

F.A.P. RTE.	SECTION	COUNTY	TOTAL SHEETS	SHEET NO.
100	104 RS-8	MCHENRY	22	1

D-91-427-06

STATE OF ILLINOIS  
DEPARTMENT OF TRANSPORTATION  
DIVISION OF HIGHWAYS

**PROPOSED  
HIGHWAY PLANS**

FAP ROUTE 100 : ILL 47  
SECTION 104 RS-8  
ILL 173 TO WISCONSIN STATE LINE  
RESURFACING (MAINTENANCE)  
MCHENRY COUNTY  
C-91-427-06

FOR INDEX OF SHEETS, SEE SHEET NO. 2

IMPROVEMENT LOCATED IN THE VILLAGE OF HEBRON

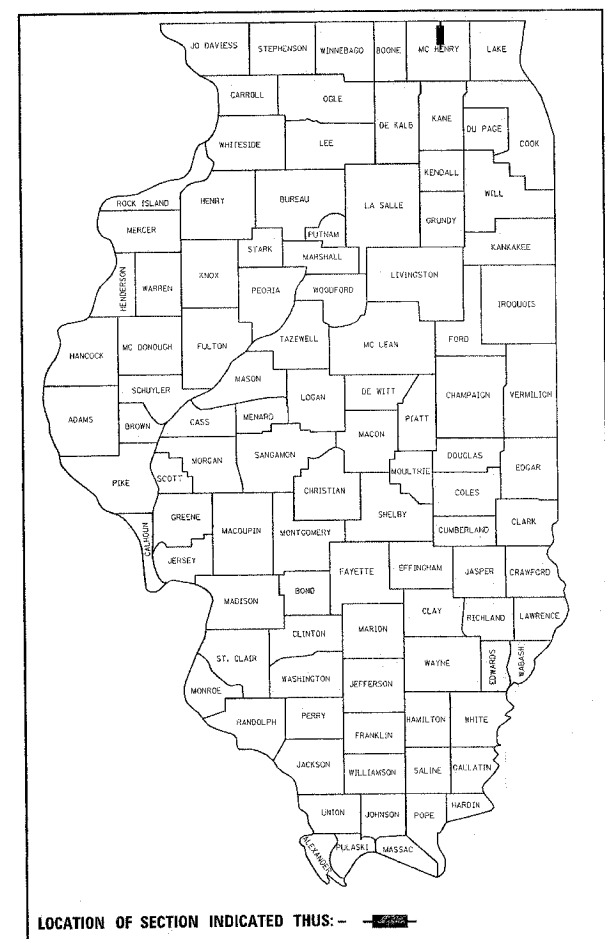

DISTRICT 1 DESIGN PLAN PREPARATION ENGINEER: KEN ENG /LONG TRAN (847) 705-4240

IMPROVEMENT ENDS STATION 98+99

IMPROVEMENT BEGINS STATION 1+52

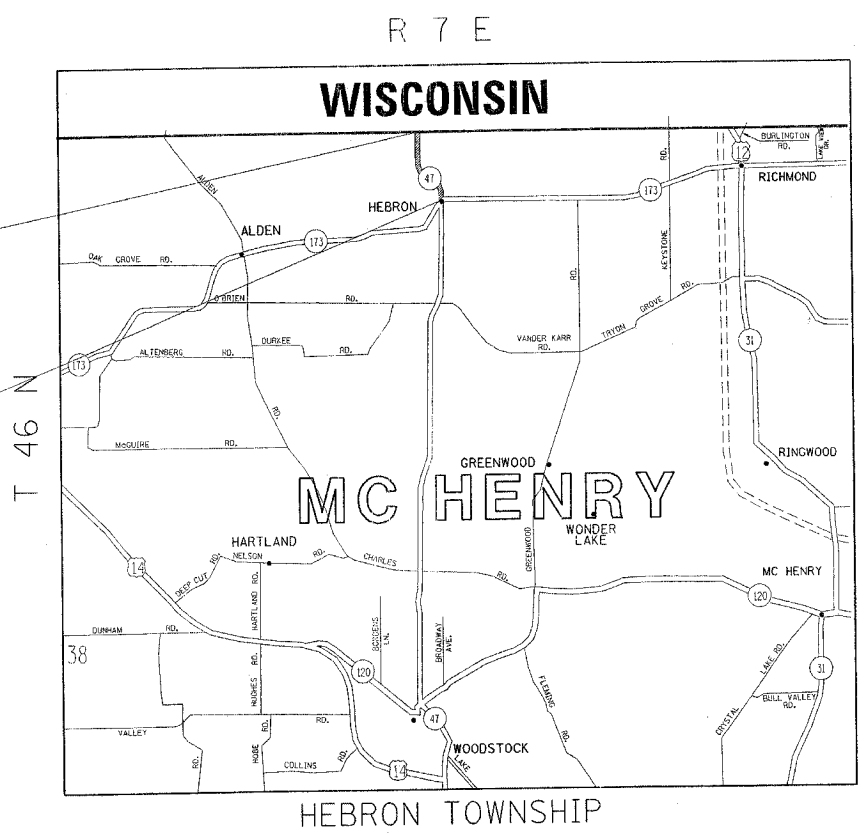

TRAFFIC DATA  
2005 ADT = 3,550  
POSTED SPEED LIMIT= 35-55 MPH

MAP SCALE  
NOT TO SCALE

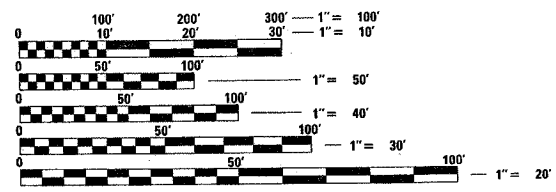

FULL SIZE PLANS HAVE BEEN PREPARED USING STANDARD ENGINEERING SCALES. REDUCED SIZED PLANS WILL NOT CONFORM TO STANDARD SCALES. IN MAKING MEASUREMENTS ON REDUCED PLANS, THE ABOVE SCALES MAY BE USED.

J.U.L.I.E.  
JOINT UTILITY LOCATION INFORMATION FOR EXCAVATION  
1-800-892-0123

GROSS & NET LENGTH OF IMPROVEMENT = 9,747 LINEAL FEET = 1.85 MILES

STATE OF ILLINOIS  
DEPARTMENT OF TRANSPORTATION  
DIVISION OF HIGHWAYS

SUBMITTED Feb 5 20 07

Dme Okh  
DEPUTY DIRECTOR OF HIGHWAYS, REGION ENGINEER

March 23, 20 07

Eric E. Haral  
ENGINEER OF DESIGN AND ENVIRONMENT

March 23, 20 07

Melton R. See, P.E.  
DIRECTOR OF HIGHWAYS, CHIEF ENGINEER

**PRINTED BY THE AUTHORITY  
OF THE STATE OF ILLINOIS**

P. A. U. NO.	SECTION	COUNTY	TOTAL SHEETS	SHEET NO.
100	104 RS-8	MCHENRY	22	2
STA.		TO STA.		
FED. ROAD DIST. NO. 1		MILEAGE		FED. AID PROJECT

INDEX OF SHEET

<u>SHEET NO.</u>	
2	INDEX OF SHEETS, STATE STANDARDS AND GENERAL NOTES
3	SUMMARY OF QUANTITIES
4-8	TYPICAL SECTIONS AND MIXTURE REQUIREMENT TABLE
9-12	ROADWAY AND PAVEMENT MARKING PLANS
13	DETAILS FOR FRAMES AND LIDS ADJUSTMENT WITH MILLING
14	PAVEMENT PATCHING FOR HMA SURFACED PAVEMENT
15	CURB OR CURB AND GUTTER REMOVAL AND REPLACEMENT
16	BUTT JOINT AND HMA TAPER DETAILS
17	TRAFFIC CONTROL AND PROTECTION FOR SIDE ROADS, INTERSECTIONS, AND DRIVEWAYS
18	TYPICAL APPLICATIONS RAISED REFLECTIVE PAVEMENT MARKERS (SNOW-PLOW RESISTANT)
19	DISTRICT ONE TYPICAL PAVEMENT MARKINGS
20	TRAFFIC CONTROL AND PROTECTION AT TURN BAYS (TO REMAIN OPEN TO TRAFFIC)
21	PAVEMENT MARKINGS LETTERS AND SYMBOLS FOR TRAFFIC STAGING
22	TEMPORARY INFORMATION SIGNING

LIST OF STANDARDS

- 000001-04 STANDARD SYMBOLS, ABBREVIATIONS AND PATTERNS
- 442201-02 CLASS C AND D PATCHES
- 482011-02 BIT. SHOULDER STRIPS/ SHLDS. WITH RESURFACING OR WIDENING AND RESURFACING PROJECTS
- 701201-02 LANE CLOSURE, 2-L,2-W, DAY ONLY FOR SPEEDS ≥ 45MPH
- 701301-02 LANE CLOSURE, 2-L,2-W, SHORT TIME OPERATIONS
- 701306-01 LANE CLOSURE, 2-L,2-W SLOW MOVING OPERATIONS-DAY ONLY FOR SPEEDS ≥ 45
- 701311-02 LANE CLOSURE, 2-L,2W MOVING OPERATIONS-DAY ONLY
- 701421-01 LANE CLOSURE, MULTILANE, DAY OPERATIONS ONLY, FOR SPEEDS ≥ 45 MPH TO 55 MPH

GENERAL NOTES

BEFORE STARTING ANY EXCAVATION, THE CONTRACTOR SHALL CALL "JULIE" AT 800-892-0123 FOR FIELD LOCATIONS OF BURIED ELECTRIC, TELEPHONE AND GAS FACILITIES. (48 HOUR NOTIFICATION IS REQUIRED)

THE CONTRACTOR SHALL COORDINATE CONSTRUCTION ACTIVITIES WITH UTILITY COMPANIES IN THE VILLAGE OF HEBRON.

THE CONTRACTOR WILL NOT BE ALLOWED TO SET UP A YARD OR FIELD OFFICE ON STATE PROPERTY WITHOUT WRITTEN PERMISSION FROM THE DEPARTMENT.

WHEN MILLED PAVEMENT IS OPEN TO TRAFFIC THE MAXIMUM GRADE DIFFERENTIAL BETWEEN PASSES OF THE MILLING MACHINE SHALL NOT EXCEED 40 MM (1 1/2 INCHES) WHERE THE SPEED LIMIT IS 80 KM/H (45 MPH) OR LESS AND 25 MM (1 INCH) WHERE THE SPEED LIMIT IS GREATER THAN 80 KM/H (45 MPH). WITH WRITTEN APPROVAL FROM THE ENGINEER, A MAXIMUM GRADE DIFFERENTIAL OF 75 MM (3 INCHES) MAY BE ALLOWED IF THE EDGE OF THE MILLING IS SLOPED A MINIMUM 1:3 (V:H).

BUTT JOINTS WILL BE INSTALLED AT THE ENDS OF ALL RESURFACING (WHERE RESURFACING MEETS EXISTING PAVEMENT), IN ACCORDANCE WITH THE "BUTT JOINT AND HOT-MIX ASPHALT TAPER DETAILS" SHEET INCLUDED IN THE PLANS, UNLESS OTHERWISE SPECIFIED.

THE RESIDENT ENGINEER SHALL CONTACT MS. DEBBIE HANLON AREA TRAFFIC FIELD TECHNICIAN AT (847) 438-2300 A MINIMUM OF 2 WEEKS PRIOR TO PLACEMENT OF PERMANENT PAVEMENT MARKING.

2/6/2007  
c:\projects\804\_42706\804\_42706.dgn  
\*REF -  
\*REF -  
\*REF -

REVISIONS	
NAME	DATE

ILLINOIS DEPARTMENT OF TRANSPORTATION

IL 47

**INDEX OF SHEETS, STATE STANDARDS & GENERAL NOTES**

SCALE: VERT. 1"=50'  
HORIZ. 1"=50'

DATE 2/6/2007

DRAWN BY \_\_\_\_\_  
CHECKED BY \_\_\_\_\_

F.A.P. RTE.	SECTION	COUNTY	TOTAL SHEETS	SHEET NO.
100	104 RS-8	MCHENRY	22	3
FED. ROAD DIST. NO. 1		ILLINOIS	HIGHWAY PROJECT	

SUMMARY OF QUANTITIES			URBAN TOTAL QUANTITIES	CONSTRUCTION TYPE CODE					SUMMARY OF QUANTITIES			URBAN TOTAL QUANTITIES	CONSTRUCTION TYPE CODE						
CODE NO	ITEM	UNIT		1000	Parking					CODE NO	ITEM		UNIT	1000	Parking				
			100% State	50% State 50% Village								100% State	50% State 50% Village						
20201006	GRADING AND SHAPING SHOULDERS	UNIT	90	90					70300260	TEMPORARY PAVEMENT MARKING - LINE 12"	FOOT	287	287						
40300200	BITUMINOUS MATERIALS (PRIME COAT)	TON	13	12	1				70300280	TEMPORARY PAVEMENT MARKING - LINE 24"	FOOT	70	70						
40600300	AGGREGATE (PRIME COAT)	TON	61	60	1				70301000	WORK ZONE PAVEMENT MARKING REMOVAL	SQ FT	7000	7000						
40600400	MIXTURE FOR CRACKS, JOINTS, AND FLANGEWAYS	TON	9.5	9	0.5				* 78000100	THERMOPLASTIC PAVEMENT MARKING - LETTERS AND SYMBOLS	SQ FT	146	146						
40600895	CONSTRUCTING TEST STRIP	EACH	1	1					* 78000200	THERMOPLASTIC PAVEMENT MARKING - LINE 4"	FOOT	36778	36778						
40600982	HOT-MIX ASPHALT SURFACE REMOVAL - BUTT JOINT	SQ YD	164	164					* 78000400	THERMOPLASTIC PAVEMENT MARKING - LINE 6"	FOOT	850	850						
40601005	HOT-MIX ASPHALT REPLACEMENT OVER PATCHES	TON	52	52					* 78000600	THERMOPLASTIC PAVEMENT MARKING - LINE 12"	FOOT	287	287						
40603335	HOT-MIX ASPHALT SURFACE COURSE, MIX "D", N50	TON	2526	2500	26				* 78000650	THERMOPLASTIC PAVEMENT MARKING - LINE 24"	FOOT	70	70						
42001300	PROTECTIVE COAT	SQ YD	70	70					* 78100100	RAISED REFLECTIVE PAVEMENT MARKER	EACH	275	275						
44000158	HOT-MIX ASPHALT SURFACE REMOVAL, 2 1/4"	SQ YD	30000	29690	310				78300200	RAISED REFLECTIVE PAVEMENT MARKER REMOVAL	EACH	248	248						
44001700	COMBINATION CONCRETE CURB AND GUTTER REMOVAL AND REPLACEMENT	FOOT	250	250					X0322256	TEMPORARY INFORMATION SIGNING	SQ FT	51.4	51.4						
44002223	HOT-MIX ASPHALT REMOVAL OVER PATCHES, 5 3/4"	SQ YD	120	120					X4067107	POLYMERIZED LEVELING BINDER (MACHINE METHOD), IL-4.75, N50	TON	1260	1247	13					
44201753	CLASS D PATCHES, TYPE II, 9 INCH	SQ YD	120	120					Z0018500	DRAINAGE STRUCTURES TO BE CLEANED	EACH	8	8						
48102100	AGGREGATE WEDGE SHOULDER, TYPE B	TON	360	360															
55039700	STORM SEWERS TO BE CLEANED	FOOT	200	200															
60257900	MANHOLES TO BE RECONSTRUCTED	EACH	1	1															
60300305	FRAMES AND LIDS TO BE ADJUSTED	EACH	9	9															
67000400	ENGINEER'S FIELD OFFICE, TYPE A	CAL MO	6	6															
67100100	MOBILIZATION	L SUM	1	1															
70100450	TRAFFIC CONTROL AND PROTECTION, STANDARD 701201	L SUM	1	1															
70100460	TRAFFIC CONTROL AND PROTECTION, STANDARD 701306	L SUM	1	1															
70300100	SHORT-TERM PAVEMENT MARKING	FOOT	9000	9000															
70300210	TEMPORARY PAVEMENT MARKING - LETTERS AND SYMBOLS	SQ FT	99	99															
70300220	TEMPORARY PAVEMENT MARKING - LINE 4"	FOOT	36778	36778															
70300240	TEMPORARY PAVEMENT MARKING - LINE 6"	FOOT	850	850															

\* SPECIALTY ITEMS

REVISIONS	
NAME	DATE

ILLINOIS DEPARTMENT OF TRANSPORTATION  
SUMMARY OF QUANTITIES  
IL 47

2/3/2007 10:58:42 AM C:\PROJECTS\60B78\60B78.DWG

F.A.P. RTE.	SECTION	COUNTY	TOTAL SHEETS	SHEET NO.
100	104 RS-8	MCHENRY	22	4
STA.		TO STA.		
FED. ROAD DIST. NO.		ILLINOIS FED. AID PROJECT		

D-91-427-06

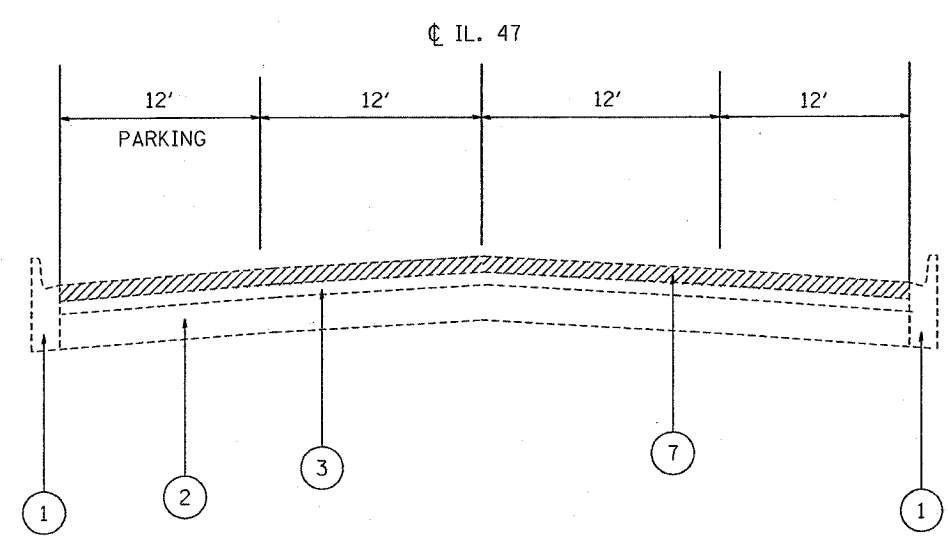

EXISTING TYPICAL SECTION  
STA. 1+52 TO STA. 4+90

**LEGEND**

- 1 EXISTING B6.24 CURB & GUTTER
- 2 EXISTING P.C.C. BASE COURSE 9" ±
- 3 EXISTING HOT MIX ASPHALT OVERLAY 8" ±
- 4 EXISTING GUARDRAIL
- 5 EXISTING AGGREGATE WEDGE SHOULDER TYPE B
- 6 EXISTING HOT-MIX ASPHALT SHOULDERS
- 7 PROPOSED HOT MIX ASPHALT SURFACE REMOVAL 2 1/4"
- 8 PROPOSED POLYMERIZED LEVELING BINDER (MACHINE METHOD), IL-4.75, N50 (3/4")
- 9 PROPOSED HOT MIX ASPHALT SURFACE COURSE, MIX "D", N50 (1 1/2")
- 10 PROPOSED GRADING AND SHAPING SHOULDERS
- 11 PROPOSED AGGREGATE WEDGE SHOULDER, TYPE B

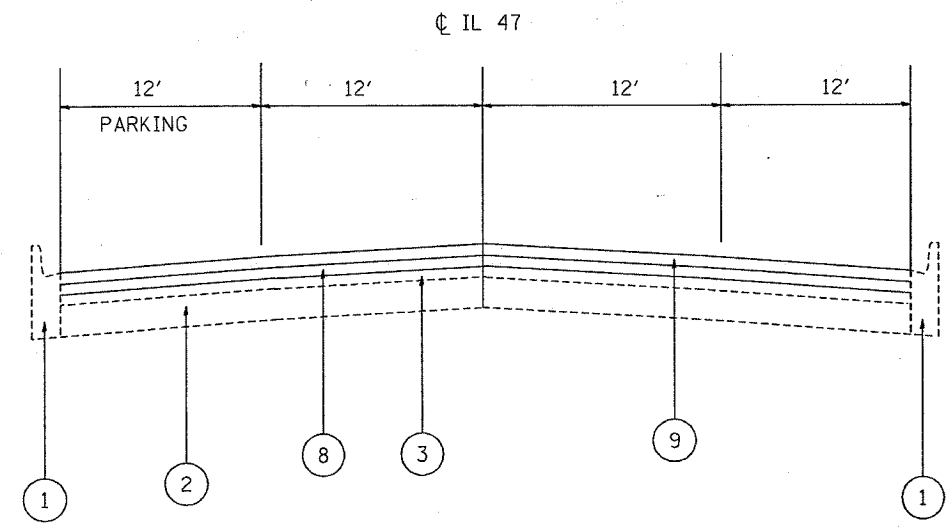

PROPOSED TYPICAL SECTION  
STA. 1+52 TO STA. 4+90

**HOT MIX ASPHALT MIXTURE REQUIREMENT**

MIXTURE TYPE	AC TYPE	AIR VOIDS
<b>PAVEMENT RESURFACING:</b>		
HOT-MIX ASPHALT SURFACE COURSE, MIX "D", N50	PG 64-22	4% @ 50 GYR.
POLYMERIZED LEVELING BINDER (MACHINE METHOD) IL-4.75, N50	SBS/SBR PG 76-28/22	4% @ 50 GYR.
<b>PATCHING:</b>		
CLASS D PATCHES, TYPE II, 9", HMA BINDER IL-19mm	PG 64-22	4% @ 70 GYR
HOT-MIX ASPHALT REPLACEMENT OVER PATCHES	PG 64-22/58-22	4% @ 70 GYR

- WHEN RAP EXCEEDS 20%, THE NEW ASPHALT BINDER IN THE MIX SHALL BE PG 58-22
- THE UNIT WEIGHT USED TO CALCULATE ALL HOT-MIX ASPHALT SURFACE MIXTURES IS 112 LBS/SY/IN

GUARDRAIL VARIES FROM LOCATION TO LOCATION WITHIN STA. 35+00 TO STA. 73+00

REVISIONS	
NAME	DATE

ILLINOIS DEPARTMENT OF TRANSPORTATION

EXISTING AND PROPOSED TYPICAL SECTIONS

SCALE: VERT. DATE      HORIZ. DRAWN BY CHECKED BY

PLOT DATE = 2/6/2007  
 FILE NAME = c:\projects\60b78\dl42786.dwg  
 PLOT SCALE = 0.00000 / 1.00000  
 USER NAME = bhakal

F.A.P. RTE.	SECTION	COUNTY	TOTAL SHEETS	SHEET NO.
100	104 RS-8	MCHENRY	22	5
STA.		TO STA.		
FED. ROAD DIST. NO.	ILLINOIS	FED. AID PROJECT		

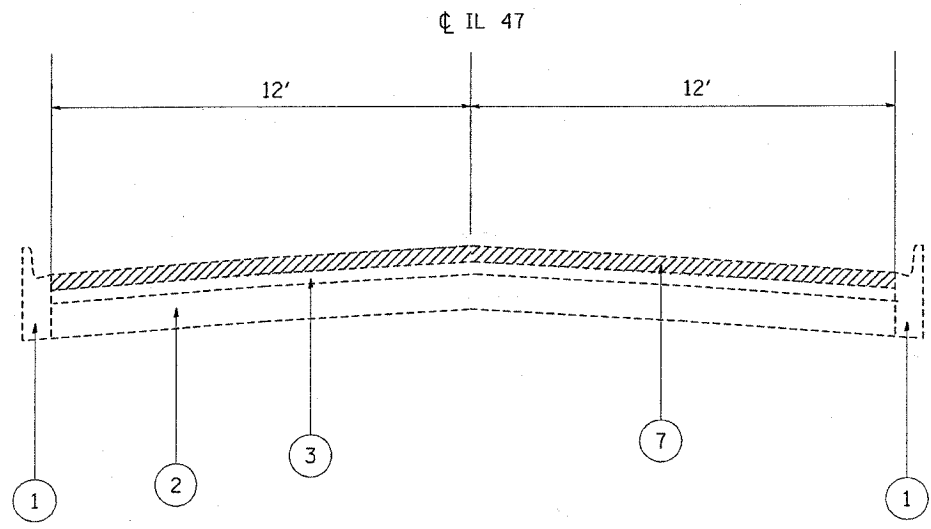

EXISTING TYPICAL SECTION  
STA. 4+90 TO STA. 15+00

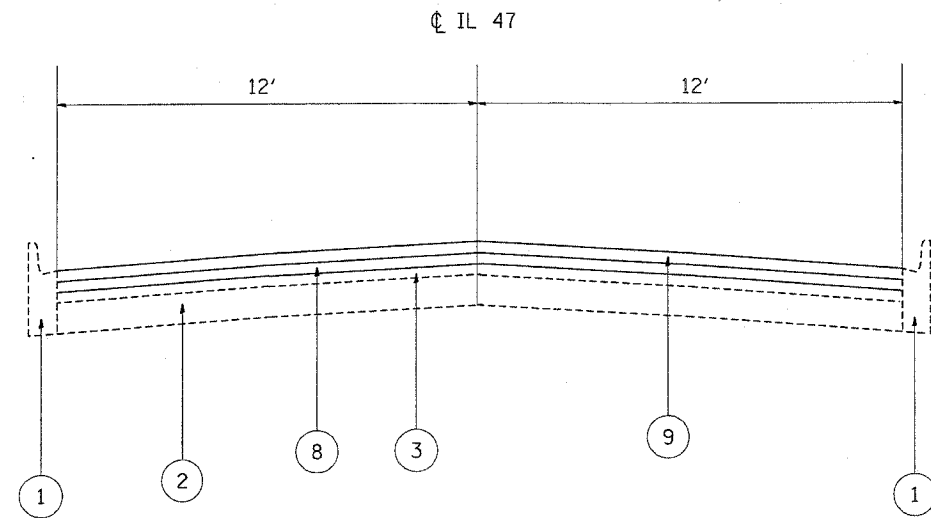

PROPOSED TYPICAL SECTION  
STA. 4+90 TO STA. 15+00

LEGEND

- 1 EXISTING B6.24 CURB & GUTTER
- 2 EXISTING P.C.C. BASE COURSE 9" ±
- 3 EXISTING HOT MIX ASPHALT OVERLAY 8" ±
- 4 EXISTING GUARDRAIL
- 5 EXISTING AGGREGATE WEDGE SHOULDER TYPE B
- 6 EXISTING HOT-MIX ASPHALT SHOULDERS
- 7 PROPOSED HOT MIX ASPHALT SURFACE REMOVAL 2 1/4"
- 8 PROPOSED POLYMERIZED LEVELING BINDER (MACHINE METHOD), IL-4.75, N50 (3/4")
- 9 PROPOSED HOT MIX ASPHALT SURFACE COURSE, MIX "D", N50 (1 1/2")
- 10 PROPOSED GRADING AND SHAPING SHOULDERS
- 11 PROPOSED AGGREGATE WEDGE SHOULDER, TYPE B

GUARDRAIL VARIES FROM LOCATION TO LOCATION WITHIN STA. 35+00 TO STA. 73+00

REVISIONS	
NAME	DATE

ILLINOIS DEPARTMENT OF TRANSPORTATION

EXISTING AND PROPOSED TYPICAL SECTIONS

SCALE: VERT. / HORIZ.  
DATE

DRAWN BY / CHECKED BY

F.A.P. RTE.	SECTION	COUNTY	TOTAL SHEETS	SHEET NO.
100	104 RS-8	MCHENRY	22	6
STA.		TO STA.		
FED. ROAD DIST. NO.	ILLINOIS	FED. AID PROJECT		

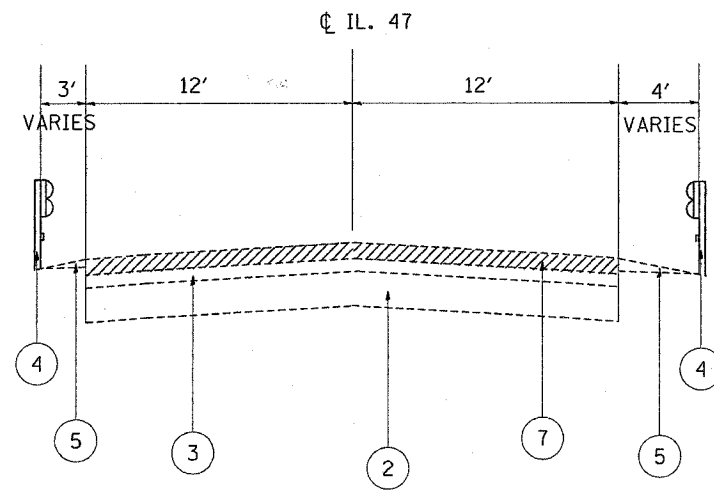

EXISTING TYPICAL SECTION  
 STA. 15+00 TO STA. 23+00  
 STA. 32+00 TO STA. 73+00

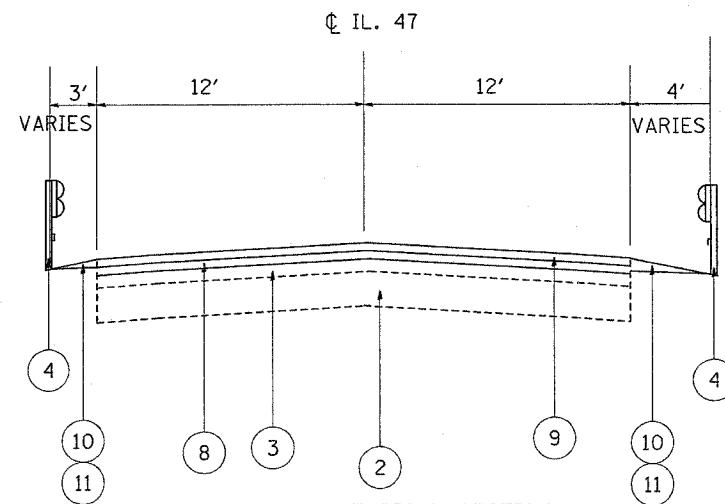

PROPOSED TYPICAL SECTION  
 STA. 15+00 TO STA. 24+00  
 STA. 32+00 TO STA. 73+00

LEGEND

- 1 EXISTING B6.24 CURB & GUTTER
- 2 EXISTING P.C.C. BASE COURSE 9" ±
- 3 EXISTING HOT MIX ASPHALT OVERLAY 8" ±
- 4 EXISTING GUARDRAIL
- 5 EXISTING AGGREGATE WEDGE SHOULDER TYPE B
- 6 EXISTING HOT-MIX ASPHALT SHOULDERS
- 7 PROPOSED HOT MIX ASPHALT SURFACE REMOVAL 2 1/4"
- 8 PROPOSED POLYMERIZED LEVELING BINDER (MACHINE METHOD), IL-4.75, N50 (3/4")
- 9 PROPOSED HOT MIX ASPHALT SURFACE COURSE, MIX "D", N50 (1 1/2")
- 10 PROPOSED GRADING AND SHAPING SHOULDERS
- 11 PROPOSED AGGREGATE WEDGE SHOULDERS, TYPE B

GUARDRAIL VARIES FROM LOCATION TO LOCATION WITHIN STA. 35+00 TO STA. 73+00

REVISIONS	
NAME	DATE

ILLINOIS DEPARTMENT OF TRANSPORTATION

EXISTING AND PROPOSED TYPICAL SECTIONS

SCALE: VERT. DATE  
 HORIZ. DRAWN BY  
 CHECKED BY

PLOT DATE = 2/6/2007  
 PLOT SCALE = 50.0000 / IN.  
 USER NAME = benkel

F.A.P. RTE.	SECTION	COUNTY	TOTAL SHEETS	SHEET NO.
100	104 RS-8	MCHENRY	22	7
STA.		TO STA.		
FED. ROAD DIST. NO.	ILLINOIS	FED. AID PROJECT		

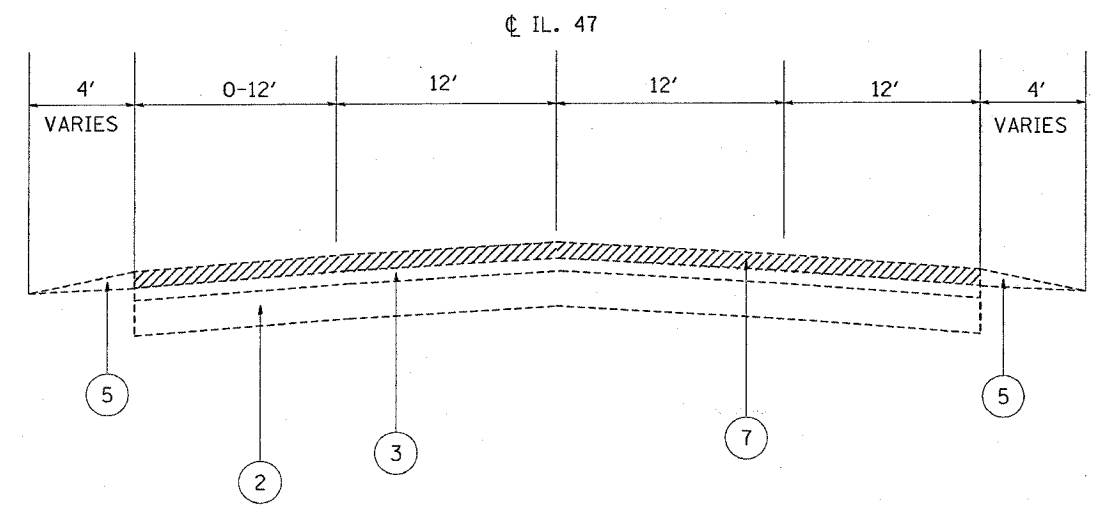

**LEGEND**

- 1 EXISTING B6.24 CURB & GUTTER
- 2 EXISTING P.C.C. BASE COURSE 9" ±
- 3 EXISTING HOT MIX ASPHALT OVERLAY 8" ±
- 4 EXISTING GUARDRAIL
- 5 EXISTING AGGREGATE WEDGE SHOULDER TYPE B
- 6 EXISTING HOT-MIX ASPHALT SHOULDERS
- 7 PROPOSED HOT MIX ASPHALT SURFACE REMOVAL 2 1/4"
- 8 PROPOSED POLYMERIZED LEVELING BINDER (MACHINE METHOD), IL-4.75, N50 (3/4")
- 9 PROPOSED HOT MIX ASPHALT SURFACE COURSE, MIX "D", N50 (1 1/2")
- 10 PROPOSED GRADING AND SHAPING SHOULDERS
- 11 PROPOSED AGGREGATE WEDGE SHOULDER, TYPE B

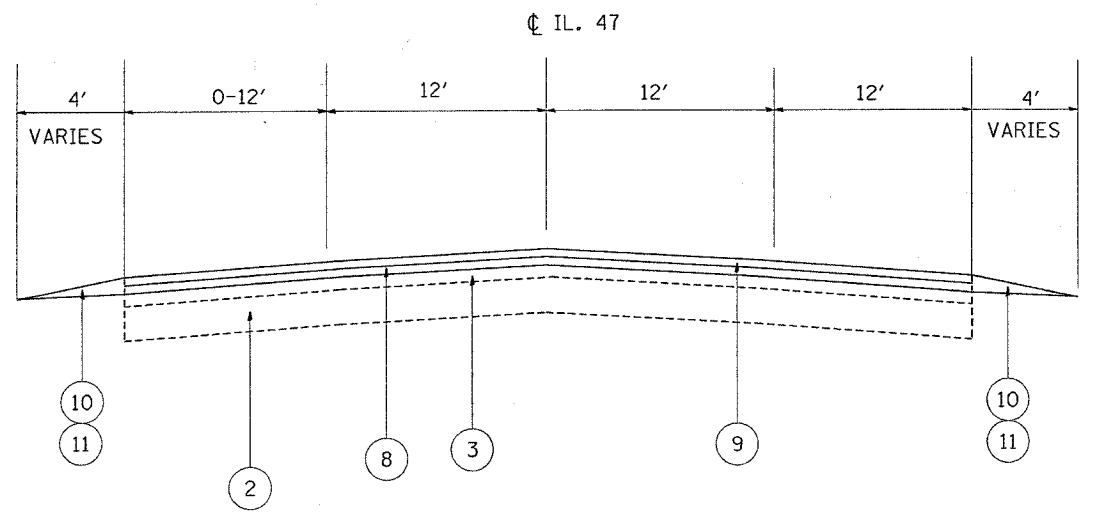

GUARDRAIL VARIES FROM LOCATION TO LOCATION WITHIN STA. 35+00 TO STA. 73+00

REVISIONS	
NAME	DATE

ILLINOIS DEPARTMENT OF TRANSPORTATION

EXISTING AND PROPOSED TYPICAL SECTIONS

SCALE: VERT.      DRAWN BY  
 HORIZ.              CHECKED BY  
 DATE

PLOT DATE = 2/6/2007  
 PLOT NAME = \\s142706\pl142706\as.dgn  
 PLOT SCALE = 50.0000 / IN.  
 USER NAME = bbnk1

F.A.P. RTE.	SECTION	COUNTY	TOTAL SHEETS	SHEET NO.
100	104 RS-8	MCHENRY	22	8
STA.		TO STA.		
FED. ROAD DIST. NO.	ILLINOIS	FED. AID PROJECT		

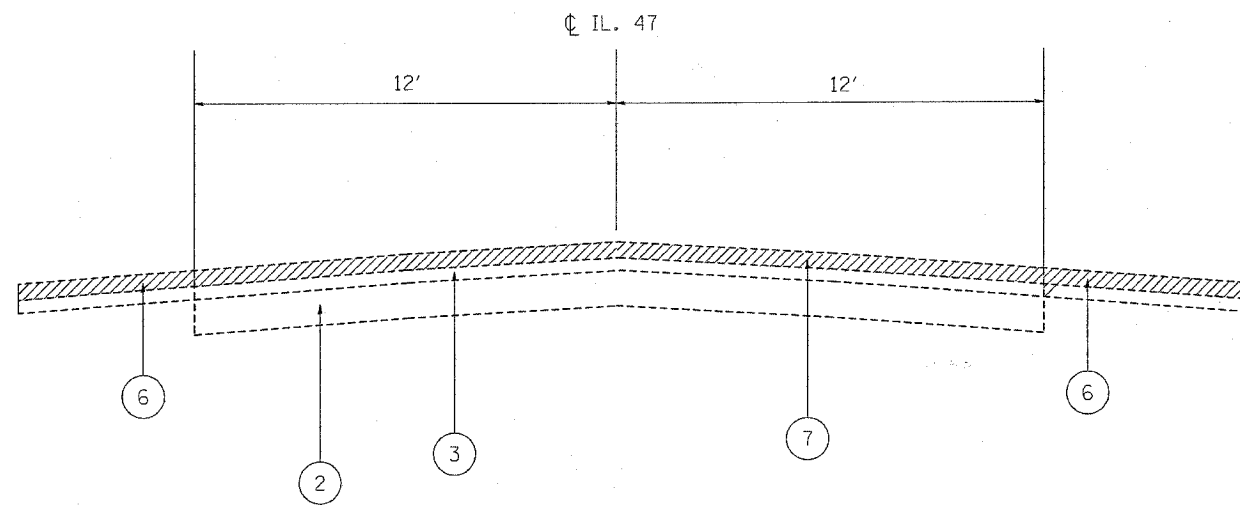

EXISTING TYPICAL SECTION  
STA. 90+00 TO STA. 98+99

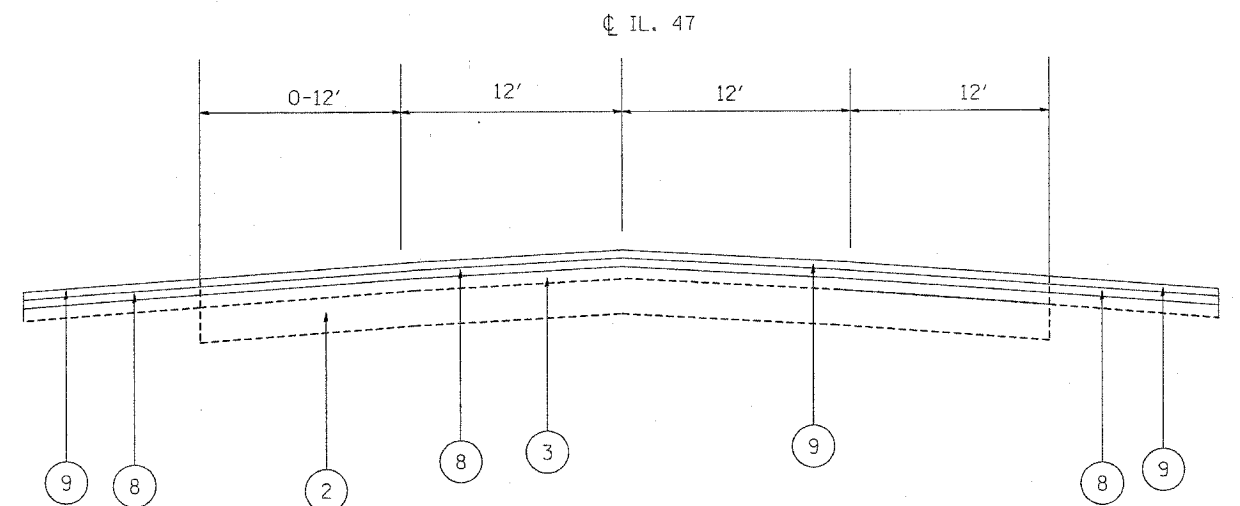

PROPOSED TYPICAL SECTION  
STA. 90+00 TO STA. 98+99

LEGEND

- 1 EXISTING B6.24 CURB & GUTTER
- 2 EXISTING P.C.C. BASE COURSE 9" ±
- 3 EXISTING HOT MIX ASPHALT OVERLAY 8" ±
- 4 EXISTING GUARDRAIL
- 5 EXISTING AGGREGATE WEDGE SHOULDER TYPE B
- 6 EXISTING HOT-MIX ASPHALT SHOULDERS
- 7 PROPOSED HOT MIX ASPHALT SURFACE REMOVAL 2 1/4"
- 8 PROPOSED POLYMERIZED LEVELING BINDER (MACHINE METHOD), IL-4.75, N50 (3/4")
- 9 PROPOSED HOT MIX ASPHALT SURFACE COURSE, MIX "D", N50 (1 1/2")
- 10 PROPOSED GRADING AND SHAPING SHOULDERS
- 11 PROPOSED AGGREGATE WEDGE SHOULDER, TYPE B

GUARDRAIL VARIES FROM LOCATION TO LOCATION WITHIN STA. 35+00 TO STA. 73+00

REVISIONS		ILLINOIS DEPARTMENT OF TRANSPORTATION
NAME	DATE	
		EXISTING AND PROPOSED TYPICAL SECTIONS

SCALE: VERT. DATE  
HORIZ. DRAWN BY  
CHECKED BY

PLOT DATE = 2/6/2007  
 FILE NAME = c:\projects\60b78\104rs8\104rs8.dgn  
 PLOT SCALE = 1/8"=1'-0"  
 USER NAME = benthal



CONTRACT NO. 60B78				
F.A.P. RTE.	SECTION	COUNTY	TOTAL SHEETS	SHEET NO.
100	104 RS-8	MCHENRY	22	9
STA.		TO STA.		
FED. ROAD DIST. NO.		ILLINOIS	FED. AID PROJECT	

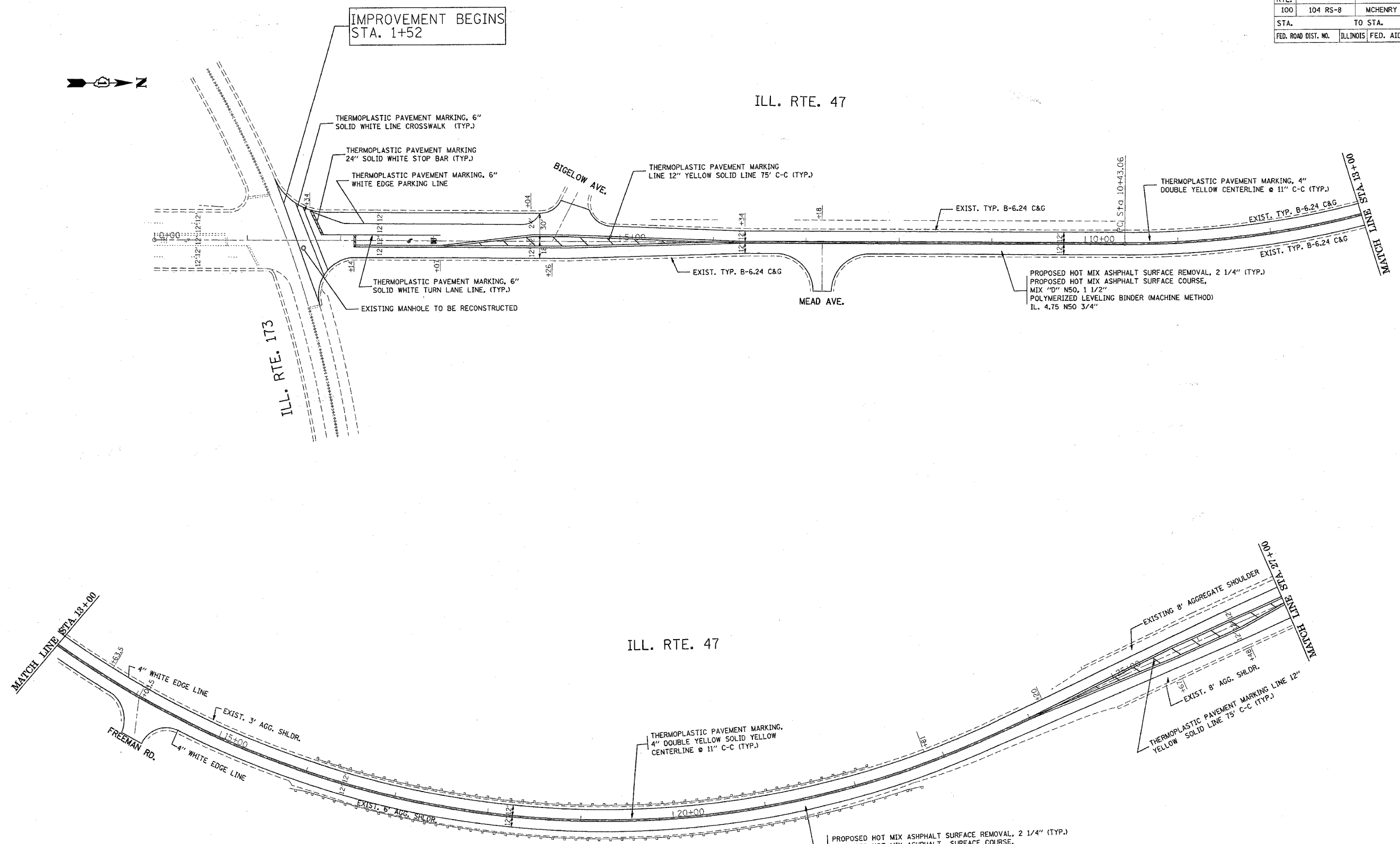
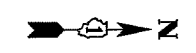

PLOT DATE = 2/13/2007  
 FILE NAME = c:\p\p\mets\j142786\142786a.dgn  
 PLOT SCALE = 50.0000' / 1" IN.  
 USER NAME = BANKSL

LIMITS OF RESURFACING SHALL BE TO THE RADIUS OF RETURN ON ALL SIDE STREETS OR AS DIRECTED BY THE ENGINEER.

PROPOSED HOT MIX ASPHALT SURFACE REMOVAL, 2 1/4" (TYP.)  
 PROPOSED HOT MIX ASPHALT SURFACE COURSE,  
 MIX "D" N50, 1 1/2"  
 POLYMERIZED LEVELING BINDER (MACHINE METHOD)  
 IL. 4.75 N50 3/4"

REVISIONS	
NAME	DATE

ILLINOIS DEPARTMENT OF TRANSPORTATION  
 IL 47  
 ILL 173 TO WISCONSIN  
 STATE LINE ROAD.  
 ROADWAY & PAVEMENT  
 MARKING PLAN  
 SCALE: VERT. DRAWN BY  
 DATE: HORIZ. CHECKED BY

CONTRACT NO. 60B78				
F.A.P. RTE.	SECTION	COUNTY	TOTAL SHEETS	SHEET NO.
100	104 RS-8	COOK	22	10
STA.		TO STA.		
FED. ROAD DIST. NO.		ILLINOIS FED. AID PROJECT		

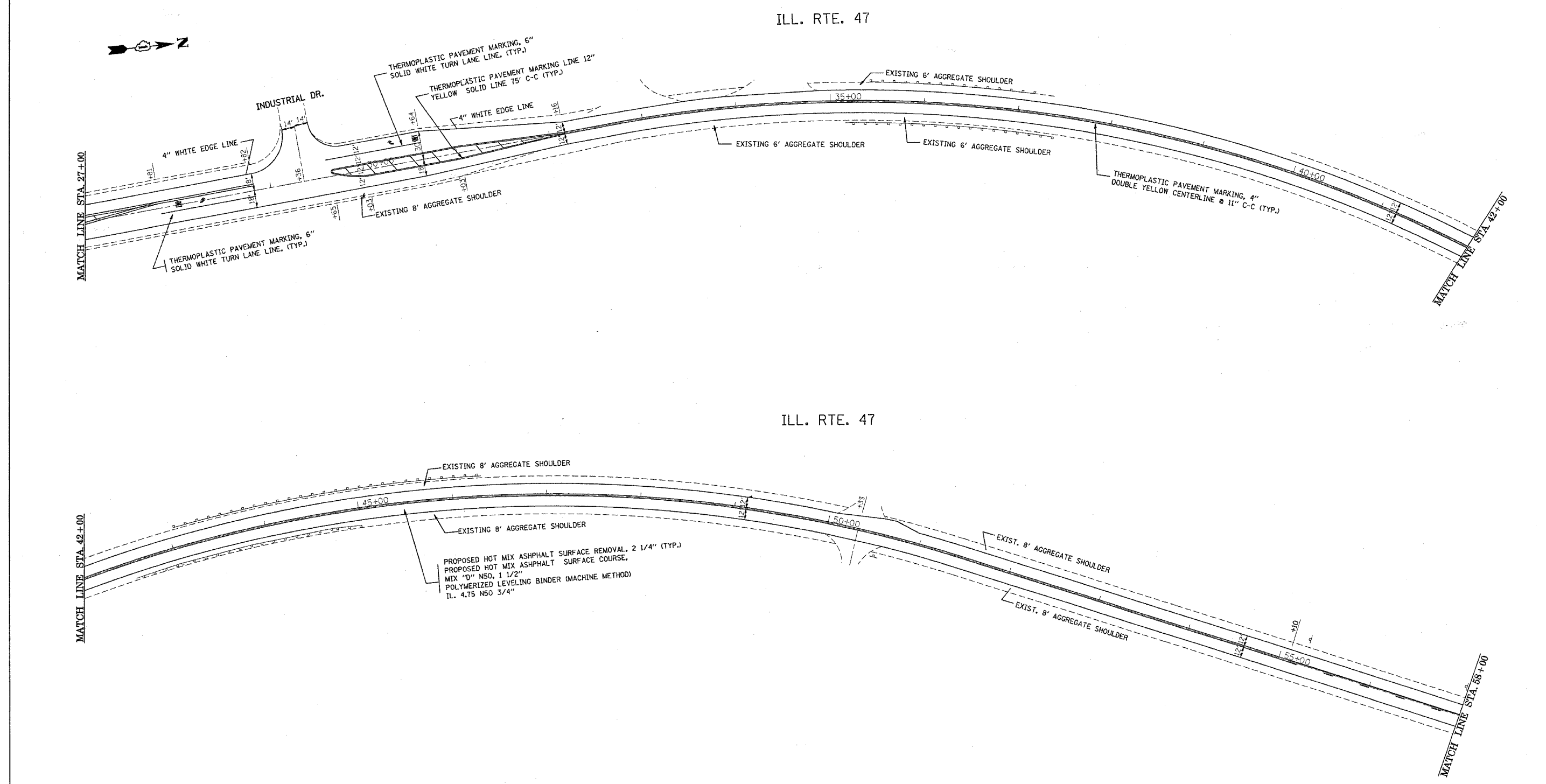

PLOT DATE = 2/3/2007  
 FILE NAME = c:\projects\442795\442795.dwg  
 PLOT SCALE = 50.0000' / IN.  
 USER NAME = BANKSI

LIMITS OF RESURFACING SHALL BE TO THE RADIUS OF RETURN ON ALL SIDE STREETS OR AS DIRECTED BY THE ENGINEER.

REVISIONS	
NAME	DATE

ILLINOIS DEPARTMENT OF TRANSPORTATION  
 IL 47  
 ILL 173 TO WISCONSIN  
 STATE LINE ROAD.  
 ROADWAY & PAVEMENT  
 MARKING PLAN

SCALE: VERT. DATE  
 HORIZ. DATE

DRAWN BY  
 CHECKED BY

F.A.P. RTE.	SECTION	COUNTY	TOTAL SHEETS	SHEET NO.
100	104 RS-8	MCHENRY	22	11
STA.		TO STA.		
FED. ROAD DIST. NO.		ILLINOIS FED. AID PROJECT		

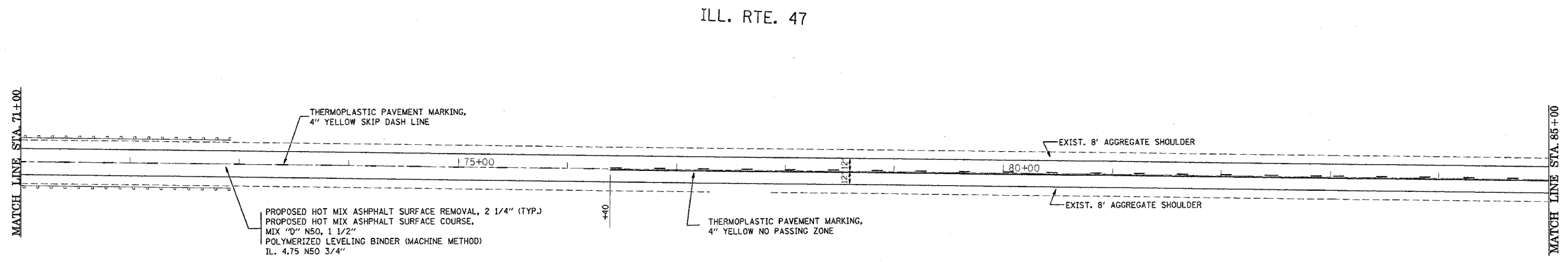
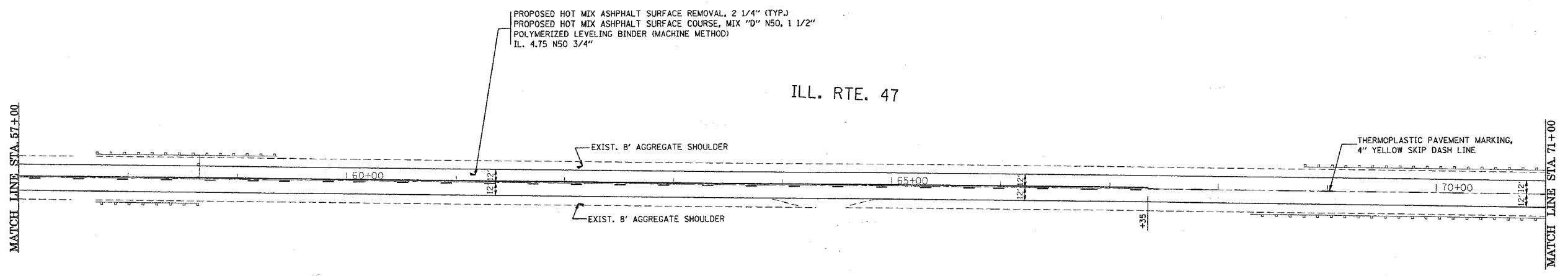

ILL. RTE. 47

ILL. RTE. 47

LIMITS OF RESURFACING SHALL BE TO THE RADIUS OF RETURN ON ALL SIDE STREETS OR AS DIRECTED BY THE ENGINEER.

REVISIONS	
NAME	DATE

ILLINOIS DEPARTMENT OF TRANSPORTATION  
 IL 47  
 ILL 173 TO WISCONSIN  
 STATE LINE ROAD.  
 ROADWAY & PAVEMENT  
 MARKING PLAN  
 SCALE: VERT. \_\_\_\_\_  
 HORIZ. \_\_\_\_\_  
 DATE \_\_\_\_\_ DRAWN BY \_\_\_\_\_  
 CHECKED BY \_\_\_\_\_

PLOT DATE = 2/12/2007  
 FILE NAME = c:\projects\42786\42786.dwg  
 PLOT SCALE = 5/8"=1'-0"  
 USER NAME = BANKSL

F.A.P. RTE.	SECTION	COUNTY	TOTAL SHEETS	SHEET NO.
100	104 RS-8	MCHENRY	22	12
STA.		TO STA.		
FED. ROAD DIST. NO.		ILLINOIS FED. AID PROJECT		

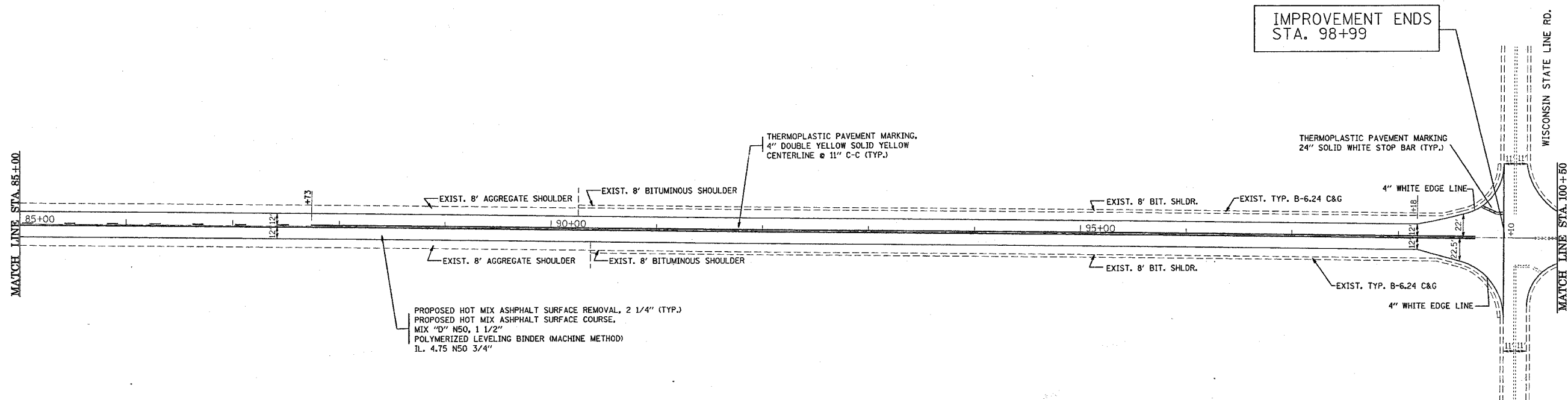

IMPROVEMENT ENDS  
STA. 98+99

PROPOSED HOT MIX ASPHALT SURFACE REMOVAL, 2 1/4" (TYP.)  
 PROPOSED HOT MIX ASPHALT SURFACE COURSE,  
 MIX "D" N50, 1 1/2"  
 POLYMERIZED LEVELING BINDER (MACHINE METHOD)  
 IL. 4.75 N50 3/4"

LIMITS OF RESURFACING SHALL  
 BE TO THE RADIUS OF RETURN ON  
 ALL SIDE STREETS OR AS  
 DIRECTED BY THE ENGINEER.

REVISIONS	
NAME	DATE

ILLINOIS DEPARTMENT OF TRANSPORTATION  
 IL 47  
 ILL 173 TO WISCONSIN  
 STATE LINE ROAD.  
 ROADWAY & PAVEMENT  
 MARKING PLAN  
 SCALE: VERT. DATE  
 HORIZ. DRAWN BY  
 CHECKED BY

PLOT DATE = 2/5/2007  
 FILE NAME = c:\pav\p001\d142796.d142796a.dgn  
 PLOT SCALE = 600000 / IN.  
 USER NAME = borndt

F.A.P. RTE.	SECTION	COUNTY	TOTAL SHEETS	SHEET NO.
100	10473-8	Mchenry	22	13
STA.	TO STA.			
FED. ROAD DIST. NO. 1	ILLINOIS	FED. AID PROJECT		

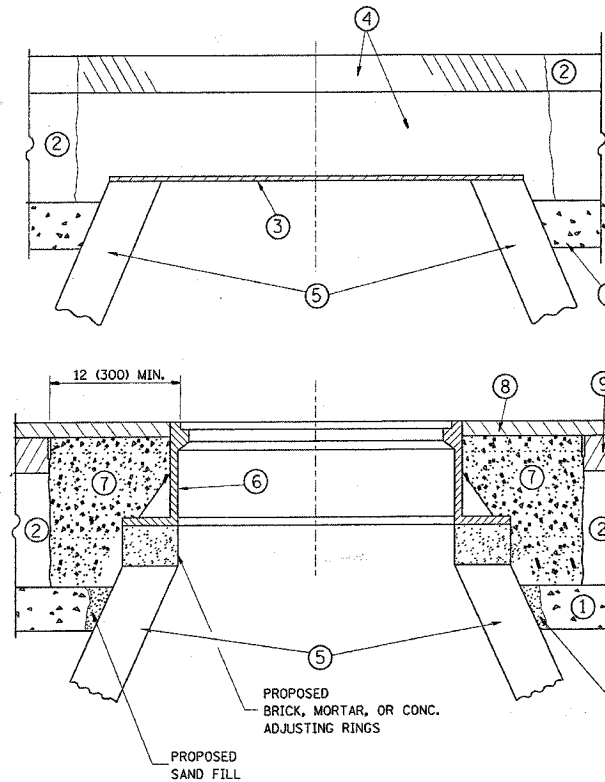

**CONSTRUCTION PROCEDURES**

**STAGE 1 (BEFORE PAVEMENT MILLING)**

- A) REMOVE A MINIMUM OF 12 (300) OF THE PAVEMENT FROM AROUND THE STRUCTURE.
- B) REMOVE THE EXISTING FRAME AND LID FROM THE STRUCTURE.
- C) COVER THE STRUCTURE OPENING WITH A 36 (900) DIAMETER METAL PLATE.
- D) BACKFILL WITH CRUSHED STONE AND A MINIMUM 1/2 (40) THICK HMA SURFACE MIX APPROVED BY THE ENGINEER.

**STAGE 2 (AFTER PAVEMENT MILLING)**

- A) REMOVE THE HMA SURFACE MIX AND CRUSHED STONE.
- B) INSTALL THE FRAME AND LID; ADJUST THE FRAME TO ITS FINAL SURFACE ELEVATION.
- C) THE SURROUNDING SPACE SHALL BE FILLED WITH CLASS S1 CONCRETE, OR HMA SURFACE COURSE OR HMA BINDER COURSE TO THE ELEVATION OF THE SURFACE OF THE EXISTING BASE COURSE OR THE BINDER COURSE.

THE PROCEDURE EXPLAINED ABOVE SHALL CONFORM TO THE APPLICABLE PORTIONS OF SECTIONS 353, 406, 602, AND 603 OF THE STANDARD SPECIFICATIONS.

**LEGEND**

- ① SUB-BASE GRANULAR MATERIAL
- ② EXISTING PAVEMENT
- ③ 36 (900) DIAMETER METAL PLATE
- ④ PROPOSED CRUSHED STONE AND HMA SURFACE MIX
- ⑤ EXISTING STRUCTURE
- ⑥ FRAME AND LID (SEE NOTES)
- ⑦ CLASS S1 CONCRETE, HMA SURFACE COURSE OR HMA BINDER COURSE
- ⑧ PROPOSED HMA SURFACE COURSE
- ⑨ PROPOSED HMA BINDER COURSE

**NOTES:**

EXISTING BROKEN FRAMES AND LIDS SHALL BE REMOVED AND DISPOSED OF BY THE CONTRACTOR AND SHALL BE REPLACED AS DIRECTED BY THE ENGINEER. REPLACEMENT FRAMES AND LIDS WILL BE PAID FOR IN ACCORDANCE WITH ARTICLE 109.04 OF THE STANDARD SPECIFICATIONS UNLESS A SEPARATE PAY ITEM HAS BEEN PROVIDED.

IF THE EXISTING LIDS ARE OPEN, THE FRAME WILL BE ADJUSTED TO THE ELEVATION OF THE MILLED PAVEMENT SURFACE PRIOR TO THE MILLING OPERATION. THE FRAME WILL NOT BE REMOVED AND COVERED BY THE METAL PLATE.

CITY OF CHICAGO CASTINGS ARE THE PROPERTY OF THE CITY AND THE CONTRACTOR SHALL NOTIFY THE CITY FOR REMOVAL AND DISPOSITION OF THE CASTINGS.

THE METAL PLATE USED TO COVER THE STRUCTURE SHALL REMAIN THE PROPERTY OF THE CONTRACTOR.

WHEN STRUCTURES ARE TO BE ADJUSTED OR RECONSTRUCTED, THE LOWERING AND RAISING OF THE FRAMES AND LIDS WILL NOT BE PAID FOR SEPARATELY BUT WILL BE INCLUDED IN THE COST OF THE CORRESPONDING PAY ITEM.

**LOCATION OF STRUCTURES:**

THE CONTRACTOR WILL BE REQUIRED TO KEEP A RECORD OF THE LOCATIONS OF THE BURIED STRUCTURES ACCORDING TO THE STATION AND DISTANCE LEFT OR RIGHT OF THE CENTERLINE OF PAVEMENT. UPON COMPLETION OF THE WORK, THE CONTRACTOR WILL DELIVER THE RECORD TO THE ENGINEER.

**BASIS OF PAYMENT:** THIS WORK WILL BE PAID FOR AT THE CONTRACT UNIT PRICE PER EACH FOR "FRAMES AND LIDS TO BE ADJUSTED, SPECIAL"

NEW FRAMES AND LIDS, WHEN SPECIFIED, WILL BE PAID FOR SEPARATELY.

**DETAILS FOR FRAMES AND LIDS ADJUSTMENT WITH MILLING**

ALL DIMENSIONS ARE IN INCHES (MILLIMETERS) UNLESS OTHERWISE SHOWN

REVISIONS	
NAME	DATE
R. SHAH	10/25/94
R. SHAH	01/30/95
R. SHAH	03/10/95
A. ABBAS	03/21/97
R. WIEDEMAN	05/14/04
R. BORO	01/01/07

**ILLINOIS DEPARTMENT OF TRANSPORTATION  
DETAILS FOR  
FRAMES AND LIDS ADJUSTMENT  
WITH MILLING**

SCALE: VERT. NONE  
HORIZ. NONE  
PLOT DATE: 2/3/2007

DRAWN BY  
CHECKED BY

BD600-03 (BD-8)

REVISION DATE: 01/01/07

PLOT DATE = 2/3/2007  
PLOT SCALE = 40' = 1" (1:1600)  
USER NAME = BRANKSL

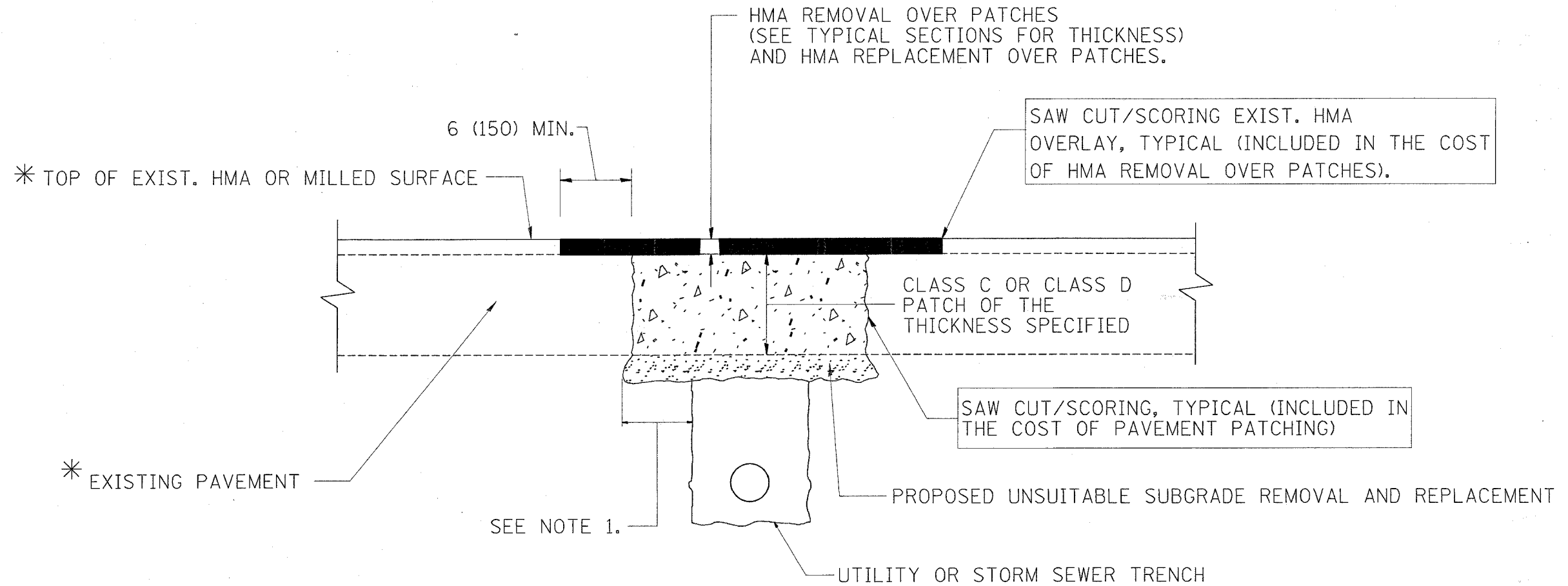

\* SEE TYPICAL SECTIONS FOR THICKNESS AND MATERIALS

NOTES:

1. THE WIDTH OF THE FULL DEPTH PATCH OVER A TRENCH SHALL BE 12 (300) WIDER ON EACH SIDE OF THE TRENCH.
2. FOR METHOD OF MEASUREMENT AND BASIS OF PAYMENT, SEE RECURRING SPECIAL PROVISION "PATCHING WITH HOT-MIX ASPHALT OVERLAY REMOVAL".

SEQUENCE OF CONSTRUCTION

1. REMOVE THE EXISTING HMA MATERIAL OVER THE AREA TO BE PATCHED.
2. REMOVE AND REPLACE FULL DEPTH PATCHES
3. REPLACE HMA MATERIAL OVER THE AREA TO BE PATCHED.

ALL DIMENSIONS ARE IN INCHES (MILLIMETERS) UNLESS OTHERWISE SHOWN.

REVISIONS	
NAME	DATE
R. SHAH	10/25/94
R. SHAH	01/14/95
R. SHAH	03/23/95
R. SHAH	04/24/95
A. HOUSEH	03/15/96
A. ABBAS	03/21/97
A. ABBAS	01/20/98
ART ABBAS	04/27/98
R. BORO	01/01/07

ILLINOIS DEPARTMENT OF TRANSPORTATION

PAVEMENT PATCHING FOR HMA SURFACED PAVEMENT

SCALE: VERT. NONE  
HORIZ. NONE  
PLOT DATE: 2/3/2007

DRAWN BY  
CHECKED BY

BD400-04 (BD-22)  
REVISION DATE: 01/01/07

F.A.P. RTE.	SECTION	COUNTY	TOTAL SHEETS	SHEET NO.
100	104RS-8	McHenry	22	15
STA.	TO STA.			
FED. ROAD DIST. NO. 1	ILLINOIS	FED. AID PROJECT		

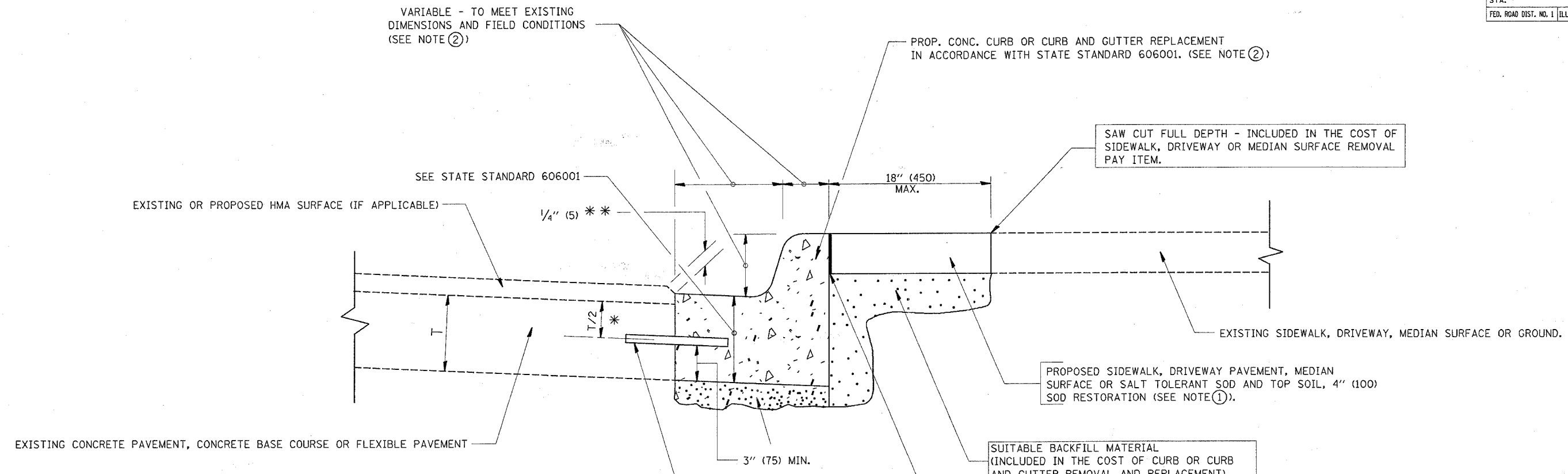

\* 3" (75) MINIMUM FROM TOP AND BOTTOM OF THE CONCRETE PAVEMENT OR BASE COURSE.  
 \*\* IF THE FINAL SURFACE OF THE PAVEMENT IS CONCRETE, THE GUTTER IS TO BE FLUSH WITH THE PAVEMENT.

- NOTE: ① SIDEWALK, DRIVEWAY PAVEMENT OR MEDIAN SURFACE SHALL BE SIMILAR TO THE MATERIAL BEING REMOVED AND WILL BE PAID FOR SEPARATELY.  
 SALT TOLERANT SOD AND TOP SOIL, 4" (100) RESTORATION WILL NOT BE PAID FOR SEPARATELY, BUT SHALL BE INCLUDED IN THE COST OF CURB OR CURB AND GUTTER REMOVAL AND REPLACEMENT.
- ② CURB OR CURB AND GUTTER REPLACEMENT SHALL MATCH THE SHAPE OF THE EXISTING CURB OR CURB AND GUTTER UNLESS OTHERWISE SPECIFIED.
- ③ FOR CURB OR CURB AND GUTTER REMOVAL AND REPLACEMENT ADJACENT TO FLEXIBLE PAVEMENT DELETE EPOXY COATED TIE BARS.
- ④ LONGITUDINAL BARS, IF ENCOUNTERED IN THE EXISTING CURB OR CURB AND GUTTER, ARE NOT TO BE REPLACED. CUTTING AND REMOVING LONGITUDINAL BARS SHALL BE INCLUDED IN THE COST OF CURB OR CURB AND GUTTER REMOVAL AND REPLACEMENT.
- ⑤ THE COST OF HMA SURFACE REMOVAL IN THE EXISTING GUTTER FLAG SHALL BE INCLUDED IN THE COST OF THE CURB AND GUTTER REMOVAL AND REPLACEMENT.
- ⑥ THE REMOVAL AND REPLACEMENT OF THE EXISTING CURB OR CURB AND GUTTER SHALL BE DONE IN ACCORDANCE WITH THE APPLICABLE PORTIONS OF SECTION 440 AND 606 OF THE STANDARD SPECIFICATIONS.
- ⑦ THE LOCATIONS OF REMOVAL AND REPLACEMENT OF EXISTING CURB OR CURB AND GUTTER SHALL BE DETERMINED BY THE RESIDENT ENGINEER AT THE TIME OF CONSTRUCTION.

UNSUITABLE SUB-BASE MATERIAL TO BE REMOVED, IF DIRECTED BY THE ENGINEER, SHALL BE REPLACED WITH EITHER SUB-BASE GRANULAR MATERIAL, TYPE B OR ADDITIONAL THICKNESS OF CONCRETE.

REMOVAL AND REPLACEMENT 4" (100) OR LESS IS INCLUDED IN THE COST OF CURB OR CURB AND GUTTER REMOVAL AND REPLACEMENT.

REMOVAL AND REPLACEMENT IN EXCESS OF 4" (100) WILL BE PAID FOR IN ACCORDANCE WITH ARTICLE 109.04 OF THE STANDARD SPECIFICATIONS.

PROPOSED #6 (20) EPOXY COATED TIE BARS 24" (600) LONG AT 24" (600) CENTERS WILL NOT BE PAID FOR SEPARATELY. DELETE EPOXY COATED TIE BARS IF EXISTING TIE BARS ARE USUABLE AS DETERMINED BY THE ENGINEER. (SEE NOTE ③).

**BASIS OF PAYMENT:**  
 THIS WORK WILL BE PAID FOR AT THE CONTRACT UNIT PRICE PER FOOT (METER) FOR "CURB REMOVAL AND REPLACEMENT" OR "COMBINATION CONCRETE CURB AND GUTTER REMOVAL AND REPLACEMENT".

ALL DIMENSIONS ARE IN INCHES (MILLIMETERS) UNLESS OTHERWISE SHOWN.

# CURB OR CURB AND GUTTER REMOVAL AND REPLACEMENT

REVISIONS	
NAME	DATE
A. HOUSEH	03/11/94
R. SHAH	02/24/95
R. SHAH	03/02/95
R. SHAH	08/19/96
R. SHAH	09/12/96
R. SHAH	09/19/96
R. SHAH	10/03/96
A. ABBAS	03/21/97
M. GOMEZ	01/22/01
R. BORO	01/01/07

ILLINOIS DEPARTMENT OF TRANSPORTATION  
 CURB OR CURB AND GUTTER  
 REMOVAL AND REPLACEMENT

SCALE: VERT. NONE  
 HORIZ.  
 PLOT DATE: 2/3/2007  
 DRAWN BY  
 CHECKED BY  
 BD600-06 (BD-24)  
 REVISION DATE: 01/01/07

PLOT DATE = 2/3/2007  
 PLOT SCALE = 50/1000  
 PLOT SCALE = 50/1000  
 USER NAME = BANKSL

F.A.P. RTE.	SECTION	COUNTY	TOTAL SHEETS	SHEET NO.
100	1047B-8	McHenry	22	16
STA.	TO STA.			
FED. ROAD DIST. NO. 1 ILLINOIS FED. AID PROJECT				

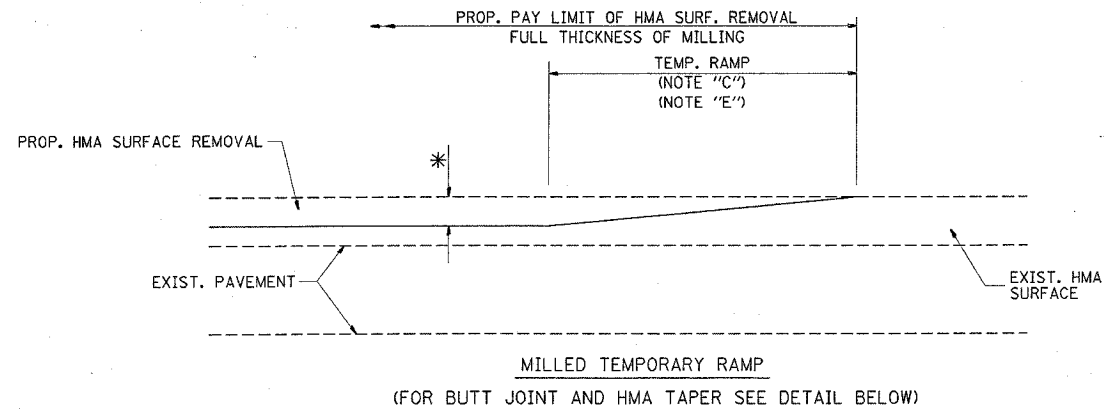

OPTION 1

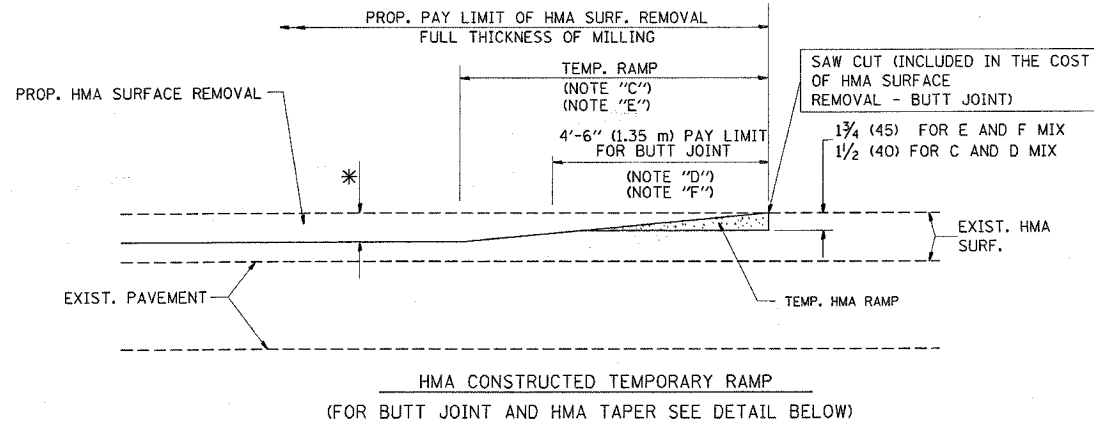

OPTION 2  
TYPICAL TEMPORARY RAMP

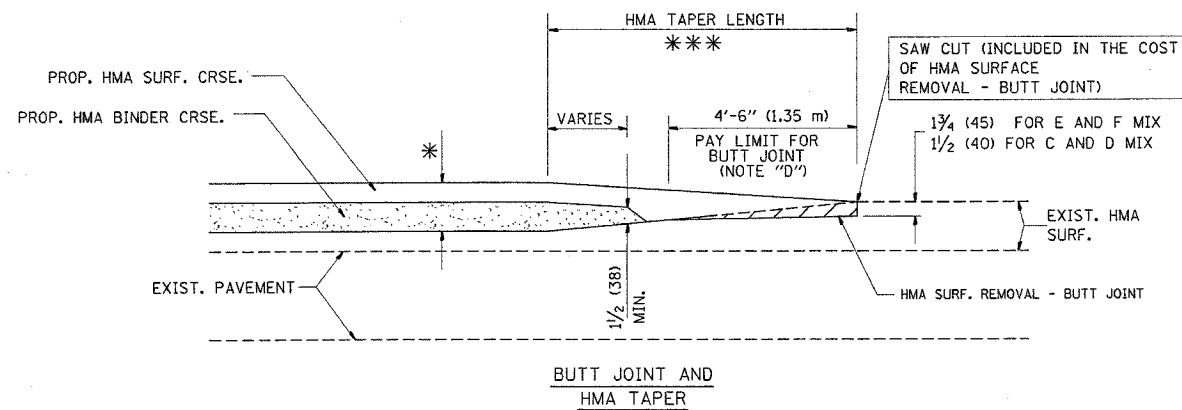

TYPICAL BUTT JOINT AND HMA TAPER  
FOR MILLING AND RESURFACING

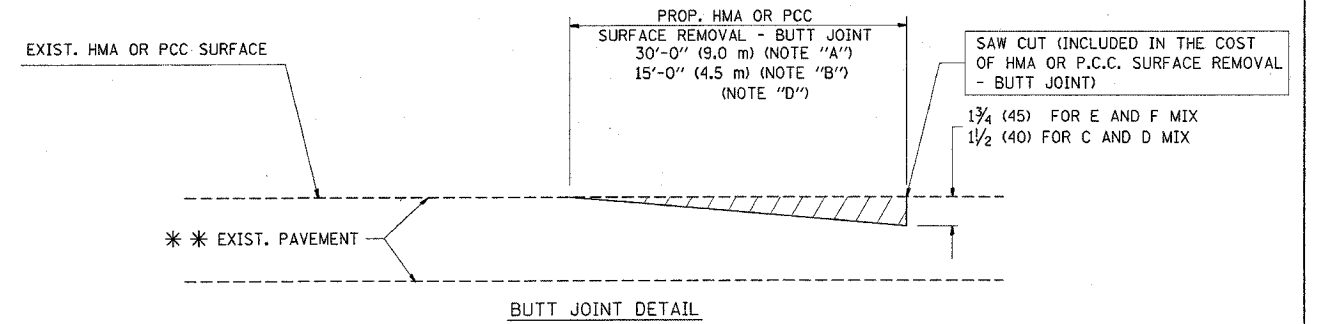

BUTT JOINT DETAIL

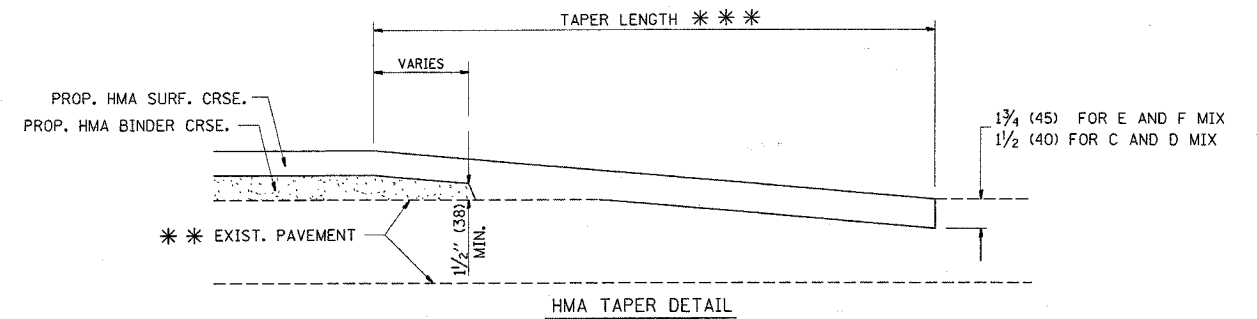

HMA TAPER DETAIL

TYPICAL BUTT JOINT AND HMA TAPER  
FOR RESURFACING ONLY

\*\*\* PC CONCRETE, HMA OR HMA RESURFACED PAVEMENT.

NOTES

- A: MAINLINE ROADWAYS AND MAJOR SIDE ROADS.
- B: MINOR SIDE ROADS.
- C: THE TEMP. RAMP SHALL BE CONSTRUCTED IMMEDIATELY UPON REMOVAL OF THE EXISTING HMA SURFACE.
- D: THE BUTT JOINT SHALL BE CONSTRUCTED IMMEDIATELY PRIOR TO PLACING THE PROPOSED HMA COURSES.
- E: TAPER THE TEMP. RAMP AT A RATE OF 3'-0" (900 mm) PER 1 INCH (25 mm) OF MILLING THICKNESS.
- F: INSTALLATION AND REMOVAL OF THE 4'-6" (1.35 m) TEMP. RAMP IS INCLUDED IN COST OF HMA SURFACE REMOVAL - BUTT JOINT
- G: SEE ARTICLE 406.08 AND 406.14 OF THE STANDARD SPECIFICATIONS FOR "HMA AND/OR PCC SURFACE REMOVAL, BUTT JOINT".

\* SEE TYPICAL SECTIONS FOR MILLING THICKNESS.

\*\*\* 20'-0" (6.1 m) PER 1 (25) RESURFACING (NOTE "A")  
10'-0" (3.0 m) PER 1 (25) RESURFACING (NOTE "B")

ALL DIMENSIONS ARE IN INCHES (MILLIMETERS) UNLESS OTHERWISE SHOWN.

BASIS OF PAYMENT:

THE BUTT JOINT WILL BE PAID FOR AT THE CONTRACT UNIT PRICE PER SQUARE YARD (SQUARE METER) FOR "HOT-MIX ASPHALT SURFACE REMOVAL - BUTT JOINT" OR FOR "PORTLAND CEMENT CONCRETE SURFACE REMOVAL - BUTT JOINT".

REVISIONS	
NAME	DATE
M. DE YONG	6-13-90
M. DE YONG	7-3-90
M. DE YONG	3-27-92
R. SHAH	09/09/94
R. SHAH	10/25/94
A. ABBAS	03/21/97
M. GOMEZ	04/06/01
R. BORO	01/01/07

ILLINOIS DEPARTMENT OF TRANSPORTATION

BUTT JOINT AND  
HMA TAPER  
DETAILS

SCALE: VERT. NONE  
HORIZ. NONE  
PLOT DATE: 2/3/2007

DRAWN BY  
CHECKED BY

BD400-05 (VI-BD32)  
REVISION DATE: 01/01/07



F.A.P. RTE.	SECTION	COUNTY	TOTAL SHEETS	SHEET NO.
100	104RS-8	McHenry	22	17
STA.	TO STA.			
FED. ROAD DIST. NO.	ILLINOIS	FED. AID PROJECT		

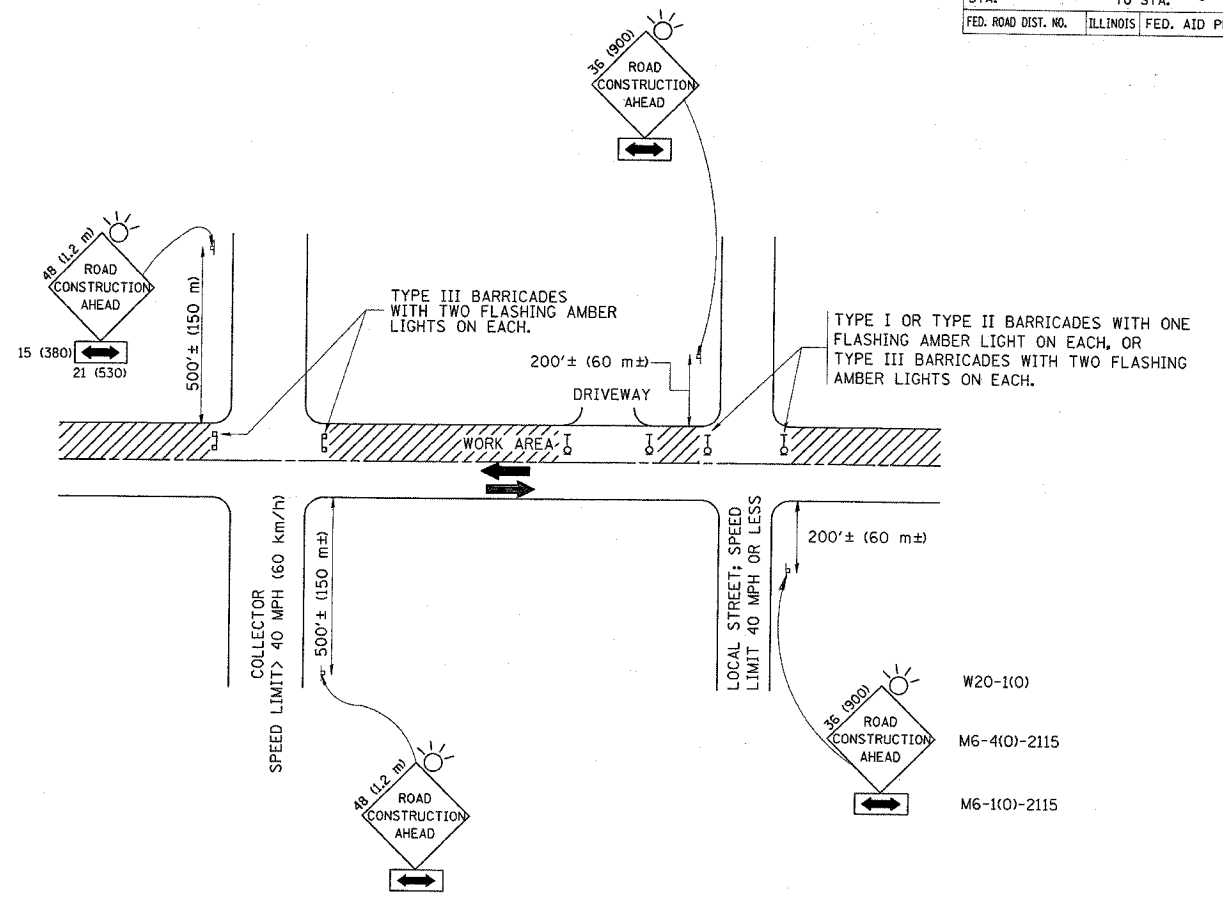

TRAFFIC CONTROL AND PROTECTION FOR SIDE ROADS, INTERSECTIONS, AND DRIVEWAYS

NOTES:

- A. FOR NO LANE RESTRICTION ON THE SIDE ROAD OR DRIVEWAYS
- SIDE ROAD WITH A SPEED LIMIT OF 40 MPH (60 km/h) OR LESS AS SHOWN ON THE DRAWING AND AS DIRECTED BY THE ENGINEER:
    - ONE ROAD CONSTRUCTION AHEAD SIGN 36 x 36 (900x900) WITH A FLASHER AND FLAG MOUNTED ON IT APPROXIMATELY 200' (60 m) IN ADVANCE OF THE MAIN ROUTE.
    - THE CLOSED PORTION OF THE MAIN ROUTE SHALL BE PROTECTED BY BLOCKING WITH TYPE I, TYPE II OR TYPE III BARRICADES, 1/3 OF THE CROSS SECTION OF THE CLOSED PORTION.
  - SIDE ROAD WITH A SPEED LIMIT GREATER THAN 60 km/h (40 MPH) AS SHOWN ON THE DRAWING AND AS DIRECTED BY THE ENGINEER:
    - ONE ROAD CONSTRUCTION AHEAD SIGN 48 x 48 (1.2 m x 1.2 m) WITH A FLASHER MOUNTED ON IT APPROXIMATELY 500' (150 m) IN ADVANCE OF THE MAIN ROUTE.
    - THE CLOSED PORTION OF THE MAIN ROUTE SHALL BE PROTECTED BY BLOCKING WITH TYPE III BARRICADES, 1/2 OF THE CROSS SECTION OF THE CLOSED PORTION.
- B. FOR A LANE CLOSURE ON A SIDE ROAD OR DRIVEWAY:
- USE APPLICABLE PORTIONS OF THE TYPICAL APPLICATION OF TRAFFIC CONTROL DEVICES (STD. 701501, STD. 701606 OR THE APPROPRIATE STANDARD). THE SPACING OF SIGNS AND BARRICADES SHALL BE ADJUSTED FOR FIELD CONDITIONS AS DIRECTED BY THE ENGINEER. THE DIRECTIONAL ARROW SHALL BE COVERED OR REMOVED WHEN NO LONGER CONSISTENT WITH THE SIDE ROAD LANE CLOSURE.
- C. ADVANCE WARNING SIGNS ARE TO BE OMITTED ON DRIVEWAY UNLESS OTHERWISE NOTED.
- D. THE TRAFFIC CONTROL AND PROTECTION FOR SIDE ROADS, INTERSECTIONS, AND DRIVEWAYS SHALL BE INCIDENTAL TO THE COST OF SPECIFIED TRAFFIC CONTROL STANDARDS OR ITEMS.

All dimensions are in millimeters (inches) unless otherwise shown.

REVISIONS	
NAME	DATE
LHA	6/89
T. RAMMACHER	09/08/94
J. OBERLE	10/18/95
A. HOUSEH	03/06/96
A. HOUSEH	10/15/96
T. RAMMACHER	01/06/00

ILLINOIS DEPARTMENT OF TRANSPORTATION  
 TRAFFIC CONTROL AND PROTECTION  
 FOR  
 SIDE ROADS, INTERSECTIONS, AND  
 DRIVEWAYS

SCALE: DATE: 2/3/2007  
 DRAWN BY: CHECKED BY: TC-10

REVISION DATE: 01/06/00

PLOT DATE = 2/3/2007  
 FILE NAME = n:\data\trc10.dgn  
 PLOT SCALE = 50.0000 / IN.  
 USER NAME = BINKEL

F.A.P. RTE.	SECTION	COUNTY	TOTAL SHEETS	SHEET NO.
100	104RS-B	McHenry	22	18
STA.		TO STA.		
FED. ROAD DIST. NO.		ILLINOIS FED. AID PROJECT		

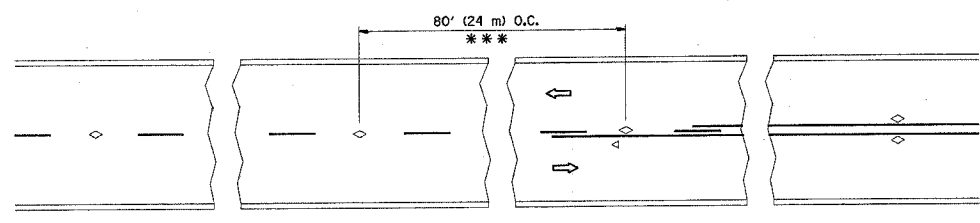

\*\*\* REDUCE TO 40' (12 m) O.C. ON CURVES WITH POSTED OR ADVISORY SPEED 45 M.P.H. (70 km/h) OR LESS.

TWO-LANE/TWO-WAY

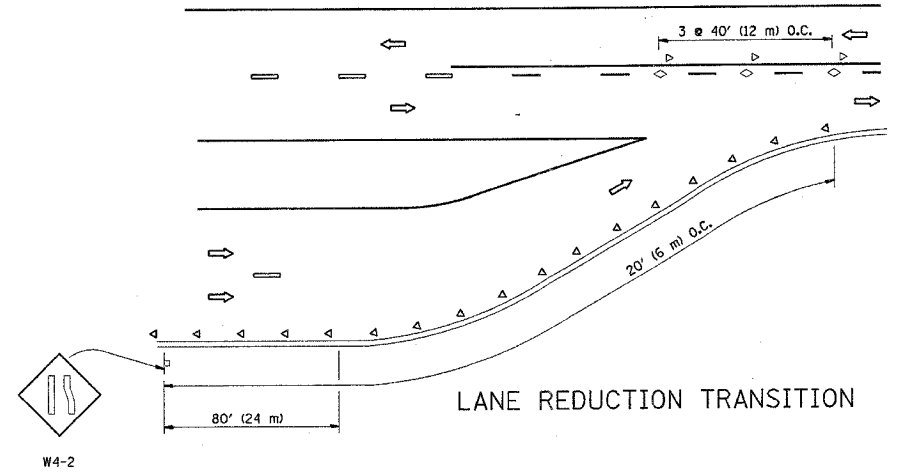

LANE REDUCTION TRANSITION

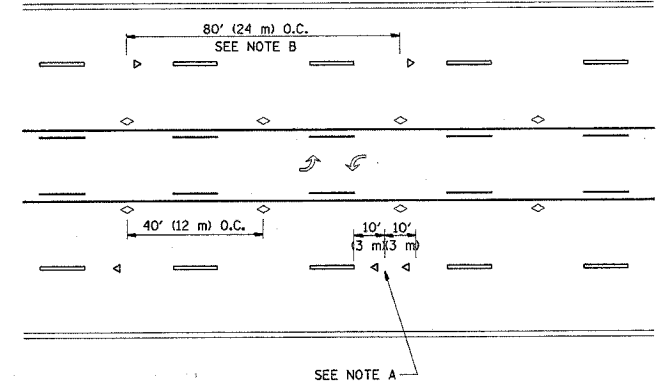

TWO-WAY LEFT TURN

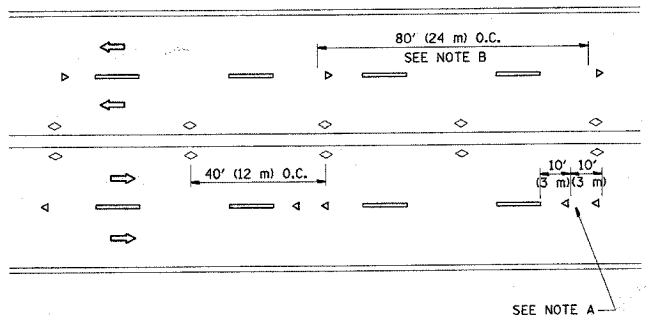

MULTI-LANE/UNDIVIDED

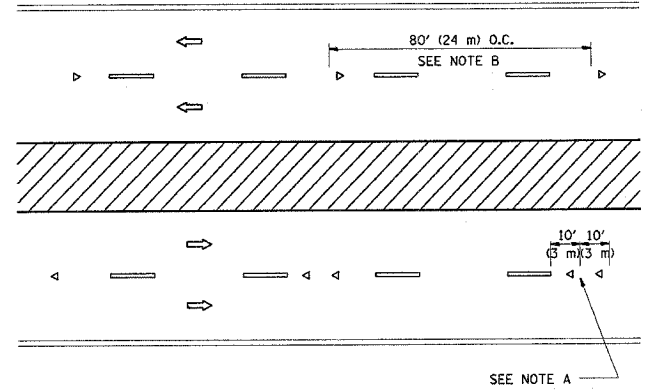

MULTI-LANE/DIVIDED

GENERAL NOTES

1. MARKERS USED WITH DASHED LINES SHALL BE CENTERED IN THE GAP BETWEEN SEGMENTS.
2. MARKERS USED ADJACENT TO SOLID LINES SHALL BE OFFSET 2 TO 3 (50 TO 75) TOWARD TRAFFIC AS SHOWN.
3. MARKERS THROUGH TANGENTS LESS THAN 500' (150 m) IN LENGTH BETWEEN CURVES SHALL BE INSTALLED AT THE LESSER OF THE TWO CURVE SPACINGS.

SYMBOLS

- YELLOW STRIPE
- WHITE STRIPE
- < ONE-WAY AMBER MARKER
- < ONE-WAY CRYSTAL MARKER (W/O)
- < TWO-WAY AMBER MARKER

LANE MARKER NOTES

- A. USE DOUBLE LANE LINE MARKERS SPACED AS SHOWN.
- B. REDUCE TO 40' (12 m) O.C. ON CURVES WHERE ADVISORY SPEEDS ARE 10 M.P.H (20 km/h) LOWER THAN POSTED SPEEDS.

DESIGN NOTES

1. DOUBLE LANE LINE MARKERS SHALL BE USED UNLESS SPECIFIED OTHERWISE.
2. EXCEPT AS SHOWN ON THE LANE REDUCTION TRANSITION AND FREEWAY EXIT RAMP DETAIL, MARKERS ARE NOT TO BE SPECIFIED ON RIGHT EDGE LINES.
3. THE EXACT MARKER LIMITS, SPACING, AND COLOR SHOULD BE INCLUDED IN THE PLANS.
4. MARKERS SHOULD NOT BE USED ALONGSIDE CURBS EXCEPT FOR EXTREMELY SHORT SECTIONS OF CURBS WHERE NOT MORE THAN TWO MARKERS WOULD BE INVOLVED.

All dimensions are in millimeters (inches) unless otherwise shown.

REVISIONS	
NAME	DATE
T. RAMMACHER	09-19-94
T. RAMMACHER	03-12-99
T. RAMMACHER	01-06-00

ILLINOIS DEPARTMENT OF TRANSPORTATION  
 TYPICAL APPLICATIONS  
 RAISED REFLECTIVE PAVEMENT  
 MARKERS (SNOW-PLOW RESISTANT)

SCALE: NONE  
 DATE: 2/3/2007

DRAWN BY CADD  
 CHECKED BY  
 TC-11  
 REVISION DATE: 01/06/00

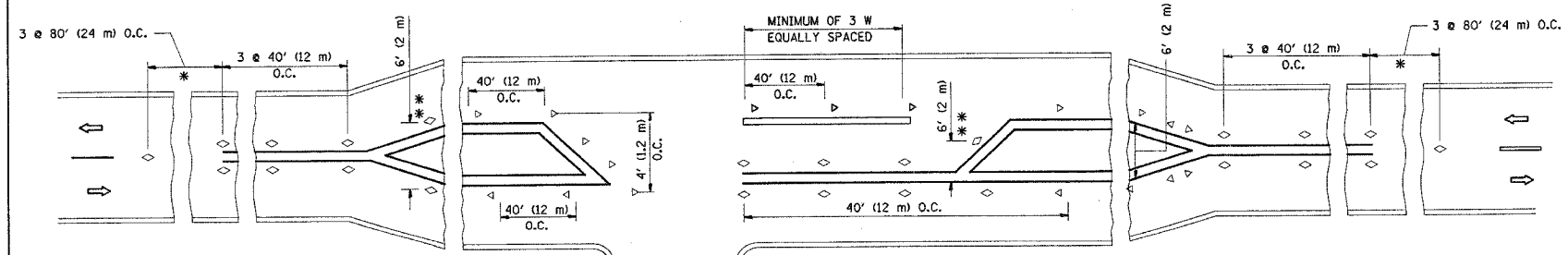

LEFT TURN

\* SEE TWO-LANE/TWO-WAY WHERE MARKERS CONTINUE  
 \*\* WHERE THE MEDIAN WIDTH IS 6' (2 m) OR LESS USE TWO-WAY MARKERS.

PLOT DATE = 2/3/2007  
 FILE NAME = w:\dms\p\1011.dgn  
 USER NAME = BANKSL

F.A.P. SECTION	COUNTY	TOTAL SHEETS	SHEET NO.
100-104RS-8	McHenry	22	19
STA. TO STA.		FED. ROAD DIST. NO. ILLINOIS FED. AID PROJECT	

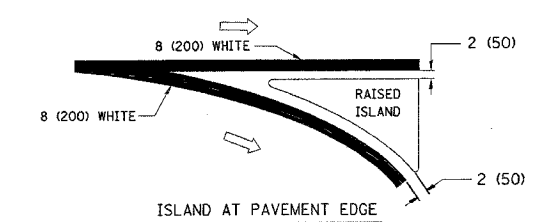
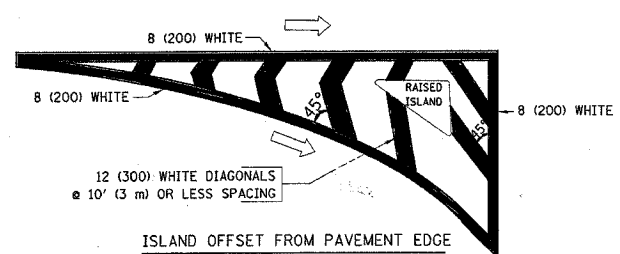
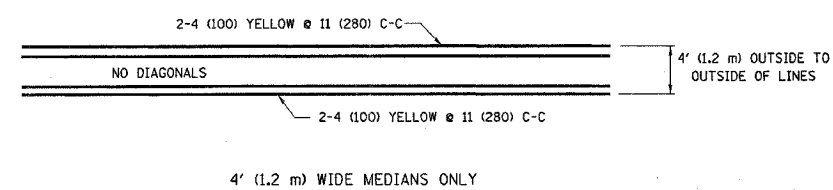
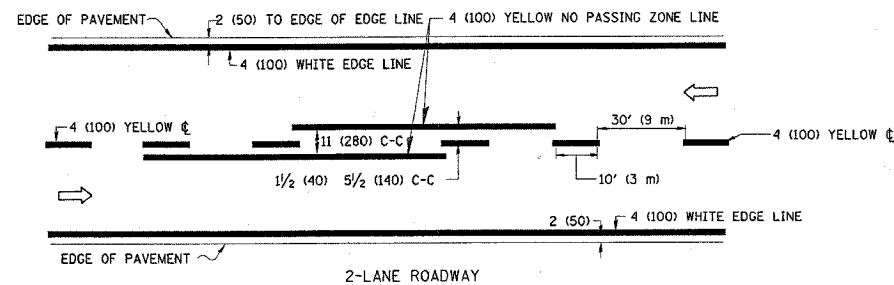

TYPICAL ISLAND MARKING

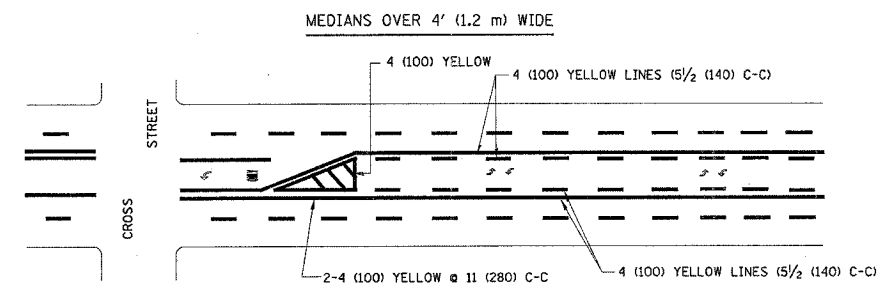
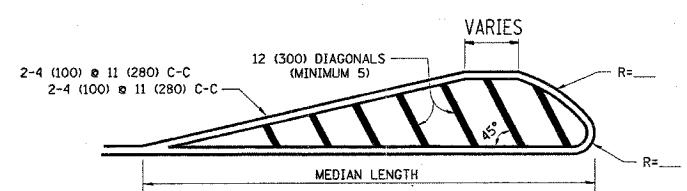
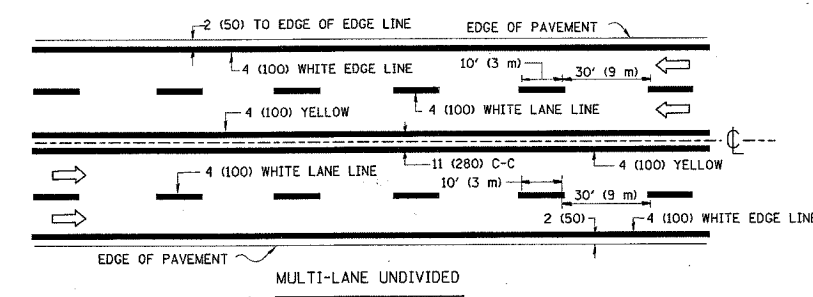

TYPICAL PAINTED MEDIAN MARKING

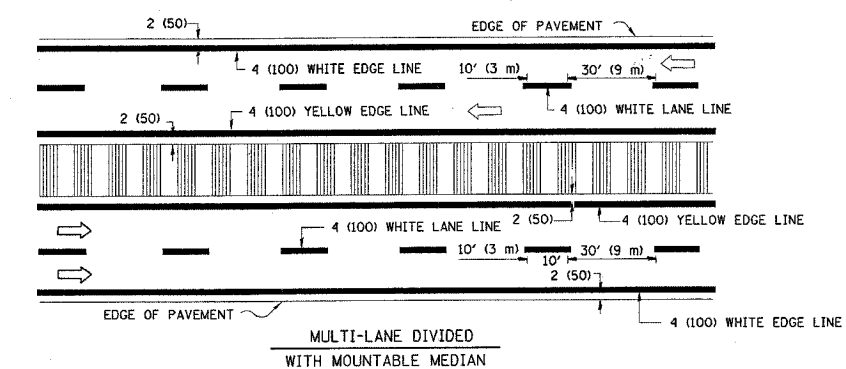

NOTE: MEDIANS WITH BARRIER CURB DO NOT REQUIRE AN EDGE LINE

TYPICAL LANE AND EDGE LINE MARKING

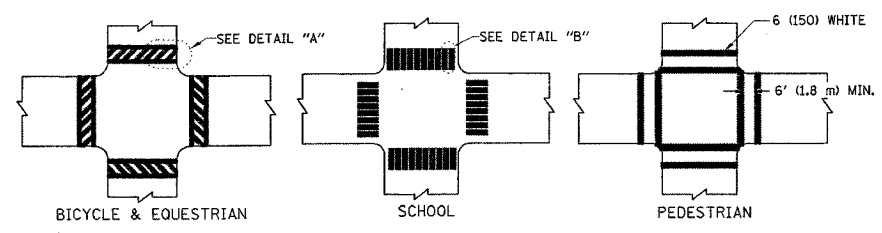

TYPICAL CROSSWALK MARKING

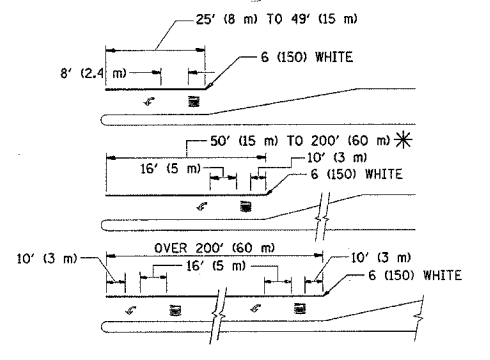

TYPICAL TURN LANE MARKING

TYPE OF MARKING	WIDTH OF LINE	PATTERN	COLOR	SPACING / REMARKS
CENTERLINE ON 2 LANE PAVEMENT	4 (100)	SKIP-DASH	YELLOW	10' (3 m) LINE WITH 30' (9 m) SPACE
CENTERLINE ON MULTI-LANE UNDIVIDED PAVEMENT	2 @ 4 (100)	SOLID	YELLOW	11 (280) C-C
NO PASSING ZONE LINES: FOR ONE DIRECTION FOR BOTH DIRECTIONS	4 (100) 2 @ 4 (100)	SOLID SOLID	YELLOW YELLOW	5/2 (140) C-C FROM SKIP-DASH CENTERLINE 11 (280) C-C OMIT SKIP-DASH CENTERLINE BETWEEN
LANE LINES	4 (100) 5 (125) ON FREEWAYS	SKIP-DASH SKIP-DASH	WHITE WHITE	10' (3 m) LINE WITH 30' (9 m) SPACE
DOTTED LINES (EXTENSIONS OF CENTER, LANE OR TURN LANE MARKINGS)	SAME AS LINE BEING EXTENDED	SKIP-DASH	SAME AS LINE BEING EXTENDED	2' (600) LINE WITH 6' (1.8 m) SPACE
EDGE LINES	4 (100)	SOLID	YELLOW-LEFT WHITE-RIGHT	OUTLINE MOUNTABLE MEDIANS IN YELLOW; EDGE LINES ARE NOT USED NEXT TO BARRIER CURB
TURN LANE MARKINGS	6 (150) LINE; FULL SIZE LETTERS & SYMBOLS (8" (2.4m))	SOLID	WHITE	SEE TYPICAL TURN LANE MARKING DETAIL
TWO WAY LEFT TURN MARKING	2 @ 4 (100) EACH DIRECTION 8' (2.4m) LEFT ARROW	SKIP-DASH AND SOLID IN PAIRS	YELLOW WHITE	10' (3 m) LINE WITH 30' (9 m) SPACE FOR SKIP-DASH; 5/2 (140) C-C BETWEEN SOLID LINE AND SKIP-DASH LINE SEE TYPICAL TWO-WAY LEFT TURN MARKING DETAIL
CROSSWALK LINES (PEDESTRIAN) A. DIAGONALS (BIKE & EQUESTRIAN) B. LONGITUDINAL BARS (SCHOOL)	2 @ 6 (150) 12 (300) @ 45° 12 (300) @ 90°	SOLID SOLID SOLID	WHITE WHITE WHITE	NOT LESS THAN 6' (1.8 m) APART 2' (600) APART SEE TYPICAL CROSSWALK MARKING DETAILS.
STOP LINES	24 (600)	SOLID	WHITE	PLACE 4' (1.2 m) IN ADVANCE OF AND PARALLEL TO CROSSWALK, IF PRESENT. OTHERWISE, PLACE AT DESIRED STOPPING POINT, PARALLEL TO CROSSROAD CENTERLINE, WHERE POSSIBLE
PAINTED MEDIANS	2 @ 4 (100) WITH 12 (300) DIAGONALS @ 45° NO DIAGONALS USED FOR 4' (1.2 m) WIDE MEDIANS	SOLID	YELLOW: TWO WAY TRAFFIC WHITE: ONE WAY TRAFFIC	11 (280) C-C FOR THE DOUBLE LINE SEE TYPICAL PAINTED MEDIAN MARKING.
GORE MARKING AND CHANNELIZING LINES	8 (200) WITH 12 (300) DIAGONALS @ 45°	SOLID	WHITE	DIAGONALS: 15' (4.5 m) C-C (LESS THAN 30MPH (50 km/h)) 20' (6 m) C-C 30MPH (50 km/h) TO 45MPH (70 km/h) 30' (9 m) C-C (OVER 45MPH (70 km/h))
RAILROAD CROSSING	24 (600) TRANSVERSE LINES; "RR" IS 6' (1.8 m) LETTERS; 16 (400) LINE FOR "X"	SOLID	WHITE	SEE STATE STANDARD 780001 AREA OF: "R"=3.6 SQ. FT. (0.33 m <sup>2</sup> ) EACH "X"=54.0 SQ. FT. (5.0 m <sup>2</sup> )
SHOULDER DIAGONALS	12 (300) @ 45°	SOLID	WHITE - RIGHT YELLOW - LEFT	50' (15 m) C-C (LESS THAN 30MPH (50 km/h)) 75' (25 m) C-C (30 MPH (50 km/h) TO 45MPH (70 km/h)) 150' (45 m) C-C (OVER 45MPH (70 km/h))

FOR FURTHER DETAILS ON PAVEMENT MARKING REFER TO STANDARD SPECIFICATIONS FOR ROAD AND BRIDGE CONSTRUCTION AND STATE STANDARD 780001.

All dimensions are in millimeters (inches) unless otherwise shown.

REVISIONS	
NAME	DATE
EVERS	03-19-90
T. RAMMACHER	10-27-94
ALEX HOUSEH	10-09-96
ALEX HOUSEH	10-17-96
T. RAMMACHER	01-06-00

ILLINOIS DEPARTMENT OF TRANSPORTATION  
DISTRICT ONE  
TYPICAL PAVEMENT MARKINGS  
SCALE: NONE  
DATE: 2/3/2007  
DRAWN BY CADD  
CHECKED BY  
TC-13  
REVISION DATE: 01/06/00

PLOT DATE = 2/3/2007  
FILE NAME = m:\asst\asst\3.dgn  
PLOT SCALE = 1/8" = 1'-0"  
USER NAME = BINKSL



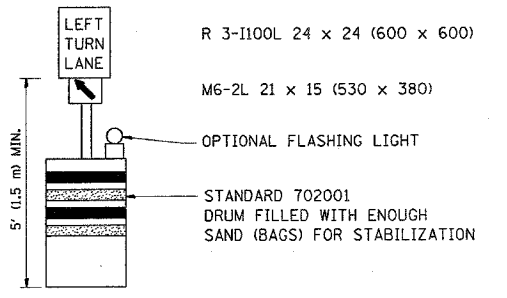
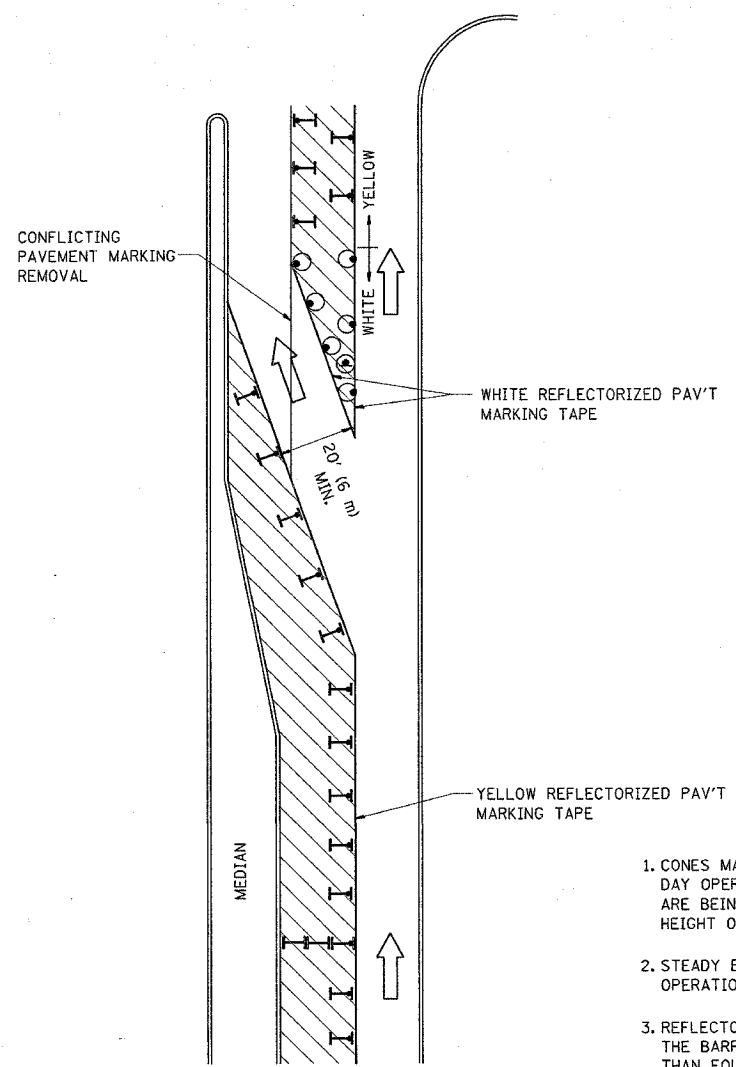

F.A.P. RTE.	SECTION	COUNTY	TOTAL SHEETS	SHEET NO.
100/104/RS-8	McHenry	22	20	
STA.		TO STA.		
FED. ROAD DIST. NO.		ILLINOIS FED. AID PROJECT		

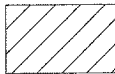
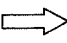

**GENERAL NOTES**

1. CONES MAY BE SUBSTITUTED FOR BARRICADES OR DRUMS AT HALF THE SPACING DURING DAY OPERATIONS. CONES SHALL BE A MINIMUM OF 28 (710) IN HEIGHT. WHEN CONES ARE BEING USED, THE "LEFT TURN LANE" SIGN MAY BE SKID MOUNTED AT A MINIMUM HEIGHT OF 5' (1.5 m).
2. STEADY BURNING LIGHTS WILL NOT BE REQUIRED ON BARRICADES OR DRUMS FOR DAY OPERATIONS. ALL LIGHTS SHALL BE MONODIRECTIONAL.
3. REFLECTORIZED TEMPORARY PAVEMENT MARKING TAPE SHALL BE PLACED THROUGHOUT THE BARRICADED AREA OF EACH TURN BAY WHERE THE CLOSURE TIME IS GREATER THAN FOURTEEN DAYS.
4. THIS APPLICATION ALSO APPLIES WHEN WORK IS BEING PERFORMED IN THE RIGHT LANE(S) AND THE RIGHT TURN BAY IS TO REMAIN OPEN. UNDER THIS CONDITION, "RIGHT TURN LANE" R3-100 24 x 24 (600 x 600) AND M6-2R 21 x 15 (530 x 380) SHALL BE USED.
5. THESE CONTROLS SHALL SUPPLEMENT MAINLINE TRAFFIC CONTROL FOR LANE CLOSURES.
6. LONGITUDINAL DIMENSIONS MAY BE ADJUSTED TO FIT FIELD CONDITIONS.
7. FORM BT 725 IS REQUIRED.
8. TRAFFIC CONTROL AND PROTECTION AT TURN BAYS (TO REMAIN OPEN TO TRAFFIC) SHALL BE INCLUDED IN THE COST SPECIFIED TRAFFIC CONTROL STANDARDS OR ITEMS.

**LEGEND**

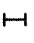
-  WORK AREA
-  LANE OPEN TO TRAFFIC
-  TYPE I OR II BARRICADE WITH STEADY BURN LIGHT
-  DRUM WITH STEADY BURN LIGHT
-  DRUM WITH SIGN (WITH OPTIONAL FLASHING LIGHT) SEE DETAIL
-  TYPE I OR II CHECK BARRICADE WITH FLASHING LIGHT

All dimensions are in millimeters (Inches) unless otherwise shown.

REVISIONS	
NAME	DATE
T. RAMMACHER	09/08/94
A. HOUSEH	11/07/95
A. HOUSEH	10/12/96
T. RAMMACHER	01/06/00

ILLINOIS DEPARTMENT OF TRANSPORTATION  
**TRAFFIC CONTROL AND PROTECTION AT TURN BAYS (TO REMAIN OPEN TO TRAFFIC)**

SCALE: NONE  
 DATE: 2/3/2007  
 DRAWN BY  
 CHECKED BY LHA

PLOT DATE = 2/3/2007  
 FILE NAME = \\n\dstated\cal\4.dgn  
 PLOT SCALE = 48.0000 / IN.  
 USER NAME = BHWKSL

F.A.P. SECTION	COUNTY	TOTAL SHEETS	SHEET NO.
100 104RS-B	McHenry	22	21
STA. TO STA.			
FED. ROAD DIST. NO.		ILLINOIS FED. AID PROJECT	

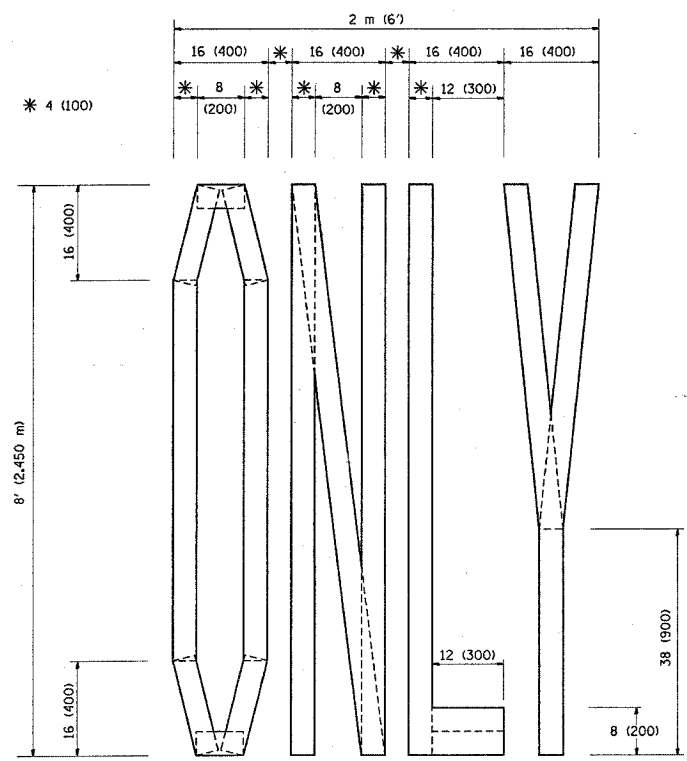

QUANTITY  
4 (100) LINE = 64.1 ft. (19.7 m)  
21.1 sq. ft. (1.97 sq. m)

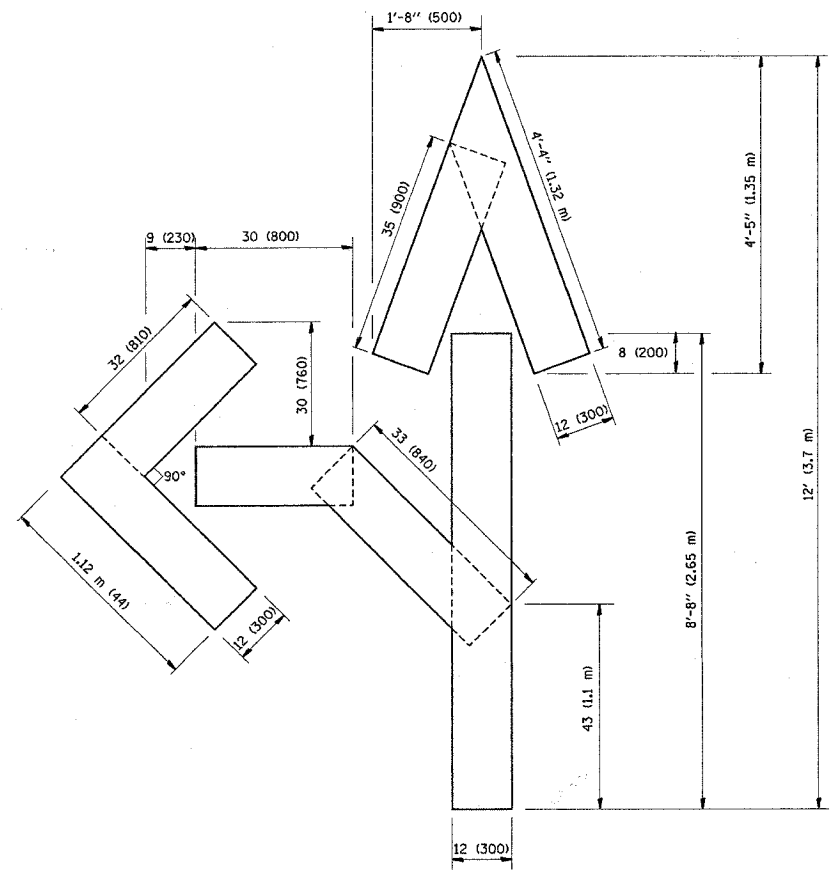

QUANTITY  
4 (100) LINE = 82.5 ft. (25.3 m)  
27.5 sq. ft. (2.53 sq. m)

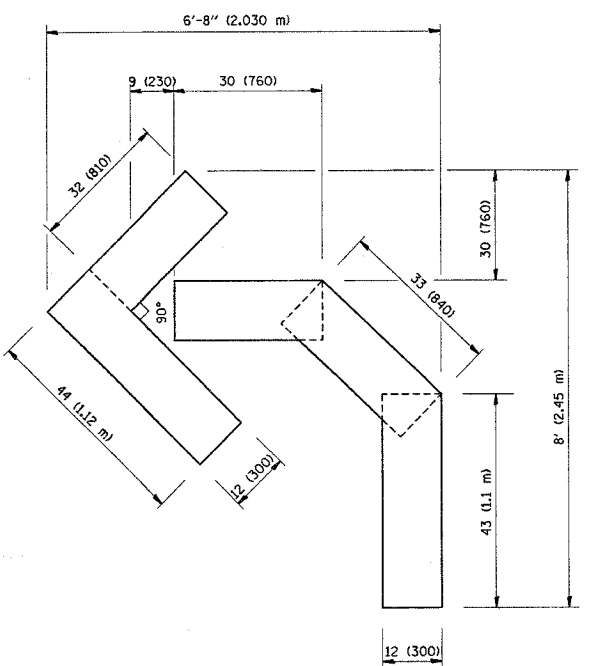

QUANTITY  
4 (100) LINE = 45.5 ft. (13.9 m)  
15.2 sq. ft. (1.39 sq. m)

All dimensions are in millimeters (inches) unless otherwise shown.

REVISIONS	
NAME	DATE
T. RAMMACHER	09/18/94
J. OBERLE	06/01/96
T. RAMMACHER	06/05/96
T. RAMMACHER	11/04/97
T. RAMMACHER	03/02/98
E. GOMEZ	08/28/00

ILLINOIS DEPARTMENT OF TRANSPORTATION

**PAVEMENT MARKING  
LETTERS AND SYMBOLS  
FOR TRAFFIC STAGING**

SCALE: NONE  
DATE: 2/3/2007

DRAWN BY CADD  
CHECKED BY

TC-16  
REVISION DATE: 08/28/00

PLT DATE = 2/3/2007  
FILE NAME = 104RS-B.dgn  
PLOT SCALE = 49.9999 / IN.  
USER NAME = BARKSL

F.A.P. SECTION	COUNTY	TOTAL SHEETS	SHEET NO.
100 104RS-8	McHenry	22	22
STA. TO STA.			
FED. ROAD DIST. NO.		ILLINOIS	FED. AID PROJECT

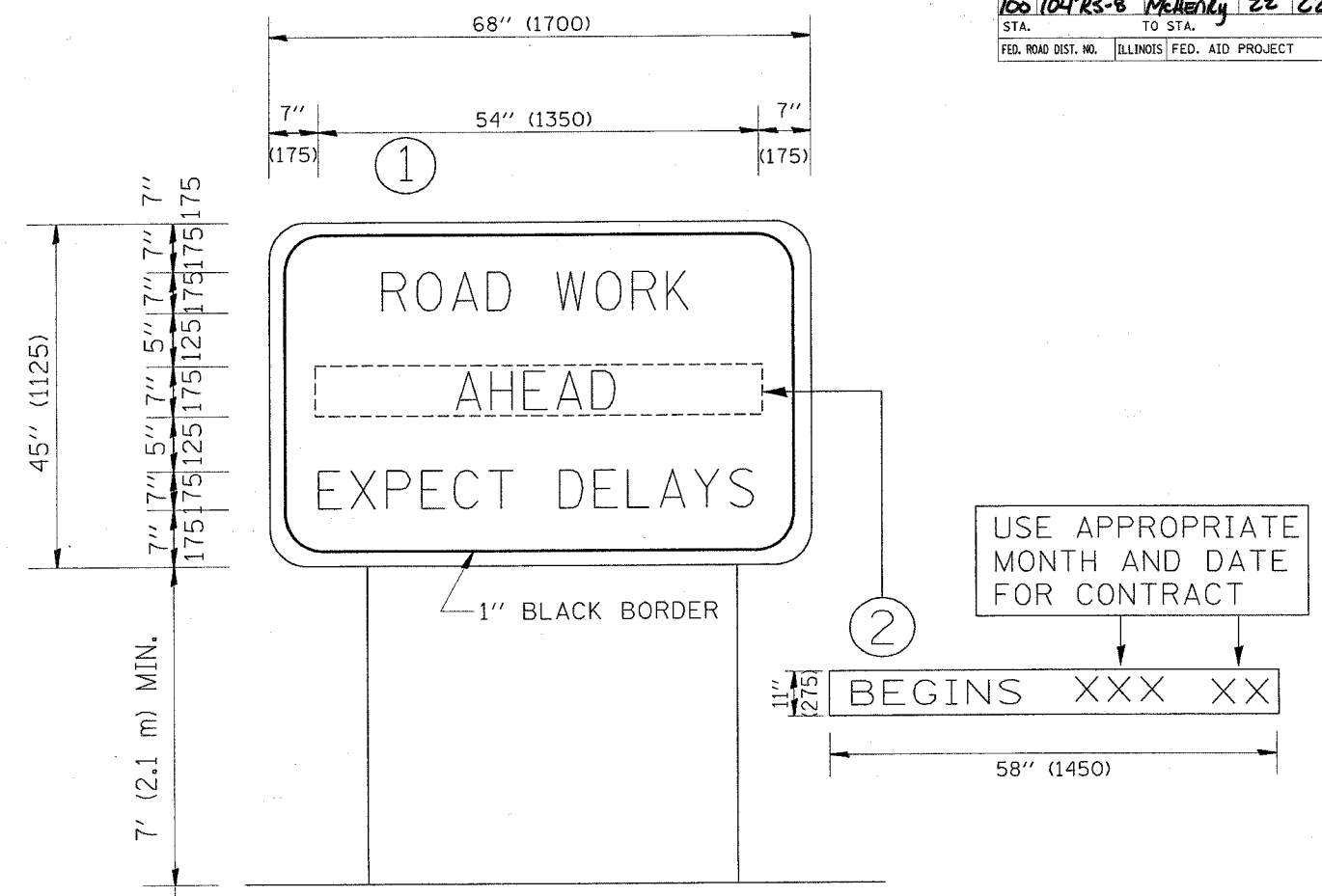

NOTES:

1. USE BLACK LETTERING ON ORANGE BACKGROUND.
2. ERECT SIGNS IN ADVANCE OF THE LOCATION FOR THE "ROAD CONSTRUCTION AHEAD" SIGN AT LOCATIONS AS DIRECTED BY THE ENGINEER.
3. ERECT SIGN ① WITH INSTALLED PANEL ② ONE WEEK PRIOR TO THE START OF CONSTRUCTION.
4. REMOVE PANEL ② SOON AFTER THE START OF CONSTRUCTION.
5. SEE SPECIAL PROVISION FOR "TEMPORARY INFORMATION SIGNING" FOR ADDITIONAL INFORMATION.
6. ONE SIGN ASSEMBLY EQUALS 25.70 SQ. FT. (2.3 SQ. M.)

ALL DIMENSIONS ARE IN MILLIMETERS (INCHES) UNLESS OTHERWISE SHOWN.

REVISIONS	
NAME	DATE
R. MIRS	9-15-97
R. MIRS	12-11-97
T. RAMMACHER	2-2-99

ILLINOIS DEPARTMENT OF TRANSPORTATION  
 TEMPORARY INFORMATION SIGNING  
 SCALE: DRAWN BY DESIGN  
 DATE: 2/3/2007 CHECKED BY  
 TC22  
 REVISION DATE: 02/02/99