

| | | | | |
|---------------------|-----------|------------------|--------------|-----------|
| F.A.I. RTE. | SECTION | COUNTY | TOTAL SHEETS | SHEET NO. |
| 80/94 | 2003-089I | COOK | 88 | 84 |
| STA. | TO STA. | | | |
| FED. ROAD DIST. NO. | ILLINOIS | FED. AID PROJECT | | |

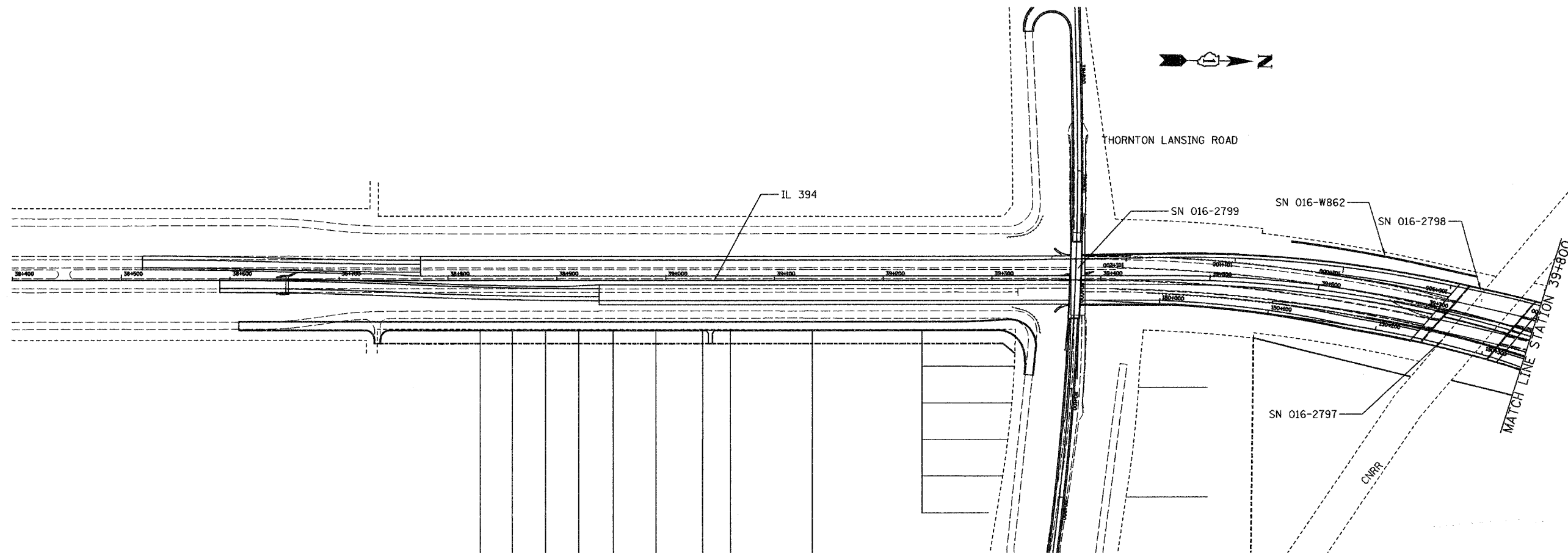

FOR INFORMATION ONLY

| REVISIONS | |
|-----------|------|
| NAME | DATE |
| | |
| | |
| | |
| | |
| | |

ILLINOIS DEPARTMENT OF TRANSPORTATION
I-80/94/US 6 (KINGERY EXPRESSWAY)
ROADWAY LIGHTING
AND TRAFFIC SURVEILLANCE

STRUCTURE LOCATION PLAN
STA. 38+400 TO 39+800

SCALE 1:2000 DRAWN BY ACE/CAD
DATE 12/03 CHECKED BY TJW

AMERICAN
CONSULTING ENGINEERS