

F.A.P. RTE.	SECTION	COUNTY	TOTAL SHEETS	SHEET NO.
549	117BR-M	Ogle	15	5
STA. TO STA.		FED. ROAD DIST. NO. ILLINOIS FED. AID PROJECT		

Traffic Control Plan

Stage I

Refer to Traffic Control & Protection Std 701321 for additional requirements.

Proposed Sequence of Operations

1. Install Stage I Std 701321
2. Build Stage I Deck Overlay and Bridge Rail
3. Remove Barrier Wall and Install Stage I Std 701316
4. Construct Furnished Excavation, Guardrail, and Temporary Ramps
5. Remove Std 701316 and Install Std 701321 for Stage II
6. Build Stage II Deck Overlay and Guardrail
7. Remove Barrier Wall and Install Stage II Std 701316
8. Construct Furnished Excavation, Guardrail, and Temporary Ramps
9. Remove Standard 701316
10. Complete Project using Standard 701201

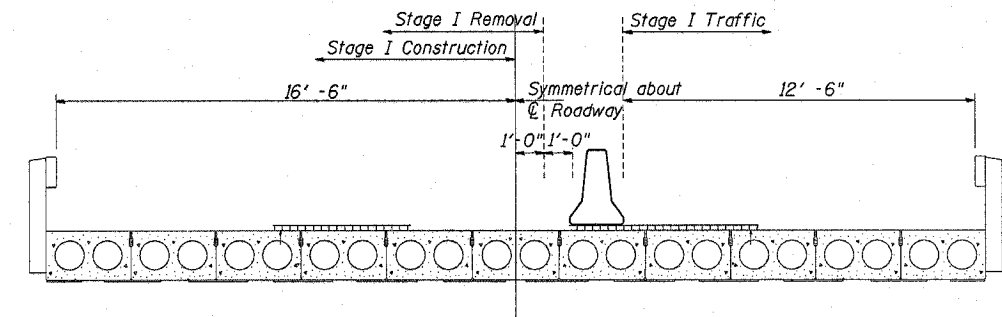

CROSS SECTION
(Looking East)

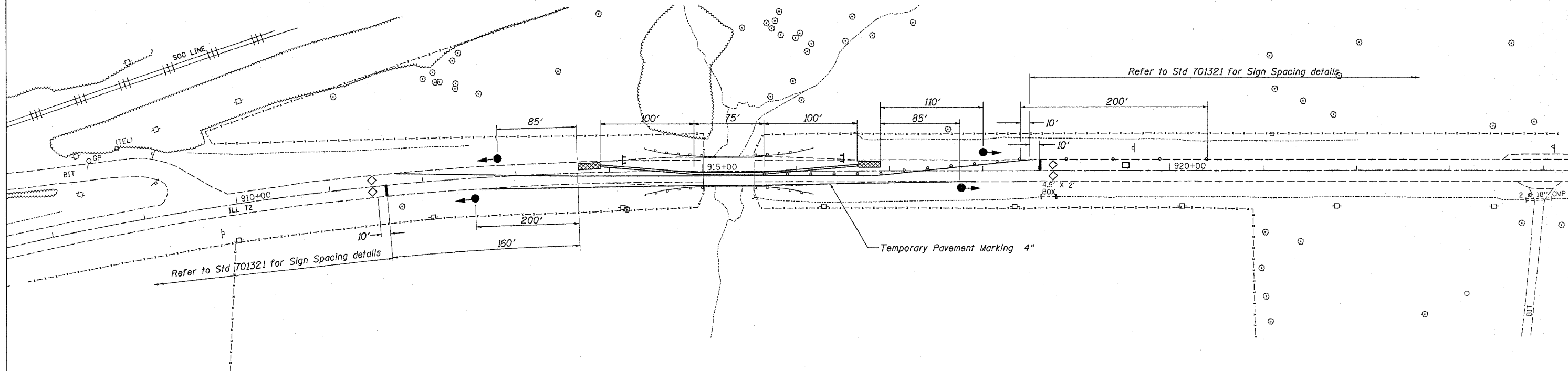

Temporary Bridge Traffic Signals	
Standard 701321	Each
1	1
Total	1

Temporary Concrete Barrier	
Standard 701321	Foot
275	275
Total	275

Pavement Marking Tape, Type III 24"	
Stop Bars	Foot
24	24
Total	24

Short Term Pavement Marking	
Post Stage II	Foot
64	64
Total	64

Traffic Control & Protection Std 701321	
Entire Project	Each
1	1
Total	1

Temporary Impact Attenuators	
Standard 701321	Each
2	2
Total	2

Temporary Pavement Marking 4"	
Sta 912+05 to 918+50 Stage I	Foot
1290	1290
Sta 912+05 to 918+50 Stage II	1290
Total	2580

Pavement Marking Removal	
Stage I	Sq Ft
100	100
Stage II	50
Total	150

Traffic Control Plan
Illinois Route 72 over Tributary to Mud Creek
FAP Route 549
Section 117BR-M
Ogle County
Structure No. 071-0068

PLOT DATE: Mon Jan 22 14:06:29 2007
 FILE NAME: D:\b\cadd\plans\ogle\county\0710068\0710068.dgn
 SCALE: 1/8"=1'-0"
 USER: NAME: J. LINDSEY