

F.A.P. RTE.	SECTION	COUNTY	TOTAL SHEETS	SHEET NO.
549	117BR-M	Ogle	15	6
STA. _____ TO STA. _____		FED. ROAD DIST. NO. ILLINOIS FED. AID PROJECT		

Traffic Control Plan

Stage II

Refer to Traffic Control & Protection Std 701321 for additional requirements.

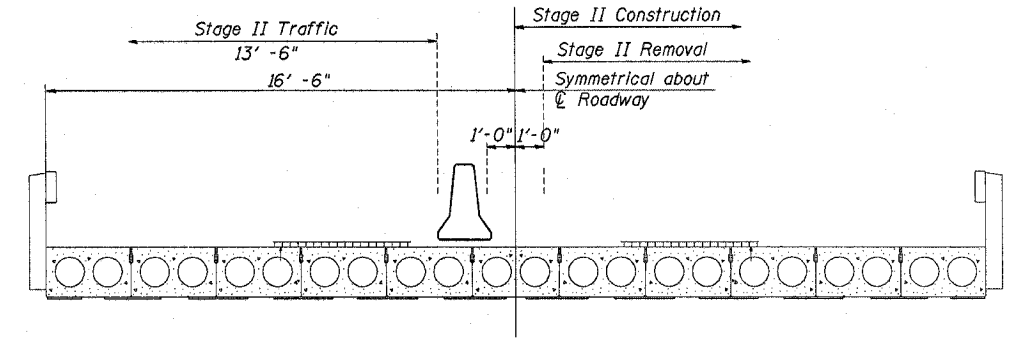

CROSS SECTION
(Looking East)

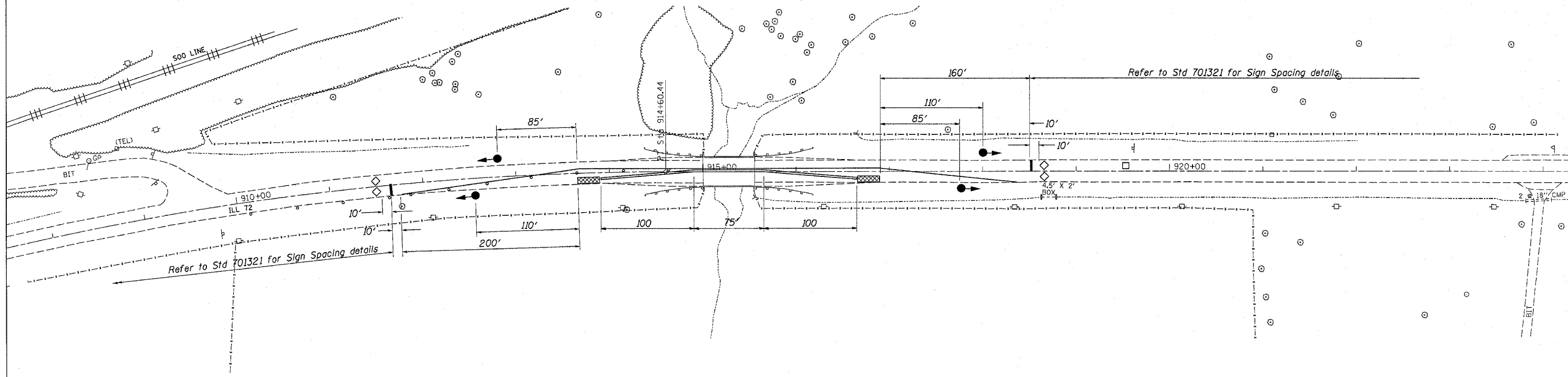

Relocate Temporary Concrete Barrier	
	Foot
Temporary Storage between Stages	275
Stage II	275
Total	550

Workzone Pavement Marking Removal	
	Sq Ft
Stage II	35
Post Stage II	452
Stop Bars	48
Total	150

Relocate Temporary Impact Attenuators	
	Each
Stage II	2
Total	2

Traffic Control Plan
Illinois Route 72 over Tributary to Mud Creek
FAP Route 549
Section 117BR-M
Ogle County
Structure No. 071-0068

PLOT DATE = Mon Jan 22 14:05:51 2007
 FILE NAME = D:\B\CAD\p1\m10g1e\County\0710068\0710068.dgn
 SCALE = 1/8"=1'-0"
 USER NAME = jtracy