

STATE OF ILLINOIS
DEPARTMENT OF TRANSPORTATION

ROUTE NO.	SECTION	COUNTY	TOTAL SHEETS	SHEET NO.	SHEET NO. 4 8 SHEETS
U.S. 20	(177-2B)M	STEPHENSON COUNTY	11	6	
FED. ROAD DIST. NO. 7	ILLINOIS	FED. AID PROJECT-			

CONTRACT # 64001

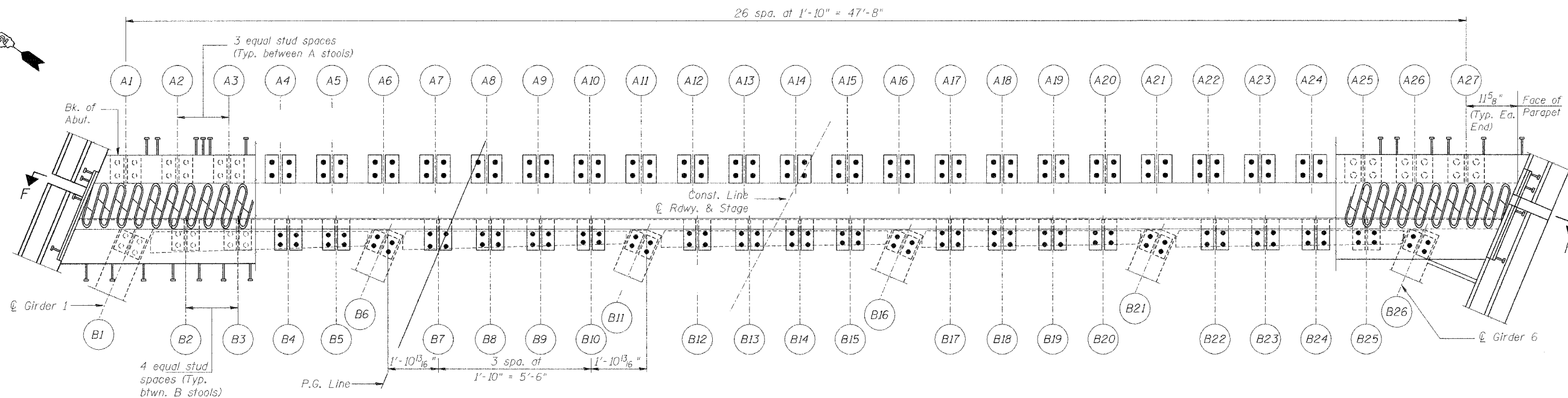

PLAN

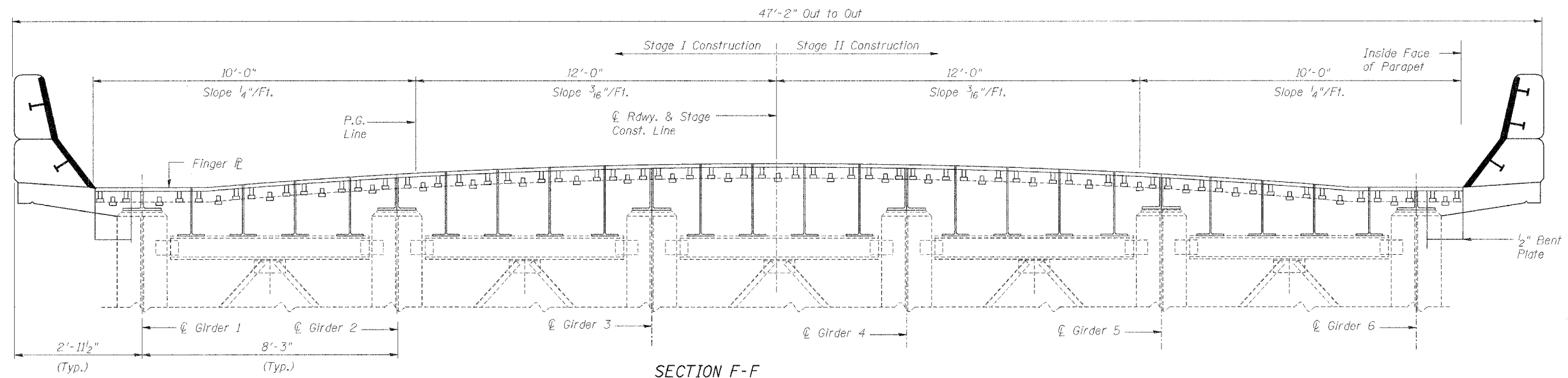

SECTION F-F

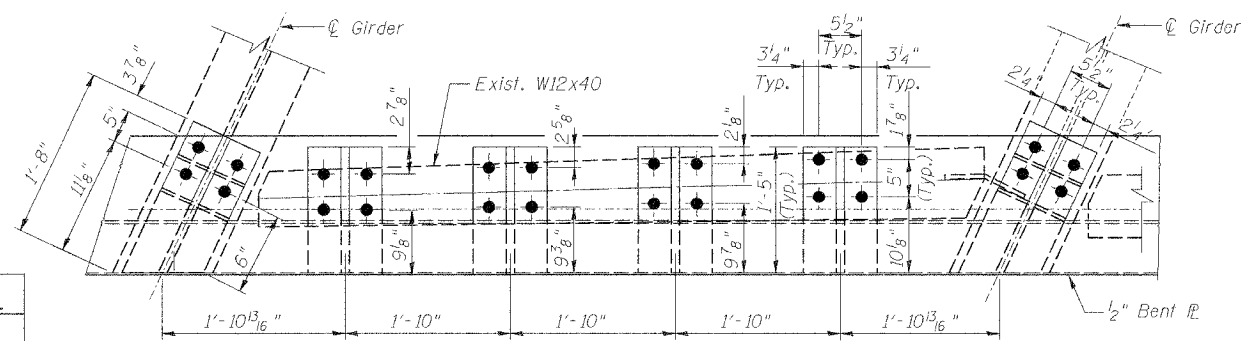

PLAN
(Showing Stool Layout Span Side)

DESIGNED	M.R./R.A.
CHECKED	H.T.
DRAWN	J.S.P.
CHECKED	H.T./M.R.

JOINT DETAILS - 2 OF 2

US 20 OVER PECATONICA RIVER
FAP ROUTE 301 (US20), SECTION (177-2B)M
STEPHENSON COUNTY
STATION 539+14.00
STRUCTURE NO. 089-0045

SCALE: NONE DATE: JANUARY, 2007

Soodan
Soodan & Associates, Inc.
100 North LaSalle Street, Suite 1800
Chicago, Illinois 60602