

F.A.I. RTE.	SECTION	COUNTY	TOTAL SHEETS	SHEET NO.
55		McLEAN	87	33
STA. 36+305		TO STA. 37+00		
FED. ROAD DIST. NO.		ILLINOIS FED. AID PROJECT		

• (57-4)RS-3 & I

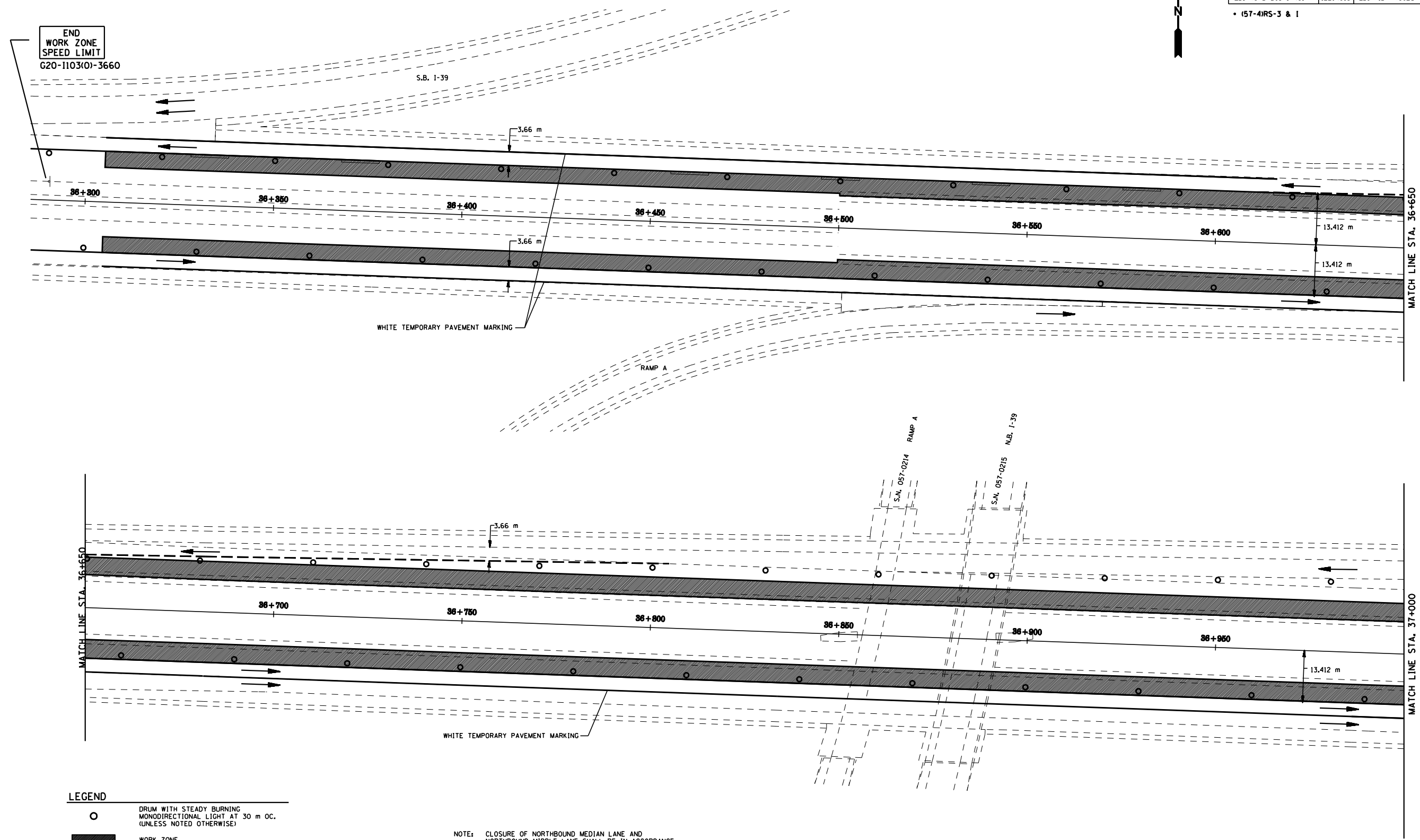

END
WORK ZONE
SPEED LIMIT
G20-1103(O)-3660

S.B. 1-39

WHITE TEMPORARY PAVEMENT MARKING

RAMP A

S.N. 057-0214
RAMP A

S.N. 057-0215
N.B. 1-39

LEGEND

- DRUM WITH STEADY BURNING MONODIRECTIONAL LIGHT AT 30 m OC. (UNLESS NOTED OTHERWISE)
- ▨ WORK ZONE
- TRAFFIC

NOTE: CLOSURE OF NORTHBOUND MEDIAN LANE AND NORTHBOUND MIDDLE LANE SHALL BE IN ACCORDANCE WITH HIGHWAY STANDARD 701446 AND 701400 THE TAPER TO BEGIN THE MEDIAN LANE CLOSURE SHALL BEGIN AT STA. 34+950

STAGE CONSTRUCTION DETAILS - STAGE 1
F.A.I. 55
SECTION (57-4)RS-3 & I
MCLEAN COUNTY