

F.A.I. RTE.	SECTION	COUNTY	TOTAL SHEETS	SHEET NO.
55		McLEAN	87	36
STA. 38+400		TO STA. 39+100		
FED. ROAD DIST. NO.		ILLINOIS FED. AID PROJECT		

• (57-4)RS-3 & I

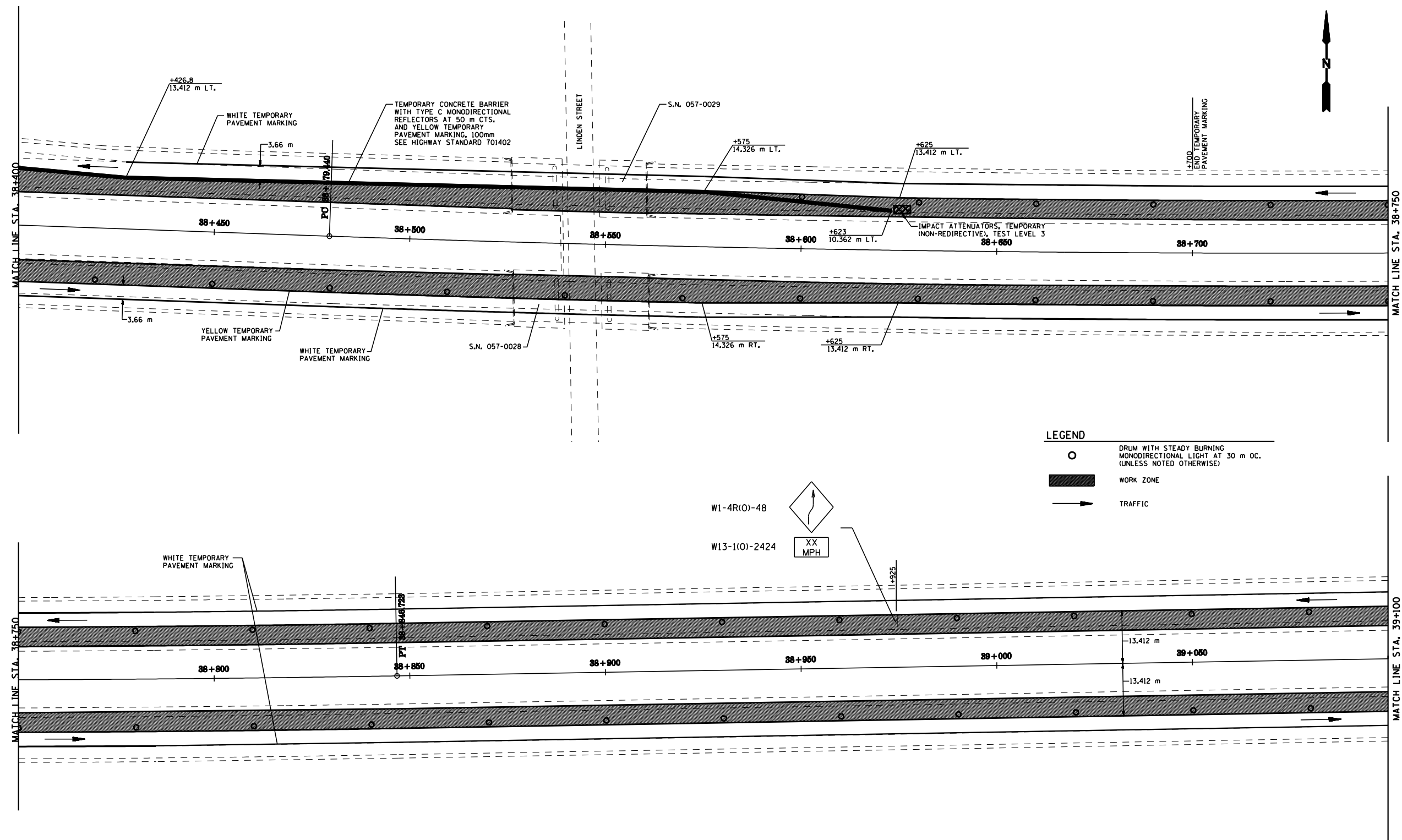

**LEGEND**

○	DRUM WITH STEADY BURNING MONODIRECTIONAL LIGHT AT 30 m OC. (UNLESS NOTED OTHERWISE)
■	WORK ZONE
→	TRAFFIC

STAGE CONSTRUCTION DETAILS - STAGE 1  
 F.A.I. 55  
 SECTION (57-4)RS-3 & I  
 McLEAN COUNTY