

F.A.I. RTE.	SECTION	COUNTY	TOTAL SHEETS	SHEET NO.
55		McLEAN	87	44
STA. 39+800		TO STA. 40+486		
FED. ROAD DIST. NO.		ILLINOIS	FED. AID PROJECT	

• (57-4)RS-3 & I

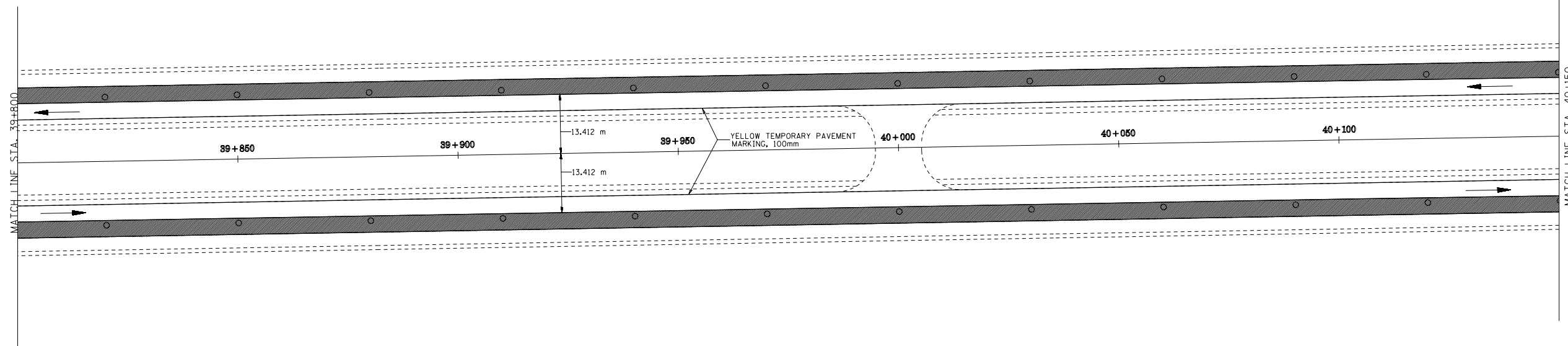

NOTE: CLOSURE OF THE SOUTHBOUND LANE SHALL BE IN ACCORDANCE WITH HIGHWAY STANDARD 701401. THE TAPER FOR THE LANE CLOSURE SHALL BEGIN AT STA. 43+000. HIGHWAY STANDARD 701411 SHALL BE USED AT THE ENTRANCE FROM BUSINESS 55 TO I55. THE MEDIAN LANE DEVELOPED AND DROPPED THROUGH BUSINESS 55 INTERCHANGE SHALL BE CLOSED WITH DRUMS WITH STEADY BURNING LIGHTS AT 30 m CENTERS.

LEGEND

- DRUM WITH STEADY BURNING MONODIRECTIONAL LIGHT AT 30 m OC. (UNLESS NOTED OTHERWISE)
- WORK ZONE
- TRAFFIC

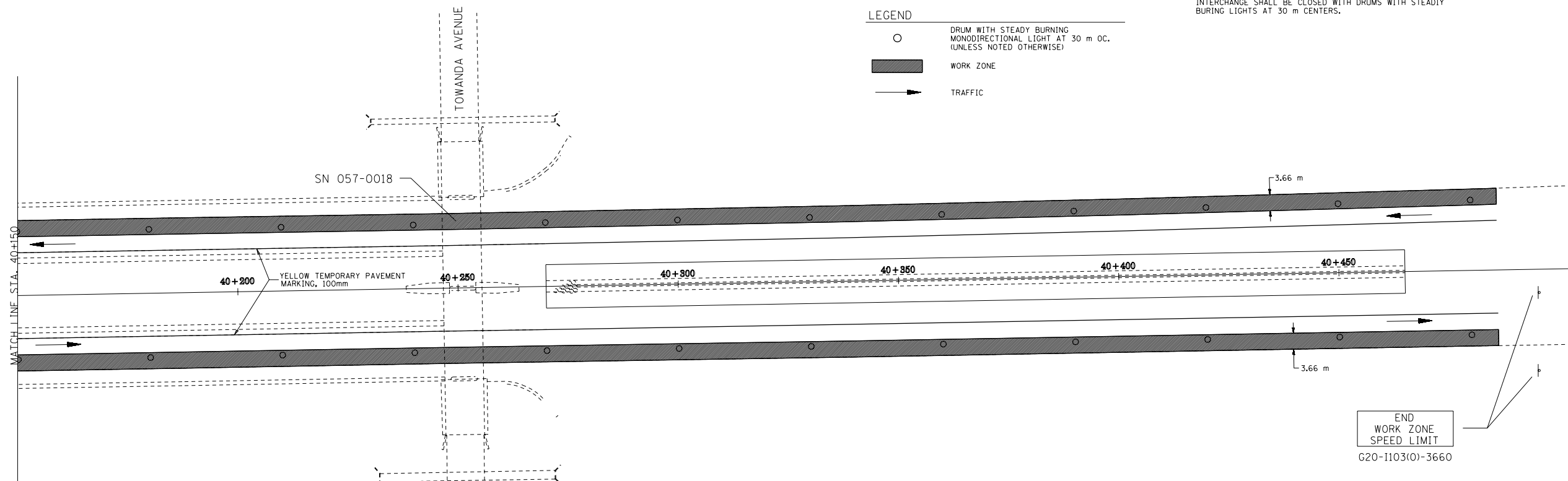

STAGE CONSTRUCTION DETAILS - STAGE 2
 F.A.I. 55
 SECTION (57-4)RS-3 & I
 McLEAN COUNTY