

| | | | | |
|---------------------|----------------|----------------------|------|-----------|
| ROUTE NO. | SECTION | COUNTY | DATE | SHEET NO. |
| FAI 55 | | McLEAN | 07 | 61 |
| 10A SHEETS | | | | |
| FED. ROAD DIST. NO. | ILL. PROJ. NO. | FED. AID PROJECT NO. | | |

• (57-4)RS-3 & 1

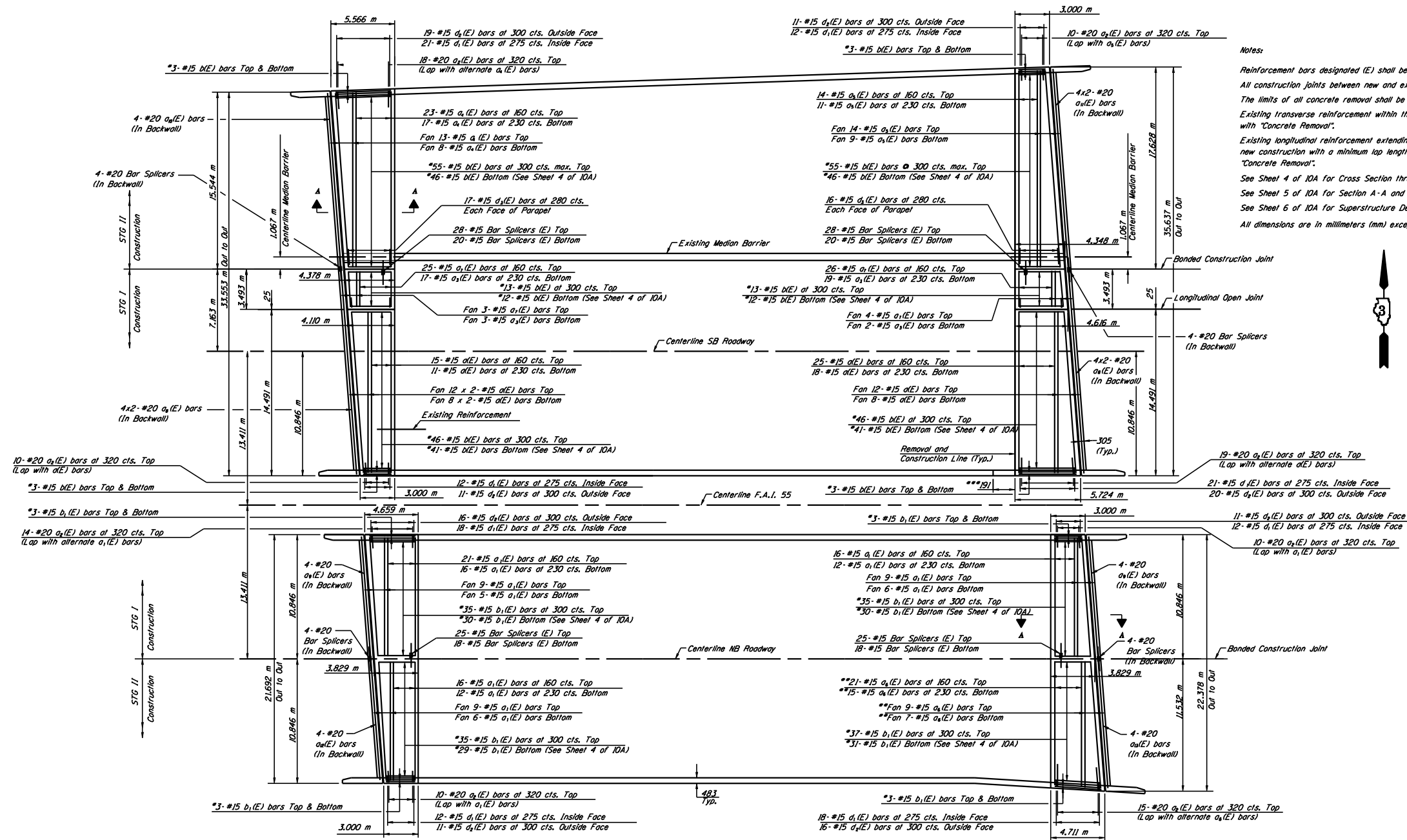

Notes:
 Reinforcement bars designated (E) shall be epoxy coated.
 All construction joints between new and existing construction shall be Banded Construction Joints.
 The limits of all concrete removal shall be saw cut 20 mm into concrete.
 Existing transverse reinforcement within the removal area shall be cut off flush with the removal line. Cost included with "Concrete Removal".
 Existing longitudinal reinforcement extending into removed areas shall be cleaned, straightened and incorporated into the new construction with a minimum lap length of 610 mm except as noted. Cost included with "Concrete Removal".
 See Sheet 4 of 10A for Cross Section thru deck.
 See Sheet 5 of 10A for Section A-A and Silicone Joint Sealer Details.
 See Sheet 6 of 10A for Superstructure Details, Parapet Reinforcement, Bar Details and Bill of Material.
 All dimensions are in millimeters (mm) except as noted.



PLAN-DECK REINFORCEMENT

| | |
|----------|-----|
| DESIGNED | GAE |
| CHECKED | JDA |
| DRAWN | NO |
| CHECKED | GAE |

* Cut to fit. Use remainder in opposite Staged corner.
 Lap to existing reinforcement.
 ** Cut to fit.
 *** See sheet 6 of 10A for Exterior Parapet Elevation Joint Detail.

MIN. BAR LAP
 #15 bars = 50

SUPERSTRUCTURE PLAN
F.A.I. 55 OVER BUSINESS U.S. 51
SECTION (57-4)RS-3 & 1
McLEAN COUNTY
SN 057-0024 (NB)
SN 057-0025 (SB)
STA. 37+474.206