

ROUTE NO.	SECTION	COUNTY	DATE	SHEET NO.
FAI 55		MCLEAN	07	71
14A SHEETS				
FED. ROAD DIST. NO. 7	ILL. PROJ. NO.	FED. AID PROJECT NO.		

• (57-4)RS-3 & I

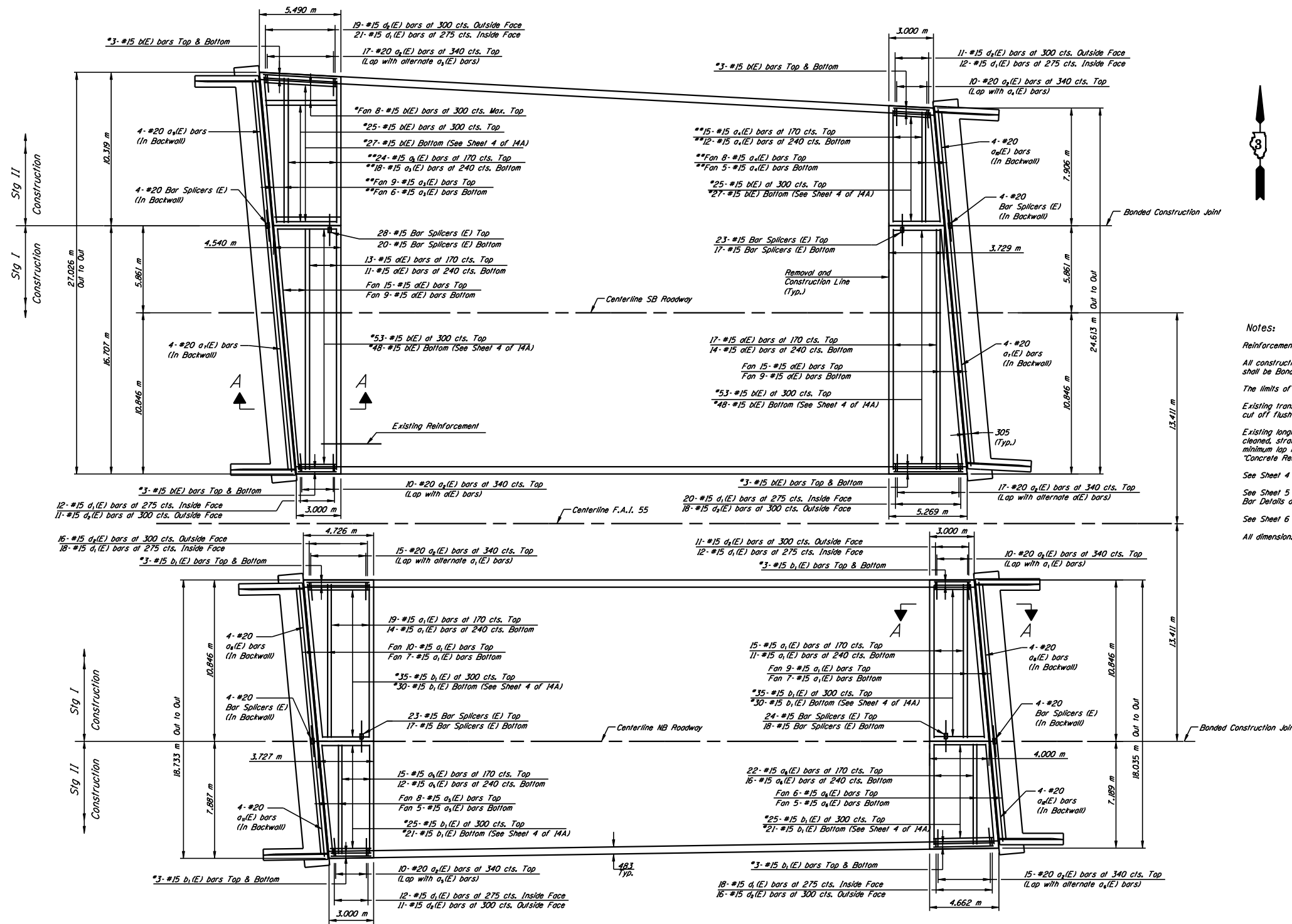

**Notes:**

Reinforcement bars designated (E) shall be epoxy coated.

All construction joints between new and existing construction shall be Banded Construction Joints.

The limits of all concrete removal shall be cut 20 mm into concrete.

Existing transverse reinforcement within the removal area shall be cut off flush with the removal line. Cost included with "Concrete Removal".

Existing longitudinal reinforcement extending into removed areas shall be cleaned, straightened and incorporated into the new construction with a minimum lap length of 610 mm except as noted. Cost included with "Concrete Removal".

See Sheet 4 of 14A for Cross Section thru deck.

See Sheet 5 of 14A for Superstructure Details, Parapet Reinforcement, Bar Details and Bill of Material.

See Sheet 6 of 14A for Section A-A.

All dimensions are in millimeters (mm) except as noted.

PLAN-DECK REINFORCEMENT

DESIGNED	GAE
CHECKED	JDA
DRAWN	NO
CHECKED	GAE

\* Cut to fit. Use remainder in opposite Staged corner. Lap to existing reinforcement.

\*\* Cut to fit.

MIN. BAR LAP  
#15 bars = 510

**DECK REPAIR**  
**F.A.I. 55 OVER CONSTITUTION TRAIL**  
**SECTION (57-4)RS-3 & I**  
**MCLEAN COUNTY**  
**SN 057-0026 (NB)**  
**SN 057-0027 (SB)**  
**STA. 38+263.167**