

F.A.P. RTE.	SECTION	COUNTY	TOTAL SHEETS	SHEET NO.
714	(135)RS-6,TS	CHRISTIAN	47	37
STA.		TO STA.		
FED. ROAD DIST. NO.	ILLINOIS	FED. AID PROJECT		

LEGEND

- ① THERMOPLASTIC PAVEMENT MARKING - LINE 5"
- ② THERMOPLASTIC PAVEMENT MARKING - LINE 8"
- ③ THERMOPLASTIC PAVEMENT MARKING - LINE 12"
- ④ PREFORMED PLASTIC PAVEMENT MARKING, TYPE B - LINE 6"
- ⑤ PREFORMED PLASTIC PAVEMENT MARKING, TYPE B - LINE 24"
- ⑥ PREFORMED PLASTIC PAVEMENT MARKING, TYPE B - LETTERS AND SYMBOLS

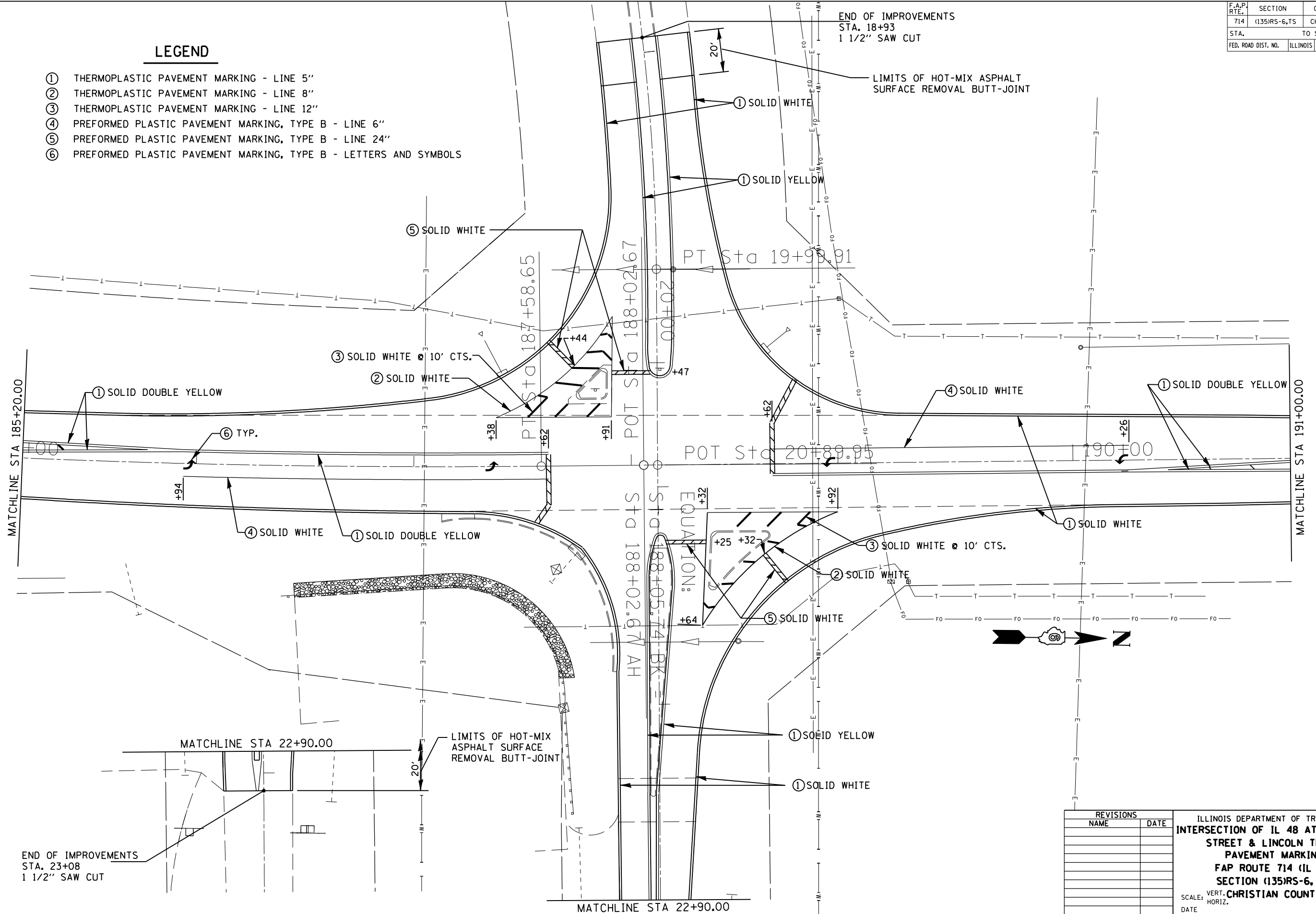

REVISIONS	
NAME	DATE

ILLINOIS DEPARTMENT OF TRANSPORTATION
INTERSECTION OF IL 48 AT E. MAIN CROSS STREET & LINCOLN TRAIL ROAD
PAVEMENT MARKING
FAP ROUTE 714 (IL 48)
SECTION (135)RS-6, TS
CHRISTIAN COUNTY
 SCALE: VERT. _____ DRAWN BY _____
 HORIZ. _____ CHECKED BY _____
 DATE _____

PLOT DATE = \$DATE\$
 FILE NAME = \$FILEL\$
 PLOT SCALE = \$SCALE\$
 USER NAME = \$USER\$