

F.A.P. RTE.	SECTION	COUNTY	TOTAL SHEETS	SHEET NO.
753	25 RS-B, I-2	MORGAN	26	18
STA.		TO STA.		
FED. ROAD DIST. NO.	ILLINOIS	FED. AID PROJECT		

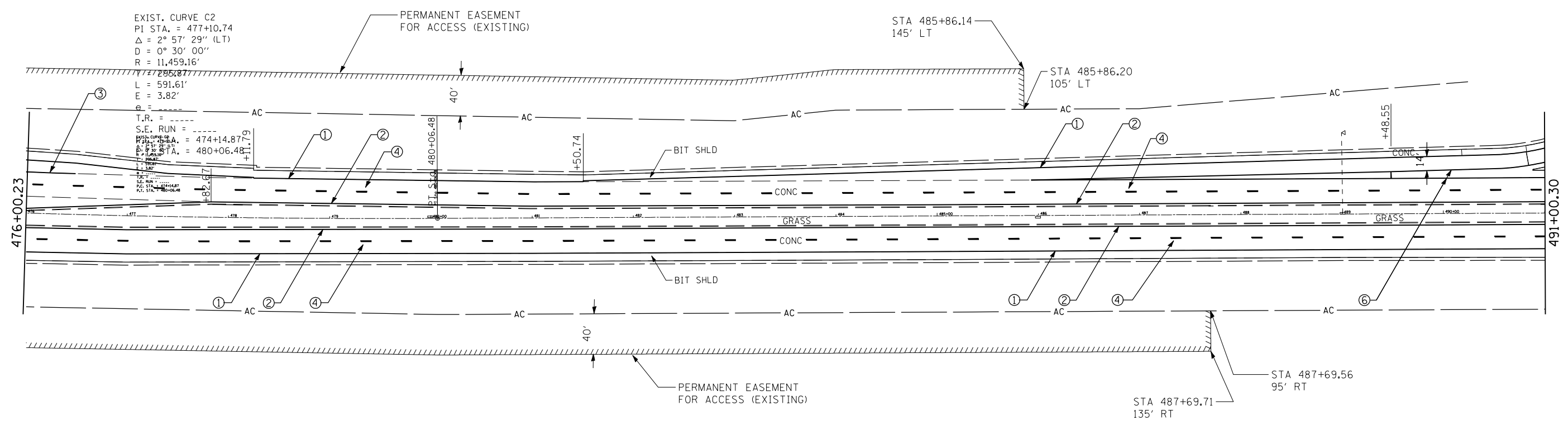

PROPOSED PAVEMENT MARKING

- ① PR POLYUREA PVMT MARKING, TY 1, 5" SOLID WHITE •
- ② PR POLYUREA PVMT MARKING, TY 1, 5" SOLID YELLOW •
- ③ PR PPPM, TY B, 6" SOLID WHITE
- ④ PR PPPM, TY B, 5" WHITE (SKIP DASH)
- ⑤ PR PPPM, TY B, 5" YELLOW (SKIP DASH)
- ⑥ PR PPPM, TY B, 8" SOLID WHITE
- ⑦ PR PPPM, TY B, LETTERS & SYMBOLS, WHITE
- ⑧ PR PPPM, TY B, 12" SOLID WHITE
- ⑨ PR PPPM, TY B, 24" SOLID WHITE

• NO EOP MARKINGS THROUGH SIDEROADS OR CROSSOVERS

REVISIONS	
NAME	DATE

ILLINOIS DEPARTMENT OF TRANSPORTATION

PAVEMENT MARKING PLAN
 FAP 753 SPUR (OLD US 36)
 AND FAS 1613

SCALE: VERT. _____
 HORIZ. _____

DATE: _____

DRAWN BY: CFC, CCA
 CHECKED BY: CCA

PLOT DATE = \$DATE\$
 FILE NAME = \$FILEL\$
 PLOT SCALE = \$SCALE\$
 USER NAME = \$USER\$