

F.A.I. RTE.	SECTION	COUNTY	TOTAL SHEETS	SHEET NO.
70	82-1,2,3,4RS-1	ST CLAIR	43	19
STA.		TO STA.		
FED. ROAD DIST. NO.		ILLINOIS	FED. AID PROJECT	

MATCHLINE A TO SHEET 18

MATCHLINE B TO SHEET 20

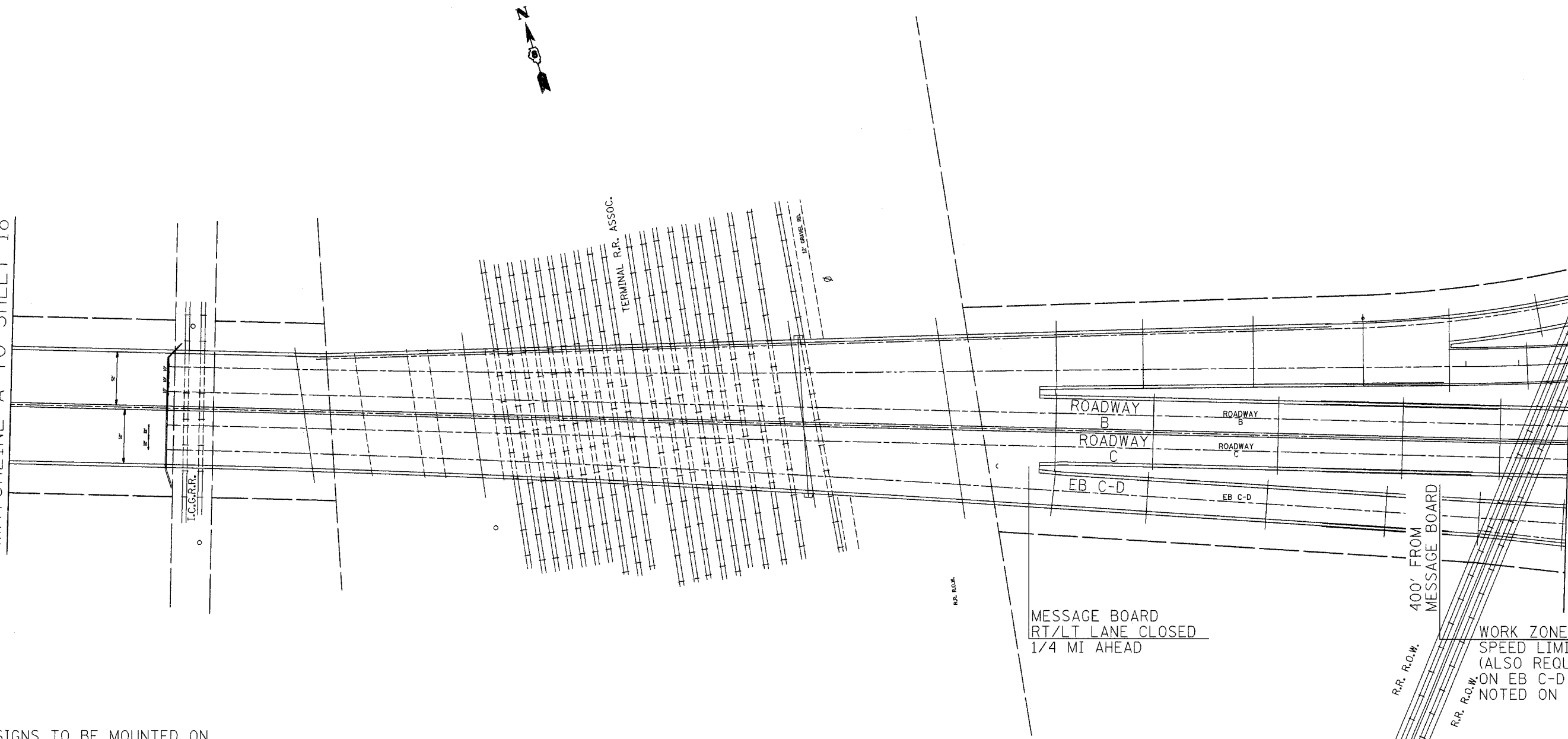

NOTE: SIGNS TO BE MOUNTED ON NEAREST EXISTING PARAPET SIGN BRACKET AVAILABLE OR CONTRACTOR SUPPLIED BRACKET, APPROVED BY THE ENGINEER, AT NO EXTRA COST.

PLOT DATE = 2/16/2007
 FILE NAME = c:\p07\104\1041387\plan\p1041387b.dgn
 PLOT SCALE = 1/8" = 1'-0"
 REFERENCE = #REF#

REVISIONS	
NAME	DATE

ILLINOIS DEPARTMENT OF TRANSPORTATION
TRAFFIC CONTROL
 FAI ROUTE 70
 SECTION 82-1,2,3,4RS-1
 ST CLAIR COUNTY

SCALE: VERT. _____
 HORIZ. _____
 DATE _____ DRAWN BY _____
 CHECKED BY _____