

F.A.I. RTE.	SECTION	COUNTY	TOTAL SHEETS	SHEET NO.
70	82-(1,2,3,4)RS-1	ST CLAIR	43	34
STA.		TO STA.		
FED. ROAD DIST. NO.	ILLINOIS FED. AID PROJECT			

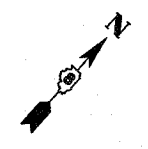
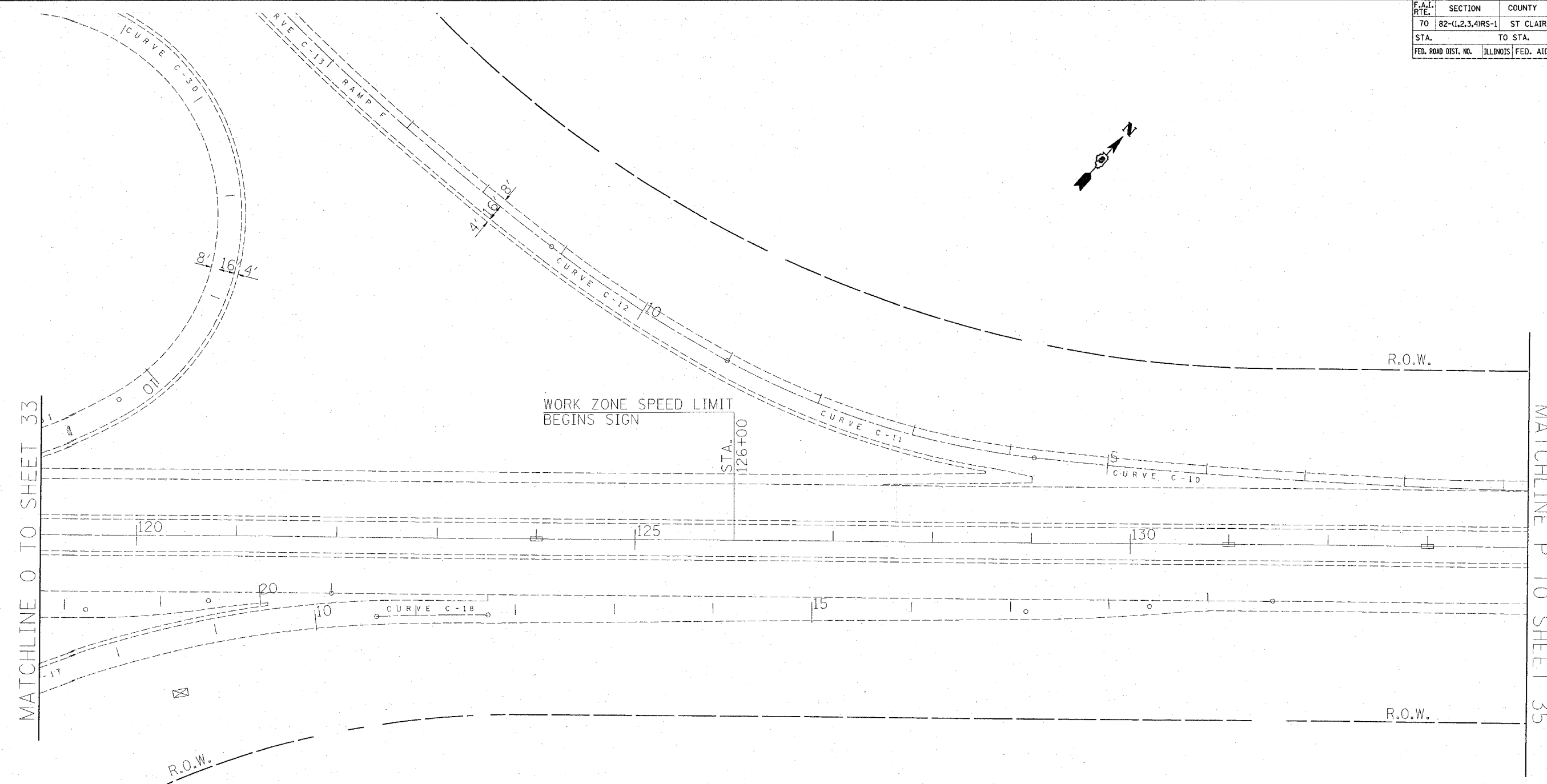

WORK ZONE SPEED LIMIT  
BEGINS SIGN

STA.  
126+00

MATCHLINE 0 TO SHEET 33

MATCHLINE P TO SHEET 35

NOTE: SIGNS SHOWN ON THIS SHEET MOVE EAST, DUE TO THE DIFFERENCES BETWEEN STD. 701401 AND STD. 701446, WHEN TWO LANE CLOSURE IS UTILIZED.

PLOT DATE = 2/15/2007  
FILE NAME = c:\proje\sta\84387\plan\plan84387b.dgn  
PLOT SCALE = 50.0000' / IN.  
REFERENCE = #REF#

REVISIONS	
NAME	DATE

ILLINOIS DEPARTMENT OF TRANSPORTATION  
**TRAFFIC CONTROL**  
FAI ROUTE 70  
SECTION 82-(1,2,3,4)RS-1  
ST CLAIR COUNTY

SCALE: VERT. DATE  
HORIZ. DRAWN BY  
CHECKED BY