

CONTRACT NO. #83853

F.A. RTE.	SECTION	COUNTY	TOTAL SHEETS	NO.
2585 97-00071-00-PV		COOK	116	17
STA.	TO STA.			
FED. ROAD DIST. NO.	ILLINOIS	FED. AID PROJECT		

PLUM GROVE RD.

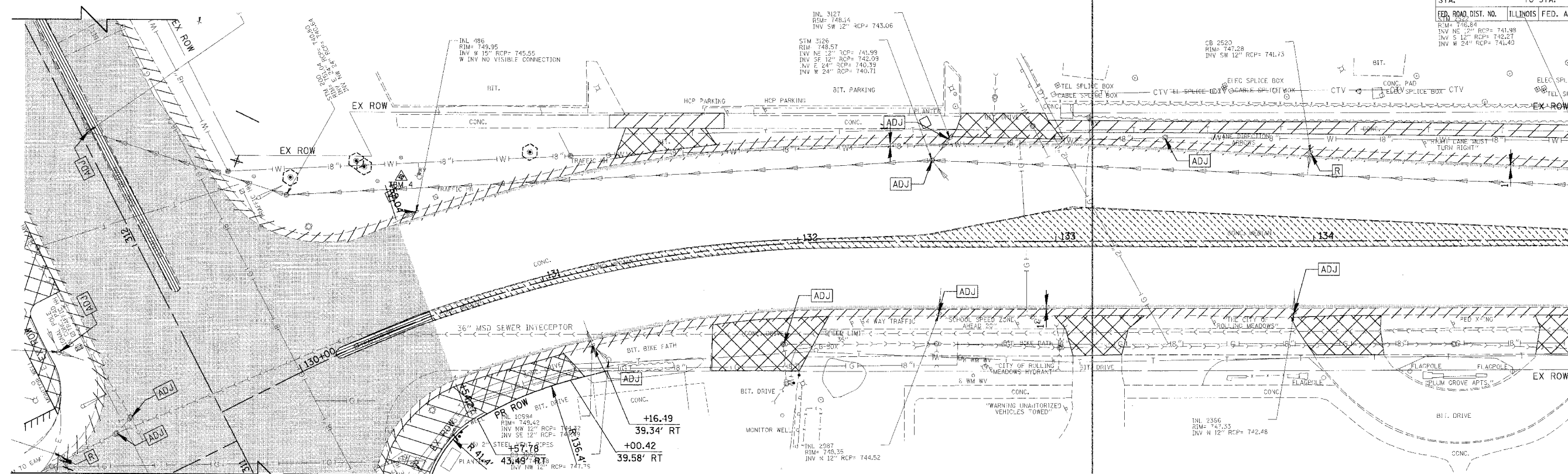

MATCH LINE STATION 135 + 00

PLUM GROVE RD.

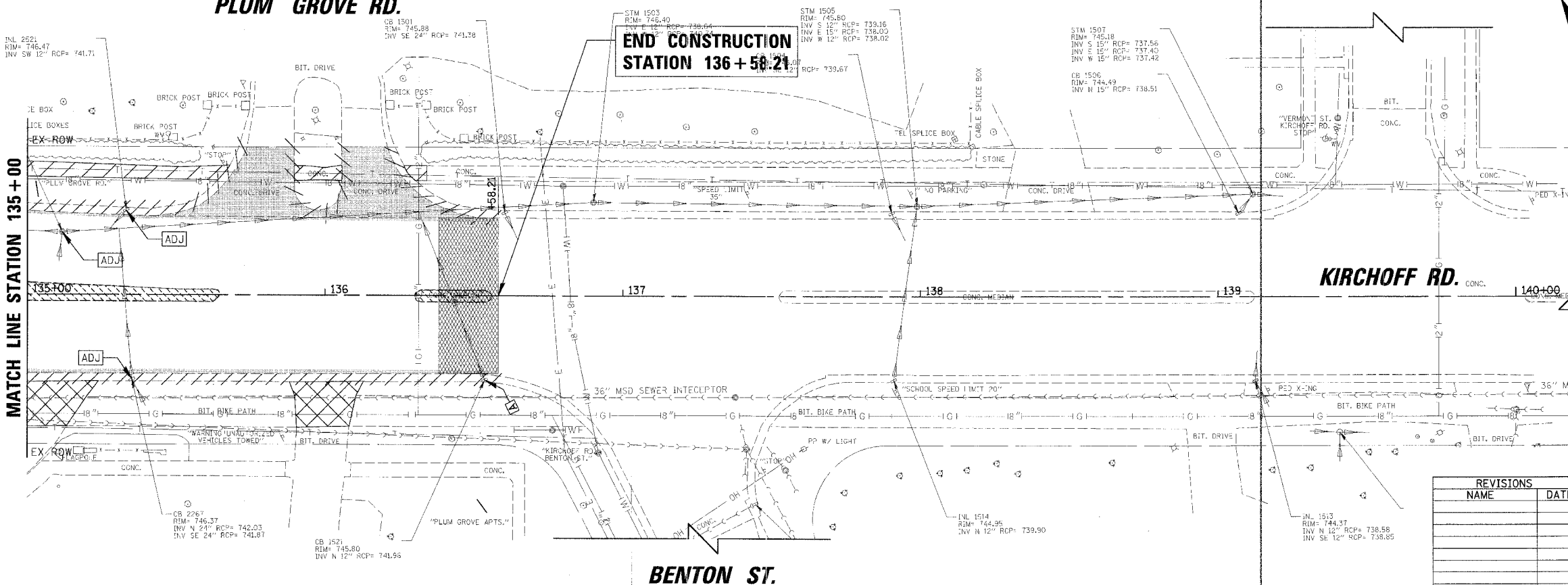

MATCH LINE STATION 135 + 00

END CONSTRUCTION
STATION 136 + 58.21

VERMONT ST.

KIRCHOFF RD.

BENTON ST.

LEGEND:

- PAVEMENT REMOVAL
- SHOULDER REMOVAL
- DRIVEWAY REMOVAL
- SIDEWALK REMOVAL
- MEDIAN REMOVAL
- COLD MILLING EX MEDIAN
- COMBINATION CURB & GUTTER REMOVAL
- STORM SEWER REMOVAL
- STRUCTURE REMOVAL
- STRUCTURE ADJUSTMENT
- FIRE HYDRANT TO BE REMOVED
- TREE REMOVAL
- CONC. SURFACE REMOVAL - BUTT JOINT
- TREE PROTECTION

REVISIONS	
NAME	DATE

ILLINOIS DEPARTMENT OF TRANSPORTATION
**KIRCHOFF ROAD
REMOVAL PLAN**
STATION 130+00 TO STATION 136+58.21

SCALE: 20'
DATE: 6/8/2006
DRAWN BY: PMM
CHECKED BY: MCW

PLAN SURVEYED
ADJUSTED
CHECKED
BY: [Signature]
DATE: [Date]

CHRISTOPHER B. BURKE ENGINEERING LTD.
9575 West Higgins Road, Suite 600
Rosemont, Illinois 60018
(847) 823-0500

PROFILE SURVEYED
ADJUSTED
CHECKED
BY: [Signature]
DATE: [Date]