

F.A. RTE.	SECTION	COUNTY	TOTAL SHEETS	SHEET NO.
2585 97-00071-00-PV		COOK	116	24
STA.	TO STA.			
FED. ROAD DIST. NO.	ILLINOIS FED. AID PROJECT			

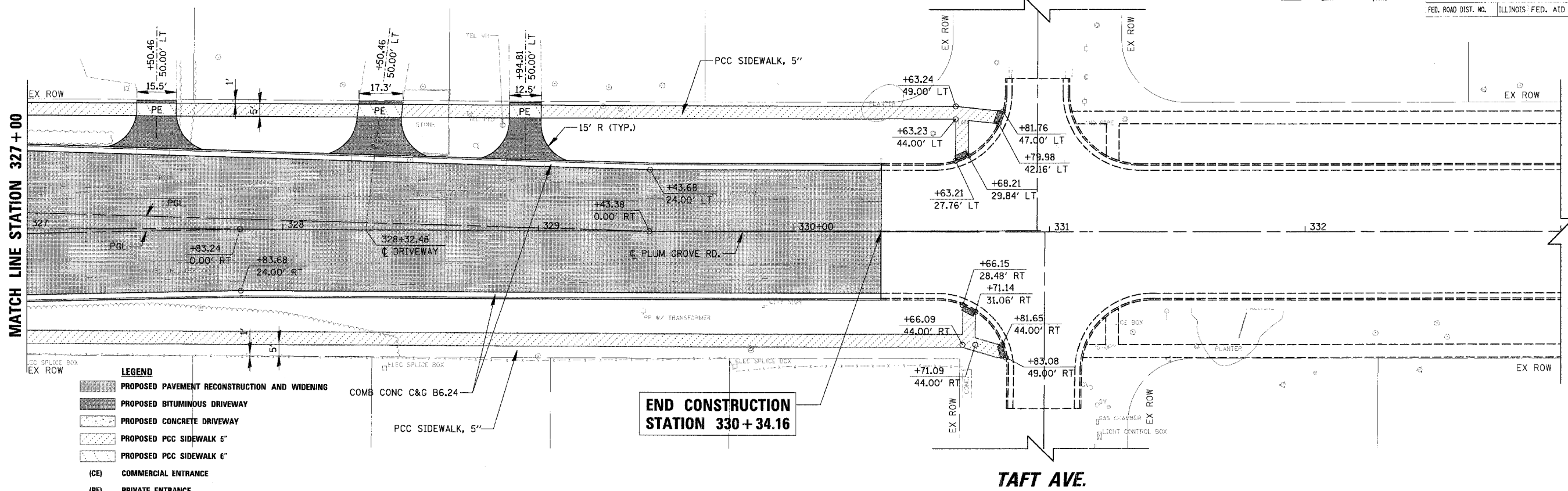

- LEGEND**
- PROPOSED PAVEMENT RECONSTRUCTION AND WIDENING
 - PROPOSED BITUMINOUS DRIVEWAY
 - PROPOSED CONCRETE DRIVEWAY
 - PROPOSED PCC SIDEWALK 5"
 - PROPOSED PCC SIDEWALK 6"
 - (CE) COMMERCIAL ENTRANCE
 - (PE) PRIVATE ENTRANCE

**END CONSTRUCTION
STATION 330 + 34.16**

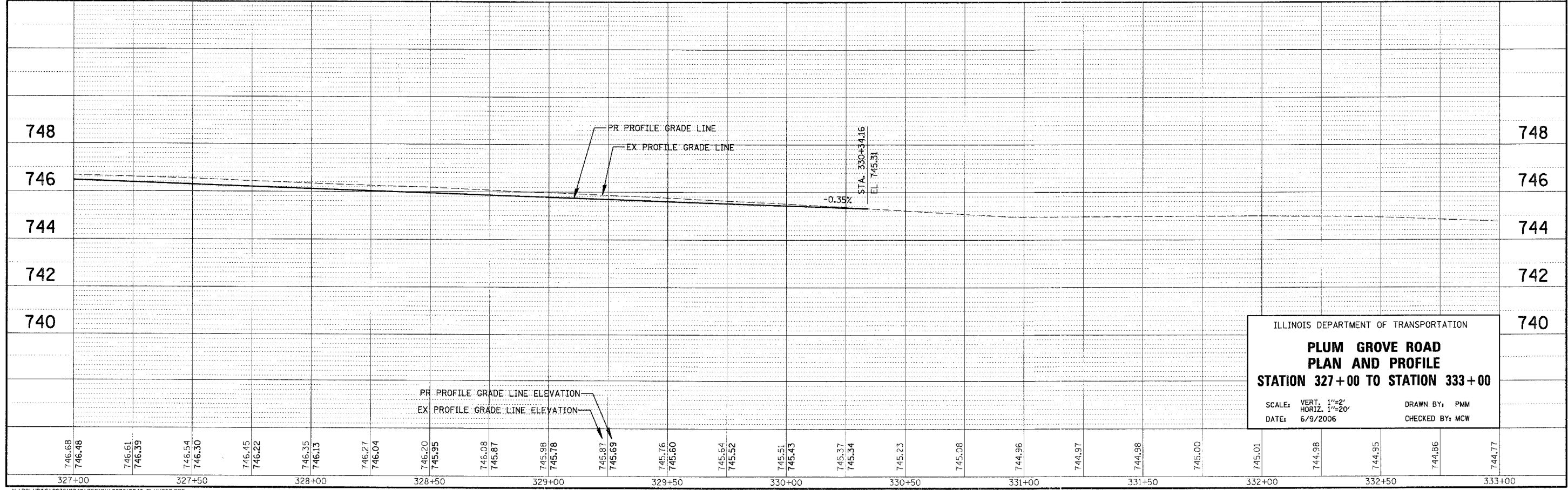

ILLINOIS DEPARTMENT OF TRANSPORTATION
**PLUM GROVE ROAD
 PLAN AND PROFILE
 STATION 327+00 TO STATION 333+00**
 SCALE: VERT. 1"=2'
 HORIZ. 1"=20'
 DATE: 6/9/2006
 DRAWN BY: PMM
 CHECKED BY: MCW

PLAN SURVEYED, PLOTTED, CHECKED, REVISIONS, DATE, BY, NO. DATE

CHRISTOPHER B. BURKE ENGINEERING LTD.
 9575 West Higgins Road, Suite 600
 Rosemont, Illinois 60018
 (847) 823-0500

PROFILE SURVEYED, PLOTTED, CHECKED, REVISIONS, DATE, BY, NO. DATE
 NOTE WORK SHALL BE NOTED IN THE FIELD