

F.A. RTE.	SECTION	COUNTY	TOTAL SHEET NO.
2585 97-00071-00-PV	COOK	ILLINOIS	116 50
STA.	TO STA.		
FED. ROAD DIST. NO.	ILLINOIS FED. AID PROJECT		

DATE: \_\_\_\_\_ BY: \_\_\_\_\_  
 PLAN: REVISIONS PLOTTED \_\_\_\_\_  
 NOTE BOOK NO. \_\_\_\_\_  
 CAD FILE NAME: \_\_\_\_\_

CHRISTOPHER B. BURKE ENGINEERING LTD.  
 9875 West Higgins Road, Suite 600  
 Rosemont, Illinois 60018  
 (847) 823-0500

DATE: \_\_\_\_\_ BY: \_\_\_\_\_  
 PROFILE: REVISIONS PLOTTED \_\_\_\_\_  
 NOTE BOOK NO. \_\_\_\_\_  
 STRUCTURE INFORMATION SHEET NO. \_\_\_\_\_

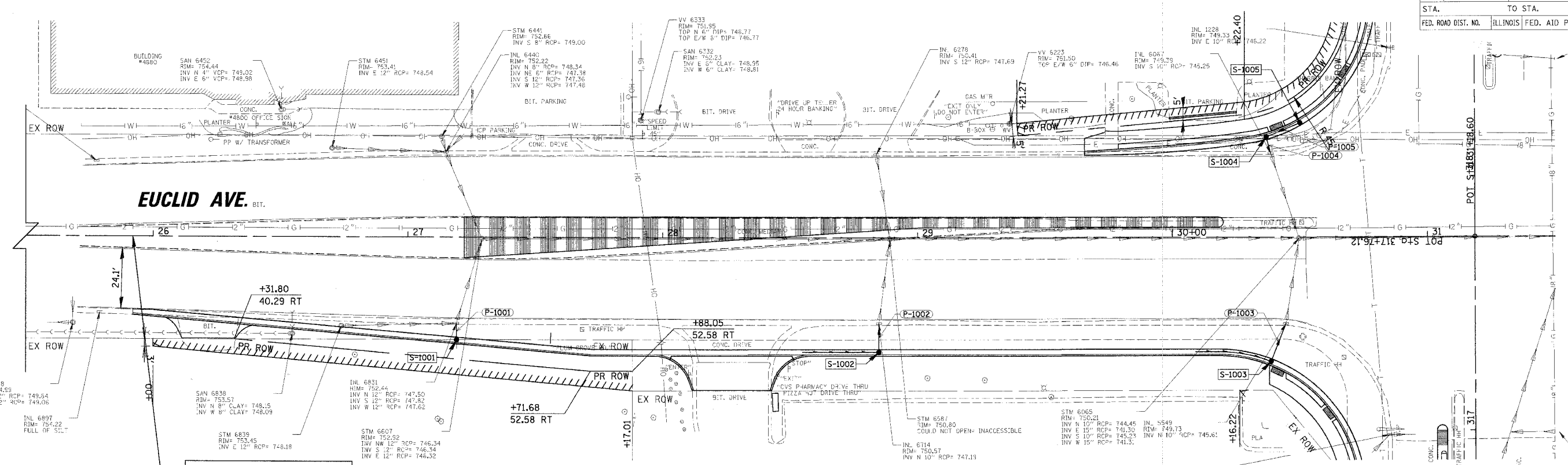

**BEGIN IMPROVEMENT  
 STATION 25+92.05**

STRUCTURE NO.	STATION	OFFSET	STRUCTURE TYPE	DIA.(FT)	RIM ELEV.	N	S
S-1001	27+19	39.35' RT	CB TC T24F&G	2	752.38	747.88	
S-1002	28+84.9	44.00' RT	CB TC T24F&G	2	750.47	747.30	
S-1003	30+38.7	47.91' RT	CB TC T24F&G	2	749.51	745.77	
S-1004	30+36.8	38.13' LT	CB TC T24F&G	2	749.47	745.31	745.31
S-1005	30+50.0	43.55' LT	CB TC T24F&G	2	749.37		745.45

PIPE NO.	FROM	TO	STRUCTURE	MATERIAL	TYPE	LENGTH (FT)	DIA. (IN)	UPPER INVERT	LOWER INVERT	SLOPE	TBF
P-1001	S-1001	-	-	RCP	2	6	12	747.88	747.82	1.00	2.00
P-1002	S-1002	-	-	RCP	2	11	12	747.30	747.19	1.00	2.00
P-1003	S-1003	-	-	RCP	2	16	12	745.77	745.61	1.00	2.00
P-1004	S-1004	-	-	RCP	2	6	12	745.31	745.25	1.00	2.00
P-1005	S-1005	-	-	RCP	2	14	12	745.45	745.31	1.00	2.00

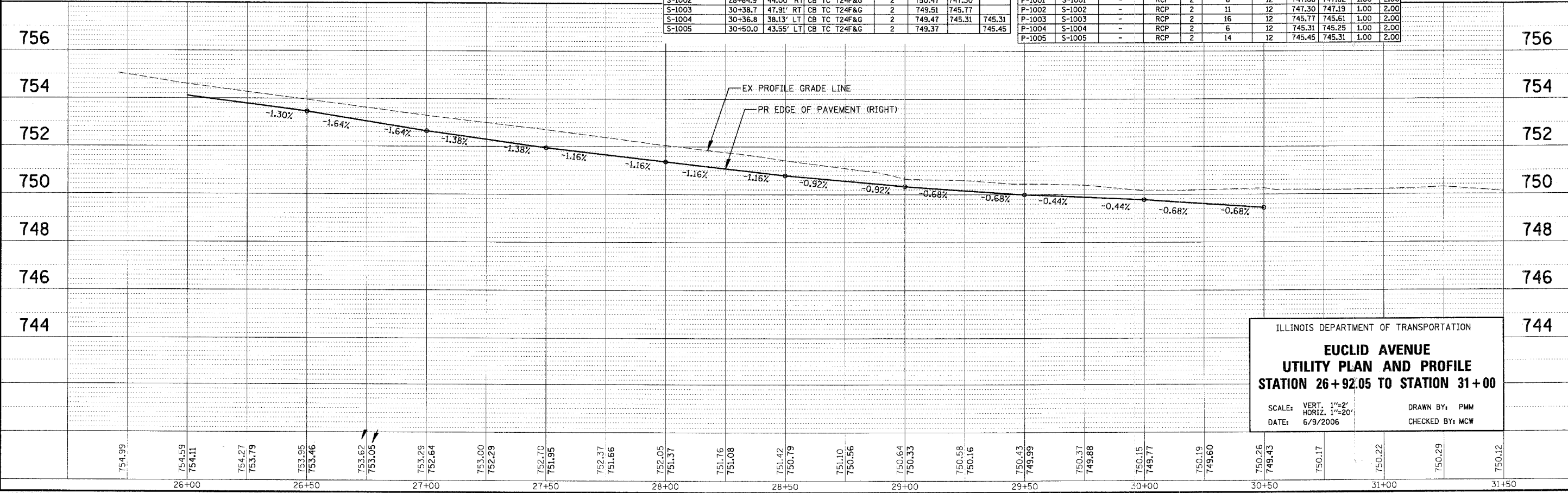

ILLINOIS DEPARTMENT OF TRANSPORTATION  
**EUCLID AVENUE  
 UTILITY PLAN AND PROFILE  
 STATION 26+92.05 TO STATION 31+00**  
 SCALE: VERT. 1"=2'  
 HORIZ. 1"=20'  
 DATE: 6/9/2006  
 DRAWN BY: PMM  
 CHECKED BY: MCW