

DATE: _____ BY: _____
 SUBMITTED: _____
 PLANNING: _____
 ENGINEERING: _____
 CHECKED: _____
 DATE: _____

CHRISTOPHER B. BURKE ENGINEERING LTD.
 9575 West Higgins Road, Suite 600
 Rosemont, Illinois 60018
 (847) 823-0500

DATE: _____ BY: _____
 SUBMITTED: _____
 PLANNING: _____
 ENGINEERING: _____
 CHECKED: _____
 DATE: _____

F.A. RTE.	SECTION	COUNTY	TOTAL SHEETS	SHEET NO.
---	06-00061-00-SW	COOK	37	16
STA.	TO STA.			
FED. ROAD DIST. NO.	ILLINOIS	FED. AID PROJECT		
CONTRACT NO. 83899				

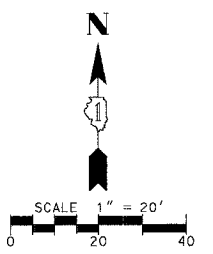
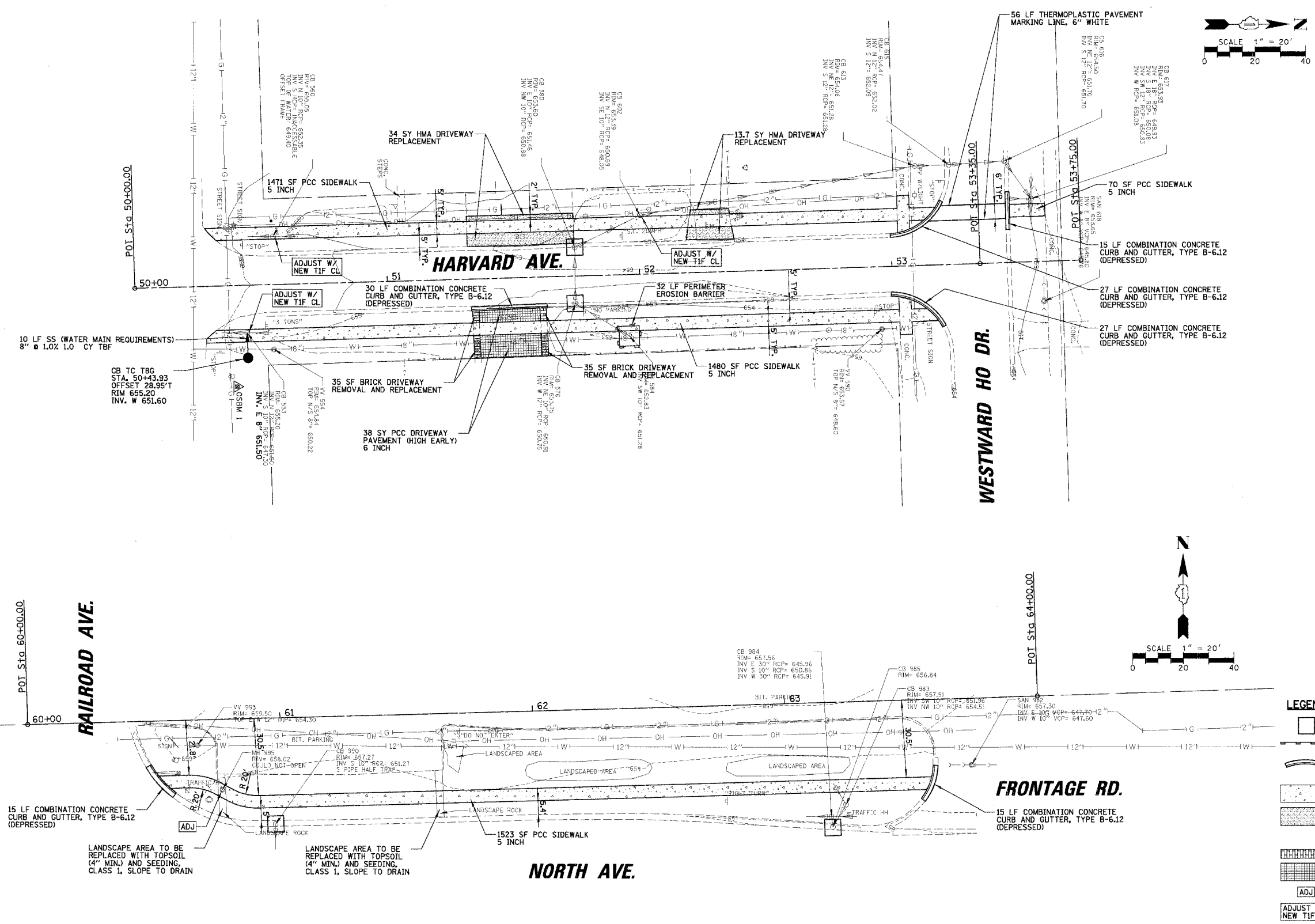
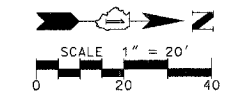

LEGEND:

- INLET FILTER
- PERIMETER EROSION BARRIER
- COMBINATION CONCRETE CURB AND GUTTER TYPE B-6.12 (PAID FOR AS COMBINATION CONCRETE CURB AND GUTTER REMOVAL AND REPLACEMENT)
- PCC SIDEWALK, 5 INCH SUBBASE GRANULAR MATERIAL, TYPE B, 2"
- HMA DRIVEWAY REPLACEMENT - HOT-MIX ASPHALT SURFACE COURSE, MIX 4C, NSO (OC/OA) - 2" - HOT-MIX ASPHALT BASE COURSE - 6" - SUBBASE GRANULAR MATERIAL, TYPE B 6"
- BRICK DRIVEWAY REMOVAL AND REPLACEMENT
- PCC DRIVEWAY PAVEMENT (HIGH EARLY), 6 INCH SUBBASE GRANULAR MATERIAL, TYPE B, 3 INCH
- MANHOLE TO BE ADJUSTED
- CATCH BASIN TO BE ADJUSTED WITH NEW TYPE 1 FRAME, CLOSED LID

REVISIONS	
NAME	DATE

ILLINOIS DEPARTMENT OF TRANSPORTATION
 HARVARD AVENUE, NORTH AVENUE
 PROPOSED IMPROVEMENTS
 CITY OF NORTHLAKE - CMAQ SIDEWALKS
 SCALE 1" = 20'
 DATE 01/04/2007
 DRAWN BY AMP
 CHECKED BY MW