

F.A.U. R.T.E.	SECTION	COUNTY	TOTAL SHEETS	SHEET NO.
1340	06-00048-00-RS	COOK	36	26
LANDSCAPE PLAN				
ILLINOIS				



KEY

1) IN KEYSTONE AVE. PARKWAY, PROVIDE 24" OF TOPSOIL IN TREE PITS ONLY (NOT ENTIRE PARKWAY). SEE DETAIL 4 ON SHEET 24.

James C. Gamble
JAMES C. GAMBLE
 REGISTERED LANDSCAPE ARCHITECT
 ILLINOIS LICENSE 157-000002

5142 Main Street
 Skokie, Illinois 60077
 (847) 329-9777
 Fax (847) 329-9779

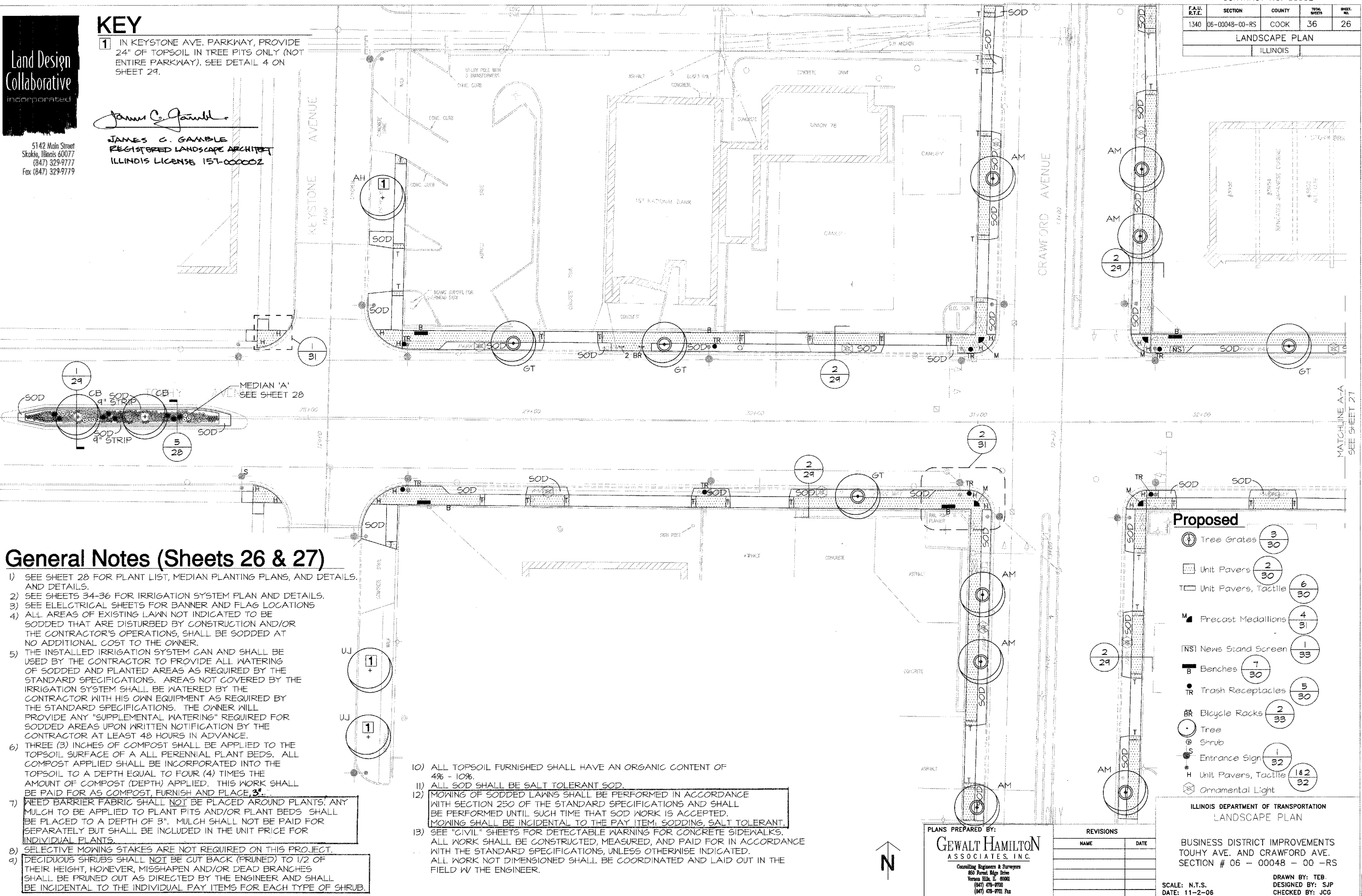

General Notes (Sheets 26 & 27)

- SEE SHEET 28 FOR PLANT LIST, MEDIAN PLANTING PLANS, AND DETAILS AND DETAILS.
- SEE SHEETS 34-36 FOR IRRIGATION SYSTEM PLAN AND DETAILS.
- SEE ELECTRICAL SHEETS FOR BANNER AND FLAG LOCATIONS
- ALL AREAS OF EXISTING LAWN NOT INDICATED TO BE SODDED THAT ARE DISTURBED BY CONSTRUCTION AND/OR THE CONTRACTOR'S OPERATIONS, SHALL BE SODDED AT NO ADDITIONAL COST TO THE OWNER.
- THE INSTALLED IRRIGATION SYSTEM CAN AND SHALL BE USED BY THE CONTRACTOR TO PROVIDE ALL WATERING OF SODDED AND PLANTED AREAS AS REQUIRED BY THE STANDARD SPECIFICATIONS. AREAS NOT COVERED BY THE IRRIGATION SYSTEM SHALL BE WATERED BY THE CONTRACTOR WITH HIS OWN EQUIPMENT AS REQUIRED BY THE STANDARD SPECIFICATIONS. THE OWNER WILL PROVIDE ANY "SUPPLEMENTAL WATERING" REQUIRED FOR SODDED AREAS UPON WRITTEN NOTIFICATION BY THE CONTRACTOR AT LEAST 48 HOURS IN ADVANCE.
- THREE (3) INCHES OF COMPOST SHALL BE APPLIED TO THE TOPSOIL SURFACE OF ALL PERENNIAL PLANT BEDS. ALL COMPOST APPLIED SHALL BE INCORPORATED INTO THE TOPSOIL TO A DEPTH EQUAL TO FOUR (4) TIMES THE AMOUNT OF COMPOST (DEPTH) APPLIED. THIS WORK SHALL BE PAID FOR AS COMPOST, FURNISH AND PLACE, 3".
- NEED BARRIER FABRIC SHALL NOT BE PLACED AROUND PLANTS. ANY MULCH TO BE APPLIED TO PLANT PITS AND/OR PLANT BEDS SHALL BE PLACED TO A DEPTH OF 3". MULCH SHALL NOT BE PAID FOR SEPARATELY BUT SHALL BE INCLUDED IN THE UNIT PRICE FOR INDIVIDUAL PLANTS.
- SELECTIVE MOWING STAKES ARE NOT REQUIRED ON THIS PROJECT.
- DECIDUOUS SHRUBS SHALL NOT BE CUT BACK (PRUNED) TO 1/2 OF THEIR HEIGHT, HOWEVER, MISSHAPEN AND/OR DEAD BRANCHES SHALL BE PRUNED OUT AS DIRECTED BY THE ENGINEER AND SHALL BE INCIDENTAL TO THE INDIVIDUAL PAY ITEMS FOR EACH TYPE OF SHRUB.

- ALL TOPSOIL FURNISHED SHALL HAVE AN ORGANIC CONTENT OF 4% - 10%.
- ALL SOD SHALL BE SALT TOLERANT SOD.
- MOWING OF SODDED LAWNS SHALL BE PERFORMED IN ACCORDANCE WITH SECTION 250 OF THE STANDARD SPECIFICATIONS AND SHALL BE PERFORMED UNTIL SUCH TIME THAT SOD WORK IS ACCEPTED. MOWING SHALL BE INCIDENTAL TO THE PAY ITEM: SODDING, SALT TOLERANT.
- SEE "CIVIL" SHEETS FOR DETECTABLE WARNING FOR CONCRETE SIDEWALKS. ALL WORK SHALL BE CONSTRUCTED, MEASURED, AND PAID FOR IN ACCORDANCE WITH THE STANDARD SPECIFICATIONS, UNLESS OTHERWISE INDICATED. ALL WORK NOT DIMENSIONED SHALL BE COORDINATED AND LAID OUT IN THE FIELD W/ THE ENGINEER.

Proposed

Tree Grates	3	30
Unit Pavers	2	30
Unit Pavers, Tactile	6	30
Precast Medallions	4	31
News Stand Screen	1	33
Benches	7	30
Trash Receptacles	5	30
Bicycle Racks	2	33
Tree		
Shrub		
Entrance Sign	1	32
Unit Pavers, Tactile	1 & 2	32
Ornamental Light		

PLANS PREPARED BY:
GEWALT HAMILTON
 ASSOCIATES, INC.
 Consulting Engineers & Surveyors
 850 Forest Ridge Drive
 Vernon Hills, IL 60061
 (847) 478-9700
 (847) 478-9701 Fax

REVISIONS	
NAME	DATE

ILLINOIS DEPARTMENT OF TRANSPORTATION
 LANDSCAPE PLAN
 BUSINESS DISTRICT IMPROVEMENTS
 TOWHY AVE. AND CRAWFORD AVE.
 SECTION # 06 - 00048 - 00 -RS
 SCALE: N.T.S.
 DATE: 11-2-06
 DRAWN BY: TEB
 DESIGNED BY: SJP
 CHECKED BY: JCG