

INDEX OF SHEETS

| Sheet No. | Description |
|-----------|-----------------------------------|
| 1 | COVER SHEET |
| 2 | TYPICAL CROSS SECTION AND DETAILS |
| 3 - 4 | DETAILS & SCHEDULES |

STANDARDS

| | |
|-----------|-----------------|
| 701301-02 | TRAFFIC CONTROL |
| 701306-01 | TRAFFIC CONTROL |
| 702001-06 | TRAFFIC CONTROL |

SUMMARY OF QUANTITIES

| CODE NO. | DESCRIPTION | QUANTITY | UNIT |
|------------|--|----------|--------|
| * Z0048665 | RAILROAD PROTECTION LIABILITY INSURANCE | 1 | L SUM |
| * 20200100 | EARTH EXCAVATION | 35 | CU YD |
| * 35100100 | AGGREGATE BASE COURSE , TYPE A | 72 | TON |
| * 40600100 | BITUMINOUS MATERIALS (PRIME COAT) | 11273 | GALLON |
| 40600300 | AGGREGATE (PRIME COAT) | 228 | TON |
| 40600625 | LEVELING BINDER (MACHINE METHOD), N50 | 5995 | TON |
| 40600982 | HOT-MIX ASPHALT SURFACE REMOVAL - BUTT JOINT | 543 | SQ YD |
| 40600990 | TEMPORARY RAMP | 46 | SQ YD |
| * 40603310 | HOT-MIX ASPHALT SURFACE CSE. MIX "C", N50 | 8010 | TON |
| 40800050 | INCIDENTAL HOT-MIX ASPHALT SURFACING | 263 | TON |
| 44000154 | HOT-MIX ASPHALT SURFACE REMOVAL - 1 1/4" | 68 | SQ YD |
| * 48101200 | AGGREGATE SHOULDERS, TYPE B | 3407 | TON |
| 67100100 | MOBILIZATION | 1 | L SUM |
| * 70100460 | TRAFFIC CONTROL AND PROTECTION, STD 701306 | 1 | L SUM |
| * 70300100 | SHORT-TERM PAVEMENT MARKING | 7839 | FOOT |

Construction Code I000

* Special Provisions

CONTRACT NO. 87323

J.U.L.I.E. 1-800-892-0123

STATE OF ILLINOIS
DEPARTMENT OF TRANSPORTATION
COUNTY OF KANKAKEE
DEPARTMENT OF HIGHWAYS
PLANS FOR PROPOSED
FEDERAL AID SECONDARY PROJECT
SECTION 04-00234-01-RS & 04-00235-01-RS
F.A.S. 313 (C.H.2) PROJECT CRS-313 (106)
JOB NO. C-93-058-06

| F.A.S. ROUTE NO. | SEC. | COUNTY | NO. SHEETS | SHEET NO. |
|-------------------------------|------|----------|--------------------|-----------|
| 313 | * | Kankakee | 4 | 1 |
| ILLINOIS PROJECT RS-313 (106) | | | CONTRACT NO. 87323 | |

* 04-00234-01-RS
04-00235-01-RS

KANKAKEE COUNTY

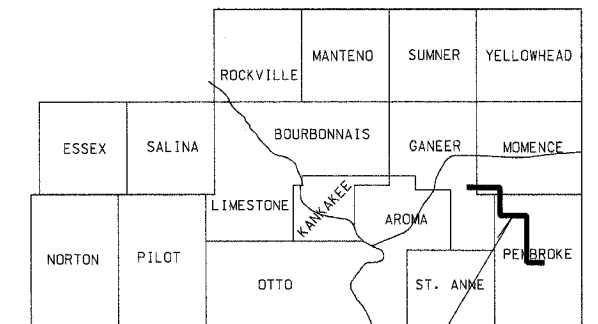

PROJECT LOCATION

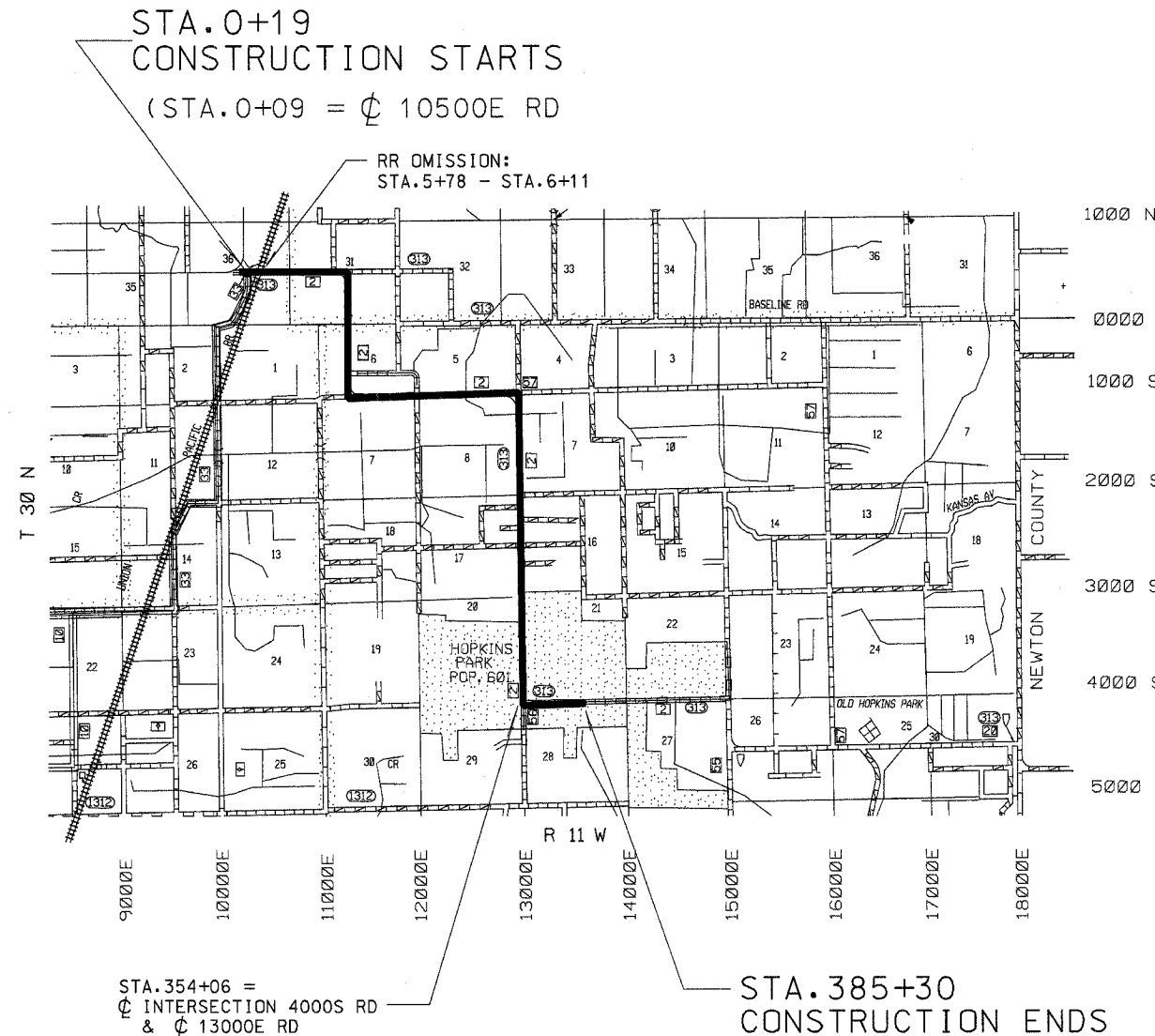

THE ACCEPTANCE OF THIS PROJECT IS BASED ON THE MINIMUM DESIGN CRITERIA FOR LOCAL AGENCY PAVEMENT PRESERVATION POLICY (LAPP) PROJECTS

CLASS II ROAD
2006 CURRENT A.D.T. = 2550
2016 DESIGN A.D.T. = 2818
DESIGN SPEED = 55 M.P.H.
ROADWAY CLASSIFICATION = COLLECTOR

STATE OF ILLINOIS
DEPARTMENT OF TRANSPORTATION
DIVISION OF HIGHWAYS

Approved 2-6 2007

JAMES W. PIEKARCZYK, P.E.
KANKAKEE COUNTY ENGINEER

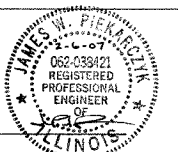

Passed 02-13 2007

KENNETH ROANG
BUREAU CHIEF, LOCAL ROADS & STREETS

Releasing for Bid Based on Limited Review 02-15 2007

DIANE O'KEEFE
REGION 2 ENGINEER

GROSS LENGTH = 38,511 LIN FT = 7.294 MILES