

STATE OF ILLINOIS  
DEPARTMENT OF TRANSPORTATION

ROUTE NO.	SECTION	COUNTY	SHEET	TOTAL
		Tazewell	43	14
FED. ROAD DIST. NO. 1		ILLINOIS	FED. AID PROJECT	
03-00123-03-BT		CONTRACT # 89302		

PROP. CURVE CL-13  
PI STA. = 73+22.08  
 $\Delta = 8^\circ 35' 13''$  (LT)  
D = 60° 18' 41"  
R = 95.00'  
T = 7.13'  
L = 14.24'  
E = 0.27'  
e = -----  
T.R. = -----  
S.E. RUN = -----  
P.C. STA. = 73+14.95  
P.T. STA. = 73+29.19

PROP. CURVE CL-14  
PI STA. = 73+83.41  
 $\Delta = 11^\circ 47' 05''$  (RT)  
D = 60° 18' 41"  
R = 95.00'  
T = 9.80'  
L = 19.54'  
E = 0.50'  
e = -----  
T.R. = -----  
S.E. RUN = -----  
P.C. STA. = 73+73.61  
P.T. STA. = 73+93.15

PROP. CURVE CL-15  
PI STA. = 75+13.70  
 $\Delta = 1^\circ 47' 22''$  (RT)  
D = 2° 31' 17"  
R = 2,272.42'  
T = 35.49'  
L = 70.97'  
E = 0.28'  
e = -----  
T.R. = -----  
S.E. RUN = -----  
P.C. STA. = 74+78.21  
P.T. STA. = 75+49.18

PROP. CURVE CL-16  
PI STA. = 75+76.60  
 $\Delta = 29^\circ 58' 16''$  (RT)  
D = 55° 56' 38"  
R = 102.42'  
T = 27.41'  
L = 53.57'  
E = 3.61'  
e = -----  
T.R. = -----  
S.E. RUN = -----  
P.C. STA. = 75+49.18  
P.T. STA. = 76+02.76

PROP. CURVE CL-17  
PI STA. = 76+20.52  
 $\Delta = 2^\circ 44' 58''$  (RT)  
D = 55° 56' 38"  
R = 102.42'  
T = 2.46'  
L = 4.91'  
E = 0.03'  
e = -----  
T.R. = -----  
S.E. RUN = -----  
P.C. STA. = 76+18.06  
P.T. STA. = 76+22.98

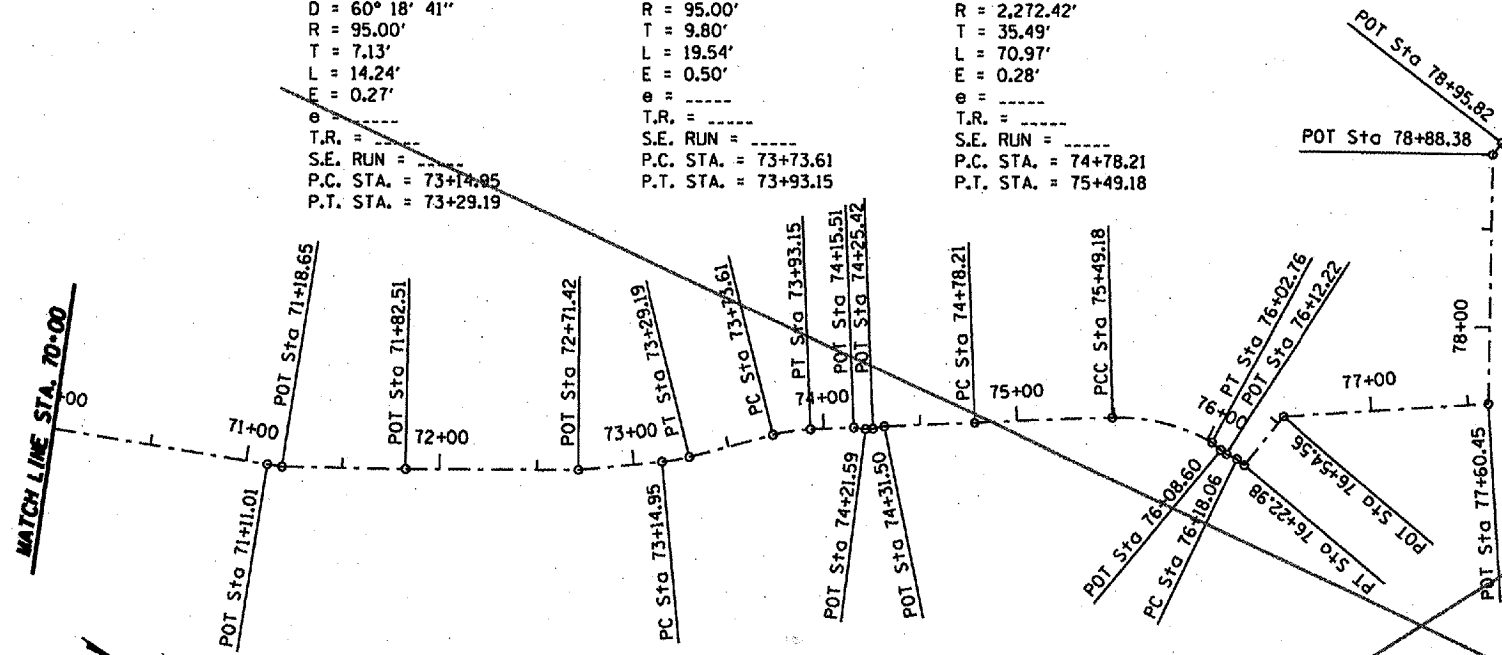

ALIGNMENT PLAN  
BIKE TRAIL OVER FARM CREEK  
SECTION 03-00123-03-BT  
TAZEWELL COUNTY

DESIGNED	RWB	 RANDOLPH & ASSOCIATES, INC. 411 N. PIONEER AVENUE, SUITE 100, CHICAGO, ILL. 60610-3100 TEL: 312.329.1100 FAX: 312.329.1101 WWW.RANDOLPH-ASSOCIATES.COM CONSULTING ENGINEERS & LAND SURVEYORS	FILE NUMBER
CHECKED	CWB		56.46
DRAWN	RWB		DATE
CHECKED	CWB		August 2003