

PLAN	DATE
BY	
REVISIONS	
NO.	
DATE	
BY	
REVISIONS	
NO.	
DATE	
BY	

F.A.I.D. RTE.	SECTION	COUNTY	TOTAL SHEETS	SHEET NO.
6998	99-00209-01-PV	VERMILION	296	100
STA. 151+00	TO STA. 157+00			
FED. ROAD DIST. NO. ILLINOIS	FED. AID PROJECT-			
CONTRACT NO.: 91358				

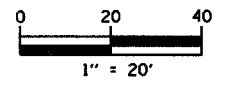

END IMPROVEMENT
END PERMANENT STRIPING
STA. 156+35.00

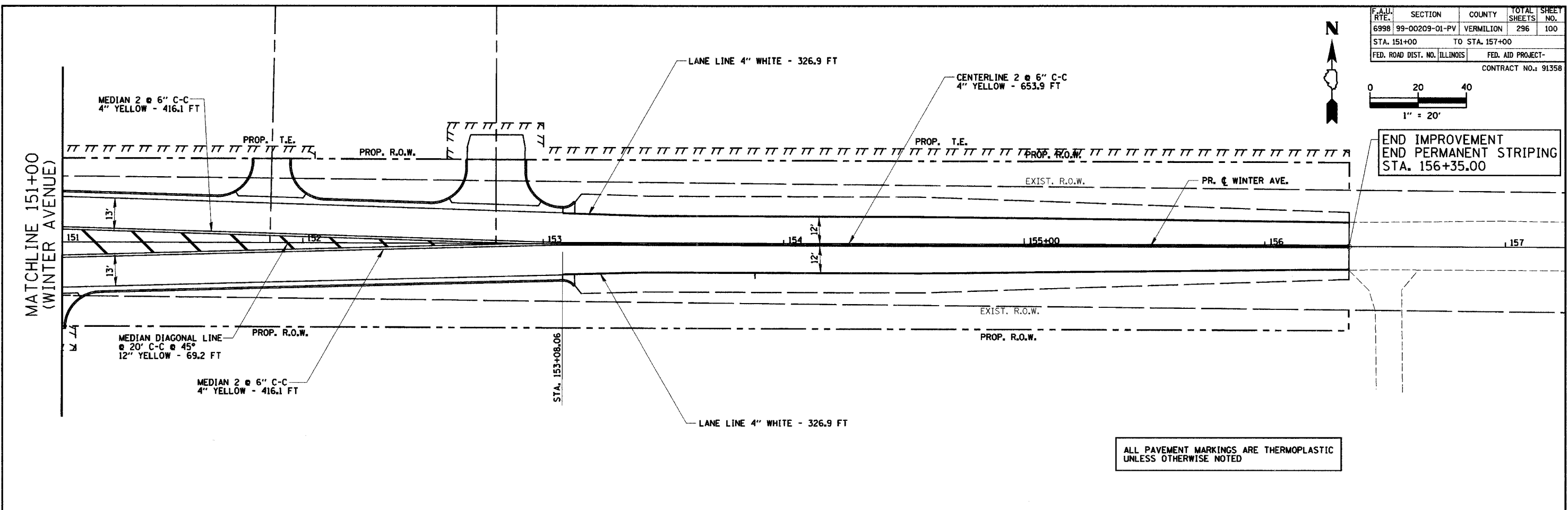

ALL PAVEMENT MARKINGS ARE THERMOPLASTIC
UNLESS OTHERWISE NOTED

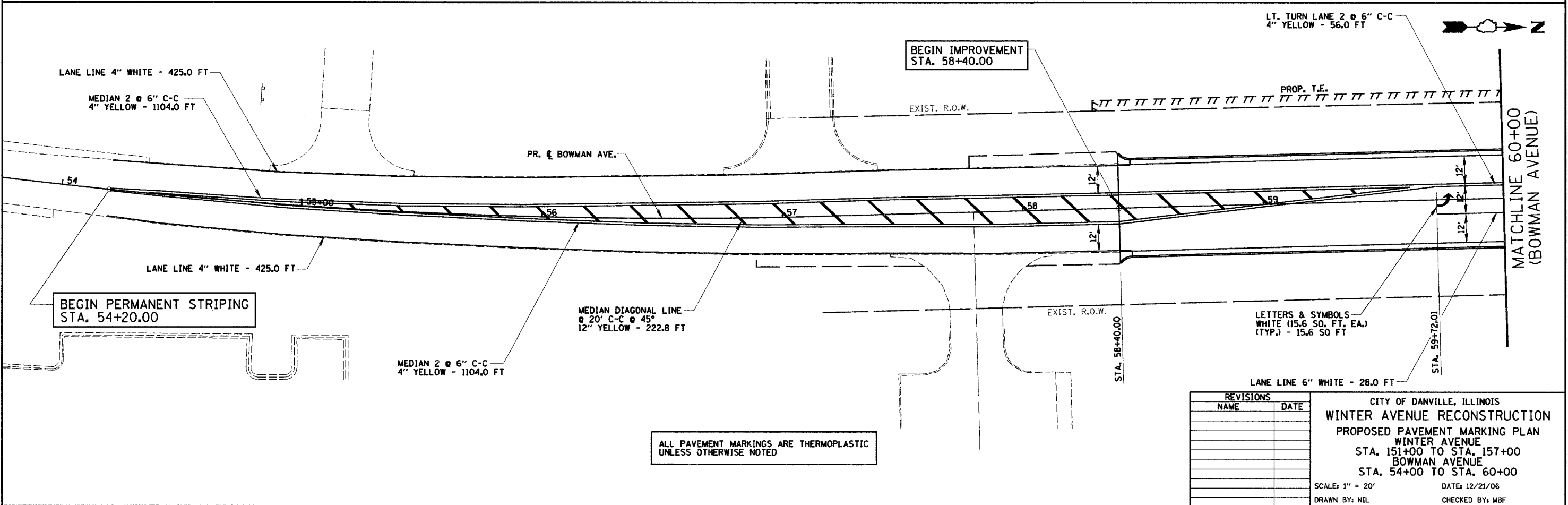

ALL PAVEMENT MARKINGS ARE THERMOPLASTIC
UNLESS OTHERWISE NOTED

REVISIONS	
NAME	DATE

CITY OF DANVILLE, ILLINOIS
WINTER AVENUE RECONSTRUCTION
PROPOSED PAVEMENT MARKING PLAN
WINTER AVENUE
STA. 151+00 TO STA. 157+00
BOWMAN AVENUE
STA. 54+00 TO STA. 60+00
SCALE: 1" = 20'
DATE: 12/21/06
DRAWN BY: NIL
CHECKED BY: MBF