

| | | | | |
|------------------------------|----------------|-------------------|--------------|-----------|
| F.A.I.D. RTE. | SECTION | COUNTY | TOTAL SHEETS | SHEET NO. |
| 6998 | 99-00209-01-PV | VERMILION | 296 | 171 |
| STA. 63+50 | | TO STA. 75+00 | | |
| FED. ROAD DIST. NO. ILLINOIS | | FED. AID PROJECT- | | |
| CONTRACT NO.: 91358 | | | | |

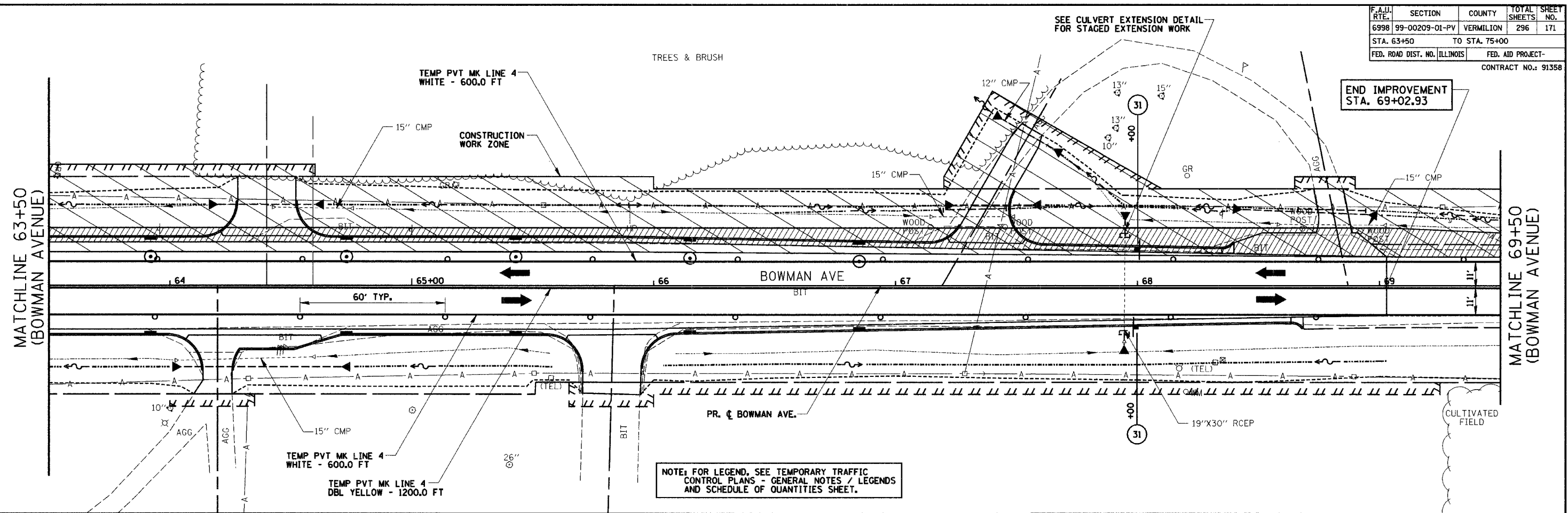

| | | |
|------|-----------|------|
| PLAN | SURVEYED | DATE |
| | PLOTTED | |
| | CHECKED | |
| | BY | |
| | NO. | |
| | FILE NAME | |

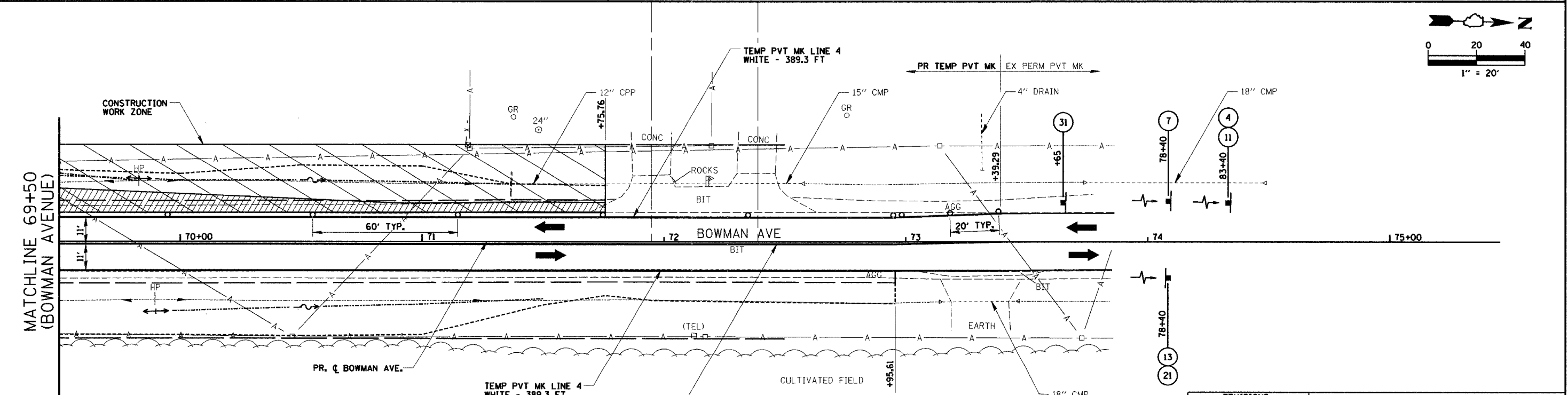
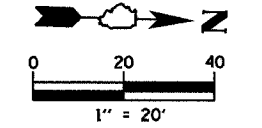

NOTE: FOR LEGEND, SEE TEMPORARY TRAFFIC CONTROL PLANS - GENERAL NOTES / LEGENDS AND SCHEDULE OF QUANTITIES SHEET.

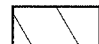

LEGEND

| | |
|---|--|
|  | CONSTRUCTION WORK ZONE |
|  | TEMPORARY PAVEMENT WITH AGGREGATE SHOULDER |

| REVISIONS | |
|-----------|------|
| NAME | DATE |
| | |
| | |
| | |
| | |
| | |
| | |
| | |
| | |
| | |
| | |

CITY OF DANVILLE, ILLINOIS
WINTER AVENUE RECONSTRUCTION
TEMPORARY TRAFFIC CONTROL PLAN
STAGE 4
BOWMAN AVENUE
STA. 63+50 TO STA. 75+00
 SCALE: 1" = 20'
 DATE: 12/21/06
 DRAWN BY: MLS
 CHECKED BY: MBF