

F.A.S. RTE.	SECTION	COUNTY	TOTAL SHEETS	SHEET NO.
461	D4-00001-03-RS	MASON	19	10
STA. 138+00		TO STA. 198+00		
FED. ROAD DIST. NO.	ILLINOIS	FED. AID PROJECT		

CONTRACT NO. 93432

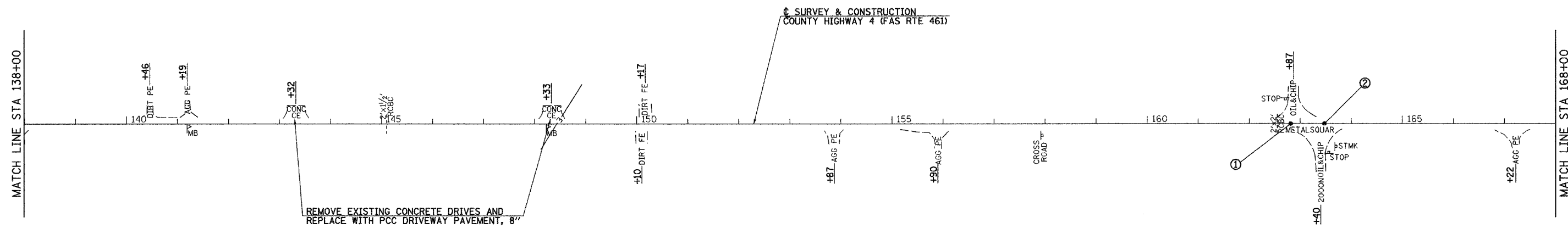

① NE COR, NE 1/4, SEC 24, T22N, R7W, 3RD PM
 N - 1340411.76 E - 2390875.63
 STA 162+81.19; TO BE RESET BY COUNTY

② NW COR, NW 1/4, SEC 19, T22N, R6W, 3RD PM
 N - 1340477.69 E - 2390875.39
 STA 163+47.12; TO BE RESET BY COUNTY

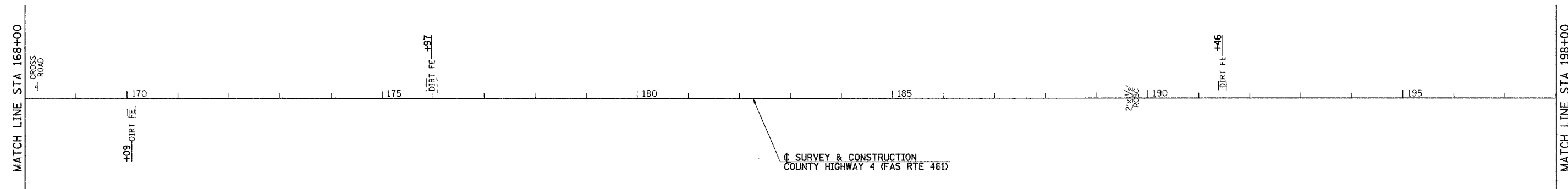
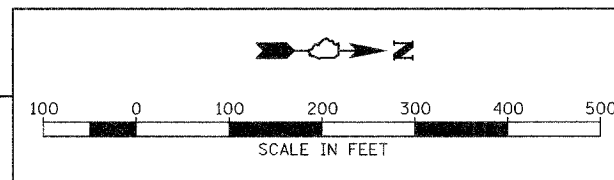

REVISIONS	
NAME	DATE

ILLINOIS DEPARTMENT OF TRANSPORTATION

COUNTY HIGHWAY 4 (FAS 461)
 STA 138+00 TO STA 198+00

SCALE:
 DATE: 11-22-06

DRAWN BY TJD
 CHECKED BY AWM