

COUNTY	ROUTE	SECTION	TOTAL SHEETS	SHEET NO.
ADAMS	CH 11	08-00200-00-RS	10	5
STATION 480+00 TO STATION 485+00				
PROJECT NO. RS-1889(105)				

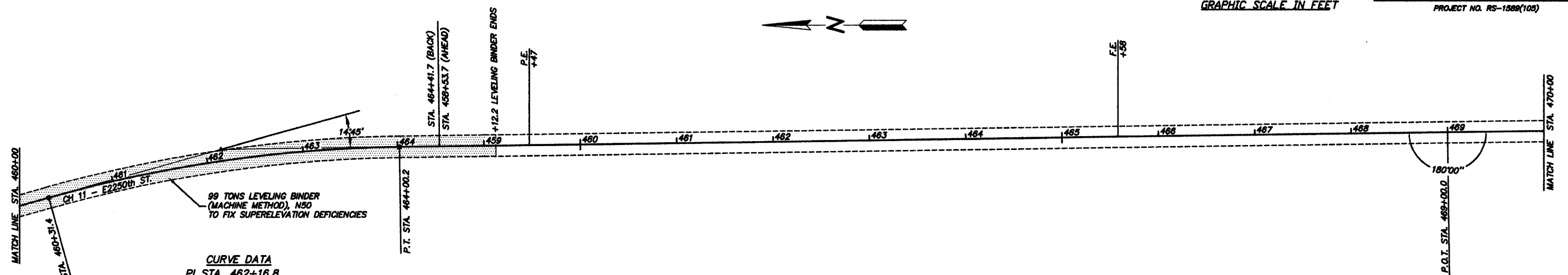

CURVE DATA
 PI STA. 462+16.8
 $\Delta=14^{\circ}45'$
 D=4'00"
 T=185.44'
 R=1,432.69'
 L=368.75'
 E=11.87'
 PC STA. 460+31.4
 PT STA. 464+00.2
 SE=0.0566 FT/FT

99 TONS LEVELING BINDER
 (MACHINE METHOD), N50
 TO FIX SUPERELEVATION DEFICIENCIES

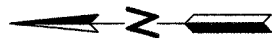
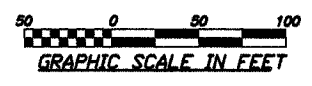