

DATE	BY
REVISION	NO.
PLANNED	NO.
DESIGNED	NO.
CHECKED	NO.
APPROVED	NO.
DATE	BY
NO.	NO.
NO.	NO.
NO.	NO.
NO.	NO.
NO.	NO.

DATE	BY
REVISION	NO.
PLANNED	NO.
DESIGNED	NO.
CHECKED	NO.
APPROVED	NO.
DATE	BY
NO.	NO.
NO.	NO.
NO.	NO.
NO.	NO.
NO.	NO.

CADD FILE: 14812/ss\_Sixth\_01.dwg  
PLOTTED: 3/5/2007

F.A.I.I. RTE.	SECTION	COUNTY	TOTAL SHEETS	SHEET NO.
8419	99-00048-01-PV	FAYETTE	142	52
STA.	TO STA.			
FED. ROAD DIST. NO.	ILLINOIS FED. AID PROJECT	CONTRACT NO. 95500		

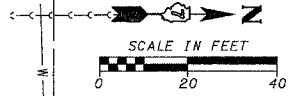
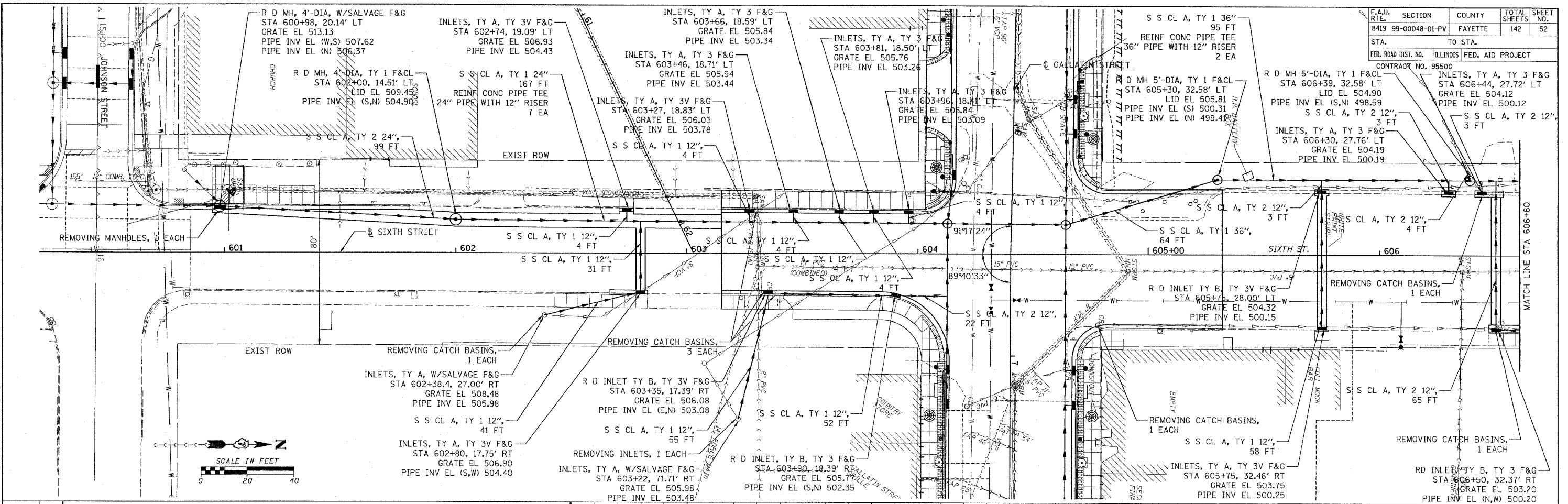

**ABBREVIATIONS**

S S CL A, TY 1	= STORM SEWERS CLASS A, TYPE 1
S S CL A, TY 2	= STORM SEWERS CLASS A, TYPE 2
INLETS, TY A, TY 3V F&G	= INLETS, TYPE A, TYPE 3V FRAME AND GRATE
INLETS, TY B, TY 3V F&G	= INLETS, TYPE B, TYPE 3V FRAME AND GRATE
INLETS, TY A, W/SALVAGE F&G	= INLETS, TYPE A, WITH SALVAGE FRAME AND GRATE
R D INLET TY B, TY 3V F&G	= RESTRICTED DEPTH INLET TYPE B, TYPE 3V FRAME AND GRATE
R D INLET TY B, TY 1 F&CL	= RESTRICTED DEPTH INLET TYPE B, TYPE 1 FRAME AND CLOSED LID
R D MH, 4'-DIA, TY 1 F&CL	= RESTRICTED DEPTH MANHOLE, 4'-DIAMETER, TYPE 1 FRAME AND CLOSED LID
R D MH, 5'-DIA, TY 1 F&CL	= RESTRICTED DEPTH MANHOLE, 5'-DIAMETER, TYPE 1 FRAME AND CLOSED LID
R D MH, 4'-DIA, W/SALVAGE F&G	= RESTRICTED DEPTH MANHOLE, 4'-DIAMETER, WITH SALVAGE FRAME AND GRATE

**LEGEND**

	PROPOSED SEWER	530
	PROPOSED MANHOLE	525
	PROPOSED INLET	520

