

ROUTE	SECTION	COUNTY	TOTAL SHEETS	SHEET NO.
FAS 946	05-00074-00-RS	ALEXANDER	15	6
PROJECT NO. RS-946 (106)			CONTRACT NO. 99287	

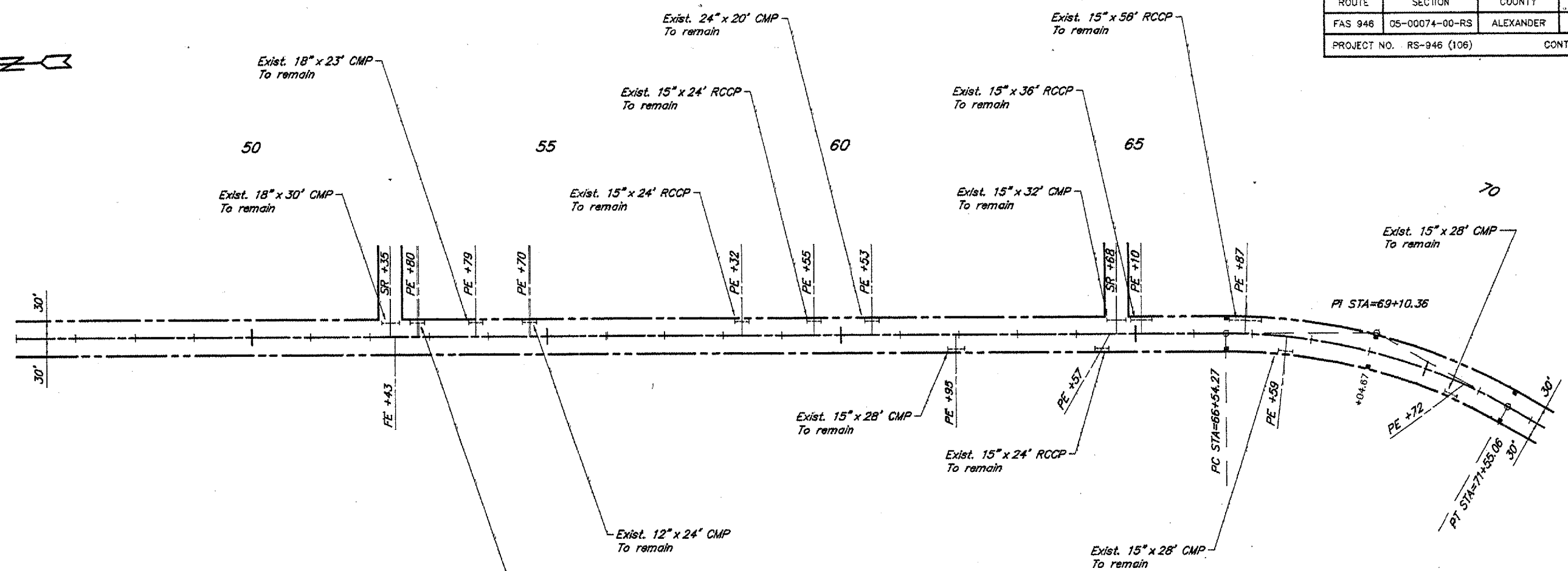
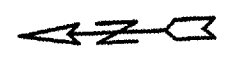

**CURVE DATA**  
 $\Delta = 29^{\circ}32'00''$   $T = 256.09'$   
 $D = 5^{\circ}53'50''$   $L = 500.79'$   
 $R = 971.55'$   $E = 33.18'$   
 $S.E. = 0.077'/ft.$   
 Attain Sta. 65+08 to Sta. 67+10  
 Remove Sta. 70+99 to Sta. 73+01

SCALES:  
 1" = 200' HOR  
 1" = 20' VER

651 PPO3 01/05/07 10:53 RLM

