

ROUTE	SECTION	COUNTY	TOTAL SHEETS	SHEET NO.
FAS 946	05-00074-00-RS	ALEXANDER	15	10
PROJECT NO. RS-946 (106)			CONTRACT NO. 99287	

**CURVE DATA**  
 $\Delta = 5^{\circ}10'00''$   $T = 258.52'$   
 $D = 1^{\circ}00'00''$   $L = 516.69'$   
 $R = 5729.83'$   $E = 5.83'$   
 $S.E. = 0.018'/ft.$   
 Attain Sta. 154+82 to Sta. 155+54  
 Remove Sta. 160+45 to Sta. 161+18

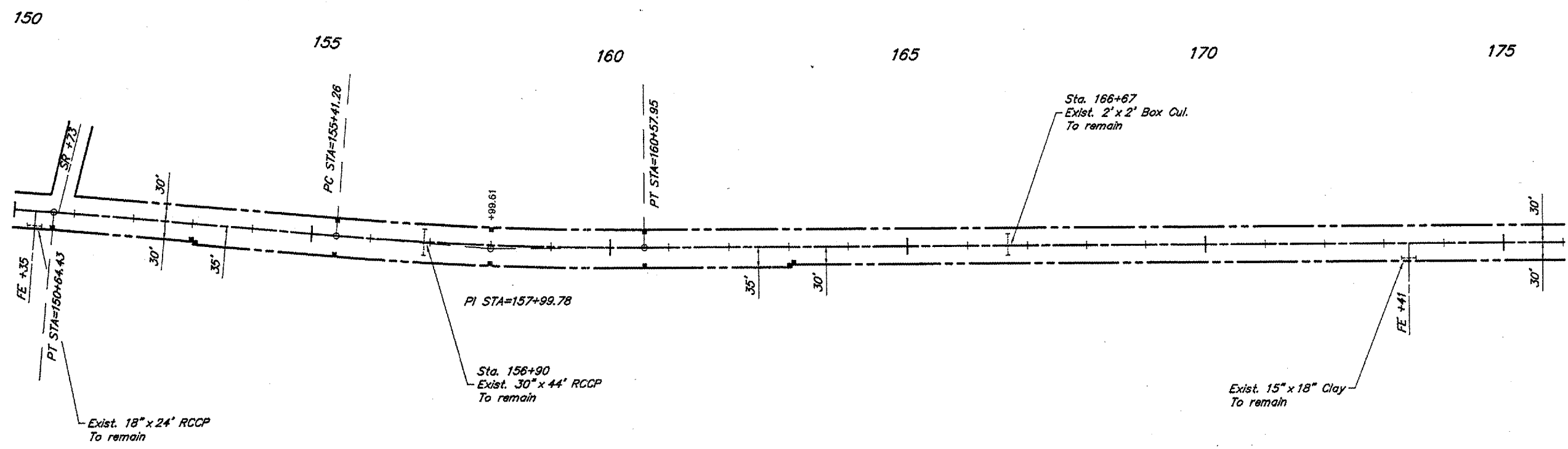

SCALES:  
 1" = 200' HOR  
 1" = 20' VER

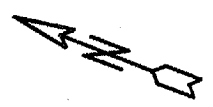
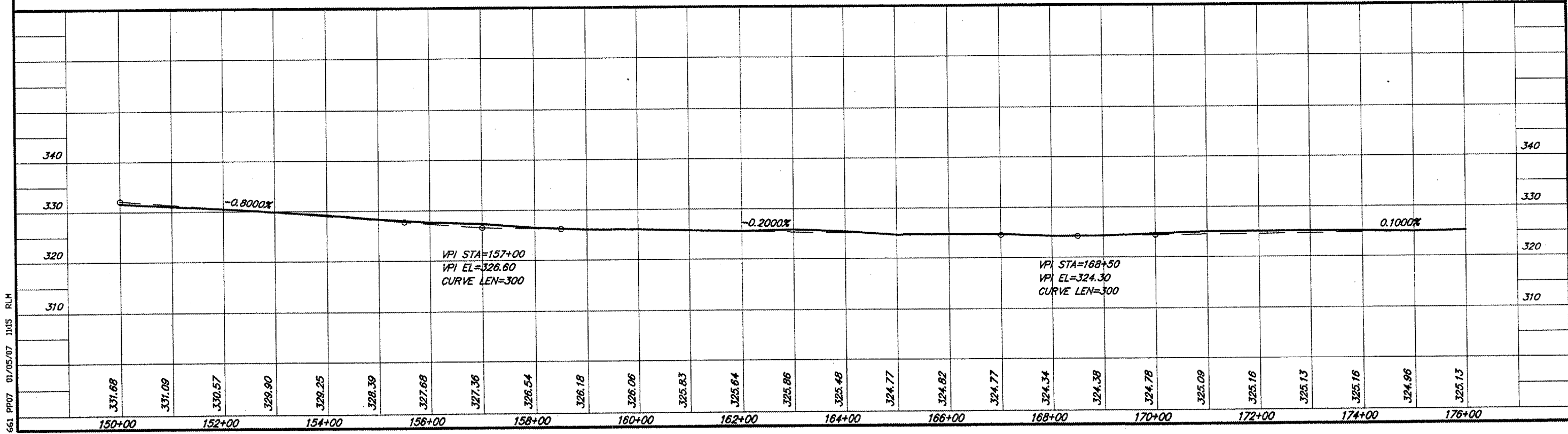

661.PP07 01/05/07 1145 RLM