

PLAN	SURVEYED	DATE
	PLOTTED	BY
	ALIGNED	
	CHECKED	
	FILED	
	NO.	

PROFILE	SURVEYED	DATE
	PLOTTED	BY
	GRADES	
	CHECKED	
	STRUCTURE	
	NOTATIONS	
	NO.	

- LEGEND:**
- PROPOSED INLET
 - PROPOSED MANHOLE
 - PROPOSED CATCH BASIN
 - ∩ PROPOSED HEADWALL
 - ▼ PROPOSED END SECTION
 - ~ PROPOSED DITCH
 - PROPOSED STORM SEWER
 - △ PROPOSED STRUCTURE NO.
 - ⊕ PROPOSED STORM SEWER NO.
 - ▨ PROPOSED STONE RIPRAP
 - ▩ PROPOSED TURF REINFORCEMENT MAT
 - ↑ PROPOSED SWALE
 - ➔ PROPOSED SHEET FLOW
 - EXISTING INLET
 - ▽ EXISTING END SECTION
 - EXISTING STORM SEWER
 - EXISTING PIPE UNDERDRAIN / FARM TILE
 - EXISTING ABANDONED FARM TILE (SEE GENERAL NOTES)
 - ~ EXISTING DITCH
 - ∩ EXISTING HEADWALL
 - ↑ EXISTING SWALE
 - ➔ EXISTING SHEET FLOW

NOTES:
 1. FOR STRUCTURE AND PIPE SCHEDULES SEE SHEETS NO. 54 AND 55.

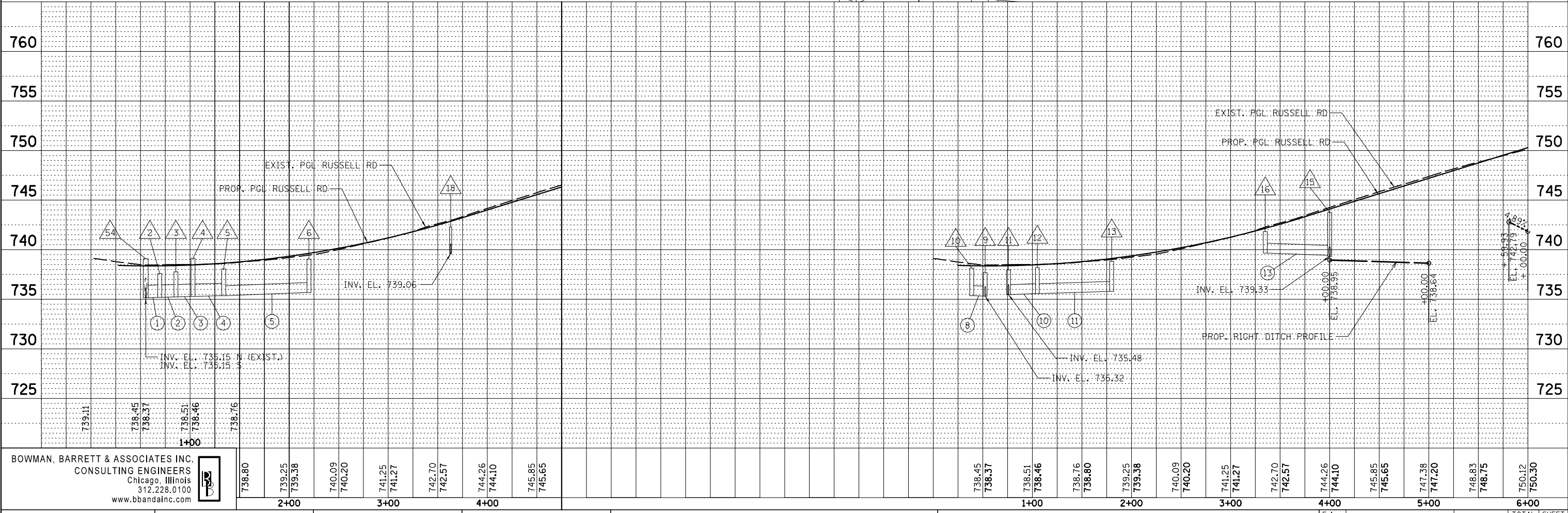
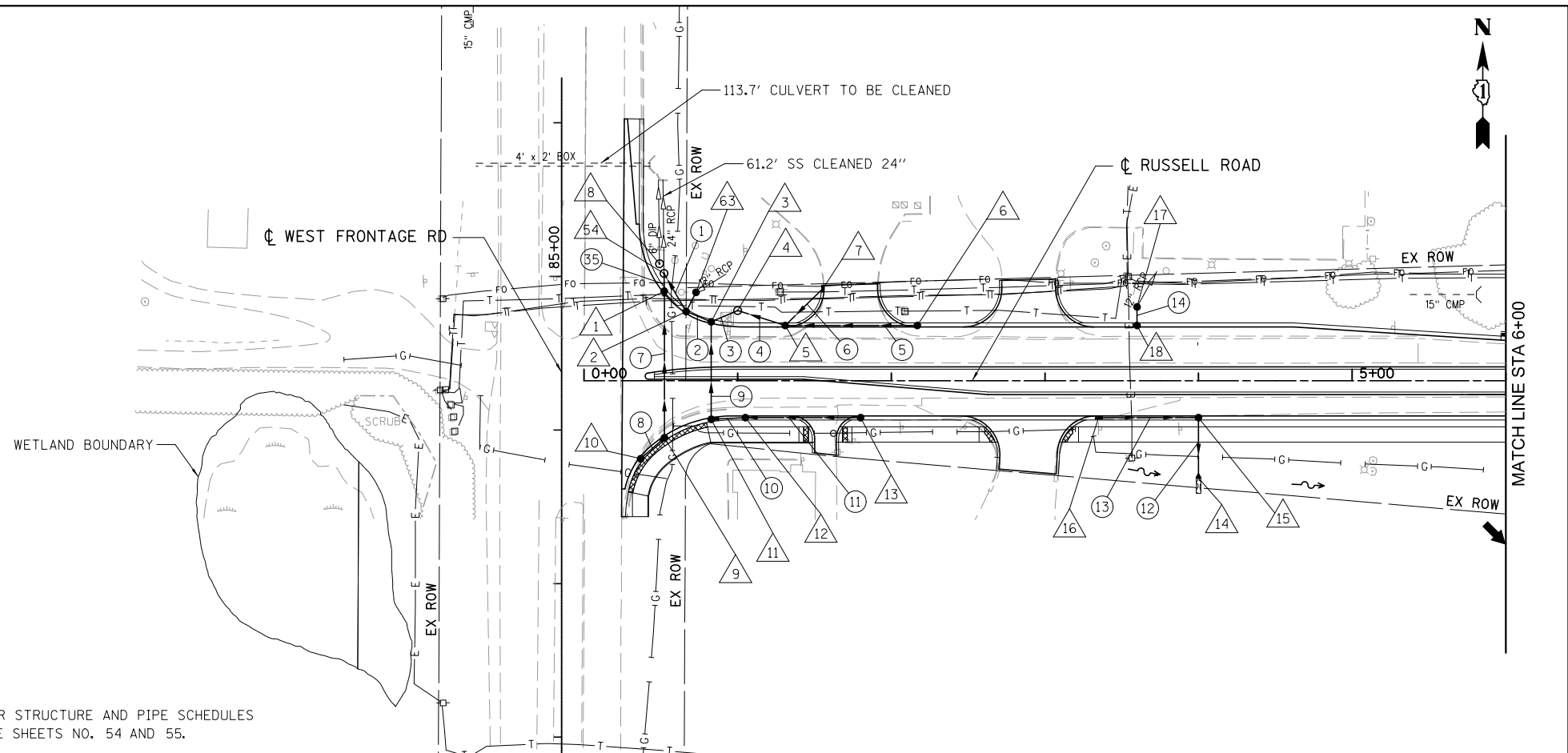

BOWMAN, BARRETT & ASSOCIATES INC.
 CONSULTING ENGINEERS
 Chicago, Illinois
 312.228.0100
 www.bbainc.com

FILE NAME = #FILES#	USER NAME = default	DESIGNED - JAM	REVISED -
		DRAWN - JAM	REVISED -
		CHECKED - RGR	REVISED -
		DATE - 03/09/2012	REVISED -

**STATE OF ILLINOIS
 DEPARTMENT OF TRANSPORTATION**

**PROPOSED DRAINAGE PLAN AND PROFILE
 FOR RUSSELL ROAD**
 SCALE: 1"=50' SHEET NO. 1 OF 3 SHEETS STA. 0+00.00 TO STA. 6+00.00

F.A. RTF.	SECTION	COUNTY	TOTAL SHEETS	SHEET NO.
94	49-1(HB & HB-1R)	LAKE	225	48
CONTRACT NO. 60L76			ILLINOIS FED. AID PROJECT	

S:\101\05_CADD\60L76_Russell_Road\60L76_Sheets\0160L76-sh1-drain01.dgn