

STATE OF ILLINOIS  
DEPARTMENT OF TRANSPORTATION  
RIGHT OF WAY PLANS  
**FOR PROPOSED  
FEDERAL AID HIGHWAY**

ROUTE: INTERSTATE 94  
SECTION: AT RUSSELL ROAD  
PROJECT NO:  
JOB NO.: R-91-025-09  
COUNTY: LAKE  
LIMITS: 1001 + 98.82 TO 1031 + 62.38

F.A. RTE.	SECTION	COUNTY	TOTAL SHEETS	SHEET NO.
94	AT RUSSELL ROAD	LAKE	6	1
FED. ROAD DIST. NO. 1		ILLINOIS	CONTRACT NO.	

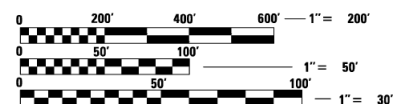
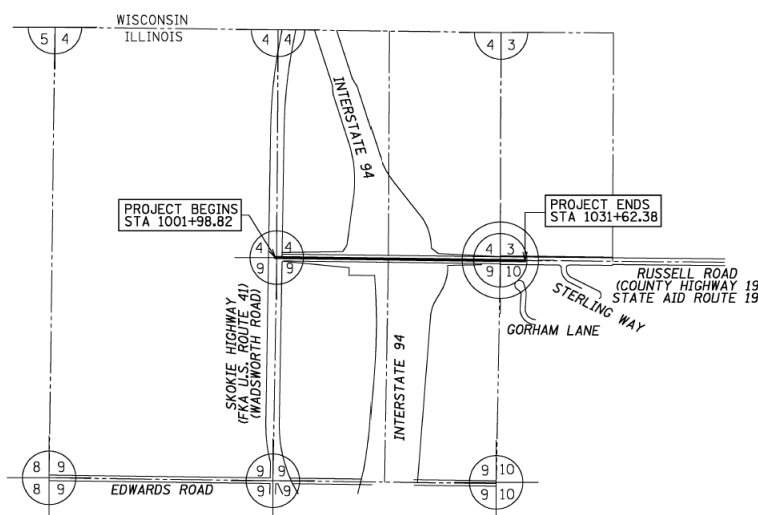

FULL SIZE PLANS HAVE BEEN PREPARED USING STANDARD ENGINEERING SCALES. REDUCED SIZED PLANS WILL NOT CONFORM TO STANDARD SCALES. IN MAKING MEASUREMENTS ON REDUCED PLANS, THE ABOVE SCALES MAY BE USED.

PROJECT LENGTH = 2963.56 LINEAL FEET (0.561 MILES), RUSSELL ROAD

**STATE OF ILLINOIS  
DEPARTMENT OF TRANSPORTATION  
DIVISION OF HIGHWAYS**

SUBMITTED \_\_\_\_\_ 20 \_\_\_\_\_  
DISTRICT ENGINEER

EXAMINED \_\_\_\_\_ 20 \_\_\_\_\_  
DISTRICT RIGHT OF WAY PLANS ENGINEER

PASSED \_\_\_\_\_ 20 \_\_\_\_\_  
DISTRICT LAND ACQUISITION ENGINEER

REVIEWED \_\_\_\_\_ 20 \_\_\_\_\_  
CENTRAL BUREAU RIGHT OF WAY PLANS ENGINEER

APPROVED \_\_\_\_\_ 20 \_\_\_\_\_  
ENGINEER OF LAND ACQUISITION



**Mackie Consultants, LLC**  
9575 W Higgins Road, Suite 500  
Rosemont, IL 60018  
(847)696-1400  
www.mackieconsult.com

FOR INFORMATION ONLY

FILE NAME = #FILES#	USER NAME = default	DESIGNED -	REVISED -	<b>STATE OF ILLINOIS DEPARTMENT OF TRANSPORTATION</b>	<b>RUSSELL ROAD RIGHT OF WAY PLANS</b>	F.A. RTE.	SECTION	COUNTY	TOTAL SHEETS	SHEET NO.	
		DRAWN -	REVISED -			94	49-1(HB & HB-1R)	LAKE	225	56	
	PLOT SCALE = #SCALE#	CHECKED - RGR	REVISED -			CONTRACT NO. 60L76					
	PLOT DATE = 2/9/2012	DATE - 01/25/2012	REVISED -			SCALE:	SHEET NO. 1 OF 7 SHEETS	STA. N/A	TO STA. N/A	ILLINOIS FED. AID PROJECT	

S:\1101\95-CADD\60L76 Russel11 Rdwy\60L76 Sheets\0160L76-shr-compland.dgn