

1/27/2012 3:50:39 PM

S:\101\05_CADD\60L76_RussellRdwy\60L76_Sheets\0490533-60L76-010-ASEE.dgn

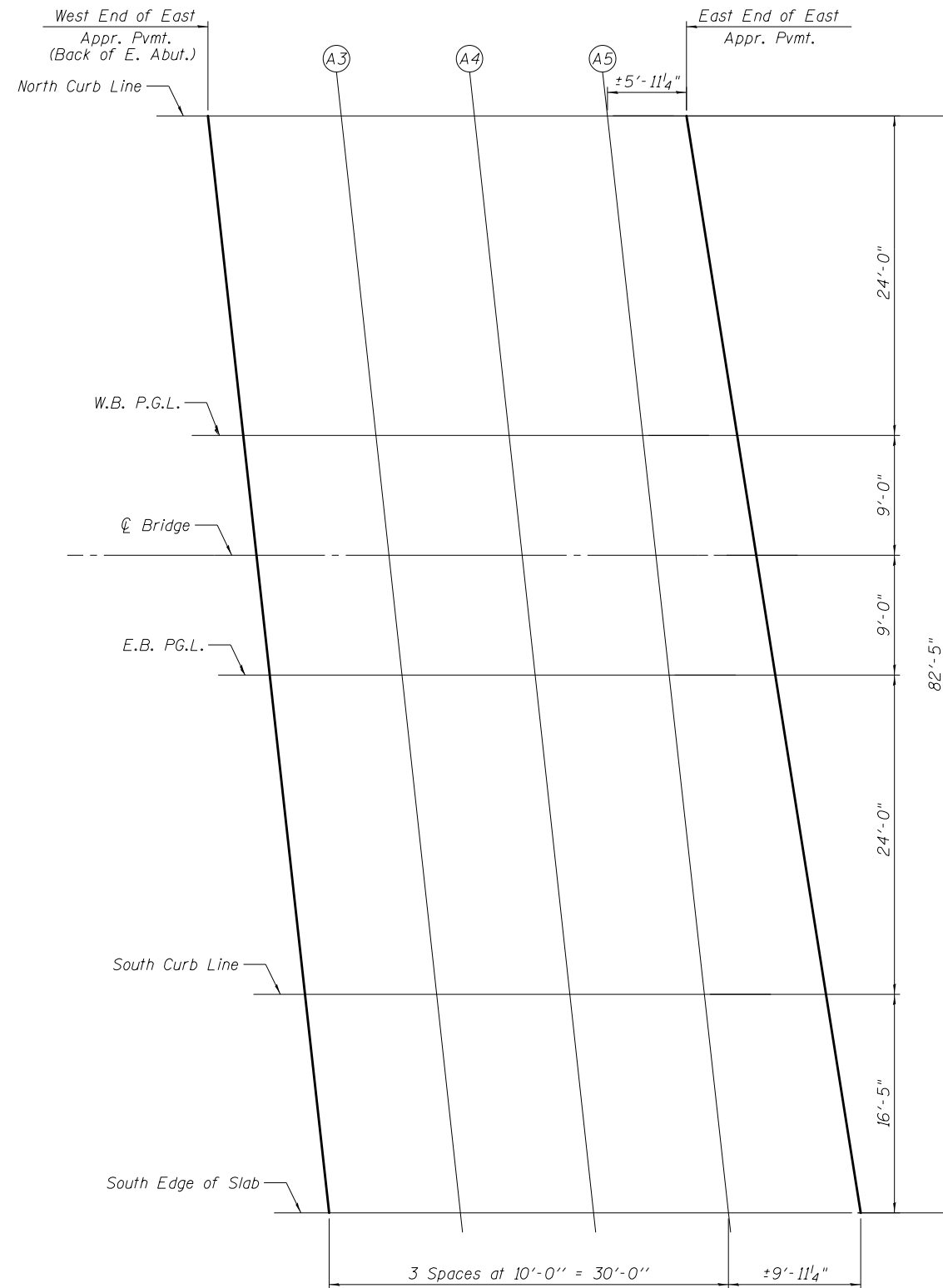

PLAN



NORTH CURB LINE

Location	Station	Offset	Theoretical Grade Elevations
West End of East Appr. Pvm.	12+96.42	-33.00	758.58
A3	13+06.42	-33.00	758.49
A4	13+16.42	-33.00	758.40
A5	13+26.42	-33.00	758.30
East End of East Appr. Pvm.	13+32.43	-33.00	758.23

WB P.G.L.

Location	Station	Offset	Theoretical Grade Elevations
West End of East Appr. Pvm.	12+99.07	-9.00	759.06
A3	13+09.07	-9.00	758.97
A4	13+19.07	-9.00	758.87
A5	13+29.07	-9.00	758.77
East End of East Appr. Pvm.	13+36.22	-9.00	758.69

BRIDGE CENTERLINE

Location	Station	Offset	Theoretical Grade Elevations
West End of East Appr. Pvm.	13+00.06	0.00	759.24
A3	13+10.06	0.00	759.15
A4	13+20.06	0.00	759.05
A5	13+30.06	0.00	758.94
East End of East Appr. Pvm.	13+37.65	0.00	758.86

EB P.G.L.

Location	Station	Offset	Theoretical Grade Elevations
West End of East Appr. Pvm.	13+01.06	9.00	759.04
A3	13+11.06	9.00	758.95
A4	13+21.06	9.00	758.85
A5	13+31.06	9.00	758.75
East End of East Appr. Pvm.	13+39.07	9.00	758.66

SOUTH CURB LINE

Location	Station	Offset	Theoretical Grade Elevations
West End of East Appr. Pvm.	13+03.70	33.00	758.52
A3	13+13.70	33.00	758.42
A4	13+23.70	33.00	758.32
A5	13+33.70	33.00	758.22
East End of East Appr. Pvm.	13+42.86	33.00	758.11

SOUTH EDGE OF SLAB

Location	Station	Offset	Theoretical Grade Elevations
West End of East Appr. Pvm.	13+05.52	49.42	758.84
A3	13+15.52	49.42	758.75
A4	13+25.52	49.42	758.65
A5	13+35.52	49.42	758.54
East End of East Appr. Pvm.	13+45.45	49.42	758.43

BOWMAN, BARRETT & ASSOCIATES INC.
CONSULTING ENGINEERS
Chicago, Illinois
312.228.0100
www.bbandainc.com



FILE NAME =	USER NAME =	DESIGNED - MRM	REVISIONS -
		CHECKED - TL	REVISIONS -
		DRAWN - LAM	REVISIONS -
		CHECKED - SF	REVISIONS -

STATE OF ILLINOIS
DEPARTMENT OF TRANSPORTATION

TOP OF EAST APPROACH SLAB ELEVATIONS
STRUCTURE NO. 049-0533

SHEET NO. S-9 OF S-33 SHEETS

F.A.U. RTE.	SECTION	COUNTY	TOTAL SHEETS	SHEET NO.
1199	49-1(HB & HB-1R)	LAKE	225	123
CONTRACT NO. 60L76				
ILLINOIS FED. AID PROJECT				