

NORTH EDGE OF SHOULDER

Location	Station	Offset	Theoretical Grade Elevations
W. End West Appr. Pav't	13+32.44	-33.00	758.24
A1	13+42.44	-33.00	758.12
A2	13+52.44	-33.00	758.01
A3	13+62.44	-33.00	757.88
E. End West Appr. Pav't	13+68.45	-33.00	757.80

WEST BOUND PROFILE GRADE

Location	Station	Offset	Theoretical Grade Elevations
W. End West Appr. Pav't	13+36.23	-9.00	758.69
A1	13+46.23	-9.00	758.58
A2	13+56.23	-9.00	758.46
A3	13+66.23	-9.00	758.33
E. End West Appr. Pav't	13+73.38	-9.00	758.24

☉ ROADWAY

Location	Station	Offset	Theoretical Grade Elevations
W. End West Appr. Pav't	13+37.65	0.00	758.87
A1	13+47.65	0.00	758.75
A2	13+57.65	0.00	758.63
A3	13+67.65	0.00	758.50
E. End West Appr. Pav't	13+75.23	0.00	758.40

EAST BOUND PROFILE GRADE

Location	Station	Offset	Theoretical Grade Elevations
W. End West Appr. Pav't	13+39.07	9.00	758.66
A1	13+49.07	9.00	758.55
A2	13+59.07	9.00	758.42
A3	13+69.07	9.00	758.30
E. End West Appr. Pav't	13+77.08	9.00	758.19

SOUTH EDGE OF SHOULDER

Location	Station	Offset	Theoretical Grade Elevations
W. End West Appr. Pav't	13+42.86	33.00	758.12
A1	13+52.86	33.00	758.00
A2	13+62.86	33.00	757.88
A3	13+72.86	33.00	757.74
E. End West Appr. Pav't	13+82.01	33.00	757.62

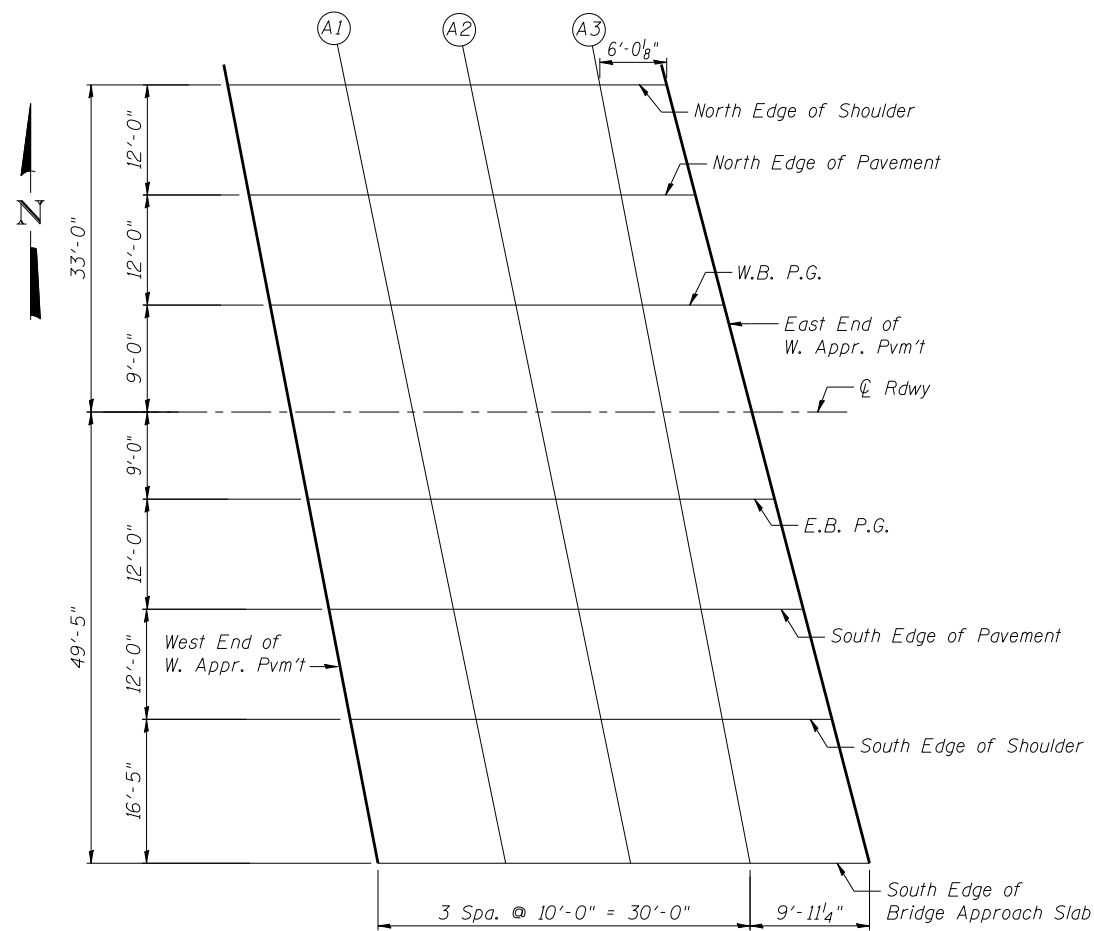

PLAN
West Approach

SOUTH EDGE OF APPROACH SLAB

Location	Station	Offset	Theoretical Grade Elevations
W. End West Appr. Pav't	13+45.46	49.42	758.43
A1	13+55.46	49.42	758.31
A2	13+65.46	49.42	758.18
A3	13+75.46	49.42	758.05
E. End West Appr. Pav't	13+85.39	49.42	757.91



FILE NAME =	USER NAME =	DESIGNED - LRT / AG	REVISED -
		CHECKED - OAO / LRT	REVISED -
	PLOT SCALE =	DRAWN - TCS / AG	REVISED -
	PLOT DATE =	CHECKED - AG	REVISED -

**STATE OF ILLINOIS
DEPARTMENT OF TRANSPORTATION**

**TOP OF WEST APPROACH SLAB ELEVATIONS
STRUCTURE NO. 049-0534**

SHEET NO. 7 OF 31 SHEETS

F.A.U. RTE.	SECTION	COUNTY	TOTAL SHEETS	SHEET NO.
1199	49-1(HB & HB-1R)	LAKE	225	154
CONTRACT NO. 60L76				

ILLINOIS FED. AID PROJECT