

NORTH EDGE OF SHOULDER

Location	Station	Offset	Theoretical Grade Elevations
W. End East Appr. Pav't	15+04.82	- 33.00	755.45
A4	15+14.82	- 33.00	755.23
A5	15+24.82	- 33.00	755.00
E. End East Appr. Pav't	15+34.82	- 33.00	754.77

WEST BOUND PROFILE GRADE

Location	Station	Offset	Theoretical Grade Elevations
W. End East Appr. Pav't	15+09.75	- 9.00	755.84
A4	15+19.75	- 9.00	755.62
A5	15+29.75	- 9.00	755.39
E. End East Appr. Pav't	15+39.75	- 9.00	755.16

CL ROADWAY

Location	Station	Offset	Theoretical Grade Elevations
W. End East Appr. Pav't	15+11.60	0.00	755.99
A4	15+21.60	0.00	755.76
A5	15+31.60	0.00	755.54
E. End East Appr. Pav't	15+41.60	0.00	755.30

EAST BOUND PROFILE GRADE

Location	Station	Offset	Theoretical Grade Elevations
W. End East Appr. Pav't	15+13.45	9.00	755.76
A4	15+23.45	9.00	755.53
A5	15+33.45	9.00	755.30
E. End East Appr. Pav't	15+43.45	9.00	755.07

SOUTH EDGE OF SHOULDER

Location	Station	Offset	Theoretical Grade Elevations
W. End East Appr. Pav't	15+18.38	33.00	755.15
A4	15+28.38	33.00	754.92
A5	15+38.38	33.00	754.69
E. End East Appr. Pav't	15+48.38	33.00	754.45

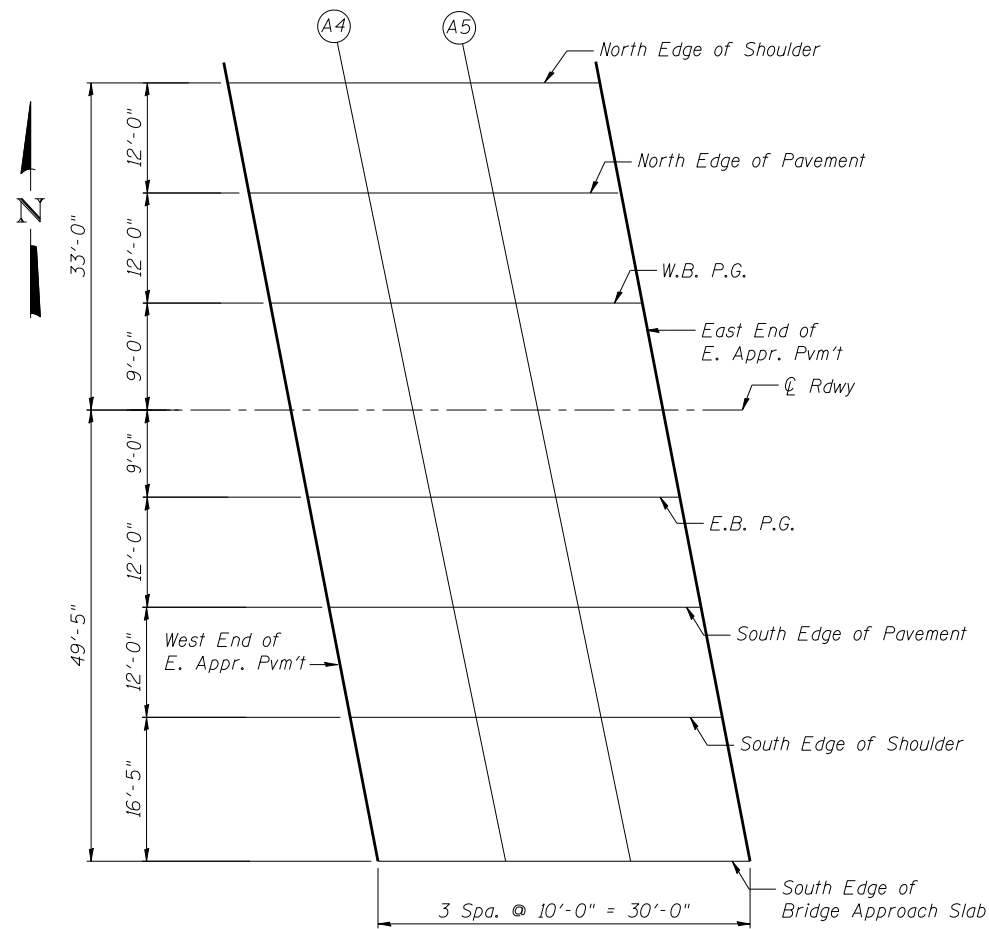

PLAN
East Approach

SOUTH EDGE OF APPROACH SLAB

Location	Station	Offset	Theoretical Grade Elevations
W. End East Appr. Pav't	15+21.76	49.42	755.41
A4	15+31.76	49.42	755.19
A5	15+41.76	49.42	754.95
E. End East Appr. Pav't	15+51.76	49.42	754.71



FILE NAME =	USER NAME =	DESIGNED - LRT / AG	REVISED -
		CHECKED - OAO / LRT	REVISED -
		DRAWN - TCS / AG	REVISED -
		CHECKED - AG	REVISED -

**STATE OF ILLINOIS
DEPARTMENT OF TRANSPORTATION**

**TOP OF EAST APPROACH SLAB ELEVATIONS
STRUCTURE NO. 049-0534**

SHEET NO. 8 OF 31 SHEETS

F.A.U. RTE.	SECTION	COUNTY	TOTAL SHEETS	SHEET NO.
1199	49-1(HB & HB-1)R	LAKE	225	155
				CONTRACT NO. 60L76

ILLINOIS FED. AID PROJECT