

**LEGEND**

- ① TEMPORARY CONCRETE BARRIER
- ② PAVEMENT MARKING TAPE, TYPE III 4" (WHITE)
- ③ WET REFLECTIVE TEMPORARY TAPE, TYPE III 5" (WHITE)  
10' DASH 30' SKIP
- ④ PAVEMENT MARKING TAPE, TYPE III 4" (YELLOW)
- ⑤ WET REFLECTIVE TEMPORARY TAPE, TYPE III 8" (WHITE)
- ⑥ WET REFLECTIVE TEMPORARY TAPE, TYPE III 8" (YELLOW)
- ⑦ PAVEMENT MARKING TAPE, TYPE III 12" (WHITE)  
30' OFFSET C-C (TYP.)
- ⑧ IMPACT ATTENUATORS, TEMPORARY (FULLY REDIRECTIVE  
NARROW), TEST LEVEL 3

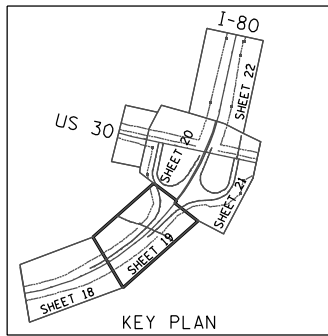

NOTE:  
EXISTING GUARDRAIL TO BE REMOVED  
AND REERECTED AS NEEDED FOR  
CONSTRUCTION ACCESS.

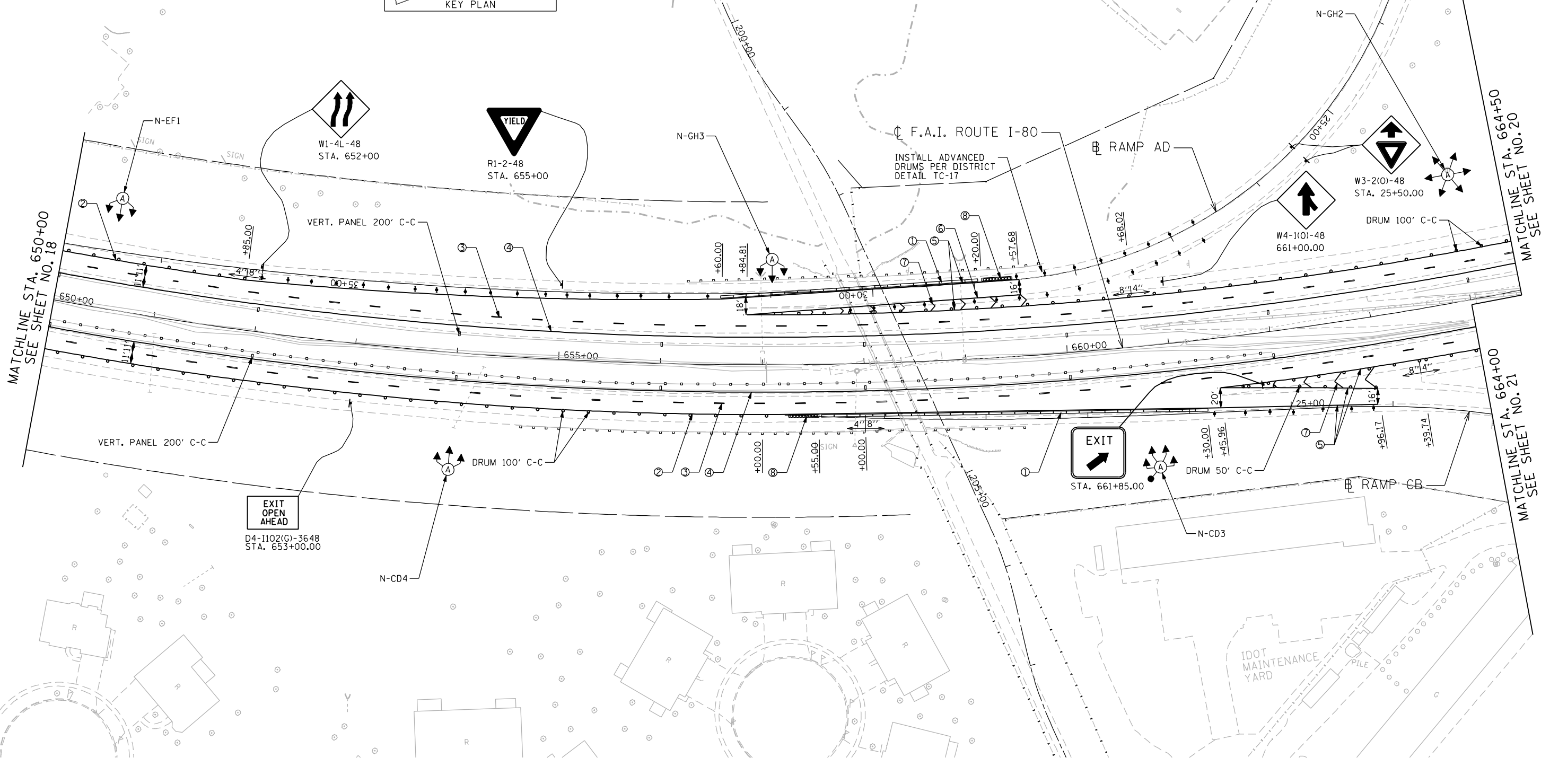
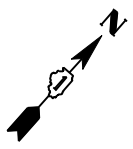

\\svr202\public\proj\10002384-00\6\_high\_mast\design\MDT\3384\_6\_US30\_High\_Mast.ms02.dgn

**ENGINEERING CONSULTANT**  
**Ciorba Group, Inc.**  
 CONSULTING ENGINEERS  
 8607 North Cumberland Avenue, Suite 402  
 Chicago, Illinois 60631  
 Tel. 773.778.4000 Fax 773.778.4914  
 Email: ciorba@ciorba.com

USER NAME = jk.jeilman	DESIGNED - JMK	REVISED -
PLDT SCALE = 100.0000' / IN.	DRAWN - JMK	REVISED -
PLDT DATE = 3/22/2012	CHECKED - MJL	REVISED -
	DATE - 02-14-2012	REVISED -

**STATE OF ILLINOIS  
DEPARTMENT OF TRANSPORTATION**

**F.A.I. ROUTE 80 AT U.S. ROUTE 30 LIGHTING  
STAGING AND TRAFFIC CONTROL PLAN**

SCALE: 1" = 50' SHEET NO. OF SHEETS STA. TO STA.

F.A.I. RTE. 80	SECTION 2011-046-L	COUNTY WILL	TOTAL SHEETS 106	SHEET NO. 19
			CONTRACT NO. 60P56	
ILLINOIS FED. AID PROJECT				