

**INDEX OF SHEETS**

SHEET NO.	DESCRIPTION
1	TITLE SHEET
2	INDEX OF SHEETS, STATE STANDARDS AND GENERAL NOTES
3	SUMMARY OF QUANTITIES
4 - 30	PROPOSED PLANS AND PAVEMENT MARKING PLANS
31	CRACK & JOINT SEALING DETAIL
32	FREEWAY ENTRANCE AND EXIT RAMP (TC-08)
33	TRAFFIC CONTROL DETAILS FOR FREEWAY SINGLE & MULTI-LANE WEAVE (TC-09)
34 - 35	MULTI-LANE FREEWAY PAVEMENT MARKING DETAILS (TC-12)
36	DISTRICT ONE TYPICAL PAVEMENT MARKINGS (TC-13)
37	TRAFFIC CONTROL AND PROTECTION AT TURN BAYS (TO REMAIN OPEN TO TRAFFIC) (TC-14)
38	TRAFFIC CONTROL DETAILS FOR FREEWAY SHOULDER CLOSURES AND PARTIAL RAMP CLOSURES (TC-17)

**STANDARDS**

- 701400-05 APPROACH TO LANE CLOSURE, FREEWAY/EXPRESSWAY
- 701401-06 LANE CLOSURE, FREEWAY/EXPRESSWAY
- 701411-08 LANE CLOSURE, MULTILANE AT ENTRANCE OR EXIT RAMP, FOR SPEEDS  $\geq$  45 MPH
- 701426-04 LANE CLOSURE, MULTILANE, INTERMITTENT OR MOVING OPERATION, FOR SPEEDS  $\geq$  45 MPH
- 701446-03 TWO LANE CLOSURE FREEWAY/EXPRESSWAY
- 701901-02 TRAFFIC CONTROL DEVICES

780001-03 

**GENERAL NOTES**

BEFORE STARTING ANY EXCAVATION, THE CONTRACTOR SHALL CALL "JULIE" AT (800) 892-0123 OR 811 FOR FIELD LOCATIONS OF BURIED ELECTRIC, TELEPHONE AND GAS UTILITIES. (48 HOUR NOTIFICATION IS REQUIRED).

THE CONTRACT SHALL COORDINATE CONSTRUCTION ACTIVITIES WITH UTILITY COMPANIES AND THE VILLAGES OF SHOREWOOD, PLAINFIELD AND BOLINGBROOK AND COYNES (UNINC.) TOWNSHIP.

THE CONTRACTOR WILL NOT BE ALLOWED TO SET UP A YARD OR FIELD OFFICE ON STATE PROPERTY WITHOUT WRITTEN PERMISSION FROM THE DEPARTMENT.

IT SHALL BE THE CONTRACTOR'S RESPONSIBILITY TO VERIFY ALL DIMENSIONS AND CONDITIONS EXISTING IN THE FIELD PRIOR TO CONSTRUCTION AND ORDERING OF MATERIALS.

THE CONTRACTOR SHALL CONTACT THE DISTRICT ONE TRAFFIC CONTROL SUPERVISOR AT (847) 705-4151 A MINIMUM OF 72 HOURS IN ADVANCE OF BEGINNING WORK.

THE ENGINEER SHALL CONTACT LAWRENCE HILL, AREA TRAFFIC FIELD ENGINEER, AT (815) 485-6475 A MINIMUM OF TWO (2) WEEKS PRIOR TO THE PLACEMENT OF PERMANENT PAVEMENT MARKINGS.

ALL CRACK ROUTING & CRACK SEALING LOCATIONS WILL BE DETERMINED IN THE FIELD BY THE ENGINEER. CRACK ROUTING SHALL BE OMITTED WHERE VEHICLE DETECTOR LOOPS & RAISED REFLECTIVE PAVEMENT MARKERS ARE PRESENT IN THE PAVEMENT.

MATERIALS RESULTING FROM THE ROUTING OF CRACKS IN THE EXISTING PAVEMENT MAY BE PLACED, SHAPED AND COMPACTED TO THE SATISFACTION OF THE ENGINEER ALONG EXISTING AGGREGATE SHOULDERS ADJACENT TO THE PAVEMENT. ALL MATERIALS RESULTING FROM THE ROUTING OF CRACKS IN PAVEMENTS WITHOUT AGGREGATE SHOULDERS AND SURPLUS MATERIALS RESULTING FROM THE ROUTING OF CRACKS IN PAVEMENTS WITH AGGREGATE SHOULDERS, WHERE ALL MATERIALS ARE NOT PLACED ALONG EXISTING AGGREGATE SHOULDERS, SHALL BE DISPOSED OF AS SPECIFIED IN ARTICLE 202.03 OF THE STANDARD SPECIFICATIONS. OLD SEALANTS REMOVED PRIOR TO ROUTING SHALL BE DISPOSED OF AS SPECIFIED IN ARTICLE 202.03. THIS WORK WILL NOT BE PAID FOR SEPARATELY, BUT THE COST SHALL BE CONSIDERED AS INCLUDED IN THE CONTRACT UNIT PRICE FOR THE CONSTRUCTION ITEMS INVOLVED, AND NO ADDITIONAL COMPENSATION WILL BE ALLOWED.

DO NOT SCALE PLANS FOR CONSTRUCTION DIMENSIONS.

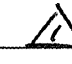
 Rev. 4-12-12

FILE NAME P123612-shr-plan.dgn	USER NAME = msdyje	DESIGNED -	REVISED -	<b>STATE OF ILLINOIS DEPARTMENT OF TRANSPORTATION</b>	<b>I-55 (NORTH OF I-80 TO WEBER RD.) INDEX OF SHEETS, LIST OF STATE STANDARDS &amp; PLAN NOTES</b>		F.A.I. RTE. 55	SECTION 2011-226-1	COUNTY WILL	TOTAL SHEETS 38	SHEET NO. 2	CONTRACT NO. 60R89
	PLOT SCALE = 50,0000' / in.	DRAWN -	REVISED -		SCALE: 1" = 50'	SHEET NO.	OF	SHEETS	STA.	TO STA.	ILLINOIS FED. AID PROJECT	
	PLOT DATE = 2/21/2012	CHECKED -	REVISED -									
		DATE -	REVISED -									

SUMMARY OF QUANTITIES			URBAN 100% STATE	CONSTRUCTION TYPE CODE				
CODE NO	ITEM	UNIT	TOTAL QUANTITIES	0005				
45100100	CRACK ROUTING (PAVEMENT)	FOOT	864,679	864,679				
45100200	CRACK FILLING	POUND	328,578	328,578				
67100100	MOBILIZATION	L SUM	1	1				
X7011015	TRAFFIC CONTROL AND PROTECTION (EXPRESSWAYS)	L SUM	1	1				
* X7800815	HOT SPRAY THERMOPLASTIC PAVEMENT MARKING LINE - 4 INCH	FOOT	286,724	286,724				
* X7800825	HOT SPRAY THERMOPLASTIC PAVEMENT MARKING LINE - 5 INCH	FOOT	312018	312018				
* X7800845	HOT SPRAY THERMOPLASTIC PAVEMENT MARKING LINE - 8 INCH	FOOT	32,394	32,394				

\*Specialty Items

Rev. 4-12-12

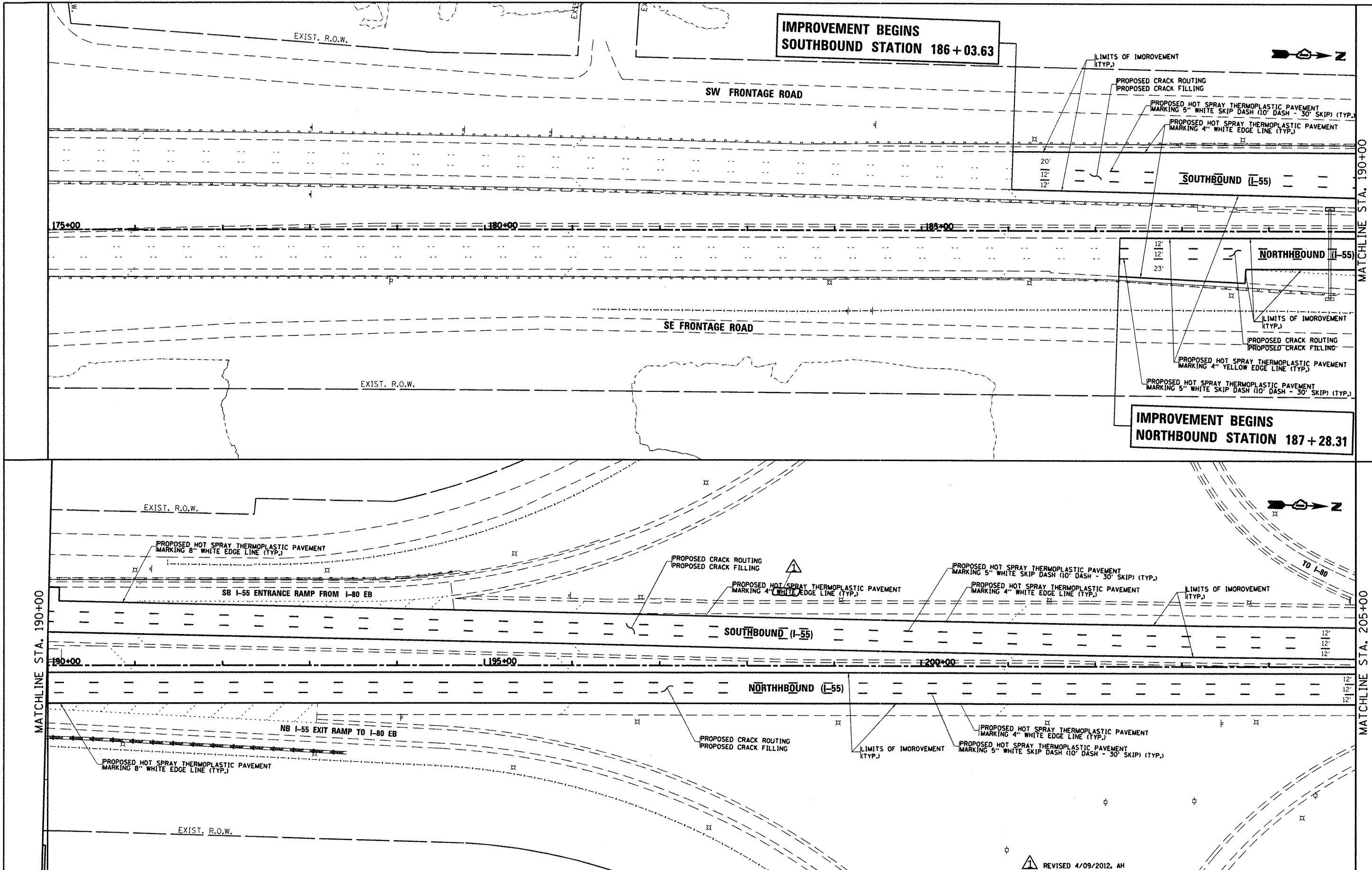

FILE NAME = c:\pwwork\p1dot\hmdanah\d0291538\p12  
 USER NAME = hmdanah  
 PLOT SCALE = 100.0000' / 1" = 100'  
 PLOT DATE = 4/11/2012

DESIGNED -	REVISIONS -
DRAWN -	REVISIONS -
CHECKED -	REVISIONS -
DATE -	REVISIONS -

**STATE OF ILLINOIS  
 DEPARTMENT OF TRANSPORTATION**

**I-55 (NORTH OF I-80 TO WEBER RD.)  
 PROPOSED PLANS AND PAVEMENT MARKING**

SCALE: 1"=50' SHEET OF SHEETS STA. TO STA.

F.A.I. RTE. 55	SECTION 2011-226-1	COUNTY WILL	TOTAL SHEETS 38	SHEET NO. 4
CONTRACT NO. 60R89			ILLINOIS FED. AID PROJECT	

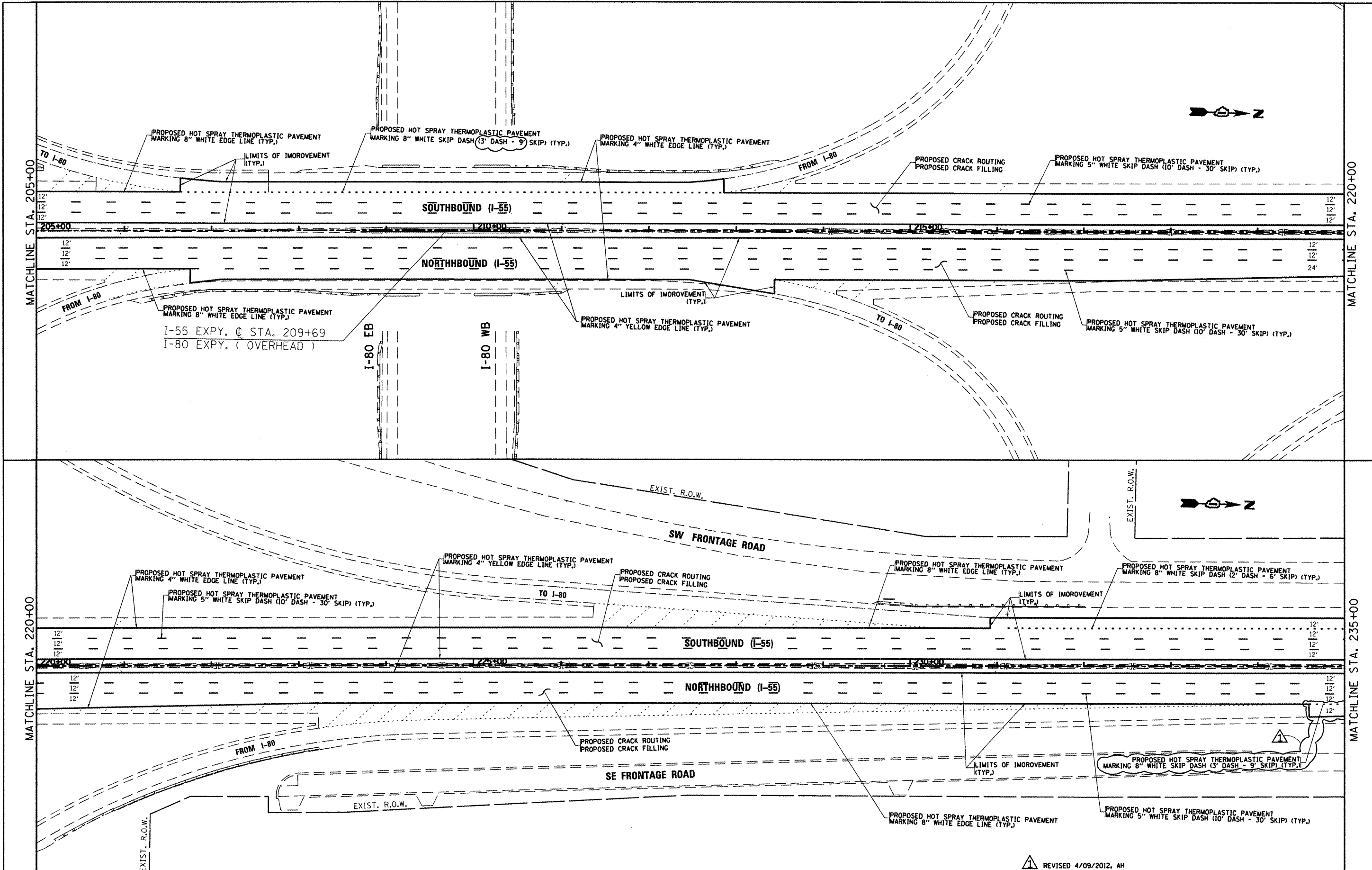

FILE NAME =  
 c:\pwwork\p12\hamdanah\0291536\p12

USER NAME = hamdanah  
 612-shr-plan.dgn  
 PLOT SCALE = 100.0000' / in.  
 PLOT DATE = 4/11/2012

DESIGNED -	REVISED -
DRAWN -	REVISED -
CHECKED -	REVISED -
DATE -	REVISED -

**STATE OF ILLINOIS  
 DEPARTMENT OF TRANSPORTATION**

**I-55 (NORTH OF I-80 TO WEBER RD.)  
 PROPOSED PLANS AND PAVEMENT MARKING**

SCALE: 1"=50' SHEET OF SHEETS STA. TO STA.

F.A.I. RTE.	SECTION	COUNTY	TOTAL SHEETS	SHEET NO.
55	2011-226-1	WILL	38	5
CONTRACT NO. 60R89			ILLINOIS FED. AID PROJECT	

REVISED 4/09/2012, AH



EXIST. R.O.W.

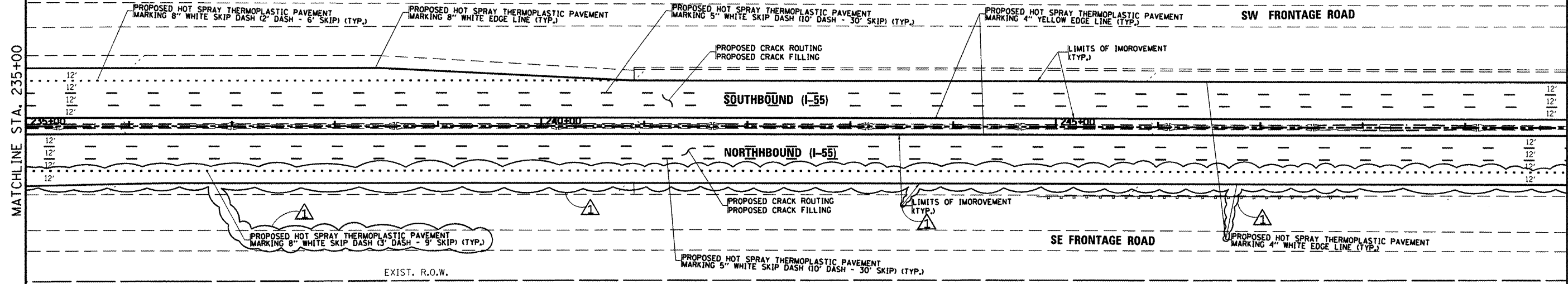

MATCHLINE STA. 235+00

MATCHLINE STA. 250+00



EXIST. R.O.W.

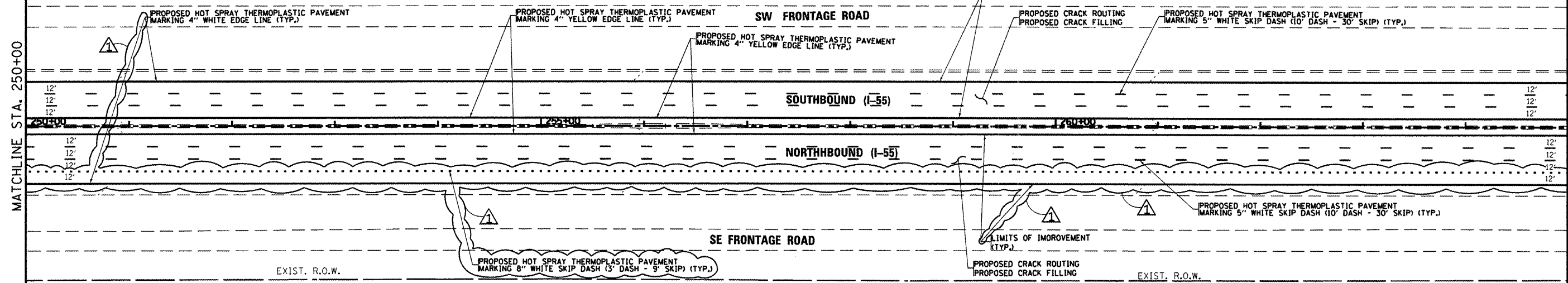

MATCHLINE STA. 250+00

MATCHLINE STA. 265+00

REVISD 4/09/2012, AH

FILE NAME =	USER NAME = hamdanah	DESIGNED -	REVISED -
c:\pwork\p12\dot\hamdanah\d0291538\p12\612-sht-plan.dgn		DRAWN -	REVISED -
		CHECKED -	REVISED -
		DATE -	REVISED -

STATE OF ILLINOIS  
DEPARTMENT OF TRANSPORTATION

I-55 (NORTH OF I-80 TO WEBER RD.)  
PROPOSED PLANS AND PAVEMENT MARKING

SCALE: 1"=50'

SHEET OF SHEETS STA. TO STA.

F.A.I. RTE. 55	SECTION 2011-226-1	COUNTY WILL	TOTAL SHEETS 38	SHEET NO. 6
CONTRACT NO. 60R89				
ILLINOIS FED. AID PROJECT				

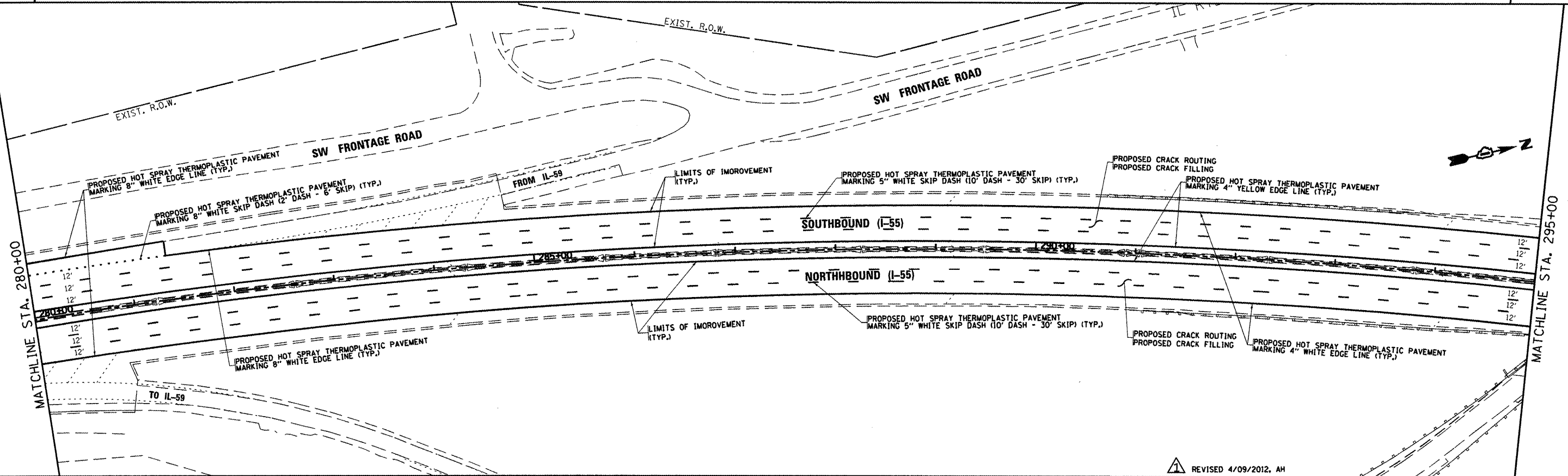
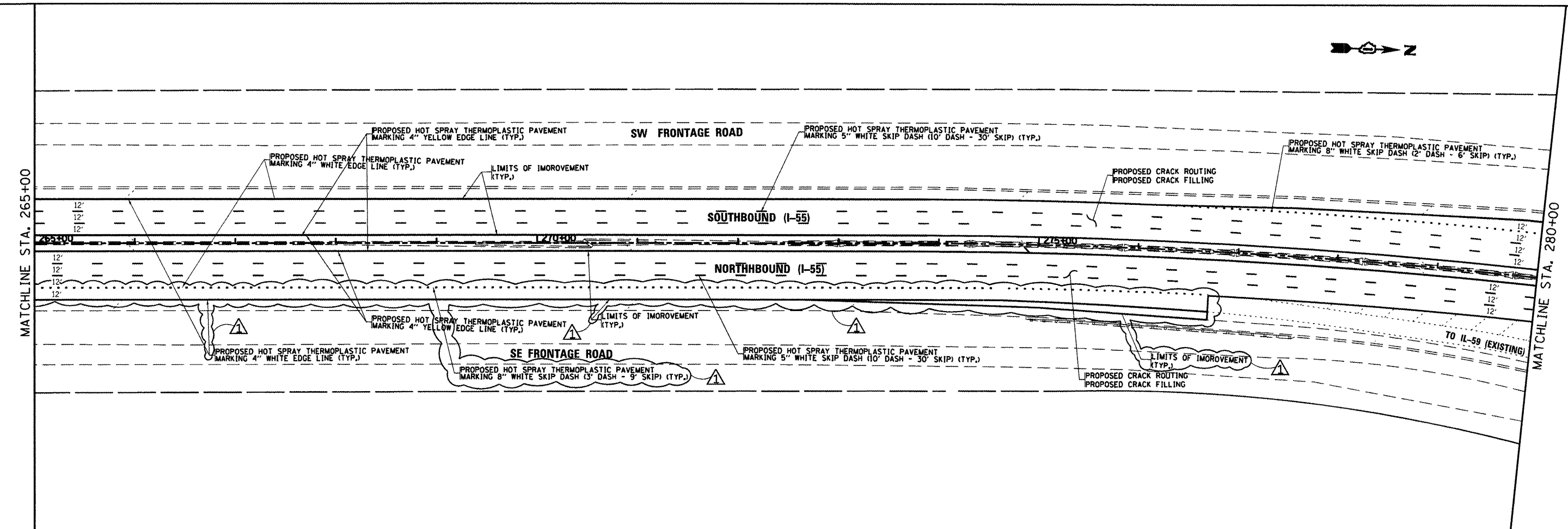

FILE NAME =	USER NAME = hamdanah	DESIGNED -	REVISED -
ct:\p_w\k\p\dot\hamdanah\0291538\PI2	612\sh\plan.dgn	DRAWN -	REVISED -
	PLOT SCALE = 100.0000 / 1"	CHECKED -	REVISED -
	PLOT DATE = 4/11/2012	DATE -	REVISED -

**STATE OF ILLINOIS  
DEPARTMENT OF TRANSPORTATION**

**I-55 (NORTH OF I-80 TO WEBER RD.)  
PROPOSED PLANS AND PAVEMENT MARKING**

SCALE: 1"=50'      SHEET    OF    SHEETS    STA.            TO STA.

F.A.I. RTE. = 55	SECTION = 2011-226-1	COUNTY = WILL	TOTAL SHEETS = 38	SHEET NO. = 7
CONTRACT NO. 60R89				
ILLINOIS FED. AID PROJECT				

REVISD 4/09/2012, AH

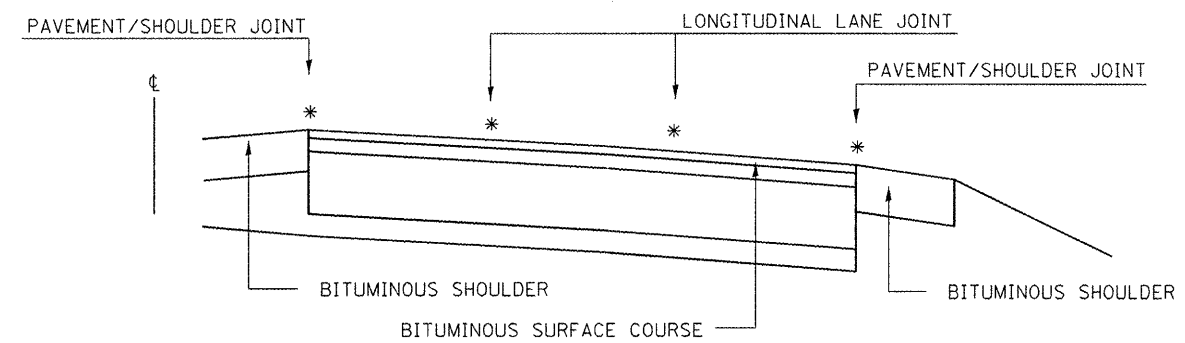

MULTI-LANE DIVIDED PAVEMENT

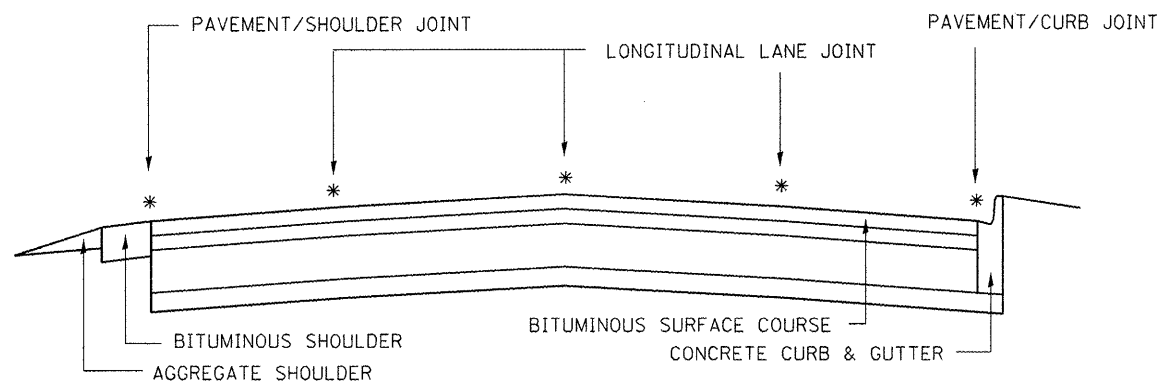

MULTI-LANE UNDIVIDED PAVEMENT

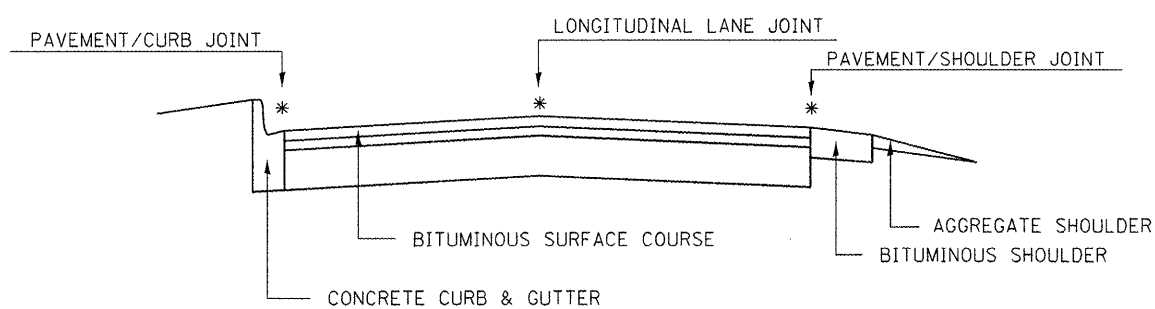

TWO-LANE PAVEMENT

PROPOSED TRANSVERSE CRACK ROUTING (PAVEMENT) & CRACK FILLING LOCATIONS NOT SHOWN

\* PROPOSED LONGITUDINAL CRACK ROUTING (PAVEMENT) & CRACK FILLING LOCATIONS

GENERAL EXISTING TYPICAL SECTIONS

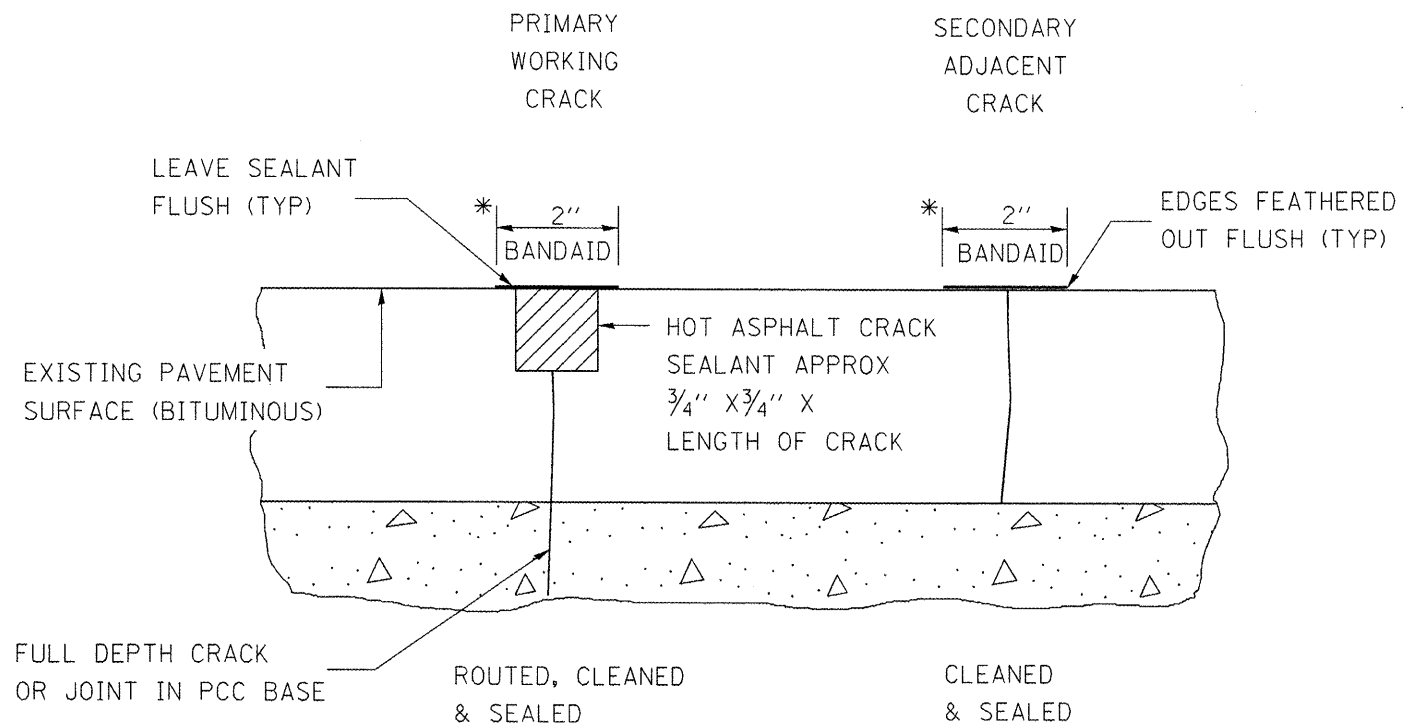

\* IN ALL LOCATIONS WHERE THE LONGITUDINAL CRACK CONFLICTS WITH EXISTING PAVEMENT MARKINGS (EITHER EDGE LINE OR LANE LINE) THE CRACK SHALL BE ROUTED & THE RESULTING RESERVOIR FILLED WITH SEALANT. HOWEVER, THE 2" BANDAID SEALANT STRIP SHALL BE DELETED TO PREVENT UNNECESSARY DAMAGE TO THE EXISTING PAVEMENT MARKINGS. ALL DAMAGES TO EXISTING RAISED REFLECTIVE PAVEMENT MARKERS SHALL BE REPLACED AT THE EXPENSE OF THE CONTRACTOR. ALL EXISTING PAVEMENT MARKINGS WITHIN THE PROJECT LIMITS SHALL BE RESTORED WITH HOT SPRAY THERMOPLASTIC PAVEMENT MARKINGS.

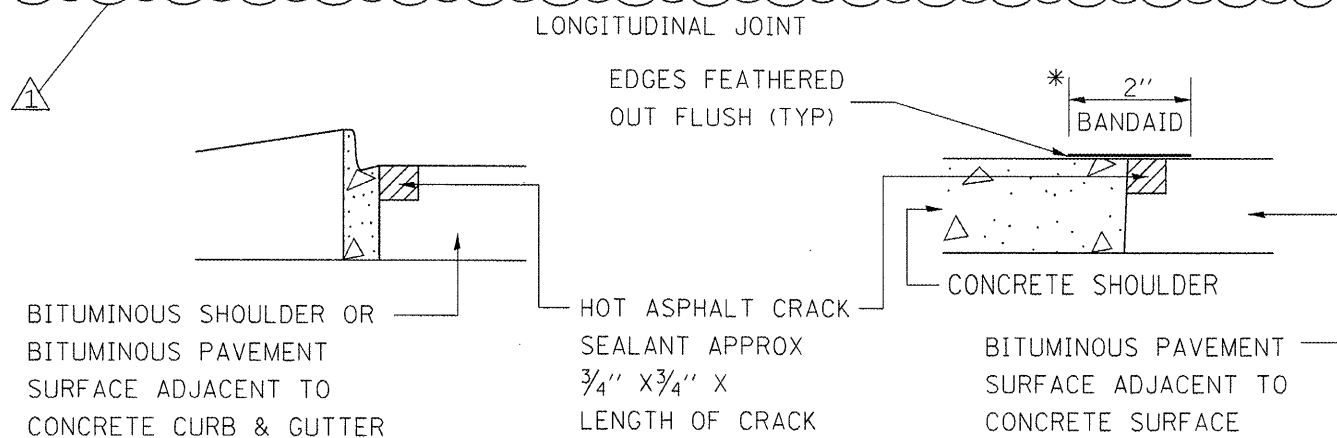

CRACK & JOINT SEALING DETAIL

REVISD 4/09/2012, JBE

FILE NAME = P123612-shr-plan.dgn	USER NAME = hamdanah	DESIGNED -	REVISED -
		DRAWN -	REVISED -
		CHECKED -	REVISED -
		DATE -	REVISED -

STATE OF ILLINOIS  
DEPARTMENT OF TRANSPORTATION

CRACK & JOINT SEALING DETAIL			
I-55 (NORTH OF I-80 TO WEBER RD.)			
SCALE:	SHEET NO.	OF SHEETS	STA. TO STA.

F.A.I. RTE. 55	SECTION 2011-226-1	COUNTY WILL	TOTAL SHEETS 38	SHEET NO. 31
CONTRACT NO. 60R89				ILLINOIS FED. AID PROJECT