

FOR INFORMATION ONLY

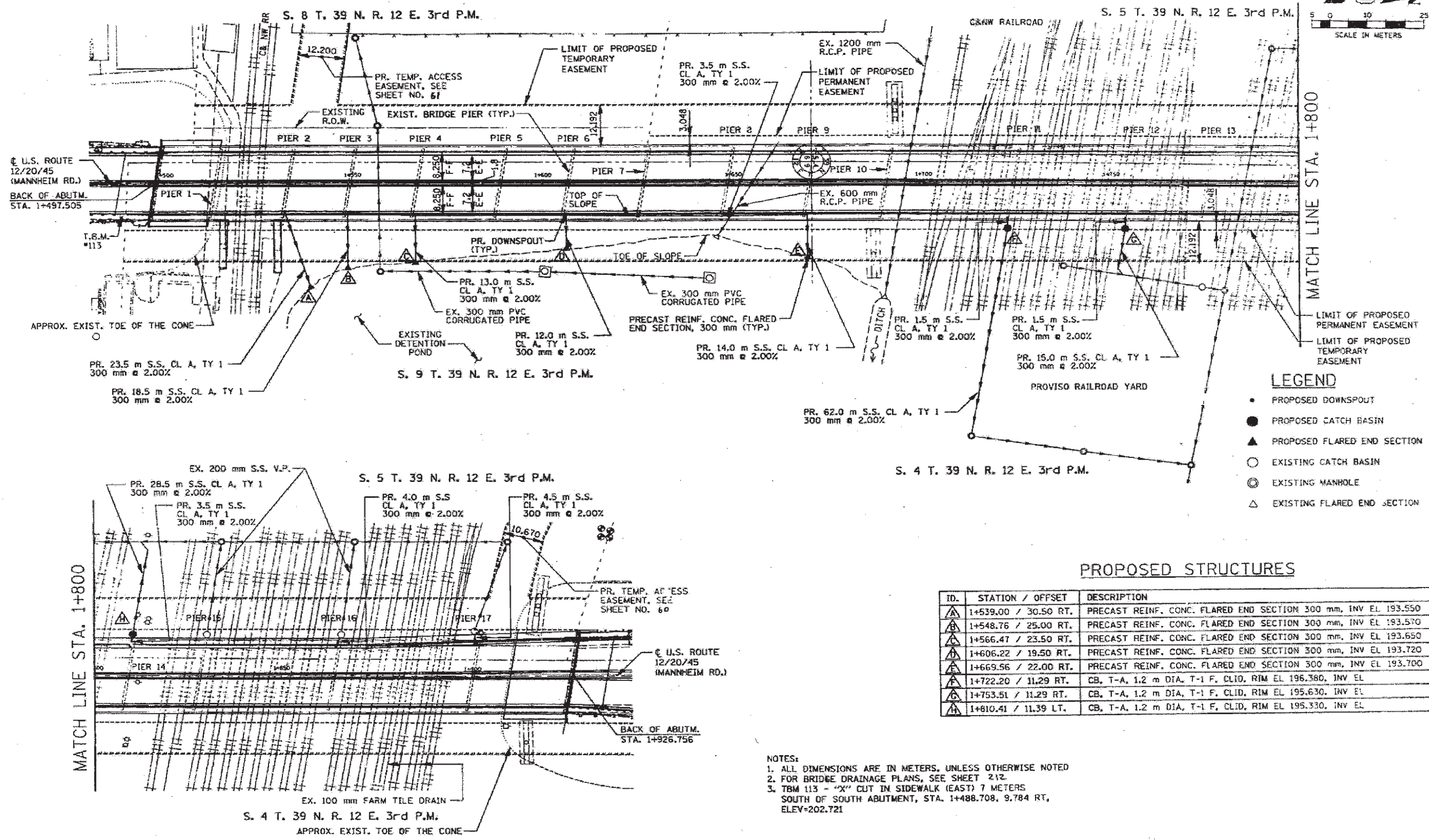

- LEGEND**
- PROPOSED DOWNSPOUT
 - PROPOSED CATCH BASIN
 - ▲ PROPOSED FLARED END SECTION
 - EXISTING CATCH BASIN
 - ⊙ EXISTING MANHOLE
 - △ EXISTING FLARED END SECTION

PROPOSED STRUCTURES

ID.	STATION / OFFSET	DESCRIPTION
▲	1+539.00 / 30.50 RT.	PRECAST REINF. CONC. FLARED END SECTION 300 mm, INV EL 193.550
▲	1+548.76 / 25.00 RT.	PRECAST REINF. CONC. FLARED END SECTION 300 mm, INV EL 193.570
▲	1+566.47 / 23.50 RT.	PRECAST REINF. CONC. FLARED END SECTION 300 mm, INV EL 193.650
▲	1+606.22 / 19.50 RT.	PRECAST REINF. CONC. FLARED END SECTION 300 mm, INV EL 193.720
▲	1+669.56 / 22.00 RT.	PRECAST REINF. CONC. FLARED END SECTION 300 mm, INV EL 193.700
▲	1+722.20 / 11.29 RT.	CB, T-A, 1.2 m DIA, T-1 F, CLID, RIM EL 196.360, INV EL
▲	1+753.51 / 11.29 RT.	CB, T-A, 1.2 m DIA, T-1 F, CLID, RIM EL 195.630, INV EL
▲	1+810.41 / 11.39 LT.	CB, T-A, 1.2 m DIA, T-1 F, CLID, RIM EL 195.330, INV EL

- NOTES:**
1. ALL DIMENSIONS ARE IN METERS, UNLESS OTHERWISE NOTED
 2. FOR BRIDGE DRAINAGE PLANS, SEE SHEET 212
 3. TBM 113 - "X" CUT IN SIDEWALK (EAST) 7 METERS SOUTH OF SOUTH ABUTMENT, STA. 1+488.708, 9.784 RT, ELEV=202.721

BRIDGE DRAINAGE PLAN

*1) FAU 2612
2) FAP 330

FILE NAME =	USER NAME = curryw	DESIGNED -	REVISED -	STATE OF ILLINOIS DEPARTMENT OF TRANSPORTATION	DRAINAGE REPAIRS (SN 016-0337)	F.A. RTE.	SECTION	COUNTY	TOTAL SHEETS	SHEET NO.	
at\pe_work\pdat\curryw\0296919\01322	2-Design\gdn	DRAWN -	REVISED -			*	2012-001-1	COOK	27	22	
	PLOT SCALE = 100.0000 * / in.	CHECKED -	REVISED -			CONTRACT NO. 60731					
	PLOT DATE = 3/2/2012	DATE -	REVISED -			ILLINOIS FED. AID PROJECT					