

PIPE CROSSINGS		
NO.	DESCRIPTION	ELEV.
1	BOTTOM OF STORM SEWER	713.7
	TOP OF WATER MAIN	712.2 (MAX)
2	TOP OF SANITARY SEWER	709.0
	BOTTOM OF STORM SEWER	713.7
3	BOTTOM OF SANITARY SEWER	710.6
	TOP OF WATER MAIN	709.1 (MAX)
4	BOTTOM OF STORM SEWER	713.1
	TOP OF WATER MAIN	711.8 (MAX)
5	TOP OF SANITARY SEWER	708.5
	BOTTOM OF STORM SEWER	713.1

* WATERMAIN IS TO BE ENCASED WITH WATER QUALITY PIPE 10' ON EITHER SIDE OF CROSSING

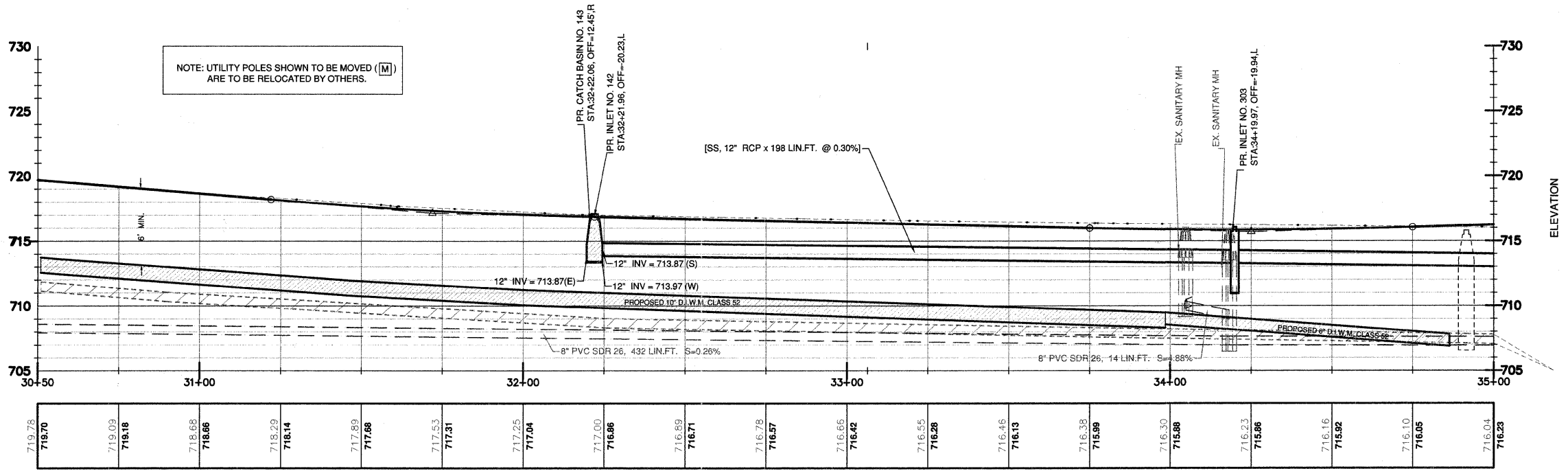

719.78	719.09	718.68	718.29	717.89	717.53	717.25	717.00	716.89	716.71	716.78	716.66	716.55	716.46	716.38	716.30	716.23	716.16	716.10	716.04
719.70	719.18	718.66	718.14	717.68	717.31	717.04	716.86	716.89	716.71	716.57	716.42	716.28	716.13	715.99	715.88	715.86	715.82	716.10	716.05