

FOR INDEX OF SHEETS
SEE SHEET 2

STATE OF ILLINOIS
DEPARTMENT OF TRANSPORTATION
DIVISION OF HIGHWAYS
**PLANS FOR PROPOSED
FEDERAL AID HIGHWAY**

DISTRICT 1
CONGESTION MITIGATION AIR QUALITY
SIGNAL INTERCONNECT
F.A.U. NO: 2581 (GLEN ELLYN ROAD)
ARMITAGE AVENUE TO ARMY TRAIL ROAD
AND
F.A.U. NO: 1397 (GENEVA ROAD/ST. CHARLES ROAD)
SCHMALE ROAD/MAIN STREET TO SWIFT ROAD
FEDERAL PROJECT NO: CMM-9003(563)
SECTION NO: 09-00206-08-TL
DuPAGE COUNTY

C-91-330-10

LOCATION MAP
(NOT TO SCALE)

F.A.U. RTE.	SECTION	COUNTY	TOTAL SHEETS	SHEET NO.
2581 & 1397	09-00206-08-TL	DuPAGE	53	1
ILLINOIS FED. AID PROJECT			CONTRACT #: 63625	

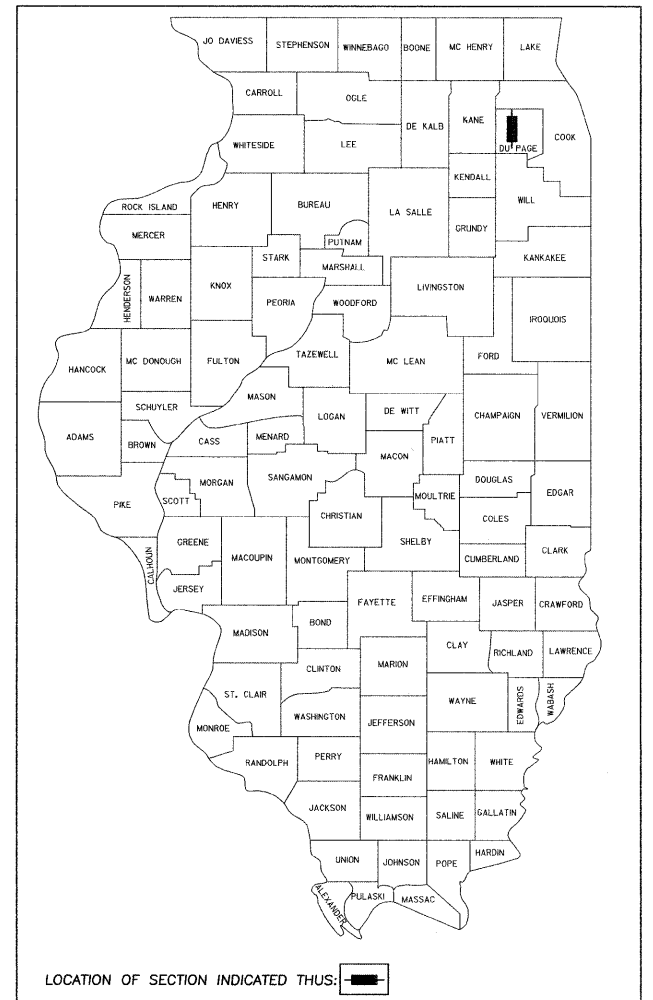

BLOOMINDALE TOWNSHIP R10E 3rd P.M.

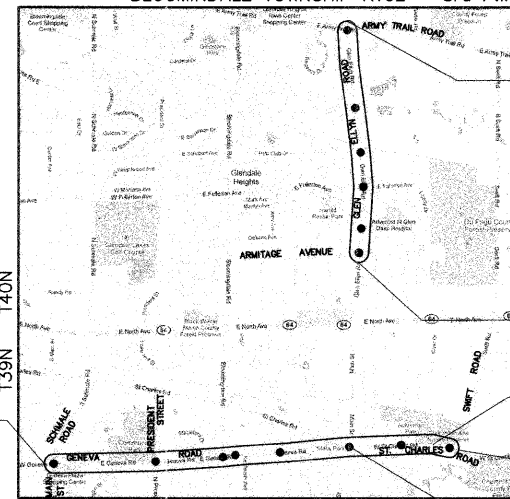

END PROJECT
STA. 102+25

BEGIN PROJECT
STA. 7+25

SN 022.0068
ST CHARLES ROAD OVER
EAST BRANCH OF DuPAGE RIVER

END PROJECT
STA. 239+75

END GENEVA RD.
BEGIN ST. CHARLES RD.
STA. 196+50

BEGIN PROJECT
STA. 77+75

NET & GROSS PROJECT LENGTHS:
GLEN ELLYN ROAD = 8,900 FEET (1.7 MILES)
GENEVA ROAD/ST. CHARLES ROAD = 16,200 FEET (3.1 MILES)

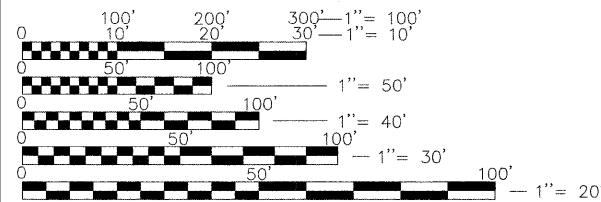

FULL SIZE PLANS HAVE BEEN PREPARED USING STANDARD ENGINEERING SCALES. REDUCED SIZE PLANS WILL NOT CONFORM TO STANDARD SCALES. IN MAKING MEASUREMENTS ON REDUCED PLANS, THE BELOW SCALES MAY BE USED.



CONTRACTOR IS RESPONSIBLE FOR CONTACTING J.U.L.I.E. AT 1-800-892-0123 AND MUST ACQUIRE A DIG NUMBER A MINIMUM OF 72 HOURS PRIOR TO ANY WORK BEING DONE.

CONTRACT NO. 63625

TRAFFIC DATA:	GLEN ELLYN ROAD	GENEVA ROAD/ST. CHARLES ROAD
POSTED SPEED:	40 MPH	35-40 MPH
DESIGN SPEED:	45 MPH	40-45 MPH
ADT:	15,100-17,300	15,200-18,300
FUNCTIONAL CLASSIFICATION:	MINOR ARTERIAL	MINOR ARTERIAL

STATE OF ILLINOIS
DEPARTMENT OF TRANSPORTATION
DIVISION OF HIGHWAYS

APPROVED: December 15 2011
Charles F. Fortunki
DuPAGE COUNTY DIVISION OF TRANSPORTATION,
DIRECTOR OF TRANSPORTATION/COUNTY ENGINEER

PASSED: JANUARY 5 2012
CHET CHRISTOPHER HUNT
DISTRICT 1 ENGINEER OF LOCAL ROADS & STREETS

RELEASING FOR BID
BASED ON LIMITED
REVIEW: JANUARY 10 2012
Diana M. D'Neale
DEPUTY DIRECTOR OF HIGHWAYS, REGION 1 ENGINEER



SIGNED: Kevin L. Belgrave
Kevin L. Belgrave
DATE: 12/15/11

EXPIRES: 11/30/2013

GHA GEWALT HAMILTON
ASSOCIATES, INC.
850 Forest Edge Drive • Vernon Hills, IL 60061
Consulting Engineers & Surveyors
847-478-9700
FAX: 847-478-9701

**PRINTED BY THE AUTHORITY
OF THE STATE OF ILLINOIS**

PROGRAM & OFFICE ENGINEER, CHARLES F. RIDDLE, P.E. (847) 705-4406 SCHAUMBURG, IL