

MATCHLINE (SEE SHEET 21)

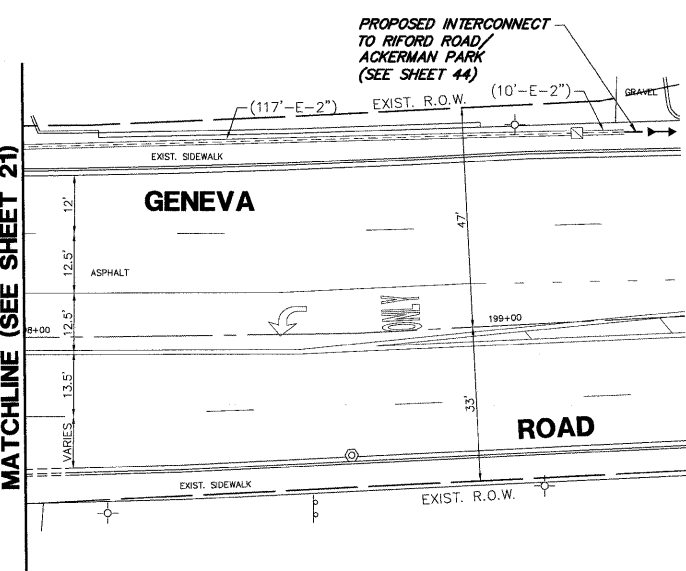

EXISTING INTERCONNECT TO GENEVA ROAD/ST. CHARLES ROAD (SEE SHEET 44)

MATCHLINE (SEE SHEET 21)

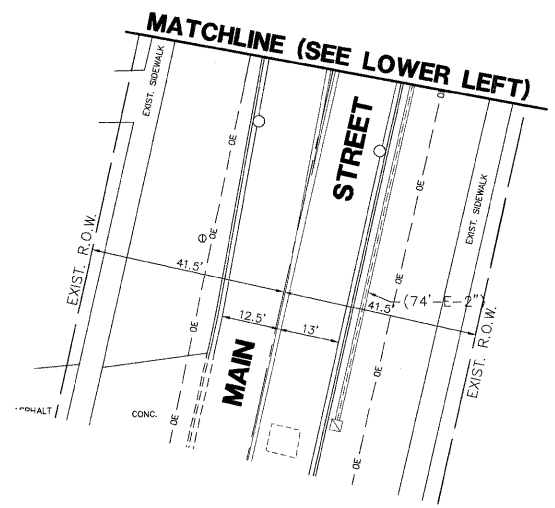
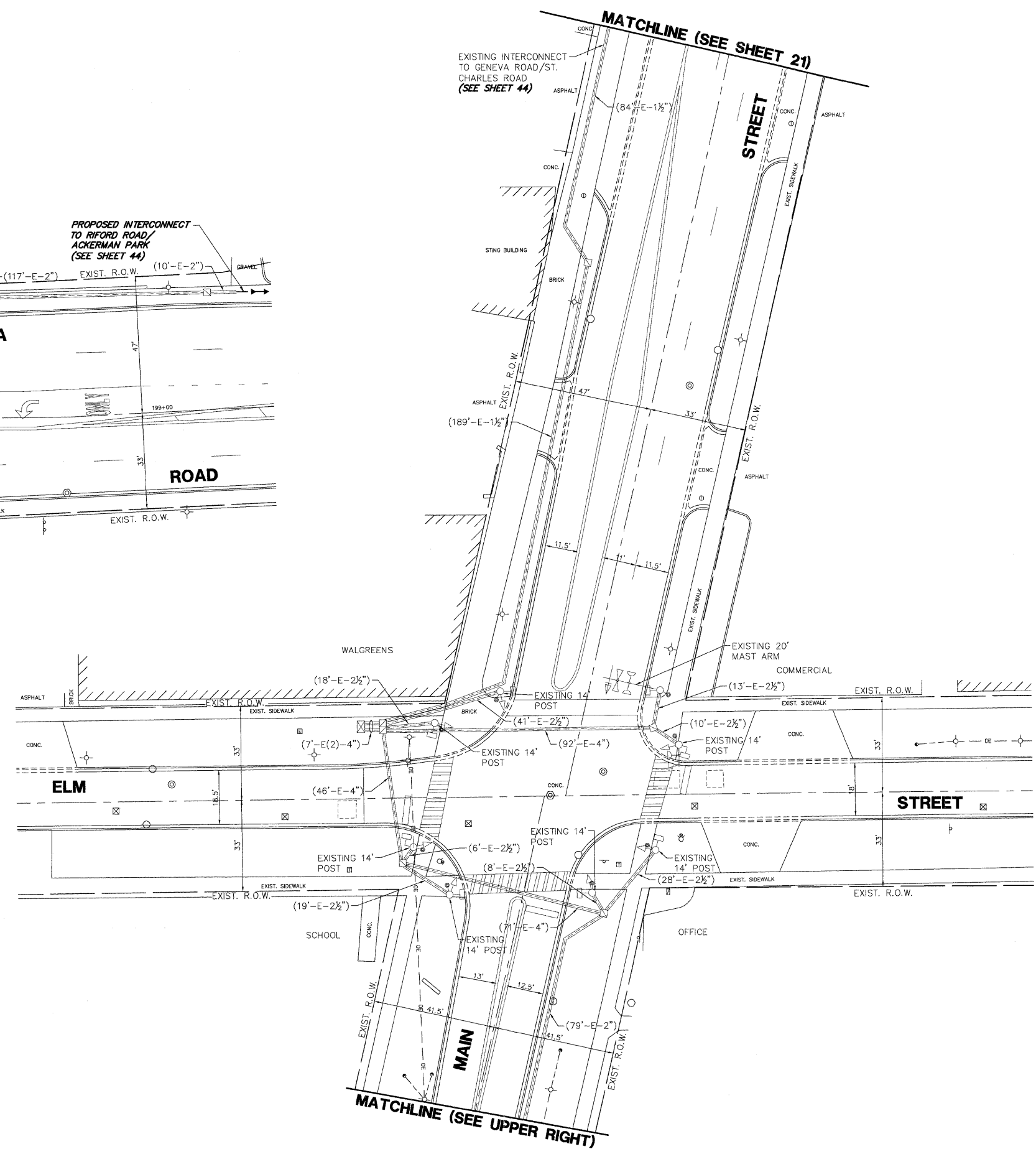

THE TRAFFIC SIGNAL CONTROL EQUIPMENT FOR THIS PROJECT SHALL BE "ECONOLITE" TO MATCH THE EXISTING ADJACENT SYSTEM.

FILE NAME =	4281.800-TR1.dwg
USER NAME =	ZACH WALLSTEN
DESIGNED =	JRD
DRAWN =	ZCW
CHECKED =	KLB
DATE =	12/16/2011

DESIGNED =	JRD
DRAWN =	ZCW
CHECKED =	KLB
DATE =	12/16/2011

DESIGNED =	JRD
DRAWN =	ZCW
CHECKED =	KLB
DATE =	12/16/2011

DESIGNED =	JRD
DRAWN =	ZCW
CHECKED =	KLB
DATE =	12/16/2011

**STATE OF ILLINOIS
DEPARTMENT OF TRANSPORTATION**

**TRAFFIC SIGNAL MODERNIZATION PLAN
ELM STREET AT MAIN STREET**

SCALE 1"=20' SHEET NO. OF SHEETS STA. TO STA.

FAU. RTE.	SECTION	COUNTY	TOTAL SHEETS	SHEET NO.
1397	09-00206-08-TL	DuPAGE	53	22
CONTRACT #:			63625	
ILLINOIS FED. AID PROJECT				

GHA #4281.800