

**SCHEDULE OF QUANTITIES**  
GLEN ELLYN ROAD AT FULLERTON AVENUE

| NO. | QUANT. | UNIT   |
|-----|--------|--|
| 1.  | 1      | EACH MAINTENANCE OF EXISTING TRAFFIC SIGNAL INSTALLATION |
| 2.  | 1      | EACH TRANSCEIVER - FIBER OPTIC                           |

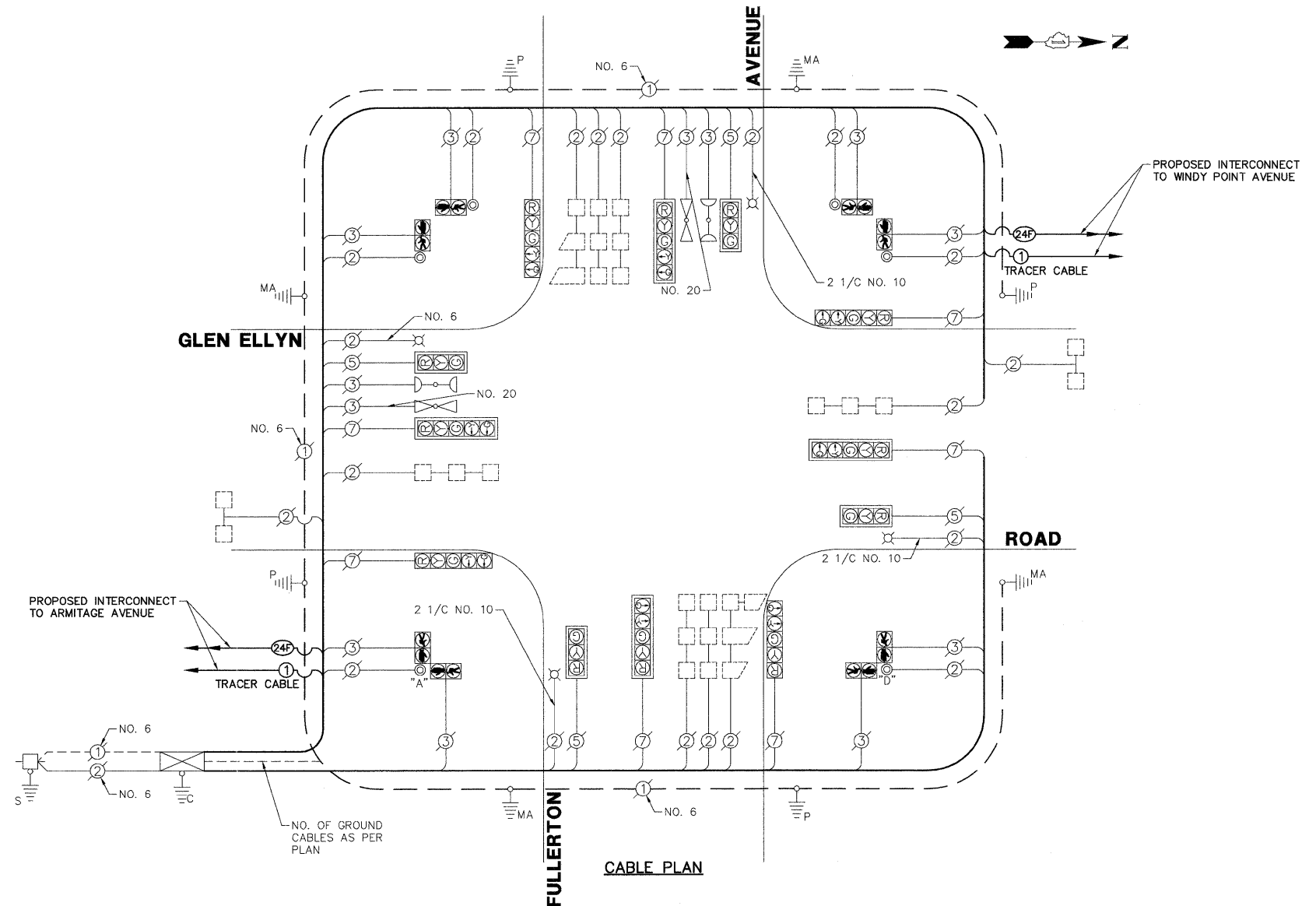

**EXISTING CONTROLLER SEQUENCE**

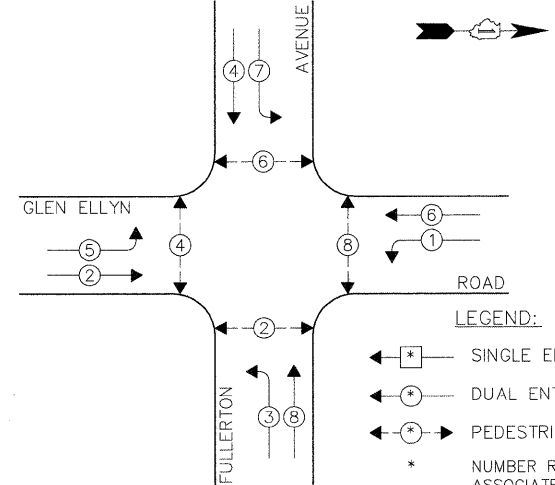

**NOTE:**  
PUSH BUTTON "A" SHALL PLACE A CALL IN PHASES 2 AND 4  
PUSH BUTTON "D" SHALL PLACE A CALL IN PHASES 2 AND 8

**EXISTING EMERGENCY VEHICLE PREEMPTION SEQUENCE**

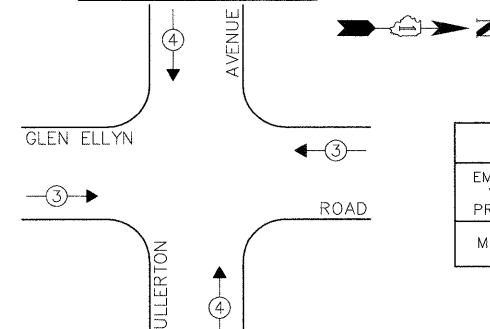

- LEGEND:**
- ← \* → SINGLE ENTRY PHASE
  - ← + → DUAL ENTRY PHASE
  - ← \* → PEDESTRIAN PHASE
  - \* NUMBER REFERS TO ASSOCIATED PHASE
  - ← OL → OVERLAP

| EXISTING EMERGENCY VEHICLE PREEMPTORS |   |   |   |
|---------------------------------------|---|---|---|
| EMERGENCY VEHICLE PREEMPTOR           | 3 | 4 |   |
| MOVEMENT                              | → | ← | ↑ |

| I.D.O.T. TRAFFIC SIGNAL INSTALLATION ELECTRICAL SERVICE REQUIREMENTS |           |         |        |             | TOTAL WATTAGE |
|--|-----------|---------|--------|-------------|---------------|
| TYPE   | NO. LAMPS | INCAND. | L.E.D. | % OPERATION |               |
| SIGNAL (RED)   | 12        | 135     | 17     | 0.50        | 102.0         |
| SIGNAL (YELLOW)  | 12        | 135     | 25     | 0.25        | 75.0          |
| SIGNAL (GREEN)   | 12        | 135     | 15     | 0.25        | 45.0          |
| ARROW  | 16        | 135     | 12     | 0.10        | 19.2          |
| PED. SIGNAL  | 8         | 90      | 25     | 1.00        | 200.0         |
| CONTROLLER   | 1         | -       | 100    | 1.00        | 100.0         |
| LUMINAIRE  | 4         | 250     | -      | 0.50        | 500.0         |
| L.E.D. ST. NAME SIGN   | -         | -       | 64     | 0.50        | -             |
| VIDEO SYSTEM   | -         | -       | 150    | 1.00        | -             |
| BATTERY BACKUP   | -         | -       | 25     | 1.00        | -             |
| ILLUMINATED SIGN   | -         | -       | 25     | 0.05        | -             |
| <b>TOTAL =</b>   |           |         |        |             | 1041.2        |

ENERGY COSTS - BILLED TO: VILLAGE OF GLEN ELLYN  
(ADDRESS) 20 S. LAMBERT ROAD  
(ADDRESS) GLEN ELLYN, IL 60137  
ENERGY SUPPLY - CONTACT: MS. DEB RANKIN  
PHONE: (630) 691-4379  
COMPANY: COM-ED

THE TRAFFIC SIGNAL CONTROL EQUIPMENT FOR THIS PROJECT SHALL BE "ECONOLITE" TO MATCH THE EXISTING ADJACENT SYSTEM.