

	CODE	IDOT PAY ITEM #	BOTANICAL NAME	COMMON NAME	QTY	CAL	ROOT	REMARKS
SHADE TREES	AMMO-A	A2000330	ACER MIYABEI 'MORTON'	STATE STREET MAPLE	16	2-1/2"	B&B	SINGLE STRAIGHT TRUNK, SPECIMEN QUALITY
	AMMO-B	A2000332	ACER MIYABEI 'MORTON'	STATE STREET MAPLE	4	4"	B&B	SINGLE STRAIGHT TRUNK, SPECIMEN QUALITY
	COC-A	A2002880	CELTIS OCCIDENTALIS 'CHICAGOLAND'	CHICAGOLAND COMMON HACKBERRY	7	2-1/2"	B&B	SINGLE STRAIGHT TRUNK, SPECIMEN QUALITY
	COC-B	A2002886	CELTIS OCCIDENTALIS 'CHICAGOLAND'	CHICAGOLAND COMMON HACKBERRY	2	4"	B&B	SINGLE STRAIGHT TRUNK, SPECIMEN QUALITY
	GBAG	A2004420	GINKGO BILOBA 'AUTUMN GOLD'	AUTUMN GOLD GINKGO	7	2-1/2"	B&B	SINGLE STRAIGHT TRUNK, SPECIMEN QUALITY
	GD-A	A2005020	GYMNOCLADUS DIOICUS	KENTUCKY COFFEETREE	6	2-1/2"	B&B	SINGLE STRAIGHT TRUNK, SPECIMEN QUALITY
	GD-B	A2005030	GYMNOCLADUS DIOICUS	KENTUCKY COFFEETREE	6	4"	B&B	SINGLE STRAIGHT TRUNK, SPECIMEN QUALITY
	QB-A	A2006520	QUERCUS BICOLOR	SWAMP WHITE OAK	7	2-1/2"	B&B	SINGLE STRAIGHT TRUNK, SPECIMEN QUALITY
	QB-B	A2006532	QUERCUS BICOLOR	SWAMP WHITE OAK	3	4"	B&B	SINGLE STRAIGHT TRUNK, SPECIMEN QUALITY
	TAR-A	A2007920	TILIA AMERICANA 'REDMOND'	REDMOND LINDEN	17	2-1/2"	B&B	SINGLE STRAIGHT TRUNK, SPECIMEN QUALITY
	TAR-B	A2007932	TILIA AMERICANA 'REDMOND'	REDMOND LINDEN	2	4"	B&B	SINGLE STRAIGHT TRUNK, SPECIMEN QUALITY
	UCMG-A	A2008619	ULMUS CARPINIFOLIA 'MORTON GLOSSY'	TRIUMPH ELM	11	2-1/2"	B&B	SINGLE STRAIGHT TRUNK, SPECIMEN QUALITY
	UCMG-B	A2008626	ULMUS CARPINIFOLIA 'MORTON GLOSSY'	TRIUMPH ELM	5	4"	B&B	SINGLE STRAIGHT TRUNK, SPECIMEN QUALITY
ORNAMENTAL TREES	ACFM	A2012005	AESCLULUS X CARNEA 'FORT MCNAIR'	FORT MCNAIR RED HORSECHESTNUT	19	4"	B&B	SINGLE STRAIGHT TRUNK, SPECIMEN QUALITY
	AGAB	B2000774	AMELANCHIER X GRANDIFLORA 'AUTUMN BRILLIANCE'	AUTUMN BRILLIANCE SERVICEBERRY	7	3"	B&B	SINGLE STRAIGHT TRUNK, SPECIMEN QUALITY
	CVVK	B2002220	CRATAEGUS VIRIDIS 'WINTER KING'	WINTER KING HAWTHORN	7	2-1/2"	B&B	SINGLE STRAIGHT TRUNK, SPECIMEN QUALITY
	SRIS	B2006332	SYRINGA RETICULATA 'IVORY SILK'	IVORY SILK JAPANESE TREE LILAC	30	4"	B&B	SINGLE STRAIGHT TRUNK, SPECIMEN QUALITY
PERENNIALS AND GROUNDCOVERS	HSPP	K0012990	HEMEROCALLIS SPECIES	DAYLILY MIX	3,056	-	#1	EVEN MIX OF 'BLACK-EYED STELLA', 'FAIRY TALE PINK', 'HAPPY RETURNS', 'STELLA DE ORO', AND 'STRAWBERRY CANDY'; 12" O.C.
	PAH	K0012990	PENNISETUM ALOPICUROIDES 'HAMEILN'	DWARF FOUNTAIN GRASS	1,212	-	#1	18" O.C.

LANDSCAPE AREAS	DEPTH
LAWN AREAS (SOD)	6" TOPSOIL
MEDIAN PLANTERS	VARIES, 12" PLANTING MIX, MIN.
SHADE AND ORNAMENTAL TREES	PER TREE INSTALLATION DETAIL

### 2 SOIL DEPTH CHART

NOTE: THE CONTRACTOR IS TO SUPPLY SOIL FILL MATERIAL TO THE DEPTHS INDICATED ON THE CHART ABOVE

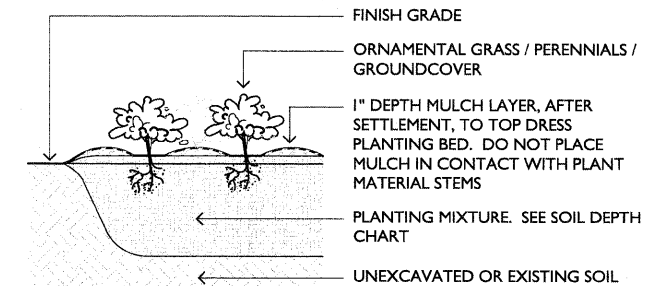

### 3 PERENNIAL INSTALLATION DETAIL

NOT TO SCALE

### PLANT LIST

NOTE: QUANTITIES ON THE PLANT LIST ARE PROVIDED FOR INFORMATION ONLY. PLANT QUANTITIES UNDER THE CONTRACT ARE INDICATED ON THE PLANS. IN THE EVENT OF ANY DISCREPANCIES, THE CONTRACT SHALL BE BASED ON THE QUANTITIES SHOWN ON THE PLANS.

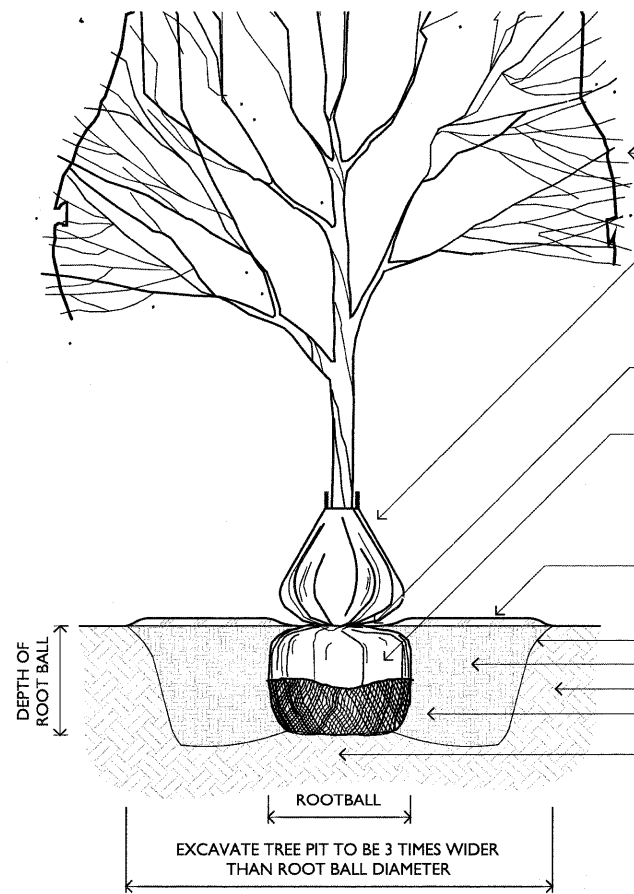

4 DECIDUOUS TREE IN TURF PARKWAY  
SCALE: 1/2" = 1'-0"

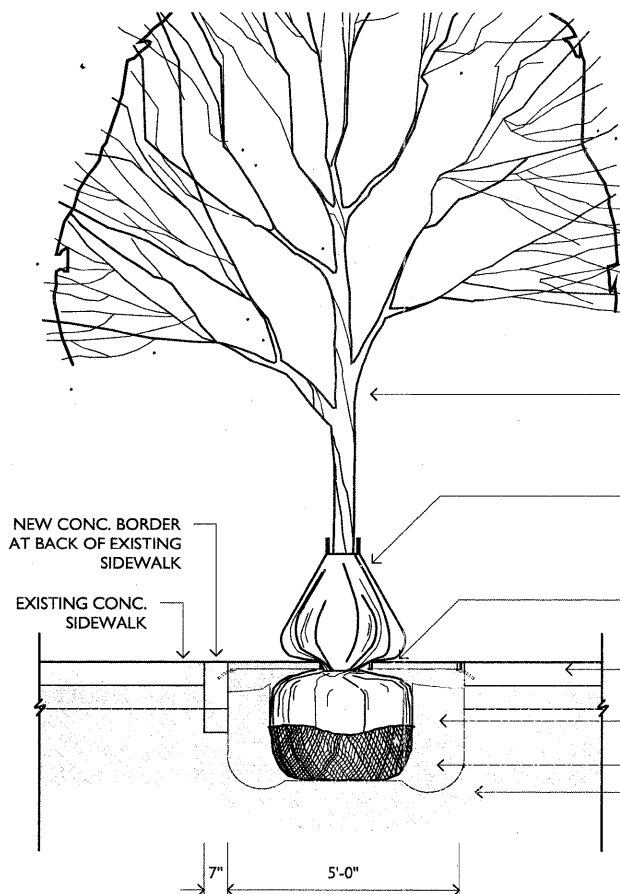

5 DECIDUOUS TREE IN TREE GRATE, SECTION PERPENDICULAR TO ROAD  
SCALE: 1/2" = 1'-0"

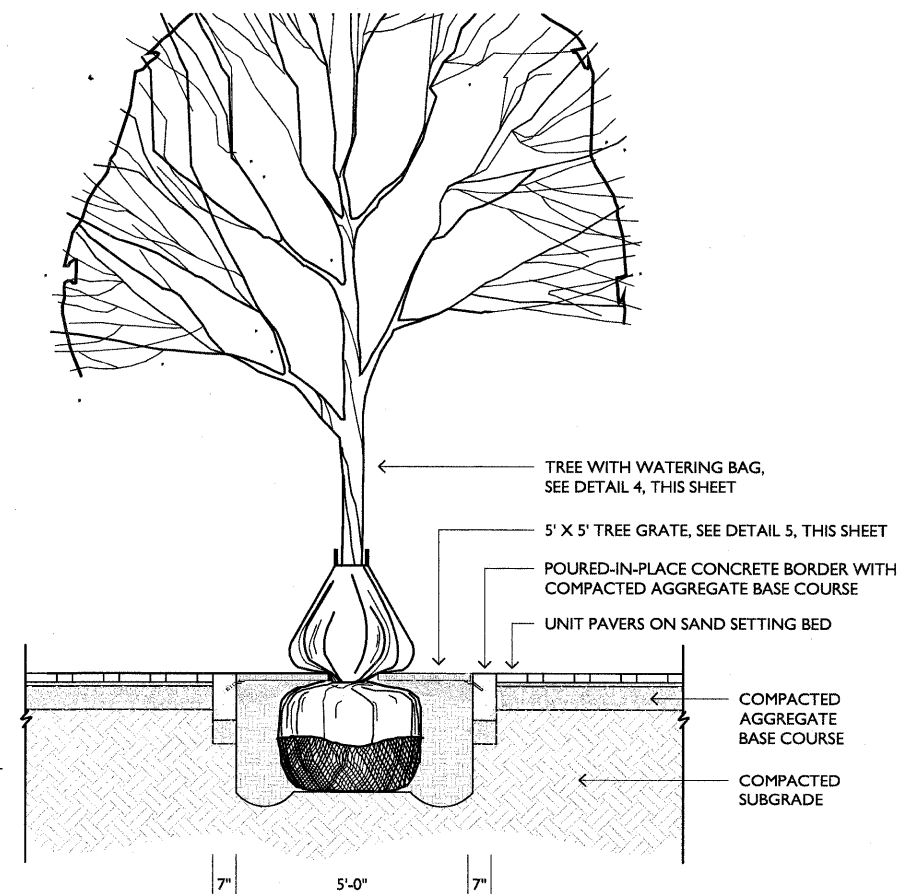

6 TREE GRATE AND PAVERS, SECTION PARALLEL TO ROAD  
SCALE: 1/2" = 1'-0"

Drawing file: S:\Projects\Division Street Enhancements-M-10028\Cad\Issue for CD\CD-CURRENT\20\_PLANT LIST AND DETAILS.dwg Feb 02, 2012 - 10:28am