

PLAN	SURVEYED	DATE
NO.	BY	
NOTE BOOK	PLOTTED	
NO.	BY	
	CHECKED	
	BY	
	DATE	

PROFILE	SURVEYED	DATE
NO.	BY	
NOTE BOOK	PLOTTED	
NO.	BY	
	CHECKED	
	BY	
	DATE	

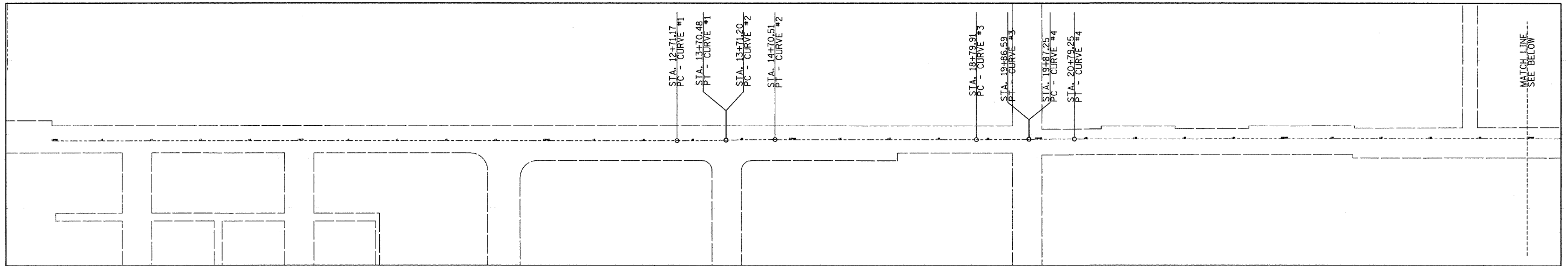

LEGEND

EX	PR	
Structure To Be Adjusted	ADJ	Aggregate Shoulder
Structure To Be Removed	R	Sidewalks, Driveways
Centerline		Guardrail
Dashed Property Line		Roadway Profile Line
Solid Property/Lot Line		Removal Tic
Storm Sewer		Bituminous Removal
Headwall		Tree Removal Single
Inlet		Water Meter
Manhole		Water Meter Valve Box
Catch Basin		Aerial Power Line
Culvert End Section		Deciduous Tree
Erosion Control Fence		Bush or Shrub
Temporary Fence		Evergreen Tree
Inlet & Pipe Protection		Orchard/Nursery Line
Erosion Control Blanket		Vegetation Line
Stop Line		Woods & Bush Line
Solid Line		
Double Centerline		
Cable TV		
Electric Cable		
Fiber Optic		
Gas Pipe		
Oil Pipe		
Sanitary Sewer		
Telephone Cable		
Water Pipe		
Edge of Pavement		
Bit Shoulders, Medians and C&G Line		

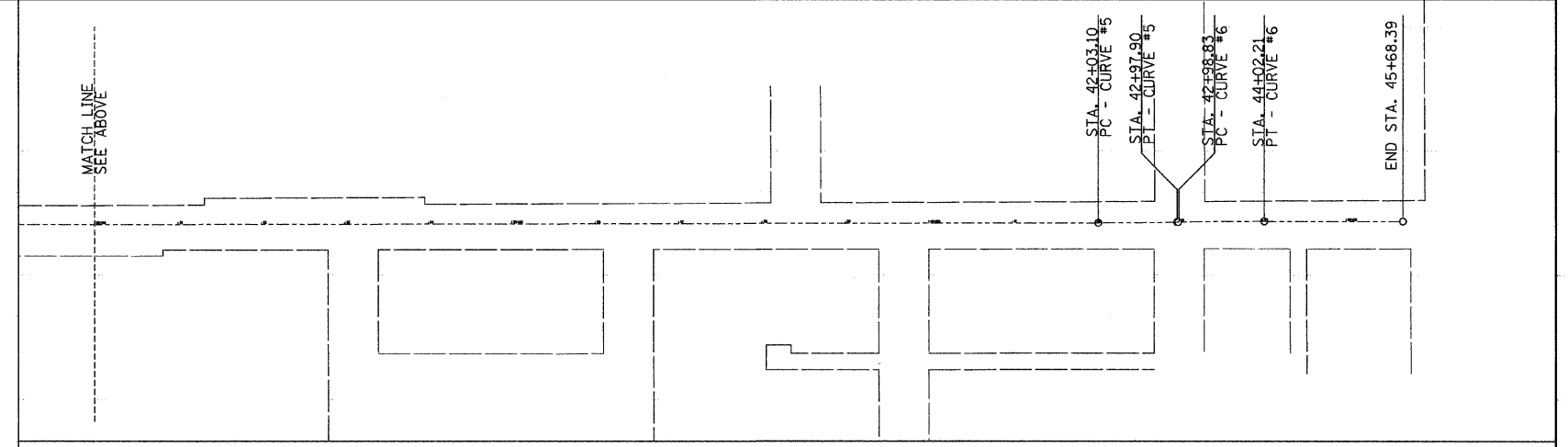

LIST OF BENCHMARKS

	NORTHING	EASTING	ELEV	DESCRIPTION
BM-1	2,096,393.9418	1,121,169.1970	734.75	PK NAIL SET ON THE SOUTH SIDE OF BEACH ROAD, 32.1 FEET SOUTH OF THE CENTERLINE AND APPROX. 147' WEST OF THE CENTERLINE OF SHERIDAN ROAD (ROUTE 137)
BM-2	2,096,420.2844	1,121,018.8565	732.43	SET IRON ROD AT NE CORNER OF BEACH ROAD AND COOLIDGE AVENUE, 34.8' NORTH OF THE CENTERLINE OF BEACH ROAD AND 29.1' EAST OF THE CENTERLINE OF COOLIDGE AVENUE.
BM-3	2,096,358.0660	1,120,387.3839	743.19	SET IRON ROD 24.8' SOUTH OF THE CENTERLINE OF BEACH ROAD AND 59.1' EAST OF CENTERLINE OF RUSSELL AVENUE
BM-4	2,096,403.3077	2,224,590.2319	743.05	SET IRON ROD 24.0' NORTH OF THE CENTERLINE OF BEACH ROAD AND 87.4' WEST OF THE CENTERLINE OF STEWART AVENUE
BM-5	2,096,342.7103	1,118,637.8774	741.66	SET IRON ROD 33.9' SOUTH OF THE CENTERLINE OF BEACH ROAD AND 31.7' WEST OF THE CENTERLINE OF NORTH AVENUE
BM-6	2,096,414.4010	1,117,659.7872	741.18	SET IRON ROD 37.0' NORTH OF THE CENTERLINE OF BEACH ROAD AND 52.9' EAST OF THE CENTERLINE OF CREEK COURT
BM-7	2,096,356.4984	1,116,679.7430	750.03	SET IRON ROD 22.6 SOUTH OF THE CENTERLINE OF BEACH ROAD AND 182.0' WEST OF THE CENTERLINE OF LOYOLA AVENUE