

COUNTY HIGHWAY	FISCAL YEAR	SHEET NO.	TOTAL SHEETS
011			

SECTION: 01-0095-00-RS

- NOTES:**
- THE EXACT LOCATIONS OF ALL UTILITIES SHALL BE FIELD VERIFIED BY THE CONTRACTOR BEFORE THE INSTALLATION OF ANY COMPONENTS OF THE TRAFFIC SIGNAL SYSTEM. FOR EXACT LOCATIONS OF THE UTILITIES, CALL J.D.L.S.E. TOLL FREE AT 1800 892-0222.
 - VEHICLE LOOP DETECTOR SHALL BE COMPATIBLE WITH THE CONTROL EQUIPMENT.
 - ALL ELECTRICAL CABLE SHALL HAVE POLYVINYL JACKET.
 - THE CONTRACTOR SHALL INFORM THE CCHD DESIGN ENGINEER AT (312) 603-1130 PRIOR TO THE START OF ANY WORK ON THE CONTRACT. A MINIMUM OF FIVE (5) WORKING DAYS ADVANCE NOTICE IS REQUIRED.
 - THE CONTRACTOR SHALL MARK THE LOCATIONS OF ALL DETECTOR LOOPS AND CONTACT THE CCHD DESIGN ENGINEER AT (312) 603-1130 FOR LOCATION APPROVAL PRIOR TO THE CUTTING OF THE LOOPS. A MINIMUM OF FIVE (5) WORKING DAYS ADVANCE NOTICE IS REQUIRED.
 - ALL SIGNAL POSTS SHALL BE SET BACK FOUR (4) FEET MINIMUM AND ALL MAST ARM POLLS SHALL BE SET BACK SIX (6) FEET MINIMUM FROM THEIR CENTERLINE TO THE BACK OF CURB UNLESS OTHERWISE NOTED. IN NON-CURBED AREAS THE MAST ARM POLL AND SIGNAL POST SHALL BE LOCATED A MINIMUM OF TEN (10) FEET BEHIND THE EDGE OF PAVEMENT OR TWO (2) FEET BEHIND THE EDGE OF SHOULDER, WHICHEVER DISTANCE IS GREATER.
 - ALL EXISTING LOOP DETECTORS ARE TO BE ANALYZED AND RE-CUT IF NECESSARY.
 - CONDUIT UNDER ROADWAYS AND DRIVEWAYS TO BE PLACED IN TRENCH BEFORE PAVEMENT IS PLACED.
 - ALL MAST ARM MOUNTED SIGNAL HEADS ARE TO BE ATTACHED TWO (2) FEET FROM THE END OF THE MAST ARM UNLESS OTHERWISE NOTED.
 - ALL 1" CONDUIT TO BE 1" EMPTY DUCT.
 - CARE IS TO BE TAKEN NOT TO DAMAGE ANY OF THE EXISTING TRAFFIC SIGNAL CONDUIT AND EQUIPMENT. IF ANY OF THE TRAFFIC SIGNAL CONDUIT AND/OR EQUIPMENT IS DAMAGED THE CONTRACTOR SHALL REPAIR OR REPLACE THE CONDUIT AND/OR EQUIPMENT AT NO COST TO THE COUNTY.

- THE CORNERS OF ALL NEW DETECTOR LOOPS SHALL BE CORE-DRILLED INCLUDING PAVEMENT JOINTS AND CRACKS.
- IT IS THE CONTRACTOR'S RESPONSIBILITY TO MAKE SURE ALL NEW AND EXISTING TRAFFIC SIGNAL POSTS ON EXISTING OR NEW CONCRETE FOUNDATIONS ARE STRAIGHT UP. THIS SHALL BE CONSIDERED INCIDENTAL TO THE CONTRACT. SHIMS ARE NOT ACCEPTABLE.
- IT IS THE CONTRACTOR'S RESPONSIBILITY TO LOCATE THE EXISTING TRAFFIC SIGNAL AND STREET LIGHTING CONDUIT AND CABLE. THIS SHALL BE CONSIDERED INCIDENTAL TO THE CONTRACT.

NOTES:

- REMOVE EXISTING SIGNAL HEAD, 1-FACE, 5-SECTION, MAST ARM MOUNTED. INSTALL NEW SIGNAL HEAD, L.E.D., 1-FACE, 5-SECTION, MAST ARM MOUNTED. REUSE EXISTING ELECTRICAL CABLE.
- REMOVE EXISTING SIGNAL HEAD, 1-FACE, 3-SECTION, BRACKET MOUNTED. INSTALL NEW SIGNAL HEAD, L.E.D., 1-FACE, 3-SECTION, BRACKET MOUNTED. REUSE EXISTING ELECTRICAL CABLE.
- REMOVE EXISTING SIGNAL HEAD, 2-FACE, 3-SECTION, BRACKET MOUNTED. INSTALL NEW SIGNAL HEAD, L.E.D., 2-FACE, 3-SECTION, BRACKET MOUNTED. REUSE EXISTING ELECTRICAL CABLE.
- REMOVE EXISTING SIGNAL POST AND SIGNAL HEAD, 1-FACE, 3-SECTION, BRACKET MOUNTED. INSTALL NEW 14 FOOT SIGNAL POST AND SIGNAL HEAD, L.E.D., 1-FACE, 3-SECTION, BRACKET MOUNTED ON EXISTING TYPE A FOUNDATION. REUSE EXISTING ELECTRICAL CABLE.
- REMOVE EXISTING SIGNAL POST AND SIGNAL HEAD, 2-FACE, 1-3-SECTION, 1-5-SECTION, BRACKET MOUNTED. INSTALL NEW 16 FOOT SIGNAL POST AND SIGNAL HEAD, L.E.D., 2-FACE, 1-3-SECTION, 1-5-SECTION BRACKET MOUNTED ON EXISTING TYPE A FOUNDATION. REUSE EXISTING ELECTRICAL CABLE.
- REMOVE EXISTING SIGNAL POST AND SIGNAL HEAD, 2-FACE, 3-SECTION, BRACKET MOUNTED. INSTALL NEW 14 FOOT POST ON EXISTING TYPE A FOUNDATION. INSTALL NEW SIGNAL HEAD, L.E.D., 2-FACE, 3-SECTION, BRACKET MOUNTED. REUSE EXISTING ELECTRICAL CABLE.
- REMOVE EXISTING SERVICE INSTALLATION. INSTALL NEW POLE MOUNTED SERVICE INSTALLATION. REUSE EXISTING ELECTRICAL CABLES.

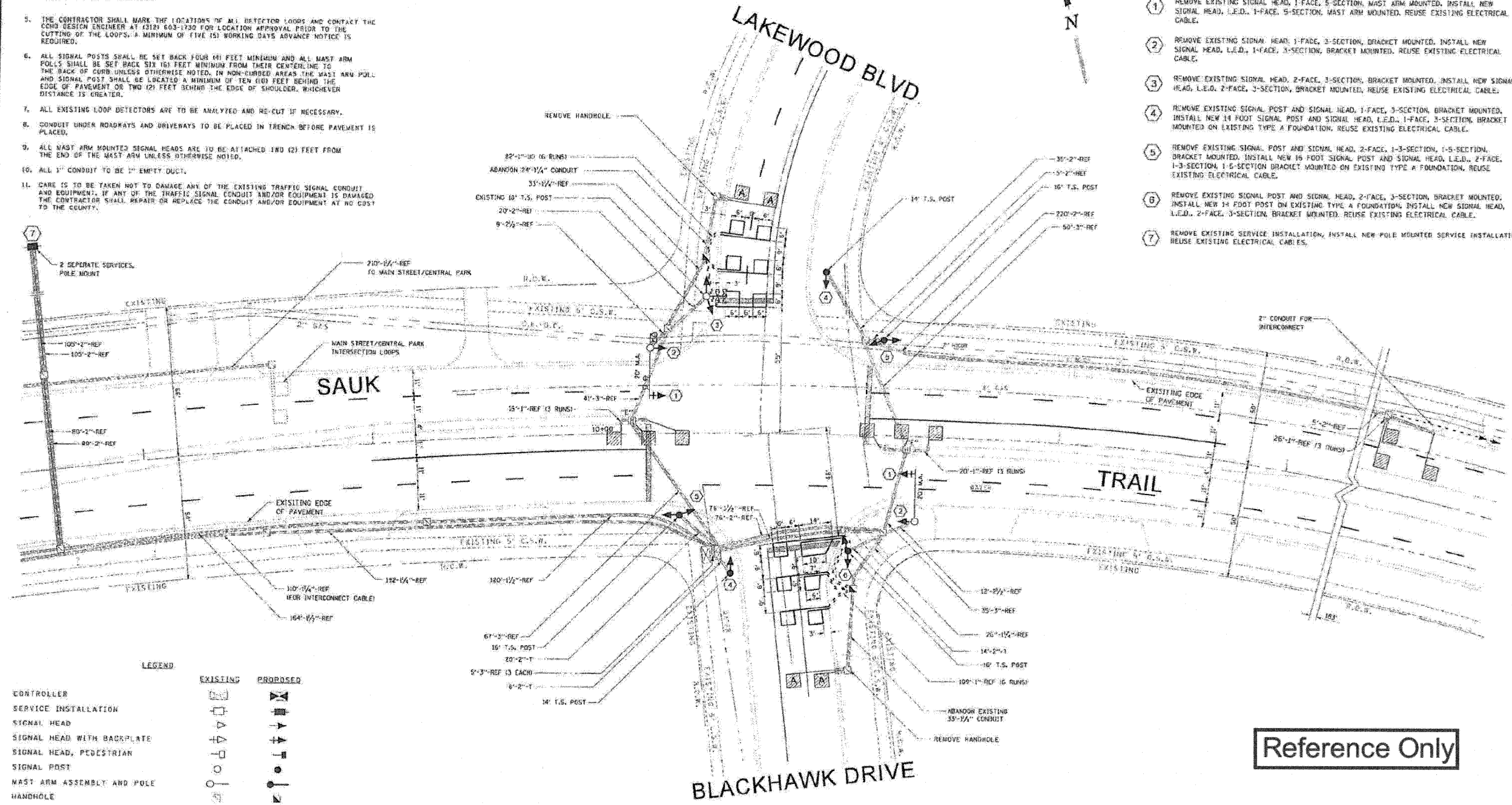

LEGEND

	EXISTING	PROPOSED
CONTROLLER	[Symbol]	[Symbol]
SERVICE INSTALLATION	[Symbol]	[Symbol]
SIGNAL HEAD	[Symbol]	[Symbol]
SIGNAL HEAD WITH BACKPLATE	[Symbol]	[Symbol]
SIGNAL HEAD, PEDESTRIAN	[Symbol]	[Symbol]
SIGNAL POST	[Symbol]	[Symbol]
MAST ARM ASSEMBLY AND POLE	[Symbol]	[Symbol]
HANDHOLE	[Symbol]	[Symbol]
HEAVY DUTY HANDHOLE	[Symbol]	[Symbol]
DOUBLE HANDHOLE	[Symbol]	[Symbol]
CALVANIZED STEEL CONDUIT	[Symbol]	[Symbol]
EMERGENCY VEHICLE SYSTEM DETECTOR	[Symbol]	[Symbol]
CONFIRMATION BEACON	[Symbol]	[Symbol]
PEDESTRIAN PUSHBUTTON	[Symbol]	[Symbol]
DETECTOR LOOP	[Symbol]	[Symbol]

Reference Only

SCALE 1"=20'

COUNTY OF COOK	
DEPARTMENT OF HIGHWAYS	
TRAFFIC SIGNAL INSTALLATION	
SAUK TRAIL AT	
LAKEWOOD BLVD. - BLACKHAWK DR.	
DESIGNED: RLS	DATE: June 17, 2003
DRAWN: B.A.C.	
CHECKED: P.L.W.	

COPYRIGHT © 2011 BY BAXTER & WOODMAN, INC.
 ALL RIGHTS RESERVED. PROFESSIONAL LICENSE NO. 021-00000000
 LICENSE NO. 021-00000000
 DATE: 7/27/2012 9:38:24 AM
 PROJECT: 11-00095-00-RS
 FILE: 091213-CCHD SIGNAL PLANS.sht



DESIGNED - TMS	REVISED -
DRAWN - KAR	REVISED -
CHECKED - JJF	REVISED -
DATE - 10-26-11	FILE - 091213-CCHD SIGNAL PLANS.sht

STATE OF ILLINOIS
DEPARTMENT OF TRANSPORTATION

COOK COUNTY HIGHWAY DEPARTMENT
SIGNAL PLANS - REFERENCE ONLY

SCALE: NONE STA. TO STA.

F.A.I. RTE.	SECTION	COUNTY	TOTAL SHEETS	SHEET NO.
	11-00095-00-RS	COOK	27	26
CONTRACT NO. 63690				
FED. ROAD DIST. NO. ILLINOIS/FED. AID PROJECT M-90039691				