





-  CLASS C PATCHES, 7"
-  CLASS D PATCHES, 9"  
REMOVAL AND DISPOSAL OF UNSUITABLE MATERIAL (DEPTH PER FIELD ENGINEER)  
POROUS GRANULAR EMBANKMENT
-  HOT-MIX ASPHALT SURFACE REMOVAL - BUTT JOINT
-  COMBINATION CURB AND GUTTER REMOVAL
-  PAVEMENT REMOVAL, SIDEWALK REMOVAL, OR  
DRIVEWAY PAVEMENT REMOVAL
-  FRAMES AND LIDS TO BE ADJUSTED OR RECONSTRUCTED

**NOTE**

FULL DEPTH SAW CUTS ALONG C&G REMOVAL, PAVEMENT REMOVAL, CLASS C & D PATCHES, SIDEWALK REMOVAL, AND PCC DRIVEWAY PAVEMENT REMOVAL ARE TO BE INCLUDED IN THE COST OF THE REMOVAL, AND WILL NOT BE PAID FOR SEPERATELY.

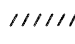
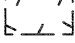

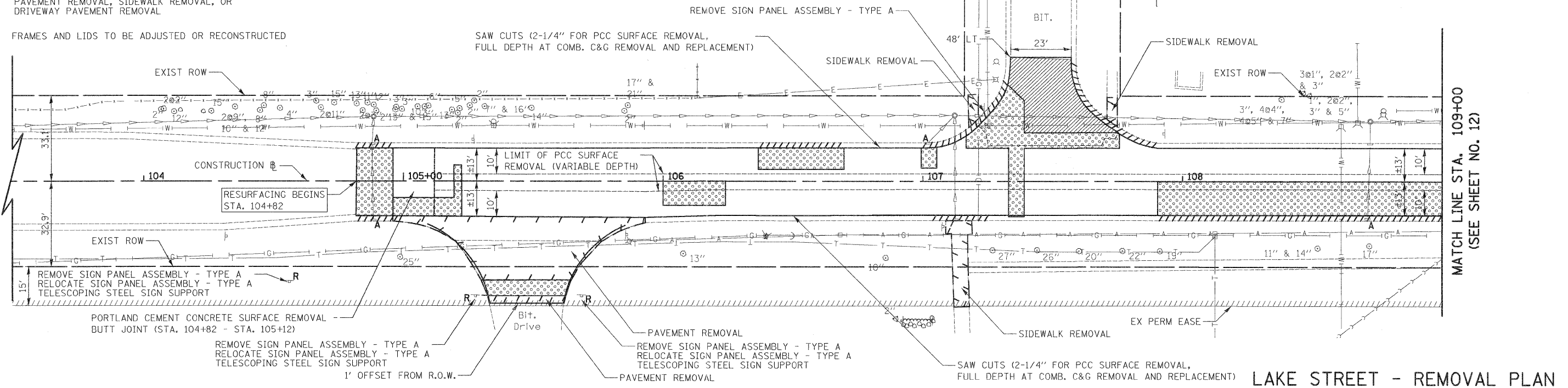
**LAKE STREET - REMOVAL PLAN**

- COMMERCIAL DRIVEWAY PAVEMENT**
- 2" HMA SURFACE COURSE, MIX "D", N50
  - 8" HMA BASE COURSE
  - 6" SUB-BASE GRANULAR MATERIAL, TYPE B

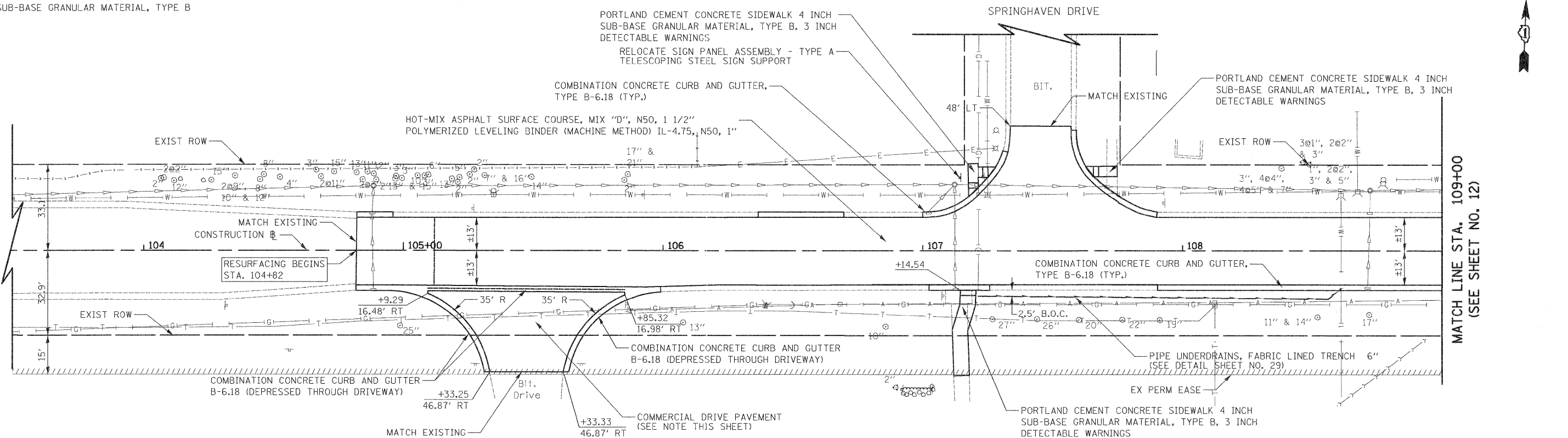

**LAKE STREET - PROPOSED PLAN**

FILE NAME =	USER NAME = ead	DESIGNED - EDS	REVISED -	<b>STATE OF ILLINOIS DEPARTMENT OF TRANSPORTATION</b>	<b>PLAN - LAKE STREET</b>	F.A.U. RTE. 1236	SECTION 08-00100-00-PV	COUNTY LAKE	TOTAL SHEETS 35	SHEET NO. 12		
... \Cad\sheet\2253.Plot	PLLOT SCALE = 20,000 Ft / Ln.	DRAWN - EDS	REVISED -			SCALE: 1" = 20'	SHEET NO. 1 OF 7 SHEETS	STA. 104+82 TO STA. 109+00	CONTRACT NO. 63697			
CIVILTECH	PLLOT DATE = 3/6/2012	CHECKED - DNM	REVISED -			FED. ROAD DIST. NO. 7 ILLINOIS FED. AID PROJECT						
		DATE - 02/06/12	REVISED -									