

STAGE 2 - BRIDGE TYPICAL SECTION

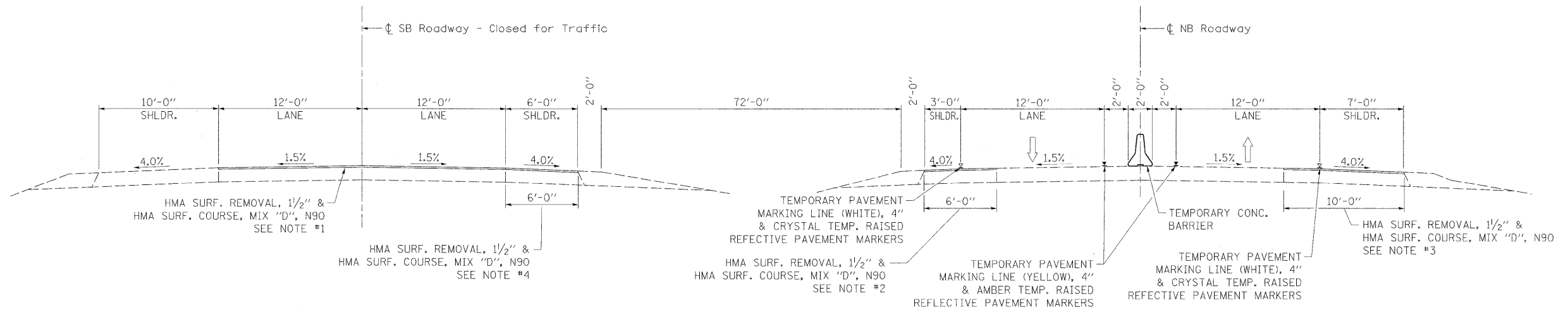

STAGE 2 - ROADWAY TYPICAL SECTION

Construction in this Stage

NOTE #1

STA. 2418+30.0 TO STA. 2419+60.0
STA. 2431+30.0 TO STA. 2431+55.0

NOTE #2

STA. 2409+92.7 TO STA. 2418+81.0
STA. 2430+44.0 TO STA. 2438+07.4
STA. 2440+32.3 TO STA. 2443+00.0

NOTE #3

STA. 2397+50.0 TO STA. 2418+81.0
STA. 2430+44.0 TO STA. 2444+00.0

NOTE #4

STA. 2442+00.0 TO STA. 2447+11.0

FILE NAME =	USER NAME = pearc00397	DESIGNED - BJB	REVISED -	STATE OF ILLINOIS DEPARTMENT OF TRANSPORTATION	TYPICAL SECTIONS - STAGE 2 CONSTRUCTION I-39 OVER KISHWAUKEE RIVER			F.A.I. RTE.	SECTION	COUNTY	TOTAL SHEETS	SHEET NO.
cr\pwise_work\do_not_delete\des59254\0264472-sh1-typical01.dgn		DRAWN - BJB	REVISED -		39	(201-1B)M-3	WINNEBAGO	38	7			
PLOT SCALE = 5.0000' / 1" =		CHECKED - JMH	REVISED -		CONTRACT NO. 64H72							
PLOT DATE = 02/09/2012		DATE - 2/9/12	REVISED -		SCALE:	SHEET 2 OF 2 SHEETS	STA. TO STA.	ILLINOIS FED. AID PROJECT				