

**NORTH CURB LINE**

| Location             | Station   | Offset | Theoretical Grade Elevations |
|----------------------|-----------|--------|------------------------------|
| W. End of West Appr. | 116+10.38 | -15.58 | 530.06                       |
| A                    | 116+20.15 | -15.58 | 530.31                       |
| B                    | 116+29.92 | -15.87 | 530.57                       |
| E. End of West Appr. | 116+39.66 | -16.46 | 530.83                       |
| Back of West Abut.   | 116+40.36 | -16.33 | 530.84                       |

**☉ ROADWAY & PROFILE GRADE LINE (P.G.L.)**

| Location             | Station   | Offset | Theoretical Grade Elevations |
|----------------------|-----------|--------|------------------------------|
| W. End of West Appr. | 116+05.31 | 0.00   | 529.22                       |
| A                    | 116+15.59 | 0.00   | 529.50                       |
| B                    | 116+25.78 | 0.00   | 529.75                       |
| E. End of West Appr. | 116+35.88 | 0.00   | 530.00                       |
| Back of West Abut.   | 116+36.65 | 0.00   | 530.02                       |

**SOUTH CURB LINE**

| Location             | Station   | Offset | Theoretical Grade Elevations |
|----------------------|-----------|--------|------------------------------|
| W. End of West Appr. | 115+99.70 | 15.93  | 528.35                       |
| A                    | 116+10.34 | 16.24  | 528.63                       |
| B                    | 116+21.01 | 16.53  | 528.89                       |
| E. End of West Appr. | 116+31.69 | 16.50  | 529.16                       |
| Back of West Abut.   | 116+32.53 | 16.40  | 529.18                       |

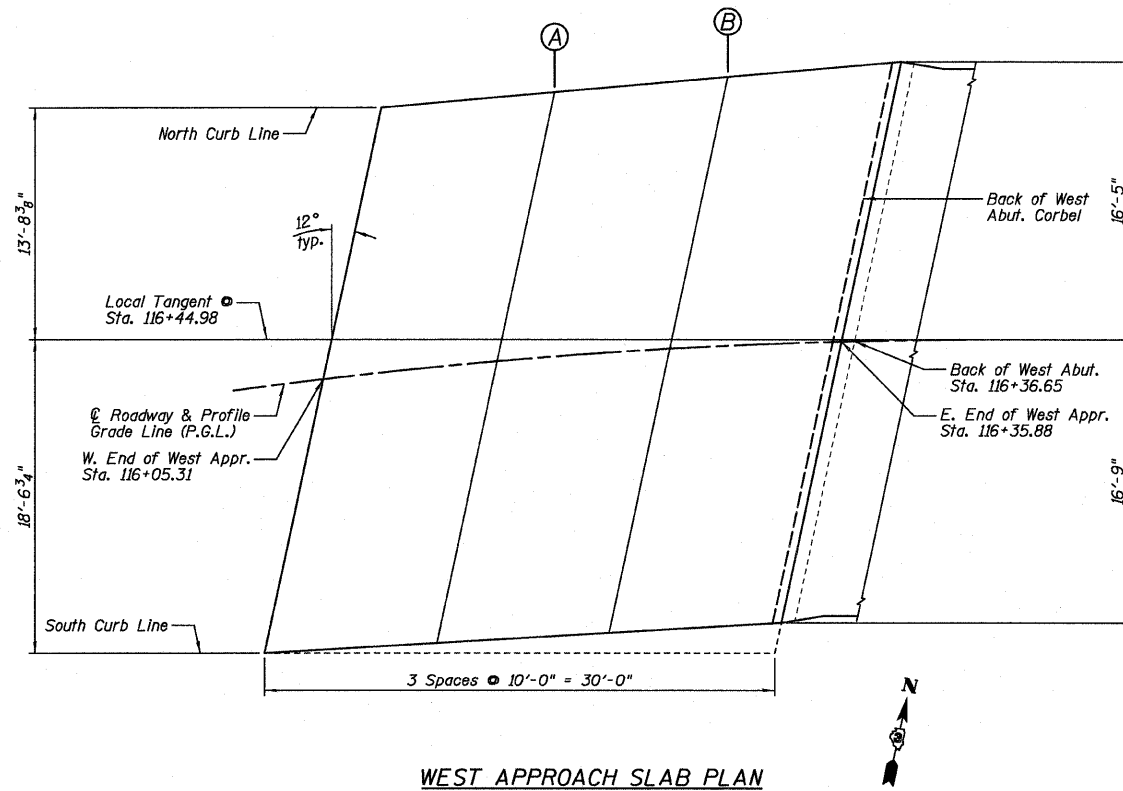

**WEST APPROACH SLAB PLAN**

**NORTH CURB LINE**

| Location             | Station   | Offset | Theoretical Grade Elevations |
|----------------------|-----------|--------|------------------------------|
| Back of East Abut.   | 116+62.76 | -16.78 | 531.34                       |
| W. End of East Appr. | 116+63.51 | -16.96 | 531.36                       |
| A                    | 116+72.83 | -16.32 | 531.52                       |
| B                    | 116+82.18 | -15.95 | 531.68                       |
| E. End of East Appr. | 116+91.54 | -15.86 | 531.85                       |

**☉ ROADWAY & PROFILE GRADE LINE (P.G.L.)**

| Location             | Station   | Offset | Theoretical Grade Elevations |
|----------------------|-----------|--------|------------------------------|
| Back of East Abut.   | 116+60.12 | 0.00   | 530.53                       |
| W. End of East Appr. | 116+60.88 | 0.00   | 530.55                       |
| A                    | 116+70.77 | 0.00   | 530.74                       |
| B                    | 116+80.62 | 0.00   | 530.93                       |
| E. End of East Appr. | 116+90.44 | 0.00   | 531.11                       |

**SOUTH CURB LINE**

| Location             | Station   | Offset | Theoretical Grade Elevations |
|----------------------|-----------|--------|------------------------------|
| Back of East Abut.   | 116+57.26 | 16.41  | 529.73                       |
| W. End of East Appr. | 116+58.05 | 16.51  | 529.75                       |
| A                    | 116+68.46 | 16.53  | 529.95                       |
| B                    | 116+78.87 | 16.25  | 530.16                       |
| E. End of East Appr. | 116+89.24 | 15.65  | 530.39                       |

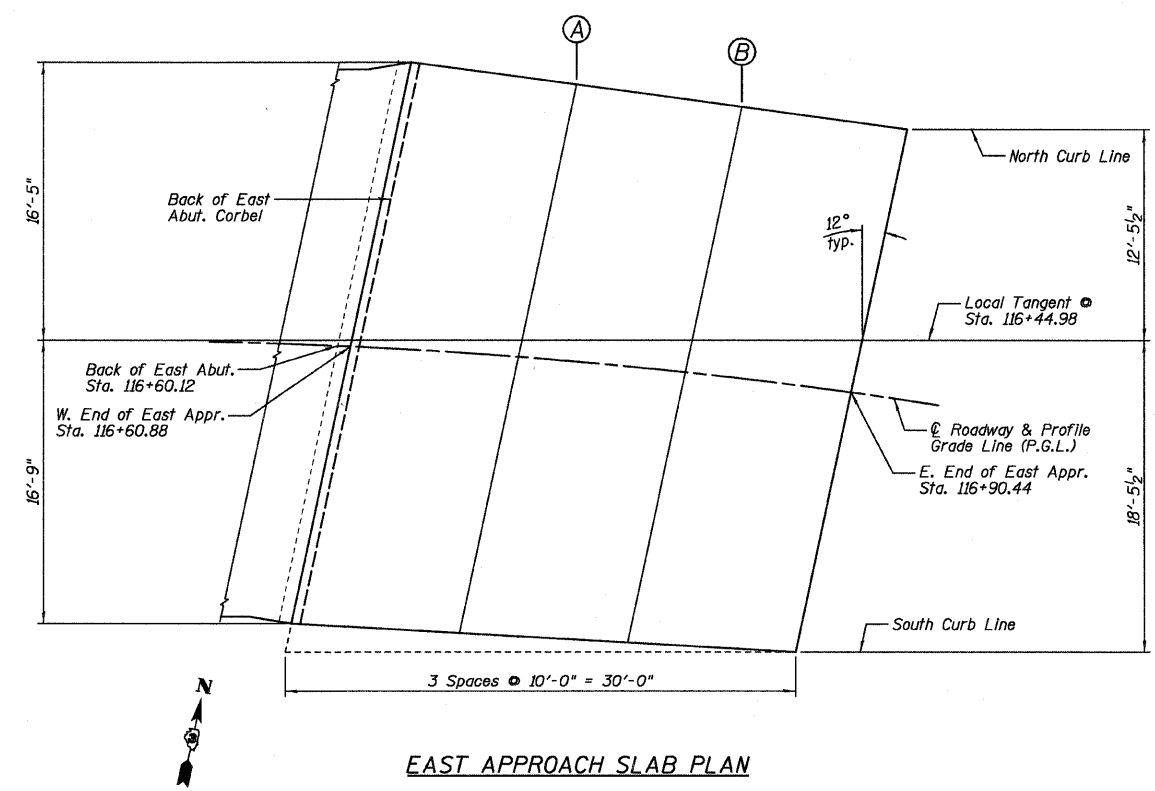

**EAST APPROACH SLAB PLAN**

**Farnsworth GROUP, INC.**  
2709 McDraw Drive  
Bloomington, Illinois 61704  
309/893-9435, 309/893-1871 fax

DESIGNED - JML  
CHECKED - MSW  
DRAWN - DJM  
DATE - 11/07/11

REVISOR  
REVISOR  
REVISOR  
REVISOR

**STATE OF ILLINOIS  
DEPARTMENT OF TRANSPORTATION**

**APPROACH SLAB ELEVATIONS  
STRUCTURE NO. 050-0184**

SHEET NO. B4 OF 20 SHEETS

|                    |                       |                   |                           |                 |
|--------------------|-----------------------|-------------------|---------------------------|-----------------|
| F.A.P. RTE.<br>623 | SECTION<br>(G-1) BR-2 | COUNTY<br>LASALLE | TOTAL SHEETS<br>48        | SHEET NO.<br>20 |
| CONTRACT NO. 66972 |                       |                   | ILLINOIS FED. AID PROJECT |                 |