

MATCH LINE
FAI 57 - STA. 1433+00

STA 36+54.80 =
STA. 1441+43.26 LT. 57'

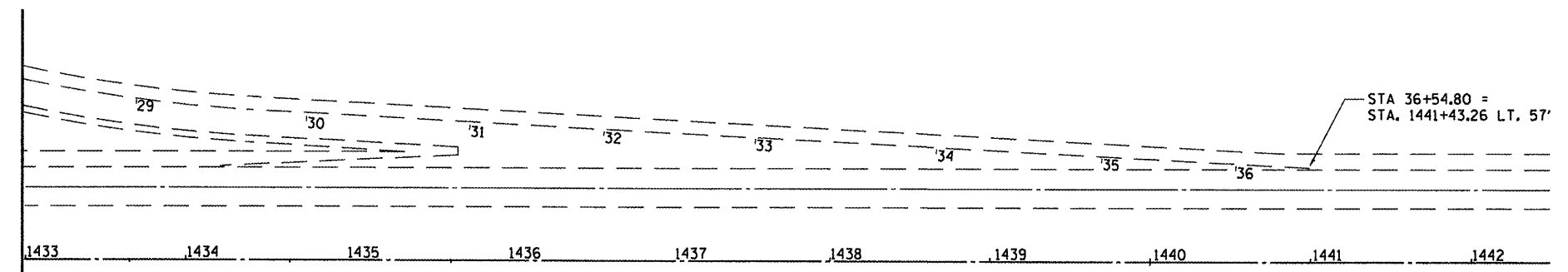

PLAN

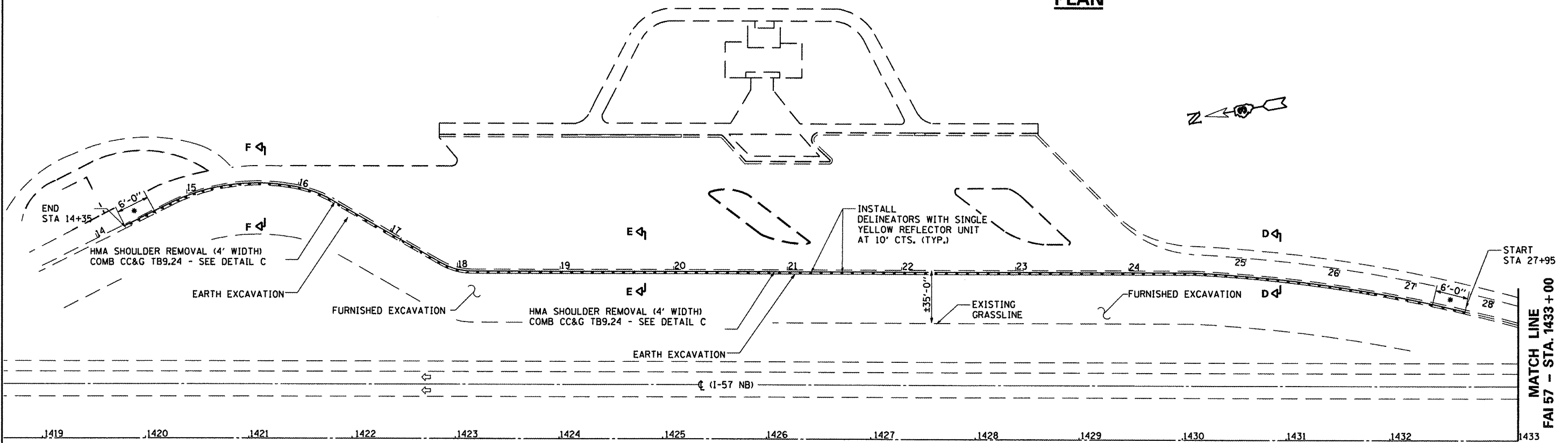

PLAN

* SEE DETAIL B

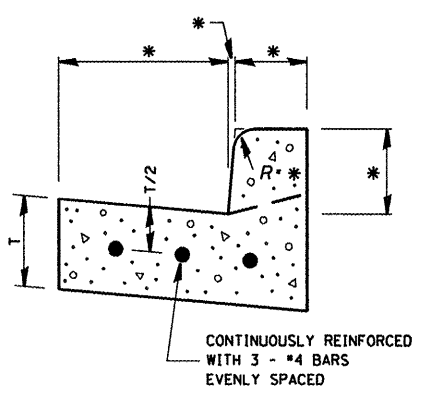

DETAIL C

REINFORCEMENT DETAIL FOR CCC & G TYPE B - 9.24

REINFORCEMENT SHALL NOT BE PAID FOR SEPARATELY BUT WILL BE INCLUDED IN THE CONTRACT UNIT PRICE FOR CCC&G.

* - SEE STANDARD 606001

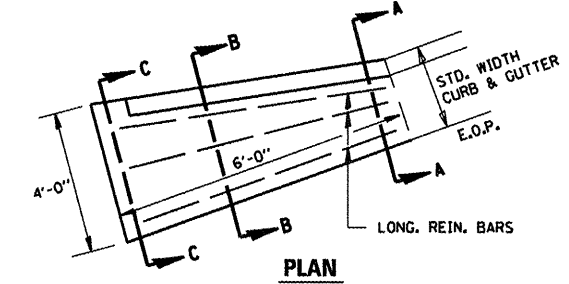
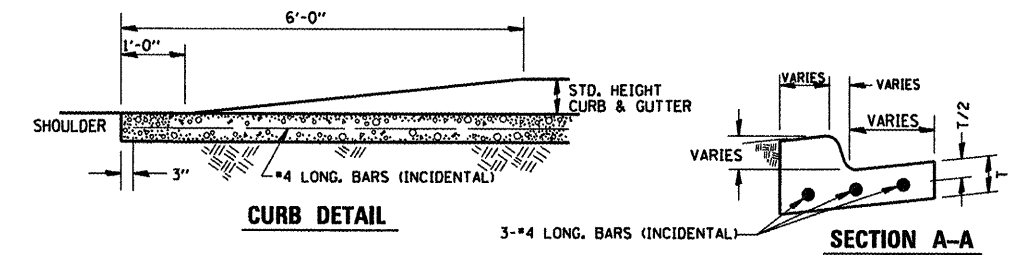

**DETAIL B
CURB & GUTTER OUTLET, SPECIAL**

FILE NAME =	USER NAME = patel.yj	DESIGNED - YOGESH PATEL	REVISED -	STATE OF ILLINOIS DEPARTMENT OF TRANSPORTATION	PLAN DETAILS - NORTHBOUND MAIN LINE STATION REST AREA	F.A.I. RTE.	SECTION	COUNTY	TOTAL SHEETS	SHEET NO.	
ct:\pwwork\p\patel\patel.yj\d0279013\0366671-shd-details.dgn	PLOT SCALE = 100.0000' / 1" =	DRAWN - YOGESH PATEL	REVISED -			57	(38-8)RA-8	ILLINOIS	12	11	
	PLOT DATE = 2/16/2012	CHECKED - RON WOODSHANK	REVISED -			SCALE: _____ SHEET NO. 1 OF 1 SHEETS STA. _____ TO STA. _____		CONTRACT NO. 66B71		ILLINOIS FED. AID PROJECT	
		DATE -	REVISED -								