

NOTE: PROVIDE SIGNING FOR RUNAROUND IN ACCORDANCE WITH STANDARD 701331

LEGEND		TEMPORARY PAVEMENT MARKING LEGEND	
	WORK AREA	①	4" SOLID YELLOW
	SIGN	②	4" SOLID WHITE
	DRUM WITH STEADY BURNING MONODIRECTIONAL LIGHT	③	6" SOLID WHITE
	DIRECTION OF TRAFFIC FLOW	④	4" DOUBLE SOLID YELLOW
	TYPE III BARRICADES	⑤	4" 2-6 SKIP DASH WHITE

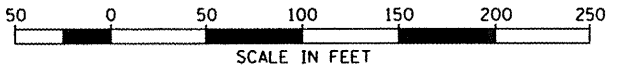
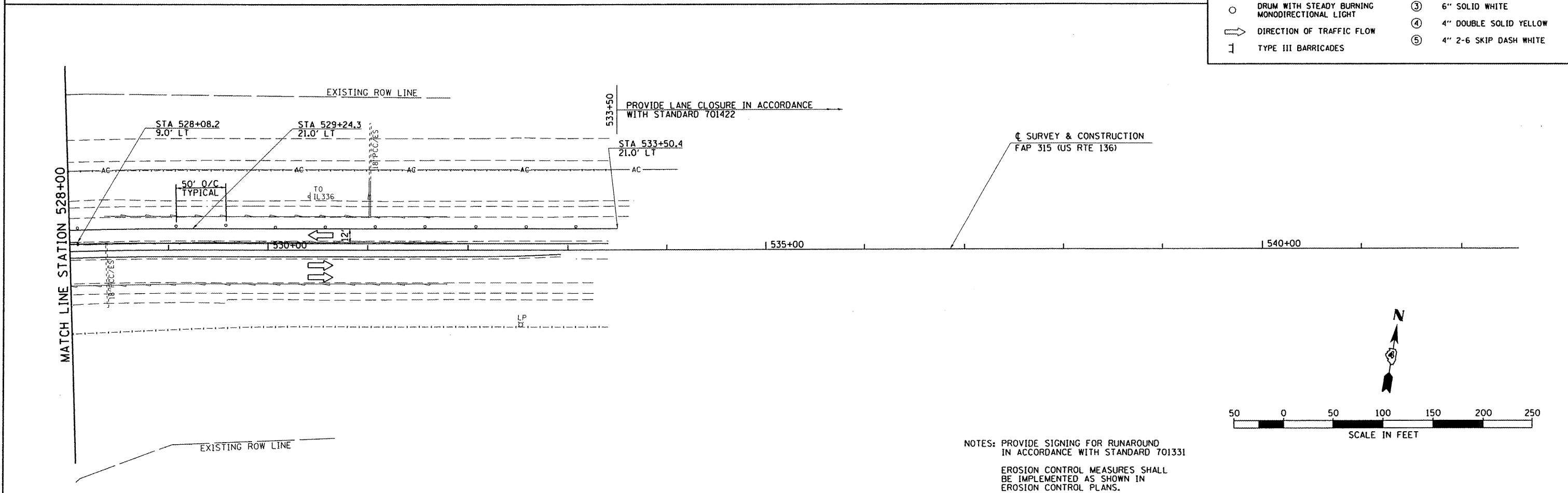

NOTES: PROVIDE SIGNING FOR RUNAROUND IN ACCORDANCE WITH STANDARD 701331

EROSION CONTROL MEASURES SHALL BE IMPLEMENTED AS SHOWN IN EROSION CONTROL PLANS.

FILE NAME = v:\transportation\289\us136\plans\US136M106.dgn	USER NAME = tdarr	DESIGNED -	REVISED -	<b>STATE OF ILLINOIS DEPARTMENT OF TRANSPORTATION</b>	<b>FAP 315 (US RTE 136) MAINTENANCE OF TRAFFIC PLAN - STAGE 2</b>			F.A.P. RTE. 315	SECTION 55-34B	COUNTY McDONOUGH	TOTAL SHEETS 103	SHEET NO. 21
PLOT SCALE = 100.00' / IN.	CHECKED -	REVISED -	REVISED -		SCALE: 1"=50'	SHEET NO. OF SHEETS	STA. 514+00 TO STA. 542+00	CONTRACT NO. 68A40				
PLOT DATE = 8/23/2011	DATE -	REVISED -	REVISED -		ILLINOIS FED. AID PROJECT							