

NOTES:
 ALL ELEVATIONS SHOWN ARE PROPOSED ELEVATIONS UNLESS NOTED WITH (EX)
 (EX) = EXISTING PAVEMENT ELEVATION

**RUNAROUND CONNECTION TO US ROUTE 136
 EAST END**

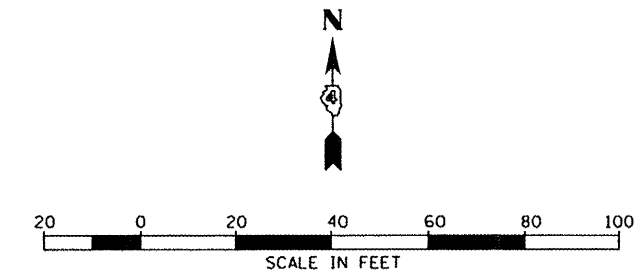
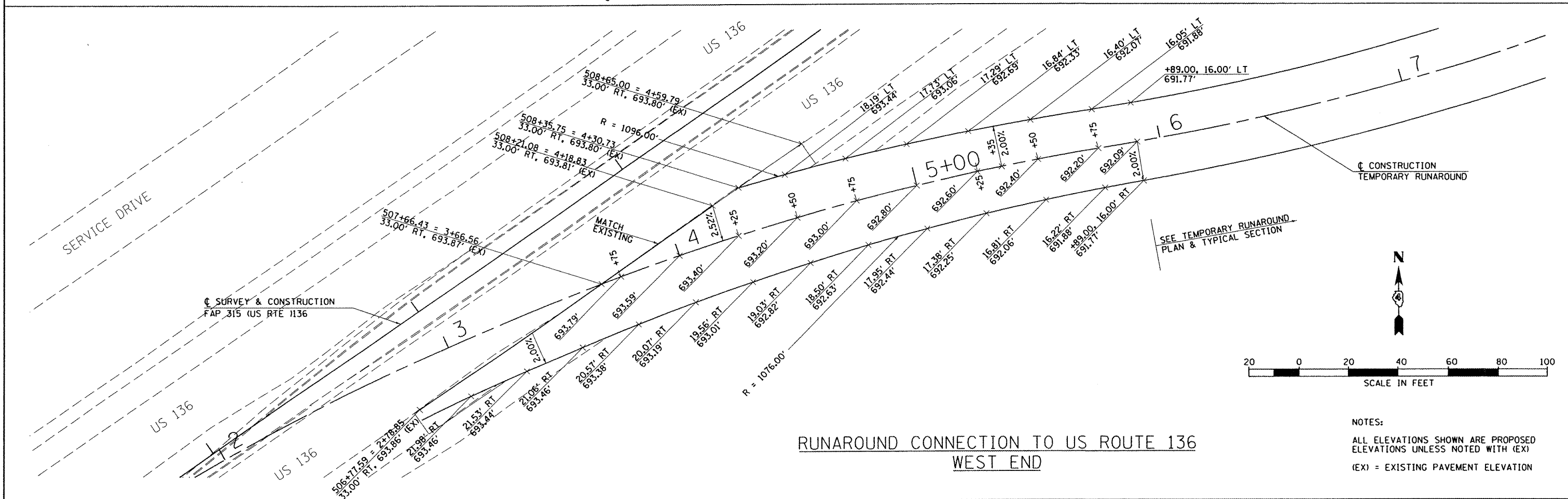

NOTES:
 ALL ELEVATIONS SHOWN ARE PROPOSED ELEVATIONS UNLESS NOTED WITH (EX)
 (EX) = EXISTING PAVEMENT ELEVATION

**RUNAROUND CONNECTION TO US ROUTE 136
 WEST END**

FILE NAME =	USER NAME = tdarr	DESIGNED - AWM	REVISED -	STATE OF ILLINOIS DEPARTMENT OF TRANSPORTATION	FAP 315 (US RTE 136) MAINTENANCE OF TRAFFIC TEMPORARY RUNAROUND - SPECIAL DETAIL			F.A.P. RTE.	SECTION	COUNTY	TOTAL SHEETS	SHEET NO.
\\transportation\2891\us136plans\US136M\TD01.dgn		DRAWN - AKK	REVISED -		315	55-3HB	MCDONOUGH	103	22			
PLOT SCALE = 40.000' / IN.		CHECKED -	REVISED -		CONTRACT NO. 68A40							
PLOT DATE = 8/23/2011		DATE - 3/21/11	REVISED -		ILLINOIS FED. AID PROJECT							
					SCALE: 1"=20'	SHEET NO. OF SHEETS	STA. TO STA.					