

SEC 4, T 5 N, R 3 W, 4th PM

PROP. CURVE US136-1
 PI STA. = 520+31.78
 $\Delta = 25^\circ 21' 37''$ (RT)
 $D = 1^\circ 23' 50''$
 $R = 4,101.04'$
 $T = 922.72'$
 $L = 1,815.21'$
 $E = 102.52'$
 $e = 2.2\%$
 $T.R. = 88.58'$
 $S.E. RUN = 134.00'$
 $P.C. STA. = 511+09.06$
 $P.T. STA. = 529+24.27$

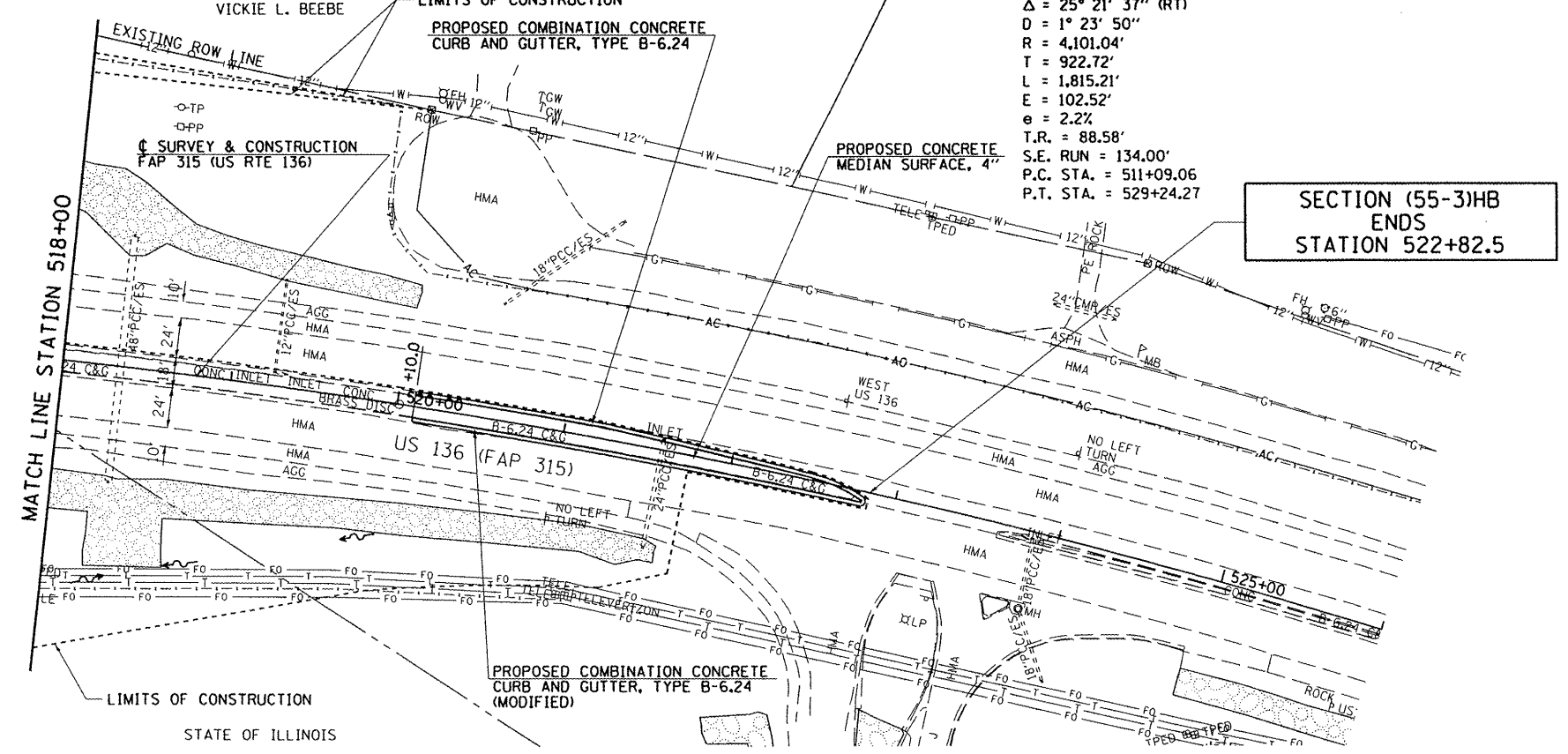

SECTION (55-3)HB
 ENDS
 STATION 522+82.5

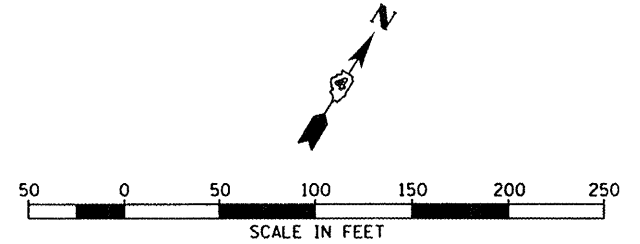

PLAN

DATE	
BY	
SURVEYED	
ALIGNED CHECKED	
RT. OF WAY CHECKED	
NOTE BOOK NO.	
FILE NAME	

PROFILE

DATE	
BY	
SURVEYED	
GRADES CHECKED	
PLANNING CHECKED	
NOTE BOOK NO.	
FILE NAME	

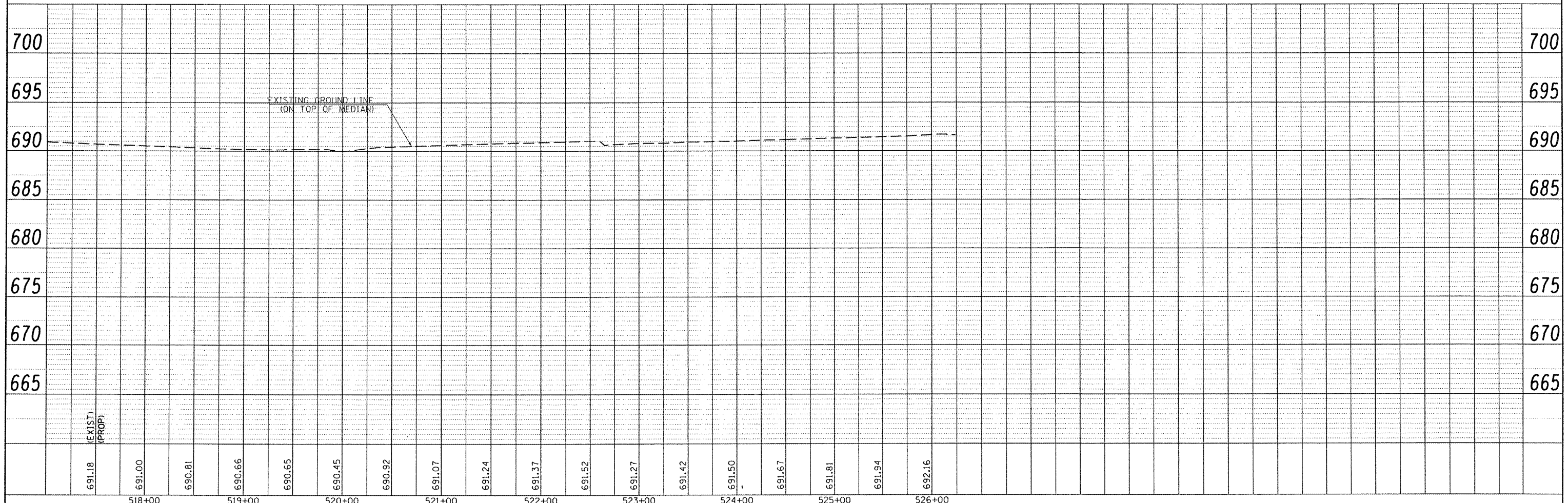

FILE NAME =	USER NAME = tdarr	DESIGNED -	REVISED -	<p align="center">STATE OF ILLINOIS DEPARTMENT OF TRANSPORTATION</p>	<p align="center">FAP 315 (US RTE 136) ROADWAY PLAN & PROFILE</p>	<table border="1"> <tr><td>F.A.P. RTE.</td><td>SECTION</td><td>COUNTY</td><td>TOTAL SHEETS</td><td>SHEET NO.</td></tr> <tr><td>315</td><td>(55-3)HB</td><td>MCDONOUGH</td><td>103</td><td>26</td></tr> <tr><td colspan="5">CONTRACT NO. 68A40</td></tr> <tr><td colspan="5">ILLINOIS FED. AID PROJECT</td></tr> </table>	F.A.P. RTE.	SECTION	COUNTY	TOTAL SHEETS	SHEET NO.	315	(55-3)HB	MCDONOUGH	103	26	CONTRACT NO. 68A40					ILLINOIS FED. AID PROJECT				
F.A.P. RTE.	SECTION	COUNTY	TOTAL SHEETS				SHEET NO.																			
315	(55-3)HB	MCDONOUGH	103				26																			
CONTRACT NO. 68A40																										
ILLINOIS FED. AID PROJECT																										
v:\transportation\2891\us136plans\US136Rdway\PP2.dgn		DRAWN -	REVISED -																							
PLOT SCALE = 100.00' / IN.		CHECKED -	REVISED -																							
PLOT DATE = 8/23/2011		DATE -	REVISED -																							
SCALE: 1"=50'				SHEET NO. OF SHEETS STA. 518+00 TO STA. 526+00																						